

ORDINANCE NO. 3684

AN ORDINANCE ANNEXING TO THE CITY OF ROCHESTER
APPROXIMATELY 21.81 ACRES OF LAND LOCATED IN THE
WEST HALF OF SECTION 18, TOWNSHIP 107 NORTH, RANGE
14 WEST, OLMSTED COUNTY, MINNESOTA.

THE COMMON COUNCIL OF THE CITY OF ROCHESTER DO ORDAIN:

Section 1. A petition has been filed with the Common Council of the City of Rochester, signed by the owner of land described herein, requesting the Common Council to annex said land to the City of Rochester. The land described in the petition for annexation is described as follows:

That part of the West Half of Section 18, Township 107 North, Range 14 West, Olmsted County, Minnesota, described as follows:

Beginning at the southeast corner of the Northwest Quarter of said Section 18; thence North 00 degrees 08 minutes 13 seconds West, assumed bearing, along the east line of said Northwest Quarter, 395.09 feet; thence South 89 degrees 51 minutes 47 seconds West, 1319.92 feet; thence South 00 degrees 04 minutes 05 seconds West, 385.95 feet to the northwest corner of the Northeast Quarter of the Southwest Quarter of said Section 18; thence South 00 degrees 03 minutes 00 seconds West, along the west line thereof, 328.64 feet; thence South 89 degrees 44 minutes 26 seconds East, 1322.41 feet to the east line of the West Half of Section 18; thence North 00 degrees 08 minutes 13 seconds West, along said east line, 328.64 feet to the point of beginning.

Containing 21.81 acres more or less.

Section 2. The total quantity of land included in the petition is approximately 21.81 acres in size.

Section 3. On November 1, 2004, the Common Council held a public hearing to consider this annexation petition after providing written notice of the hearing, by certified mail, to

the property owners, the Cascade Township officers, and the adjacent property owners.

Section 4. The City provided notification to the petitioners pursuant to Minn. Stat. §414.033, subd. 2b, 11, 12 and 13 if applicable to this petitioned annexation.

Section 5. Following the public hearing, the Common Council of the City of Rochester determined that the land abuts the municipal limits, is less than 60 acres in area, the annexation petition is signed by all property owners of the land described in Section 1, and the land is or will soon become urban or suburban in character.

Section 6. Therefore, pursuant to Minn. Stat. §414.033, subd. 2(3), the land described in Section 1 above is hereby annexed, added to and made a part of the City of Rochester, Minnesota, as if it had originally been a part thereof.

Section 7. Present and future owners of the lands annexed by this ordinance are hereby notified that in addition to the usual assessments, it is the intention of the Common Council to assess against benefited property all or a portion of the cost of any storm sewer, water tower, pumping station, and trunk line sanitary sewer construction, heretofore or hereafter undertaken to serve the area annexed.

Section 8. This ordinance shall take effect and be in force from and after its official publication and from and after the filing of a certified copy hereof with the Minnesota State Planning Commission, the Cascade Town Clerk, the County Auditor and the Secretary of State.

PASSED AND ADOPTED BY THE COMMON COUNCIL OF THE CITY OF
ROCHESTER, MINNESOTA, THIS 6th DAY OF December, 2004.

Jane Kuntz
PRESIDENT OF SAID COMMON COUNCIL

ATTEST: Walori Kampsen
Deputy CITY CLERK

APPROVED THIS 7th DAY OF December, 2004.

Steven F. Brode
MAYOR OF SAID CITY

(Seal of the City of
Rochester, Minnesota)

Ord2000Annex.0416

ANNEXATION EXHIBIT

DESCRIPTION:
SEE ATTACHED



SCALE 1" = 800'

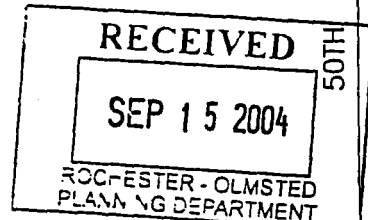
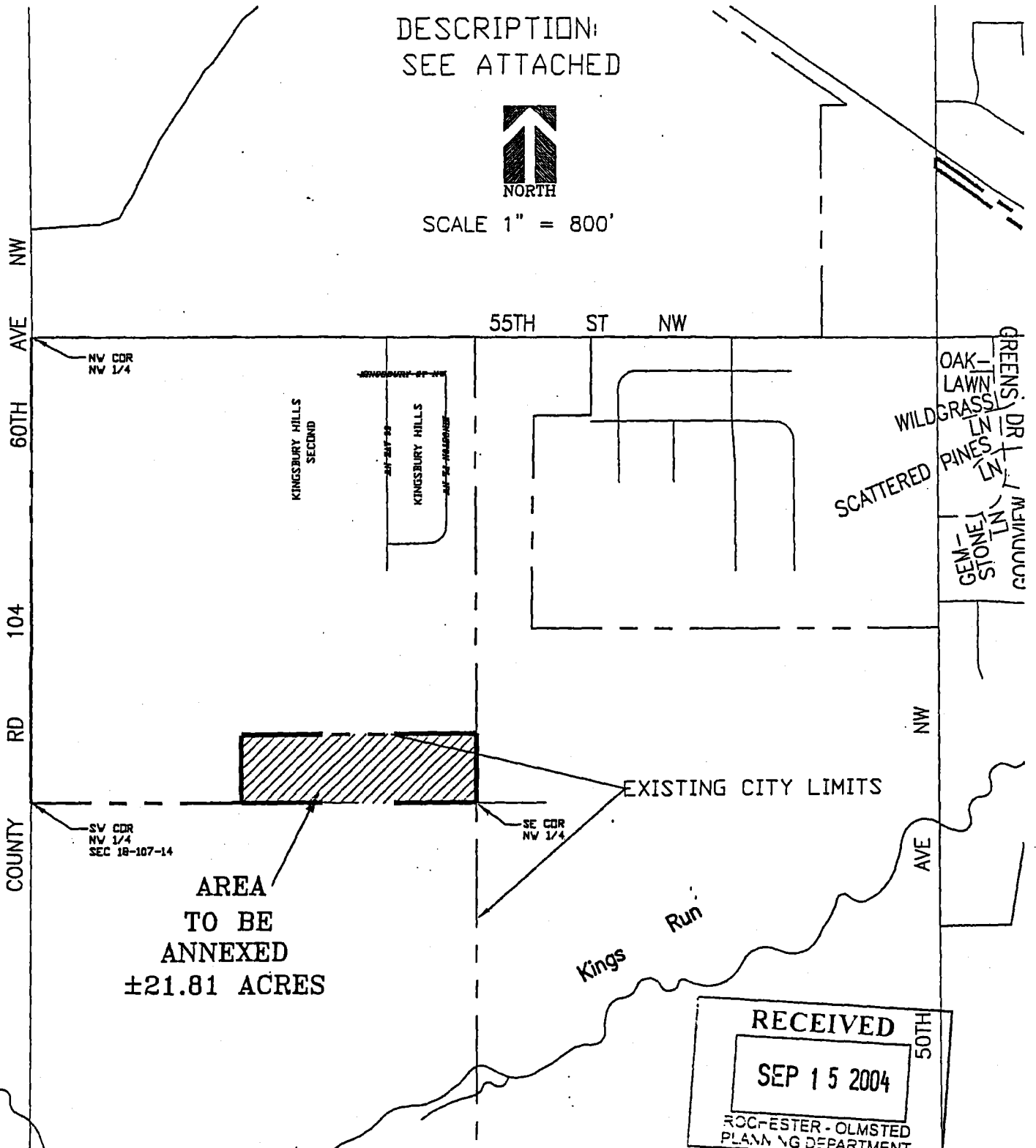

FDR:
JOEL BIGELOW
& SONS ENTERPRISES
706 CTY RD 3 NW
BYRON, MN
55009

Land Surveying
Urban-Land Planning
Consulting - Civil Engineering

McGhie

Geotechnical Engineering
Construction Material Testing
Landscape Architecture

1548 Third Avenue S.E.
Rochester, MN 55904
Telephone: 482-7800 FAX: 482-7801

SCALE:	1" = 800'
DRAWN BY:	JJJ
DATE:	09/15/04
ACCT. NO.:	1084/4318
Cadd No.:	4318ANNE