

ORDINANCE NO. 1205AN ORDINANCE EXTENDING THE CORPORATE LIMITS  
OF THE CITY OF WILLMAR

WHEREAS, Parker and Poss (petitioners) have filed a petition dated July 12, 2004, requesting that certain land, as legally described below:

That part of Government Lot 4, Section 26, Township 119, Range 35 Kandiyohi County, Minnesota, described as follows; Commencing at the Northeast corner of Lot 1, Block Three of SOUTH INDUSTRIAL PARK, as of public record, Kandiyohi County, Minnesota; thence on an assumed bearing of S 0° 04' 36" E, along the East line of said Lot 1, a distance of 250.00 feet; thence on a bearing of S 89° 55' 24" E, 300.00 feet to the point of beginning of the tract herein described; thence continuing on a bearing of S 89° 55' 24" E, 311.54 feet; thence on a bearing of N 0° 04' 36" E, 316.00 feet to the South line of Block Two of said SOUTH INDUSTRIAL PARK; thence on a bearing of N 89° 55' 24" W, along last said line 536.54 feet to the East line of the Dedicated Road in said SOUTH INDUSTRIAL PARK; thence on a bearing of S 0° 04' 36" W, along last said line 66.00 feet to the South line of said Dedicated Road; thence on a bearing of S 89° 55' 24" E, 225.00 feet; thence on a bearing of S 0° 04' 36" W, 250.00 feet to the point of beginning, containing 2.6 acres, more or less.

be annexed to the City of Willmar; and

WHEREAS, Petitioners represent that they are the sole owners of the property, that the property is unincorporated, abuts the limits of the City of Willmar, is not included within any other municipality, is less than sixty (60) acres, is not included in any area that has already been designated for orderly annexation pursuant to Minnesota Statutes 414.0325, is not presently served by public sewer facilities, and is approximately 2.6 acres in size.

NOW, THEREFORE, the City Council of Willmar, Minnesota, hereby determines, ordains, and declares as follows:

Section 1. STATUTORY COMPLIANCE. The City Council hereby determines and finds that the property abuts the municipality, that the area to be annexed is sixty (60) acres or less, that the property is not included in any area that has already been designated for orderly annexation pursuant to Minnesota Statutes 414.0325, that the property is not presently served by public sewer facilities, that the municipality has received a properly prepared Petition for Annexation from the sole owners of the property, and that the Petition complies with all of the provisions of Minnesota Statute 414.033. The property owners waived notice pursuant to Minnesota Statute 414.033 subd.13 as the utilities serving the site will not change.

AUG 25 2004

Section 2. BEST INTEREST OF THE CITY OF WILLMAR AND AREA TO BE ANNEXED. The property is urban in nature or about to become so. The annexation will be in the best interest of the City of Willmar, Minnesota, and of the area affected.

Section 3. ANNEXATION. The corporate limits of the City of Willmar are hereby extended to include the property, and the same is hereby annexed to and included within the City of Willmar as if the property had originally been part thereof.

Section 4. ZONING. The above-described real estate shall be zoned GB - General Business.

Section 5. ACREAGE. The property conditioned for annexation has an area of 2.6 acres.

Section 6. EFFECTIVE DATE. This Ordinance shall be filed and shall take effect and be in full force and effect from and after filing a certificate thereof with Minnesota Planning, the County of Kandiyohi, Minnesota, and the Secretary of State of the State of Minnesota, and from and after its adoption and publication.

This Ordinance introduced by Councilman: DeBlieck

This Ordinance introduced on: August 2, 2004

This Ordinance published on: August 6, 2004

This Ordinance given a hearing on: August 16, 2004

This Ordinance adopted on: August 16, 2004

This Ordinance published on: August 20, 2004

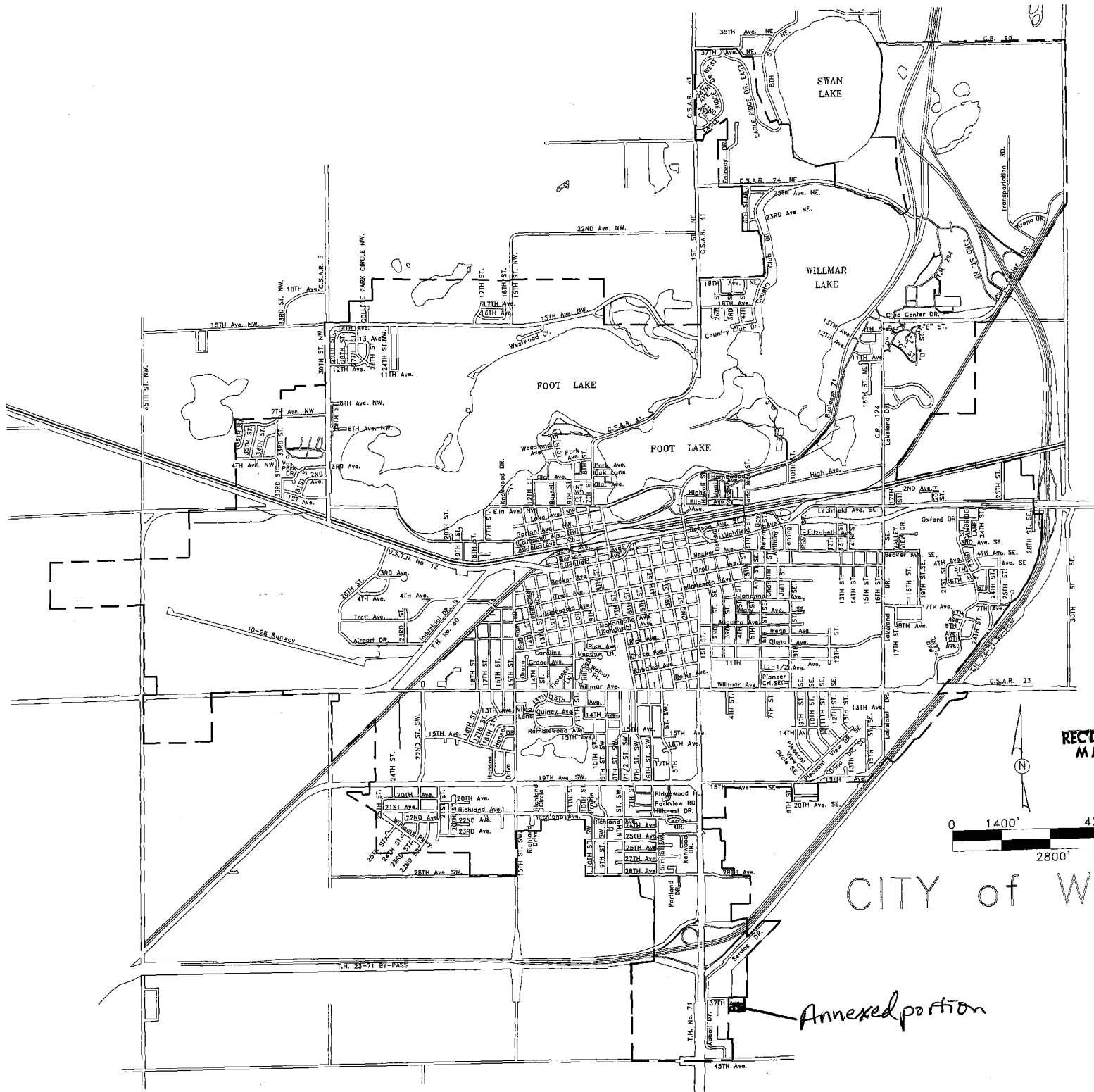

REC'D BY  
MMB  
AUG 25 2004

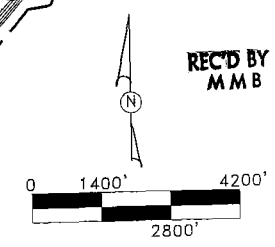

CITY of WILLMAR

Annexed portion

REC'D BY  
MMB  
AUG 25 2004

# PRELIMINARY PLAT OF HENNEN ADDITION

NO. 77

