

ORDINANCE 05-2003**AN ORDINANCE EXTENDING THE CORPORATE LIMITS OF THE CITY OF KINGSTON PURSUANT TO MINNESOTA STATUTES §414.033, Subd. 2(3)**

WHEREAS, a certain petition, dated July 21, 2003, requesting annexation of the territory hereinafter described, was duly presented to the City Council of the City of Kingston on September 5, 2003; said property being described on Exhibit A attached hereto and made a part hereof; and

WHEREAS, pursuant to Minnesota Statutes 414.033, Subd. 2b, the City Council of the City of Kingston directed the City Clerk to schedule a public hearing for said request on November 17, 2003; and

WHEREAS, pursuant to the aforesaid Order of Hearing, notice of the same was given by certified mail as required law, to all owners of lands located within the area proposed for annexation, the owners of all lands abutting the area proposed for annexation, and the affected units of government; and

WHEREAS, the City Council held a hearing on the aforesaid Petition for the Annexation of Land on the 17th day of November, 2003; and

THE CITY COUNCIL OF THE CITY OF KINGSTON FINDS THE FOLLOWING:

- (1) That the Petition for Annexation of Land, dated July 21, 2003, above described is complete in all respects as required by Minnesota Statutes §414.033, Subd. 2(3); and
- (2) That the land proposed for annexation and described in the above referred to Petition about the City of Kingston, MN, comprise an area consisting of 42 acres more or less and is an area not presently serviced by public sewer and water facilities; and
- (3) That the Petition for Annexation above referred to has been signed by all of the property owners of the lands located within the area proposed for annexation in the above described Petition; and
- (4) That the area proposed for annexation on the above described Petition is about to become urban or suburban in character; and
- (5) All of the property proposed for annexation in the above described Petition lies within the Township of Kingston, County of Meeker, State of Minnesota and is as described in the above referred to Petition; and
- (6) That the property sought to be annexed by the above described Petition abuts upon existing City Limits of the City of Kingston along the eastern boundary of the existing City Limits and that none of said territory is included within the corporate limits of any incorporated City; and

- (7) That the population of the property sought to be annexed is two; and
- (8) The property sought to be annexed is owned by the following persons:
Jerome and Martha Fitzloff and Kingston City Properties LLP
30736 725th Avenue
Dassel, MN 55325
- (9) That the City does not believe that the cost of electrical utility service to the area described in the Petition will change as a result of the annexation of said property to the City and therefore, Minnesota Statutes §414.033, Subd. 13 is not applicable; and
- (10) The property described in said Petition is located in a floodplain or shoreland area; and
- (11) That the property described in said Petition is not covered by any Community Based Planning Pilot Projects.

NOW, THEREFORE, THE CITY COUNCIL OF THE CITY OF KINGSTON, HAVING CONSIDERED ALL OF THE TESTIMONY OFFERED RELATIVE TO THE MATTER OF THE PETITION FOR ANNEXATION OF LAND ABOVE DESCRIBED, ORDAINS AS FOLLOWS:

- Section 1. That all of the heretofore stated finding are incorporated herein and made a part hereof as if included in their entirety.
- Section 2. The corporate limits of the City of Kingston are hereby extended to include the unplatted land described as follows and the same is hereby extended to and included within the City of Kingston as effectively as if it had originally been a part thereof.
SEE EXHIBIT A
- Section 3. The City Clerk of the City of Kingston is hereby directed to file certified copies of this Ordinance, and all other required documents, with the Minnesota Planning/Office of Strategic and Long Range Planning, the Kingston Township Clerk, the Secretary of State, and the Meeker County Auditor.
- Section 4. Upon annexation to the City, the Property shall be zoned R-1, One and Two Family Residential.
- Section 5. Pursuant to Minnesota Statutes §414.033, subd. 12, the property taxes payable on annexed land in the year 2004 shall be paid to the Township of Kingston, Minnesota. Thereafter, the City of Kingston shall make a cash payment to the Township of Kingston in accordance with the following schedule:
 - a. 2005 – an amount equal to ninety percent (90%) of the property taxes distributed to the town in regard to the annexed area in 2004.
 - b. 2006 – An amount equal to seventy percent (70%) of the property taxes distributed to the town in regard to the annexed area in 2004.

- c. 2007 – an amount equal to fifty percent (50%) of the property taxes distributed to the town in regard to the annexed area in 2004.
- d. 2008 – an amount equal to thirty percent (30%) of the property taxes distributed to the town in regard to the annexed area in 2004.
- e. 2009 – an amount equal to ten percent (10%) of the property taxes distributed to the town in regard to the annexed area in 2004.

Section 6. This Ordinance takes effect upon its passage and publication and the final approval thereof by the Minnesota Planning/Office of Strategic and Long Range Planning, as required by law.

ORDAINED by the City Council of the City of Kingston on this 17th day of November, 2003.

APPROVED BY:



Pat Schauer, Mayor

ATTEST:



Sherri Winkelman, City Clerk

A-6993 Kingston

EXHIBIT A
ANNEXATION DESCRIPTION

All that part of the North Half of the Northeast Quarter lying South of the Crow River in Section 22, Township 120, Range 29, except therefrom the West 174.94 feet of the South 397.85 feet thereof. The West 174.94 feet of the South 397.85 feet of the North One-Half of the Northeast Quarter (N1/2 of NE1/4) of Section 22, Township 120, Range 29, containing 1.6 acres, more or less.

REC'D BY MMB NOV 25 2003

MEEKER

neston

T.120N. - R.29W.

©2001 Cloud Cartographics, Inc. St. Cloud, MN 56301

See Page 56

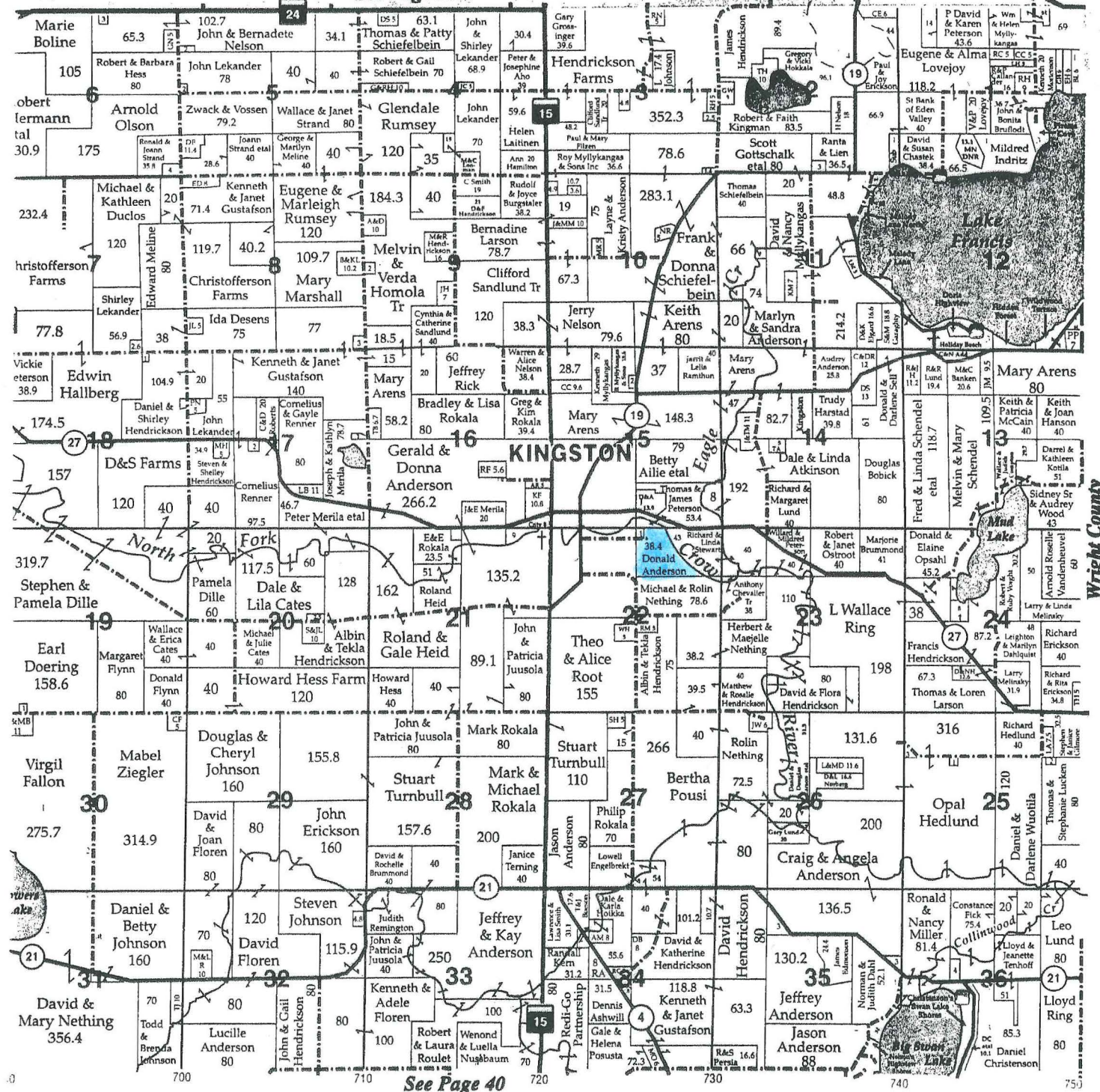

Wright County

Peter's
SIGNS
 &
SCREEN PRINTING

Custom Signs, Truck Lettering, Windows, Pinstriping
 In House Custom Embroidery

24132 So. Hwy. 22
 Peter Brynildson

Litchfield, MN 55355
 (320) 693-2796

HAUG
IMPLEMENT



Litchfield's Local
 Lawn & Garden Equipment
 Headquarters!

Minnesota Highway 24 • Litchfield
 320-693-2438