

ORDINANCE NO. 288

AN ORDINANCE EXTENDING THE CORPORATE LIMITS OF THE CITY OF ISANTI TO INCLUDE CERTAIN UNINCORPORATED PROPERTY (60 ACRES) OWNED BY JUDITH KAY ROUVEL AND ABUTTING UPON THE LIMITS OF THE CITY OF ISANTI IN ISANTI TOWNSHIP PURSUANT TO MINNESOTA STATUTES 414.033, subd. 2(3)

WHEREAS, a certain petition dated March 27, 2003, requesting that the property as hereinafter described be annexed to the City of Isanti, Minnesota, was duly presented to this Council on the 15th day of April 2003; and

WHEREAS, said petition was signed by all owners of the property; and

WHEREAS, said property is unincorporated and abuts the City of Isanti on its Northeasterly boundary; and

WHEREAS, said property is 60 acres or less; and

WHEREAS, said property is not presently served by public sewer and water facilities or public sewer and water facilities are not otherwise available; and

WHEREAS, said property is currently being developed for residential purposes; and

WHEREAS, to facilitate said development, the property owner has requested city services be extended to said property; and

WHEREAS, notice of public hearing was given to those parties specified in Minnesota Statutes 414.033, subd. 2b; and

WHEREAS, a public hearing was duly held by the Isanti City Council on the 20th day of May 2003; and

WHEREAS, provisions of Minn. Statute 414.033, subd. 13 are not applicable in that there will be no change in the electric utility service provider resulting from the annexation of the territory to the municipality.

NOW THEREFORE, THE CITY OF ISANTI DOES HEREBY ORDAINS AS FOLLOWS:

1. The City Council hereby determines that the property as hereinafter described is or is about to become urban in nature in that said property is being developed for residential purposes which need or will need city services,

MAY 23 2003

5. **Filing.** The City Clerk is directed to file certified copies of this ordinance with the Secretary of State, the County Auditor of the county in which the property is located, the Town clerk of the affected township and the Minnesota Planning.

6. **Effective date of annexation.** This ordinance takes effect upon its passage and publication and the filing of certified copies as directed in paragraph 5 and approved by the Minnesota Planning.

Passed and Adopted by the City Council of Isanti, Minnesota this 20th day of May 2003.

Mayor David E Apitz

Attest:

Irene J. Bauer, City Clerk-Treasurer

(SEAL)

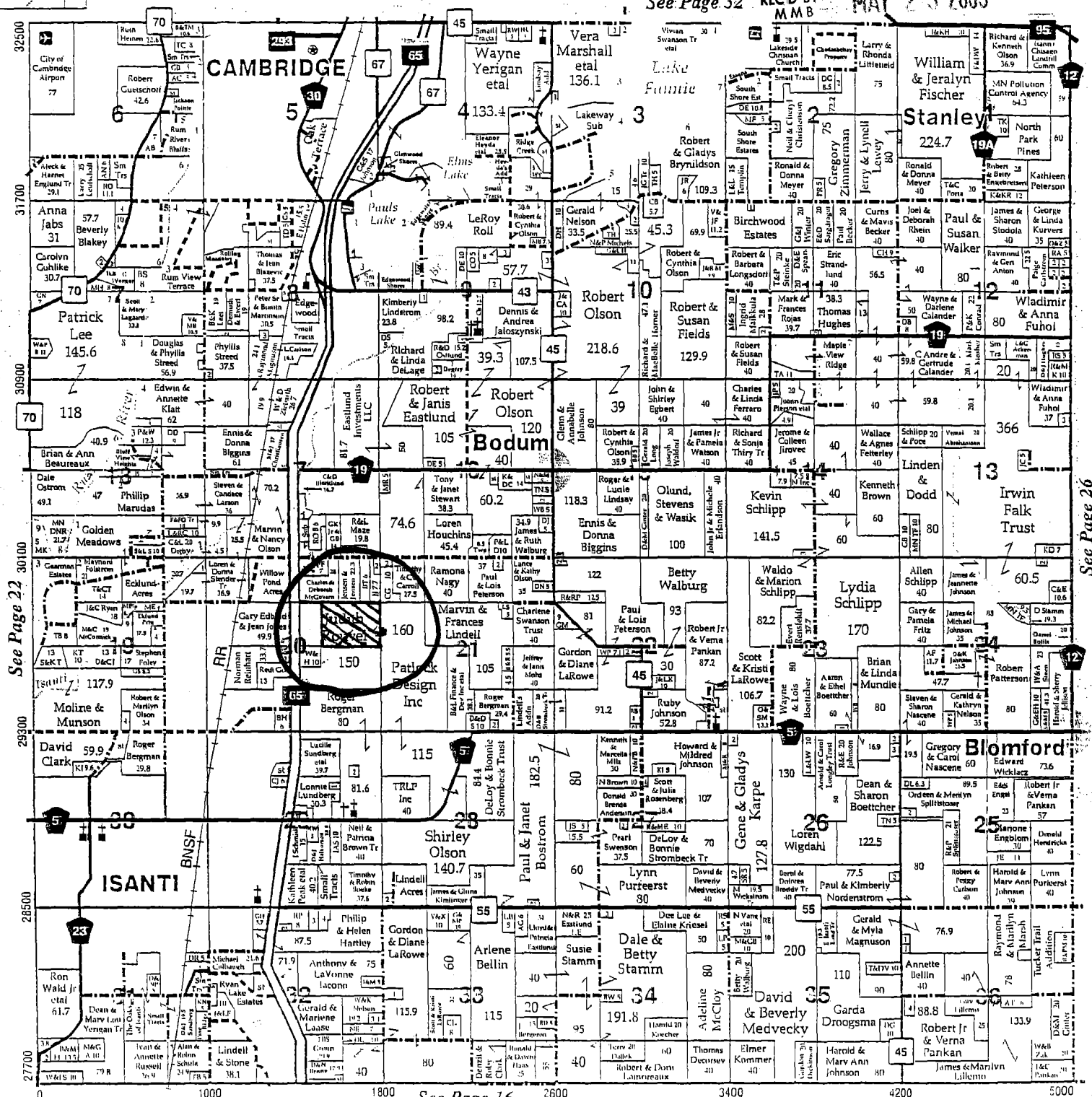

See Page 26

"Call Us For All Your Insurance Needs"



Home • Farm • Auto • Business • Life
Health • Investments • Retirement Plans
Clark G. Johnson



Upper Midwest Associates
Insurance Brokers of MN

(763) 444-9491

Hwy 65 NE & 291st Ave. • Box 368 • Isanti, MN 55040

Cam-
bridge

City
Line

MAY 23 2003

REC'D BY
MMB

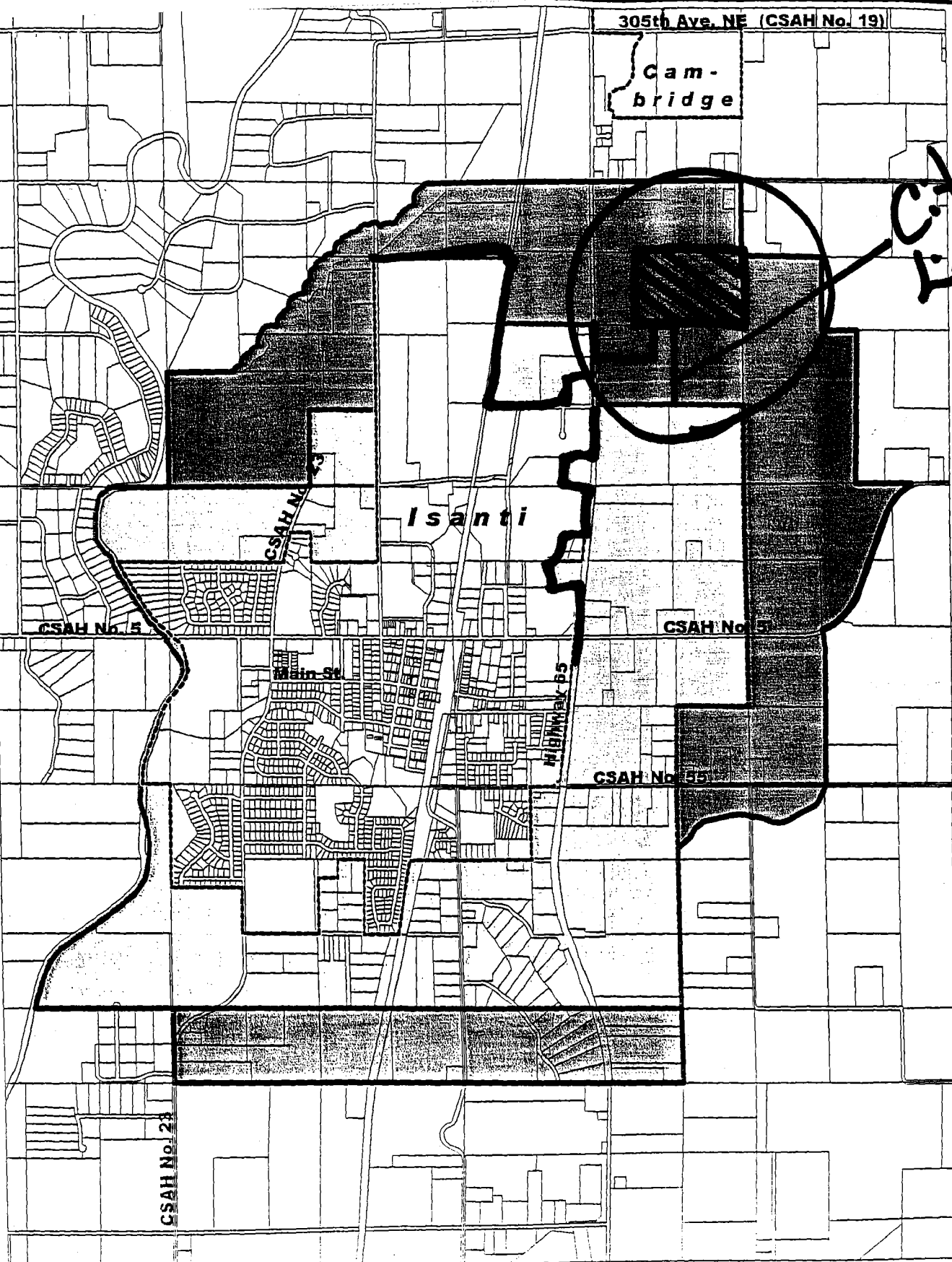



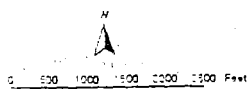

Figure 8.
Proposed USA Tier I Boundary
Isanti, Minnesota

-  City Boundary
-  Existing USA I Boundary
-  Proposed USA I Boundary



Prepared by Dahlgren, Shandrew and Urban, Inc.
21 March 2003