

**ANNEXATION PETITION**

REC'D BY  
M M B

MAR 05 2003

**IN THE MATTER OF THE PETITION FOR ANNEXATION FOR  
CERTAIN UNINCORPORATED LAND TO THE CITY OF SLEEPY EYE.**

I, the undersigned, President of the Diocese of New Ulm, a non-profit corporation, under the laws of the State of Minnesota, herewith petition for the annexation of the following described tract or parcel of land located in Home Township, Brown County, Minnesota, legally described as follows:

The East 80 feet of the Southeast Quarter of the Southwest Quarter (SE¼ of the SW¼), Section 30, Township 110, Range 32, Brown County, Minnesota,  
AND

The East 80 feet of that part of Government Lot 4 being southerly of Lot A of Government Lot 4, Section 30, Township 110, Range 32, Brown County, Minnesota.

I respectfully state:

1. The territory to be annexed abuts the city limits of the City of Sleepy Eye, Minnesota.
2. The territory to be annexed is owned entirely by the Diocese of New Ulm.
3. The property described is not presently included within the corporate limits of any incorporated city and the area is not presently served by public sewer facilities nor public water.
4. This proceeding is commenced under MSA §414.033, Subd. 5.
5. All of this territory is or is about to become urban or suburban in character.

Dated: February 20, 2003.

DIOCESE OF NEW ULM

By + John C. Nienstedt  
John C. Nienstedt, Its President

# CITY OF SLEEPY EYE, MINNESOTA



REC'D BY MMB APR 04 2003

SLEEPY EYE LAKE

Lot A Newly Annexed

Proposed 80ft wide Annexation for sewer & water lines. (3.52 ACRES)

City Boundary

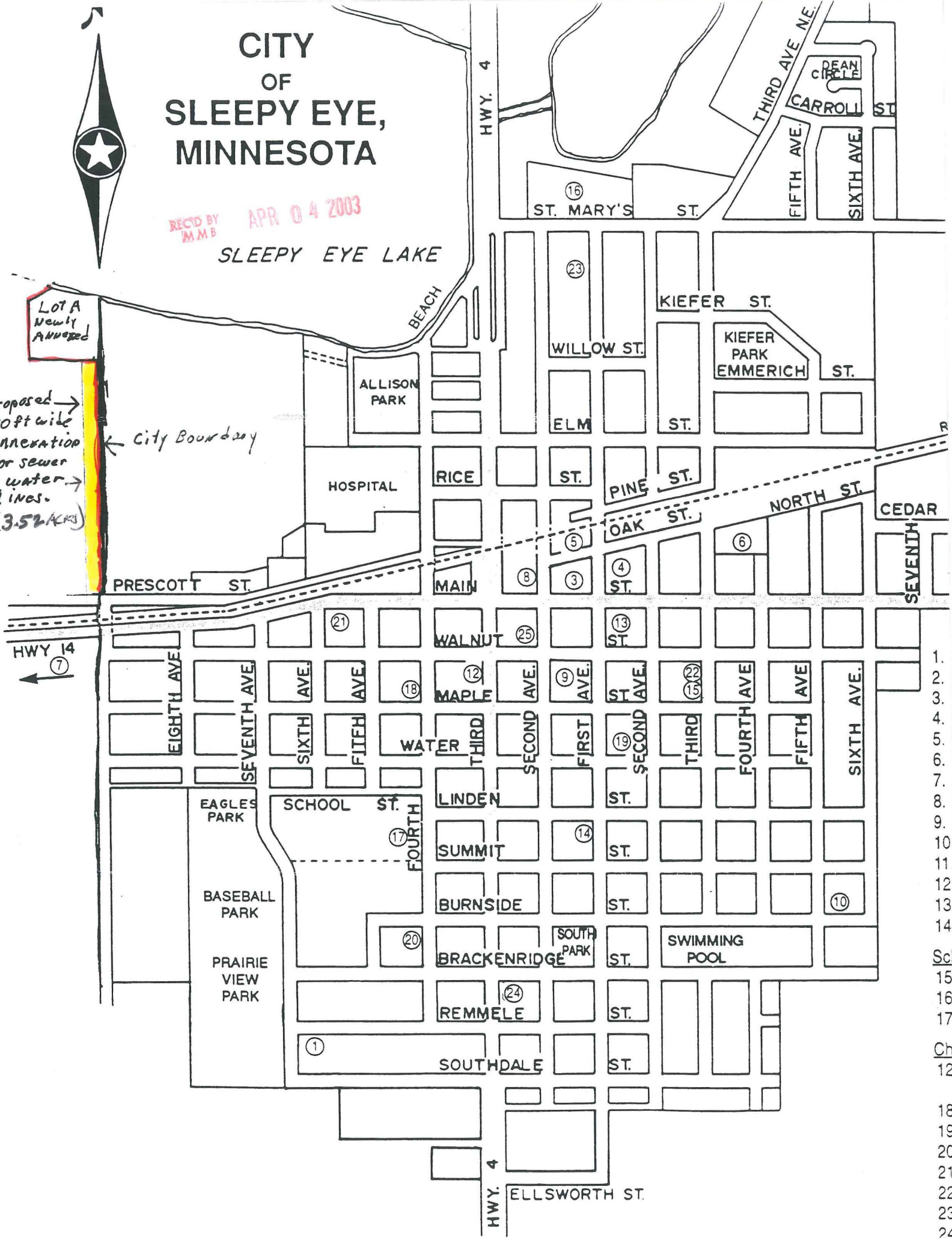

- 1.
- 2.
- 3.
- 4.
- 5.
- 6.
- 7.
- 8.
- 9.
- 10.
- 11.
- 12.
- 13.
- 14.
- Sc
- 15.
- 16.
- 17.
- Ch
- 12
- 18
- 19
- 20
- 21
- 22
- 23
- 24
- 25