

## City of Kasson, MN Ordinance # 791

### **AN ORDINANCE ANNEXING TO THE CITY OF KASSON, MINNESOTA CERTAIN UNPLATTED LAND ABUTTING THE MUNICIPALITY NOT EXCEEDING 60 ACRES IN AREA, ALL BEING IN SECTION 4, TOWNSHIP 106 NORTH, RANGE 16 WEST, DODGE COUNTY, MINNESOTA.**

THE CITY COUNCIL OF THE CITY OF KASSON, MINNESOTA, DOES ORDAIN:

A petition has been filed by Joel Bigelow, sole owner of the land described herein, requesting the City Council to annex said land to the City of Kasson, MN for the purpose of extending utilities to accommodate residential development. The land described in said petition for annexation is located in Canisteo Township, Dodge County, Minnesota, described as follows:

A part of the Northeast Quarter of Section 4, Township 106 North, Range 16 West, Dodge County, Minnesota, described as follows: Commencing at the southeast corner of the Northeast Quarter of said Section 4; thence North 89 degrees 37 minutes 42 seconds West (NOTE: all bearings are on the Dodge County Coordinate System, NAD 1983, 1996 Adjustment) along the south line of said Northeast Quarter for a distance of 1881.99 feet to the southeast corner of the west 20 acres of the South 70 Acres of the South Half of said Northeast Quarter and the POINT OF BEGINNING; thence continue North 89 degrees 37 minutes 42 seconds West for a distance of 746.97 feet to the southwest corner of said Northeast Quarter; thence North 00 degrees 00 minutes 50 seconds East along the west line of said Northeast Quarter for a distance of 1157.30 feet to the northwest corner of the west 20 acres of the South 70 Acres of the South Half of said Northeast Quarter; thence South 89 degrees 37 minutes 42 seconds East along the north line of said west 20 acres for a distance of 758.65 feet to the northeast corner of said west 20 Acres; thence South 00 degrees 35 minutes 33 seconds West along the east line of the said west 20 acres for a distance of 1157.29 feet to the POINT OF BEGINNING. Containing 20.00 Acres, more or less. Said Parcel is subject to the Right of Way easement for the Township Road (245th AVE.) over the westerly 33 feet thereof.

The City Council of the City of Kasson does hereby determine that the land described abuts upon the present territorial limits in the City of Kasson, is so conditioned as to be properly subjected to municipal government and the annexation of said land will be in the best interest of the City of Kasson and the land affected.

Therefore, the land described is hereby annexed, added to and made a part of the City of Kasson, Minnesota, as effectually as if it had originally been a part thereof.

Present and future owners of the area annexed by this ordinance are hereby notified that in addition to the usual assessments, it is the intention of the City Council to assess against said annexed property, all or a portion of the cost of any water lines, trunk line sanitary sewer, service connections and street construction, heretofore or thereafter undertaken to serve the area annexed.

Pursuant to Section 24-83 of the City of Kasson Zoning Code, the lands herein annexed to the City of Kasson, MN shall be designated as R-1 Single Family Residential.

The City Zoning Administrator is hereby directed to file certified copies of this ordinance with MN Planning, Canisteo Township, Dodge County Auditor and the Secretary of State.

Passed and adopted by the City Council of the City of Kasson, MN, this 28<sup>th</sup> day of August, 2002.

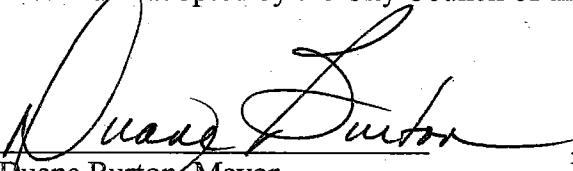
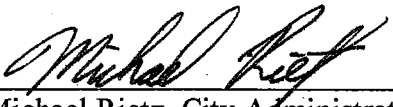
  
Duane Burton, Mayor  
Michael Rietz, City Administrator

Published in the Dodge County Independent this 18<sup>th</sup> day of September, 2002.

## CITY OF

OCT 09 2002

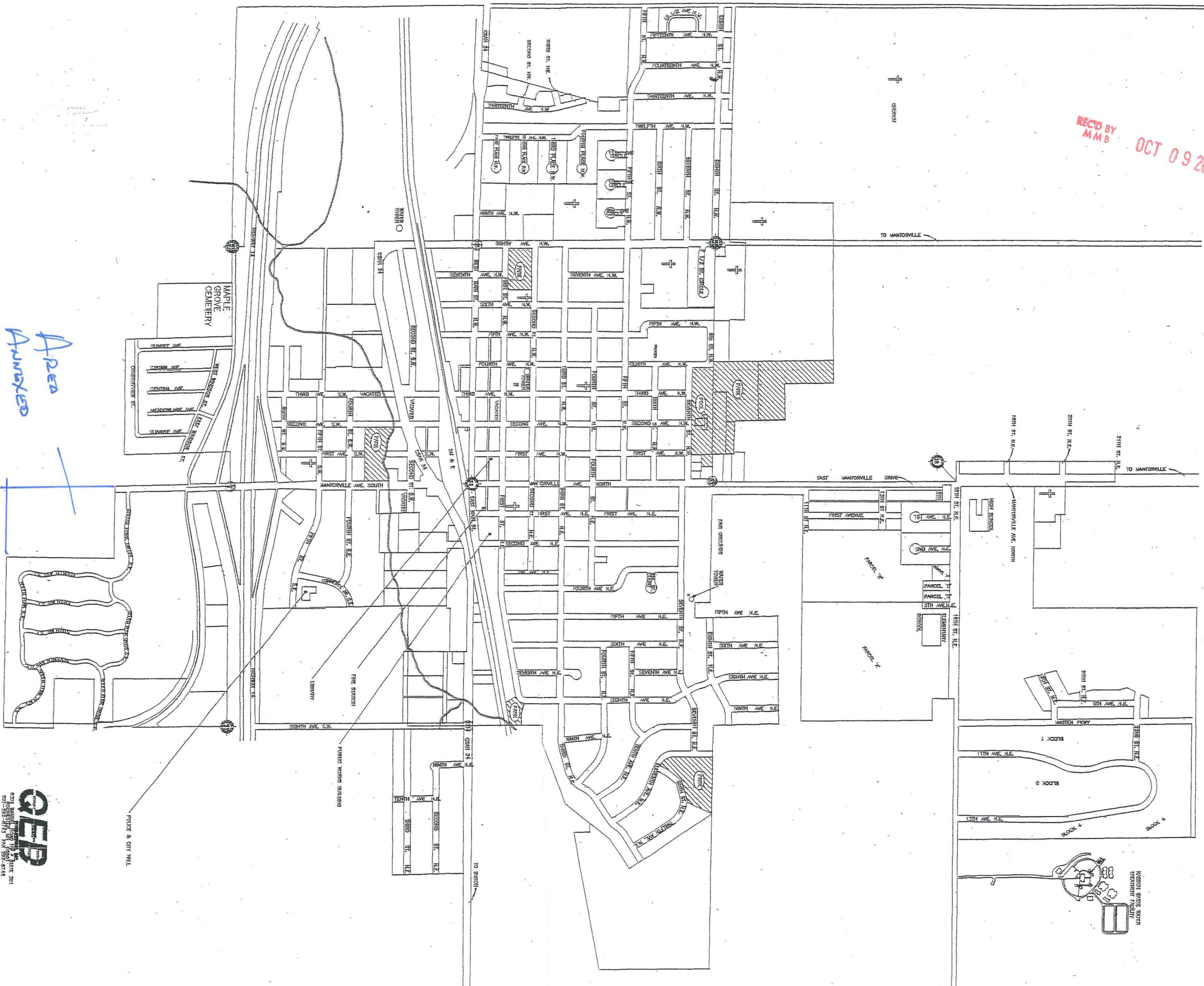

Area  
Annexed

**QEP**  
ENTER 12  
EXHIBIT 12  
FEBRUARY 12, 2001

6330 BUNNELL RD., SUITE 201  
ROCKHILL, MO 64085  
657-292-8743 FAX 657-8746

**BASE HAS LAST UPDATED: November 1, 2001**