

CITY OF NEW MARKET
SCOTT COUNTY, MINNESOTA

ORDINANCE NO. 152

**AN ORDINANCE EXTENDING THE CORPORATE LIMITS OF
THE CITY OF NEW MARKET TO INCLUDE CERTAIN
UNINCORPORATED LAND (60 ACRES OR LESS) ABUTTING
UPON THE CITY LIMITS**

"The Farm" - 45 acres

WHEREAS, a certain petition requesting annexation of the real property ("Subject Property") hereinafter described was duly presented to the council on the 7th day of July, 2002; and

WHEREAS, pursuant to Minn. Stat. § 414.033, subd. 2b, the New Market City Council has conducted a public hearing preceded by 30 days' written notice to consider the annexation petition.

WHEREAS, the petition was signed by all owners of the Subject Property ("Petitioner"); and

WHEREAS, the Subject Property is not presently within the corporate limits of any incorporated city; and

WHEREAS, the Subject Property abuts upon the city limits; and

WHEREAS, the Subject Property is 60 acres or less; and

WHEREAS, recent legislative changes have dissolved the Municipal Board and transferred its responsibilities to the Office of Strategic and Long-Range Planning. Throughout this Ordinance, reference continues to be made to the Municipal Board since the legislature has not yet modified Minnesota Statutes Chapter 414 to fully reflect the 1999 changes. In all respects, the use of the term Municipal Board and reference to Minn. Stat. Chapter 414 shall be read to apply to the Municipal Boundary Adjustment Division of the Office of Strategic and Long-Range Planning as the successor to the Municipal Board's responsibilities in administering the provisions of state law regarding orderly annexation agreements and to subsequent amendments to state law.

THE CITY COUNCIL OF THE CITY OF NEW MARKET ORDAINS:

Section 1. Validity of Petition. The City Council hereby finds (1) that the Subject Property abuts upon the city limits; and (2) the Subject Property is 60 acres or less; and (3) the Subject Property is not presently served by public sewer facilities or public sewer facilities are not otherwise available; and (4) the Subject Property is now or about to become urban or suburban in character.

Section 2. Subject Property Annexed. The corporate limits of the City of New Market are hereby extended to include the real property legally described in the attached Exhibit "A" now owned by Petitioner, and the same is hereby annexed to and included within the City as effectually as if it had originally been part of the City.

Section 3. Filing. The City Clerk is directed to file certified copies of this ordinance with the Secretary of State, the County Auditor, the Town Clerk of the affected township and the Municipal Board.

Section 4. Effective Date of Annexation. This ordinance takes effect upon its passage and publication and the filing of certified copies as directed in Section 3, and approval of this Ordinance by the Municipal Board.

ADOPTED this 7th day of July, 2002, by the City Council of the City of New Market.

CITY OF NEW MARKET

BY:

Jim Friedges
Jim Friedges, Mayor

ATTEST:

Jan Seykora
Jan Seykora, City Clerk

REC'D BY
MAB

SEP 19 2002

EXHIBIT "A"

Parcel 1:

The Southeast Quarter of the Southwest Quarter of Section 28, Township 113,
Range 21, Scott County, Minnesota

Parcel 2:

The East 5 acres of the South Half of the Northeast Quarter of the Southwest
Quarter of Section 28, Township 113, Range 21, Scott County, Minnesota

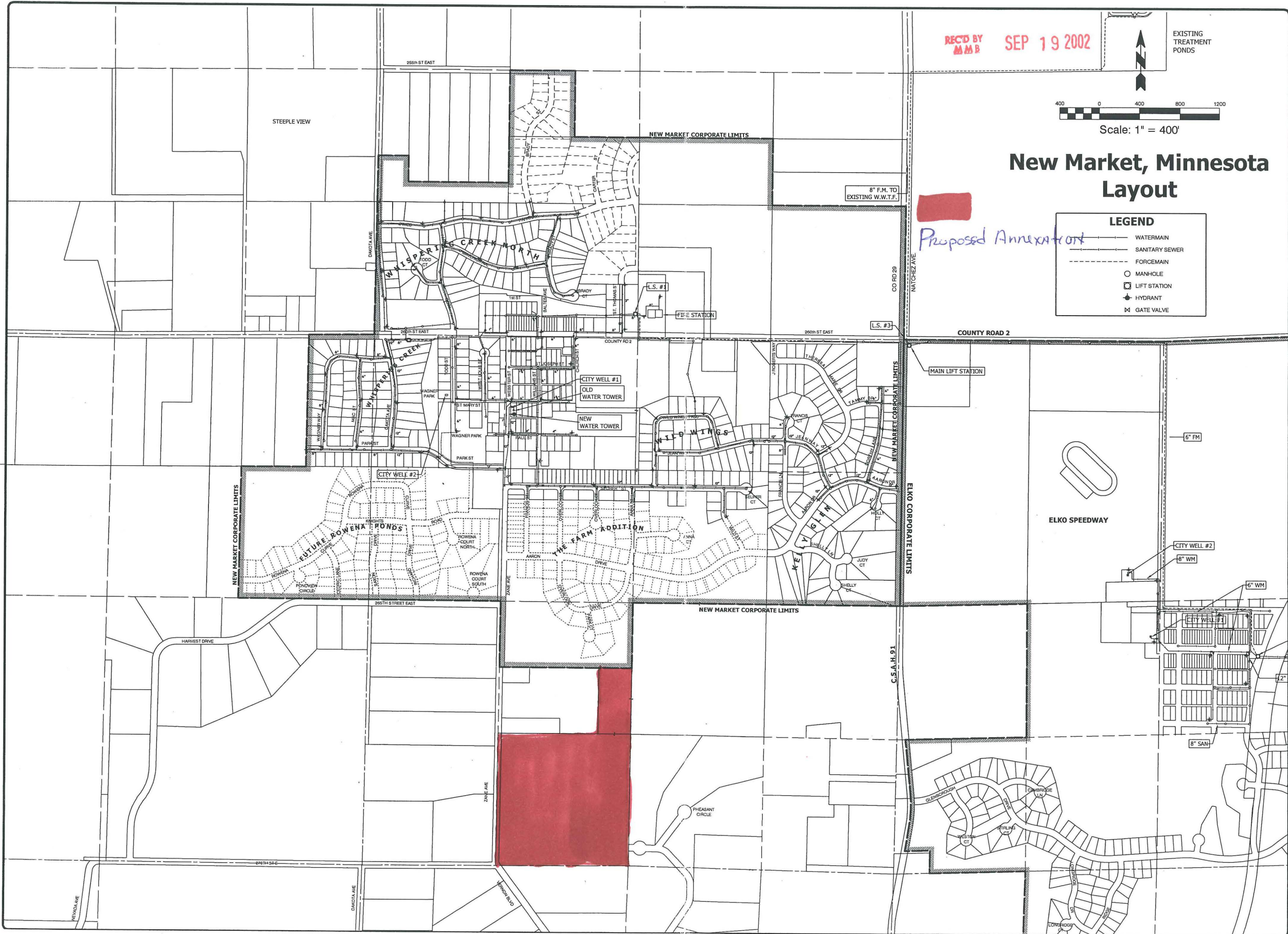

REC'D BY
MAM SEP 19 2002

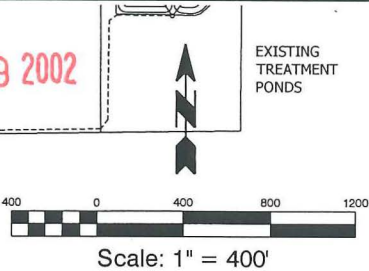

Scale: 1" = 400'

New Market, Minnesota Layout

Proposed Annexation

LEGEND	
	WATERMAIN
	SANITARY SEWER
	FORCEMAIN
	MANHOLE
	LIFT STATION
	HYDRANT
	GATE VALVE

Thatcher
ENGINEERS • SCIENTISTS • ARCHITECTS • PLANNERS

Authority: **New Market, MN**

Project Title: **Layout**

REVISIONS	
NO.	DATE
1	12/3/2001
2	9/3/2002
3	1/1/2003

Drawn: **EMS** Checked: **EMS**

Project No: **12/3/2001**

Vert. Scale: **1"=400'**

Horiz. Scale: **1"=400'**

Drawing: **OF**