

ORDINANCE NO. 3499

AN ORDINANCE ANNEXING TO THE CITY OF ROCHESTER APPROXIMATELY 1.5 ACRES OF LAND LOCATED IN A PART OF THE NORTHEAST QUARTER OF THE SOUTHWEST QUARTER OF SECTION 18, TOWNSHIP 106 NORTH, RANGE 13 WEST, OLMSTED COUNTY, MINNESOTA.

THE COMMON COUNCIL OF THE CITY OF ROCHESTER DO ORDAIN:

Section 1. A petition has been filed with the Common Council of the City of Rochester, signed by the owner of land described herein, requesting the Common Council to annex said land to the City of Rochester. The land described in the petition for annexation is described as follows:

That part of the Northeast Quarter of the Southwest Quarter of Section 18, Township 106 North, Range 13 West, Olmsted County, Minnesota, which lies westerly of the west line of Schoenfelder's Second Subdivision and Schoenfelder's Third Subdivision, Rochester, Minnesota.

Containing 1.5 acres more or less.

Section 2. The total quantity of land included in the petition is approximately 1.5 acres in size.

Section 3. On June 3, 2002, the Common Council held a public hearing to consider this annexation petition after providing written notice of the hearing, by certified mail, to the property owners, the Marion Township officers, and the adjacent property owners.

Section 4. The City provided notification to the petitioners pursuant to Minn. Stat. §414.033, subd. 2b, 11, 12 and 13 if applicable to this petitioned annexation.

Section 5. Following the public hearing, the Common Council of the City of Rochester determined that the land abuts the municipal limits, is less than 60 acres in area, the annexation petition is signed by all property owners of the land described in Section 1, and the land is or will soon become urban or suburban in character.

Section 6. Therefore, pursuant to Minn. Stat. §414.033, subd. 2(3), the land described in Section 1 above is hereby annexed, added to and made a part of the City of Rochester, Minnesota, as if it had originally been a part thereof.

Section 7. Present and future owners of the lands annexed by this ordinance are hereby notified that in addition to the usual assessments, it is the intention of the Common Council to assess against benefited property all or a portion of the cost of any storm sewer, water tower, pumping station, and trunk line sanitary sewer construction, heretofore or hereafter undertaken to serve the area annexed.

Section 8. This ordinance shall take effect and be in force from and after its official publication and from and after the filing of a certified copy hereof with the Minnesota State Planning Commission, the Marion Town Clerk, the County Auditor, and the Secretary of State.

PASSED AND ADOPTED BY THE COMMON COUNCIL OF THE CITY OF ROCHESTER, MINNESOTA, THIS 15th DAY OF July, 2002.

John Hanziker
PRESIDENT OF SAID COMMON COUNCIL

ATTEST: Judy Kay Shew
CITY CLERK

APPROVED THIS 16th DAY OF July, 2002.

G. Campbell
MAYOR OF SAID CITY

(Seal of the City of Rochester, Minnesota)

ANNEXATION EXHIBIT

DESCRIPTION:
SEE ATTACHED



SCALE 1" = 600'

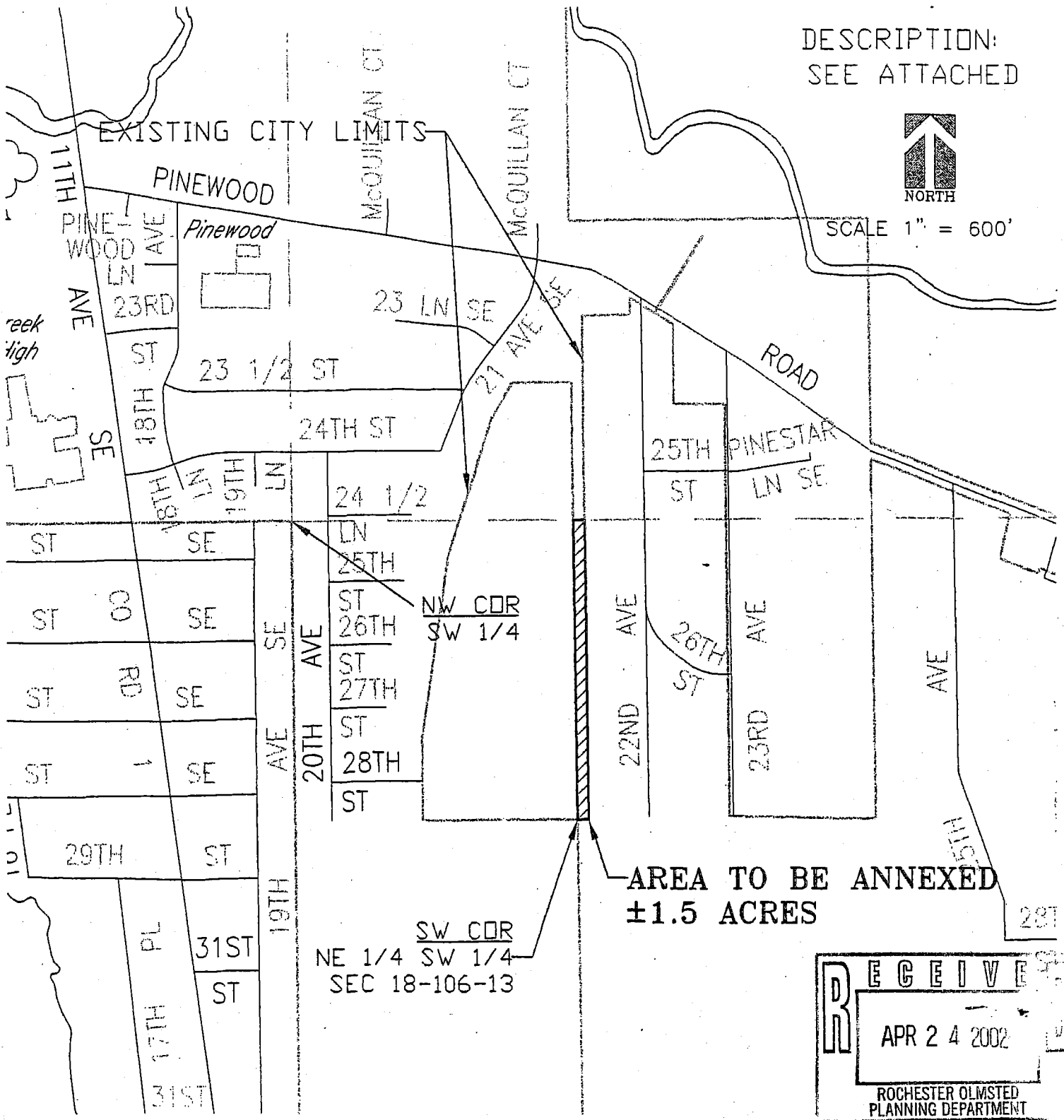

RECEIVED
APR 24 2002
ROCHESTER OLNSTED
PLANNING DEPARTMENT

FDR :
HAWK RIDGE DEVELOPMENT, LLC
706 CTY RD 3 NW
BYRON, MN
55920

Land Surveying
Urban-Land
Planning
Consulting - Civil
Engineering
1848 Third Avenue S.E.
Rochester, MN 55904
Telephone 507.288.3910
Facsimile 507.288.7302

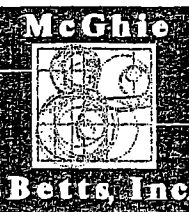

Geotechnical
Engineering
Construction Material
Testing
Landscape
Architecture
email:
mbl@mglobeta.com

SCALE: 1" = 600'
DRAWN BY: JJJ
DATE: 11/08/01
ACCT. NO.: 1111/1531 Cadd No. 1531ANNE
FILE NO.: BK. PG.