

**CITY OF MONTROSE
COUNTY OF WRIGHT
STATE OF MINNESOTA**

ORDINANCE NO. 2001-01

**AN ORDINANCE ANNEXING LAND LYING NORTH OF THE EXISTING
CITY LIMITS OF THE CITY OF MONTROSE, WRIGHT COUNTY,
MINNESOTA, PURSUANT TO MINNESOTA STATUTES 414.033,
SUBDIVISION 2(3), PERMITTING ANNEXATION BY ORDINANCE**

**THE CITY COUNCIL OF THE CITY OF MONTROSE ORDAINS AS
FOLLOWS:**

Section 1. That the unincorporated land located North of the existing City limits, as legally described on attached Exhibit A, which is herein incorporated by reference, abuts upon the limits of the City of Montrose, is not now included within the limits of any City, is 60 acres or less in size, is or is about to become urban or suburban in character, is not presently served by public sewer or water facilities, and 100% of all the owners of property in the area described have signed a petition requesting that the property be annexed to the City of Montrose.

Section 2. That the corporate limits of the City of Montrose are hereby extended to include the platted land described below, said property containing fifty eight and one half (58.5) acres, more or less.

Section 3. The City Clerk is hereby directed to file certified copies of this ordinance with Minnesota State Planning, Boundary Adjustment Division, the Minnesota Secretary of State, the Marysville Town Clerk, and the Wright County Auditor.

ADOPTED by the City Council of the City of Montrose this 12th day of March, 2001.

IN FAVOR:

Nelson, Block, Mattson, Nordschow, Petersen

OPPOSED:

None

CITY OF MONTROSE

Charles Nelson, Mayor



Barbara Swanson, City Clerk

EXHIBIT A

PARCEL B

The east 1267 feet of the Southeast Quarter of the Northeast Quarter of Section 35, Township 119, Range 26, Wright County, Minnesota, except therefrom the following:

That part of the Southeast Quarter of the Northeast Quarter of Section 35, Township 119, Range 26, described as follows: Beginning at the northeast corner of said Southeast Quarter of the Northeast Quarter; thence on an assumed bearing of South 01°02'40" East along the east line of said Southeast Quarter of the Northeast Quarter, a distance of 538.50 feet; thence North 83°20'14" West, a distance of 688.45 feet; thence North 44°37'38" West a distance of 41.46 feet; thence North 21°49'51" West a distance of 245.27 feet; thence North 45°54'48" West, a distance of 322.36 feet to the north line of said Southeast Quarter of the Northeast Quarter; thence South 88°43'08" East, along said north line a distance of 1026.12 feet to the point of beginning.

Subject to the right of way of Wright County Highway No. 12 over the east 33.00 feet thereof, lying parallel with and adjoining the east line of said Southeast Quarter of the Northeast Quarter. Subject to a blanket utility easement per Doc. No. 161538, Book 3 of Misc. page 548.

and

The Northeast Quarter of the Northeast Quarter of Section 35, Township 119, Range 26, Wright County, Minnesota.

EXCEPT THEREFROM:

Plat of Sunny Acres Addition;

ALSO EXCEPT:

The north 150.00 feet of the east 323.40 feet thereof, as measured along the north and east lines of the Northeast Quarter of the Northeast Quarter of Section 35, Township 119, Range 26;

ALSO EXCEPT:

That part of the north 300.00 feet lying west of the east 821.72 feet thereof, as measured along the north and east lines of the Northeast Quarter of the Northeast Quarter of Section 35, Township 119, Range 26;

ALSO EXCEPT:

That part of the Northeast Quarter of the Northeast Quarter of Section 35, Township 119, Range 26, described as follows: Beginning at a point on the east line of said Northeast Quarter of the Northeast Quarter 469.0 feet south of the northeast corner thereof; thence west at a right angle to said east line, 290.0 feet; thence south at a right angle, 180.0 feet; thence east at a right angle, 290.0 feet to the east line of said Northeast Quarter of the Northeast Quarter; thence north along said east line, 180.0 feet to the point of beginning.

ALSO EXCEPT:

That part of the Northeast Quarter of the Northeast Quarter of Section 35, Township 119, Range 26, Wright County, Minnesota, described as follows: Commencing at the northeast corner of said Northeast Quarter of the Northeast Quarter; thence on an assumed bearing of South 00 degrees 00 minutes 00 seconds West along the east line of said Northeast Quarter of the Northeast Quarter, a distance of 318.79 feet to the point of beginning; thence continue South 00 degrees 00 minutes 00 seconds West along said east line, a distance of 150.21 feet; thence North 90 degrees 00 minutes 00 seconds West, 290.00 feet; thence North 00 degrees 00 minutes 00 seconds East, a distance of 150.21 feet; thence South 90 degrees 00 minutes 00 seconds East, a distance of 290.00 feet to the point of beginning.

Subject to the right of way of Wright County Highway No. 12.

Containing 58.50 acres. (57.76 not including Co. Highway 12 R.O.W.)

EXHIBIT A-2

REC'D. BY
MAR 16 2001
MME

NORTH

County Road No. 12

CITY LIMITS
CITY OF MONTROSE CORPORATE BOUNDARY

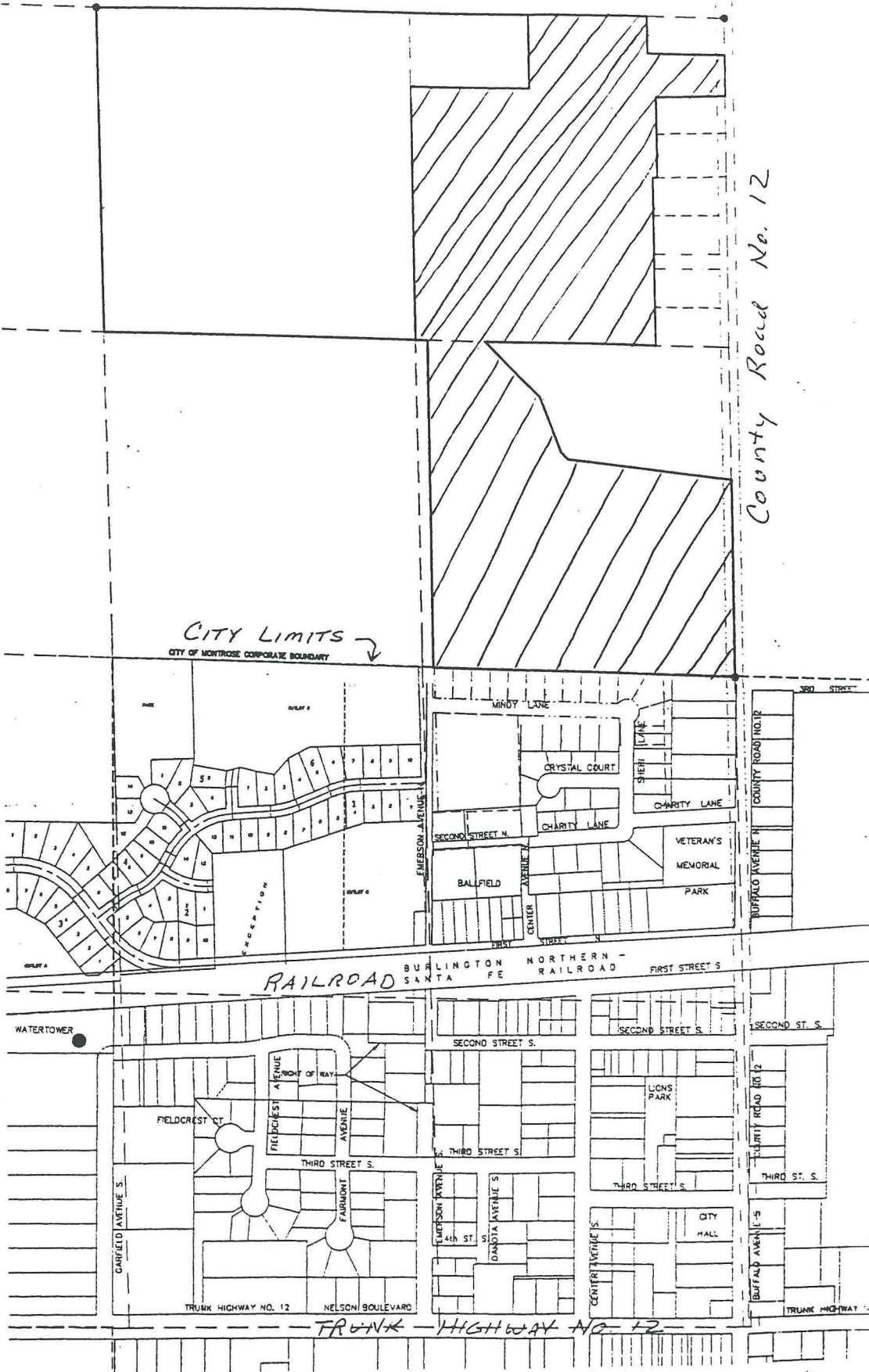

EXHIBIT A-1

