

**City of Zumbrota  
Ordinance No. 2000-02**

**AN ORDINANCE EXTENDING THE CORPORATE LIMITS OF THE CITY OF ZUMBROTA TO INCLUDE CERTAIN UNPLATTED LANDS ABUTTING UPON THE CITY LIMITS AND DESIGNATING SUCH LANDS AS R-1, SINGLE FAMILY RESIDENTIAL; PURSUANT TO MINNESOTA STATUTES SECTION 414.033, SUBDIVISION 2(3), ANNEXATION BY ORDINANCE**

**WHEREAS**, Dorothea Trelstad presented a Petition for Annexation dated April 19, 2000 to the Zumbrota City Council; and

**WHEREAS**, the quantity of land described within the Petition, and attached hereto as Exhibit A, is approximately 47 acres, is unincorporated property, and said Petition was signed by all owners who have also waived the provisions of Minnesota Statutes Section 414.033, Subd. 13; and

**WHEREAS**, a public hearing was duly conducted by the Zumbrota City Council on June 22, 2000; and

**WHEREAS**, all towns affected by the annexation and all land owners within and contiguous to the land to be annexed were provided 30 days written notice by certified mail of the hearing on the Petition; and

**WHEREAS**, the land described in the Petition abuts upon the City limits at the eastern boundary thereof and is urban or suburban in character or about to become so; and

**WHEREAS**, none of the land described in the Petition is presently served by public sewer facilities, and public sewer facilities are not otherwise available; and

**WHEREAS**, the nature of the land described in the Petition, and its best use, is consistent with a zoning designation of R-1, Single Family Residential.

**NOW, THEREFORE**, the City of Zumbrota does hereby ordain as follows:

1. The City Council hereby determines that the annexation will be in the best interests of the City and of the land affected; that the land described herein abuts upon the City limits, is urban or suburban in character, and that none of the said land is now included within the limits of any city, and does not abut upon the limits of any other city.
2. Pursuant to Minnesota Statutes Section 414.033, Subdivision 2(3) (Annexation by Ordinance) the corporate limits of the City of Zumbrota are hereby extended to include the unplatted lands described as follows:

See attached Exhibit A

and the same is hereby annexed to and included within the City of Zumbrota with the effect as if it had originally been a part thereof.

3. The land described in attached Exhibit A is to be zoned R-1, Single Family Residential.
4. The City Administrator is directed to file certified copies of this Ordinance with the director of the Minnesota Office of Strategic and Long-Range Planning (successor to the Minnesota Municipal Board), the Secretary of State, the Zumbrota Township Board, and the Goodhue County Auditor.
5. This Ordinance takes effect upon its passage and publication and the filing of certified copies as directed in Section 4 above and upon the approval of the Minnesota Office of Strategic and Long-Range Planning.

Passed and adopted by the City Council for the City of Zumbrota, Minnesota on this 22<sup>nd</sup> day of June, 2000.



Richard Bauer  
Mayor

Attest:   
Ronald S. Johnson  
City Administrator

## EXHIBIT A

That part of the West Half of the Southeast Quarter of Section 31, Township 110 North, Range 15 West, Goodhue County, Minnesota, lying north of the centerline of the St. Paul and Rochester Road and lying west of the following described line: commencing at a point on the north line of the Southeast Quarter of said Section 31 at a distance of 1170 feet east from the northwest corner of said Southeast Quarter; thence southerly to a point on the south line of said Southeast Quarter at a distance of 1275 feet east from the southwest corner of said Southeast Quarter and there terminating.

## EXCEPT:

That part of the northwest quarter (NW 1/4) of the southeast quarter (SE 1/4) of said section 31, described as follows:

From a point 1107 feet north of the southwest corner of SE 1/4 of said section 31, run south 55°45' east 112 feet, thence north 26°15' east 446.9 feet for the Place of Beginning of premises to be described; running thence north 26°15' east 89.1 feet, thence due north 80 feet, thence due west 160 feet, thence due south 160 feet, thence east 119.8 feet to the Place of Beginning.

## ALSO EXCEPTING:

That part of the SE 1/4 of section 31, township 110 north, range 15 west, Goodhue County, Minnesota, described as follows: Beginning at a point 1449.78 feet North and 176.56 feet East of the Southwest corner of said SE 1/4, said point also being the Southwest corner of that parcel of land deeded to the Village of Zumbrota and recorded in Book I-9 of Deeds, page 236, filed and of record in the office of the Register of Deeds, Goodhue County, Minnesota; thence North 90°00'00" East, 119.80 feet; thence North 26°15'00 " East, 89.10 feet; thence North 0°00'00", a distance of 80.00 feet; thence North 90°00'00" East, 294.81 feet; thence South 0°00'00", a distance of 1102.14 feet to a point in the center line of the St. Paul and Rochester Road as the same is now laid out and traveled; thence northwesterly along said Road center line as the same is now laid out and traveled on the following five courses: North 44°08'09" West, 409.49 feet; thence North 45°13'22" West, 223.92 feet; thence North 48°31'51" West, 84.20 feet; thence North 52°11'52" West, 83.14 feet; thence North 55°00'39" West, about 37.83 feet to a point in a line parallel with and 16.00 feet easterly from the West line of said SE 1/4; thence northerly along said parallel line, about 362.37 feet to a point North 90°00'00" West from said point of beginning; thence North 90°00'00" East, about 160.56 feet to said point of beginning; containing 10.00 acres, more or less, including said Road right of way, and containing 9.365 acres, more or less, excluding said Road right of way.



MBA Docket No. A-6342 Zumbrota

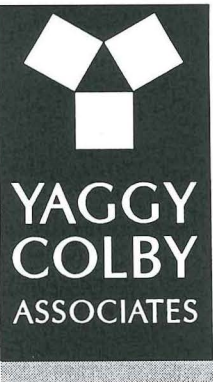

ENGINEERS  
ARCHITECTS  
SURVEYORS  
PLANNERS  
LANDSCAPE ARCHITECTS

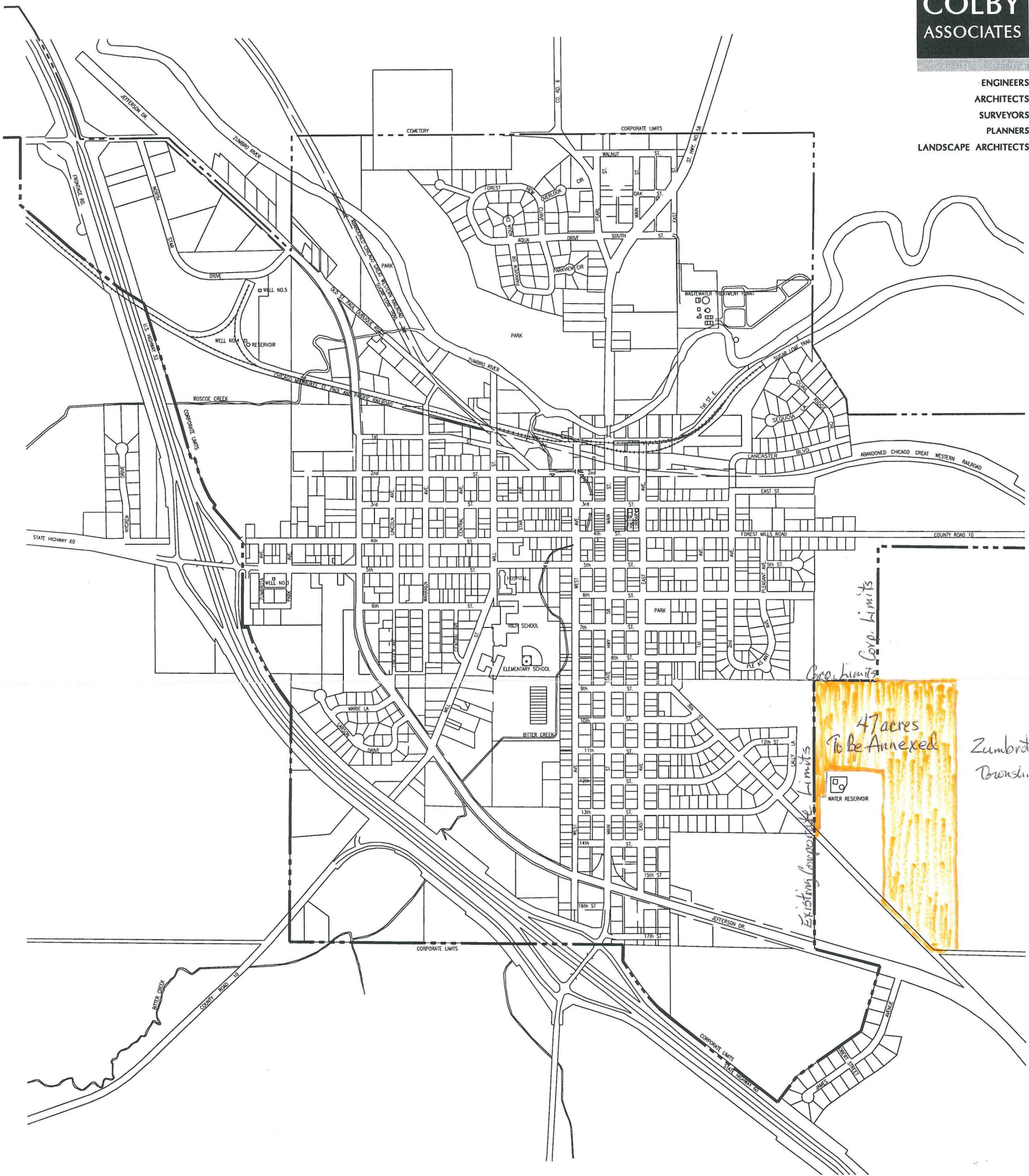

REC'D. BY JUL 21 2000  
M.M.B.

Zumbrota  
Township



SITE LOCATION MAP

CITY OF ZUMBROTA, MN

