

**Petition for Annexation of Platted Land or Unplatted Land of 200 Acres or Less
Minnesota Statutes, Section 414.033 Subd. 2**

To: Common Council
City Hall
201 4th St. SE
Rochester, MN 55904

RECD BY OCT 15 1999
MAY 11

The undersigned being (all) (a majority) of the owners in number of the land hereinafter described which abuts the city of Rochester, petition the Common Council to annex said land to the City of Rochester: **(If more space is needed, attach additional sheet)**

Description:

See attached description

Reason for Annexation:

The annexation is requested to allow for the development of multi-family housing within Rochester City Limits.

Total Number of Owners: ("Owners " include each fee holder, contract for deed purchaser, joint tenant, and tenant in common): 2

Area of Land to be Annexed in Acres: Platted: _____ Unplatted: 89.38 Total _____

Existing Population of Area to be Annexed: 0

IN WITNESS WHEREOF we have subscribed to this petition of this 8TH day of JULY, 19 99.

Respectfully submitted, (Additional names may be put on attached sheet if necessary)

[Signature] White Oaks Development of Rochester, Inc.
(Owner) (Address) 1201 Meadowlark Court SW
Rochester, MN 55902

[Signature]
(Owner) (Address)

Distribution:

City Clerk (white copy)
Consolidated Planning Department (canary copy)
Township Board (blue copy)
Olmsted County Board (green copy)
Minnesota Municipal Commission (pink copy)
Petitioner goldenrod copy)

**Annexation: Form Number 1
Petition for Annexation**

CITY OF ROCHESTER, MINNESOTA
AFFIDAVIT OF FILING PETITION FOR ANNEXATION

REC'D BY OCT 15 1999
M.A.P.

STATE OF MINNESOTA)
)ss.

COUNTY OF Olmsted)

White Oaks Development of Rock of the City of Rochester

(Name of Petitioner)

(Township or City)

(Name of Twp. or City)

County of Olmsted in the State of Minnesota, being duly sworn,
(Name of County)

says that on the 6TH day of JULY, 19 99, he served a
(Date) (Month)

copy of the attached petition to annex land to the City of Rochester, Minnesota on the Town Board
of Cascade, Olmsted County, Minnesota, the County Board of Olmsted
(Name of Township)

County, Minnesota, the County Board of Olmsted County, Minnesota and the Minnesota Municipal
Commission by mailing a copy of said petition together with a letter of transmittal, enclosed in an
envelope and by depositing the same in the Post Office at Rochester, Minnesota, directed to the
following:

Town Board of
Cascade Township
c/o Joe Vroman, Town Clerk
411 Lowry Court NW
Rochester, Minnesota

Olmsted County Board of Commissioners
Olmsted County Government Center
151 4th St. SE
Rochester, MN 55904

Subscribed and sworn to before me
this 6 day of July, 19 99

Minnesota Municipal Board
Suite 225 Bandana Square
1021 Bandana Blvd East
St. Paul, MN 55108

Notary Public Dorthe Co., Minn.
My Commission expires 1312000

DISTRIBUTION:

City Clerk (white copy)
Consolidated Planning Department (canary copy)
Minnesota Municipal Commission (pink copy)
Petitioner (goldenrod copy)

Annexation: FORM NO. 1d
Affidavit of Filing Petition for Annexation

[Signature]
Affiant

CITY OF ROCHESTER, MINNESOTA

DATE: JULY 9, 1999

Minnesota Municipal Board
Suite 225 Bandana Square
1021 Bandana Blvd. East
St. Paul, MN 55108

RE: Transmittal of a Copy of a Petition to Annex Land to the City of Rochester,
Minnesota

Gentlemen:

Enclosed herewith and served upon the Minnesota Municipal Commissioner is a copy of a petition dated JULY 9, 19 99 for the annexation to the City of Rochester, Minnesota of land in Cascade Township, County of Olmsted, Minnesota.

This petition has been filed with the City Clerk of the City of Rochester, Minnesota, on JULY 9, 19 99, and is being filed with the Town Board of Cascade Township, the County Board of Olmsted County and the Minnesota Municipal Commission in accordance with the provisions of Minnesota Statutes, Section 414.033, Subdivision 2. Affidavits of filing of copies of said petition on the Town Board and County Board are also enclosed.

Very truly yours,

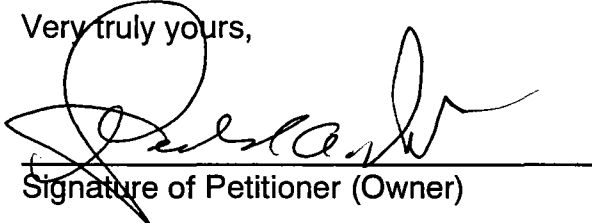
Signature of Petitioner (Owner)

Address of Petitioner:

1201 Meadowlark Court SW
Street

Rochester, MN 55902
City State

Signature of Petitioner

Address of Petitioner:

4005-75th St. N.W.
Street

Orono, Mn 55960
City State

Distribution:

Minnesota Municipal Board (pink copy)
Petitioner (goldenrod copy)

Annexation: FORM NO. 1c

Letter of Transmittal to Minnesota Municipal Board

McGhie
Consulting Engineers

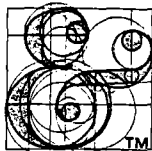

Betts, Inc.
Land Surveyors

Planners

1648 Third Avenue S.E., Rochester, MN 55904

507-289-3919

Fax 289-7333

1604 Riverview Lane, Northfield, MN 55057

507-645-0964

Fax 645-2842

ANNEXATION DESCRIPTION (provided by owner)

FOR: WHITE OAKS DEVELOPMENT INC.

DATE: JULY 6, 1999

Commencing at a point on the East line of Section seven (7) in Township one hundred and seven (107) North of Range fourteen (14) West six hundred nineteen (619) feet south of the North East corner of the South half (1/2) of the North east quarter (1/4) of said Section seven (7); thence running West parallel with the North line of said Section to the right-of-way of the Chicago and Northwestern Railway Company as now located across said land, thence running South East along said right of way to the South line of the NE1/4 of the SE1/4; thence East to the Section line; thence running North along the East line of said Section to the place of beginning, containing eighty-one and forty-six one hundredths (81 46/100) acres more or less.

A strip of land one hundred (100) feet wide comprising all that part of the South half of the Southeast quarter of the Northwest Quarter, and of the South half of the Southwest quarter of the Northeast quarter and of the North half of the Southeast quarter of Section seven (7), Township One Hundred Seven (107) North, Range Fourteen (14) West which is included between two parallel lines, one of which is distant fifty (50) feet at right angles, Northeasterly and the other being distant fifty (50) feet, at right angles, Southwesterly from the center line of the original main track of the Chicago and North Western Railway Company (formerly Rochester and Northern Minnesota Railway Company) as said main track was originally located and constructed. Containing seven and Ninety-two hundredths (7.92) acres more or less.

S:\MBI Documents\1112C\8216\annexation.desc.wpd

K. M. McGhie, P.E., L.S. 1904-1975
Douglas N. Betts, P.E., L.S. Vice President
Mark E. Severtson, L.S.

William E. Tointon, C.E.T. President
Andrew J. Masterpole, ASLA

James E. Swanson, L.S. Vice President
Larry J. Shannon, L.S.

David L. Morrill, P.E. Vice President
Michael E. Gowin, P.E., L.S.
Daniel J. Zemke, P.E.

An Equal Opportunity Employer

OCT 15 1958

55TH ST NW

CADD NO. : 8387EX01

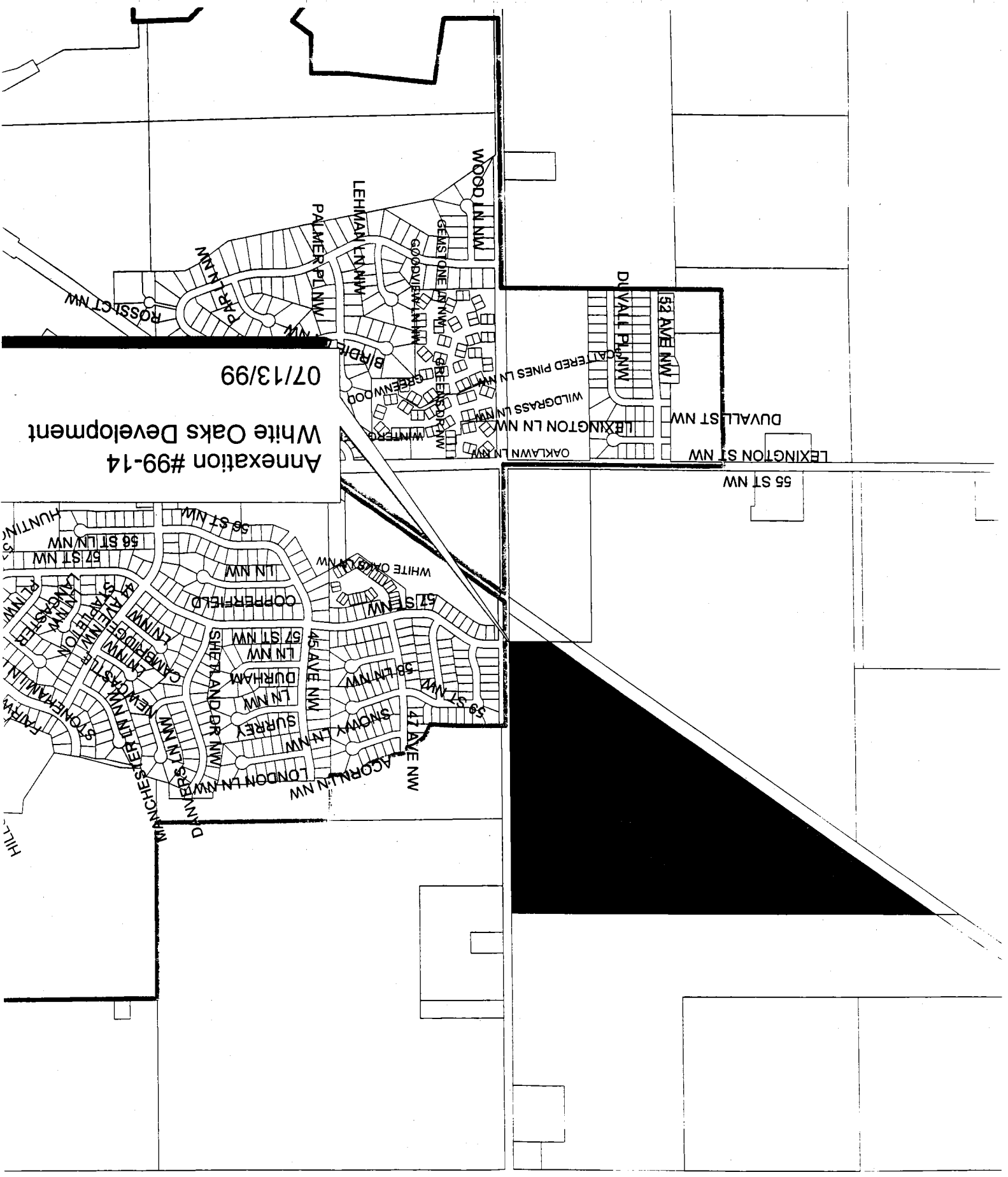

65 ST NW

07/13/99