

CITY OF WACONIA  
ORDINANCE NO. 523

REC'D. BY OCT 25 2000  
MMB

AN ORDINANCE ANNEXING CERTAIN LANDS INTO THE CORPORATE LIMITS  
OF THE CITY OF WACONIA, MINNESOTA (KLEIN and TRUMPY)

WHEREAS, The City of Waconia adopted Resolution No. 99-89, Resolution As to Petition for Annexation, on July 6, 1999, accepting a petition submitted by Trumpy Land Development, Inc. to annex certain lands into the corporate limits of the City of Waconia, Minnesota and has been assigned Docket No. A-6122 by Minnesota Planning; and

WHEREAS, The City of Waconia adopted Resolution No. 99-105, Resolution as to Petition for Annexation, on August 2, 1999, accepting a petition submitted by Marcella Klein to annex certain lands into the corporate limits of the City of Waconia, Minnesota and has been assigned Docket No. A-6132 by Minnesota Planning; and

WHEREAS, Posted, published and written notice has been provided to Waconia Township and all landowners within and contiguous to the area to be annexed; and

WHEREAS, The City Council of the City of Waconia adopted Resolution No. 2000-110, Approving an Annexation Agreement with Waconia Township related to the Klein and Trumpy Parcels on July 3, 2000; and

WHEREAS, Said annexation of said lands is consistent with the City of Waconia's Comprehensive Plan.

NOW, THEREFORE, THE CITY COUNCIL OF THE CITY OF WACONIA, CARVER COUNTY, MINNESOTA, DOES HEREBY ORDAIN:

**SECTION 1. Declaration.** It is hereby determined that the annexation of lands described in Section 2 below would be in the best interest of the City of Waconia.

**SECTION 2. Territory Annexed.** The corporate limits of the City of Waconia are hereby extended to encompass and embrace all of the territory described as follows and said land is hereby annexed to and included within the City as effectually as if it had originally been a part thereof:

See Attached Legal Descriptions

**SECTION 3. Filing.** The City Clerk is hereby directed to file certified copies of this Ordinance with the Minnesota Planning Board of the State of Minnesota, the Secretary of State, and the County Auditor of Carver County as required by law.

**SECTION 4. Effective Date of Annexation.** This Ordinance takes effect upon its passage and publication and the filing of certified copies as directed in Section 3 and shall be deemed final upon approval of this Ordinance by the Minnesota Planning Board of the State of Minnesota.

Adopted by the City Council of the City of Waconia this 16<sup>th</sup> day of October, 2000.

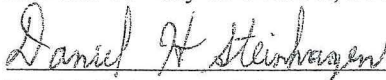
  
Daniel Steinhagen, Mayor

ATTEST:   
Mary J. Johnson, CMC, City Clerk

M/	Schiffman	Steinhagen	Aye
		D. Johnson	Aye
S/	Hilgers	Hilgers	Aye
		Schultz	Absent
		Schiffman	Aye

Ordinance No. 523  
Exhibit A

REC'D. BY OCT 25 2000  
MMB

Trumpy Parcel, Docket A-6122, 78 acres, more or less:

The South Half of the Northwest Quarter of Section 26, Township 116 North, Range 25 West, Except thereof the South 400 feet of the West 300 feet of said South Half of the Northwest Quarter of Section 26.

Klein Parcel, Docket A-6132, 72.31 acres, more or less:

That part of the Northeast Quarter of Section 27, Township 116, Range 25, Carver County, Minnesota, described as follows: Commencing at the southwest corner of said Northeast Quarter; thence on an assumed bearing of North 90 degrees 00 minutes 00 seconds East along the south line of said Northeast Quarter a distance of 462.60 feet to the point of beginning of the land to be described; thence North 90 degrees 00 minutes 00 seconds East along said south line a distance of 1497.25 feet to the west line of the East 726.00 feet of said Northeast Quarter; thence North 00 degrees 22 minutes 36 seconds East along said west line a distance of 300.01 feet to the north line of the south 300.00 feet of said Northeast Quarter; thence North 90 degrees 00 minutes 00 seconds East along said north line a distance of 726.02 feet to the east line of said Northeast Quarter; thence North 00 degrees 22 minutes 36 seconds East along said east line a distance of 1196.86 feet to a point distant 1147.43 feet south of the northeast corner of said Northeast Quarter, as measured along said east line; thence North 89 degrees 07 minutes 14 seconds West a distance of 990.18 feet; thence North 00 degrees 13 minutes 56 seconds East along a line parallel to the west line of said Northeast Quarter a distance of 364.98 feet; thence South 60 degrees 07 minutes 15 seconds West a distance of 1429.87 feet to a point on a line parallel to the west line of said Northeast Quarter passing through the point of beginning, distant 1164.70 feet north of said point of beginning as measured along said line; thence South 00 degrees 13 minutes 56 seconds West, along said parallel line, a distance of 1164.70 feet to the point of beginning.

Subject to easement for Town Road over the easterly 33 feet of the above described real property pursuant to Town Road dated October 14, 1985, recorded October 30, 1985, as Document No. 74263.



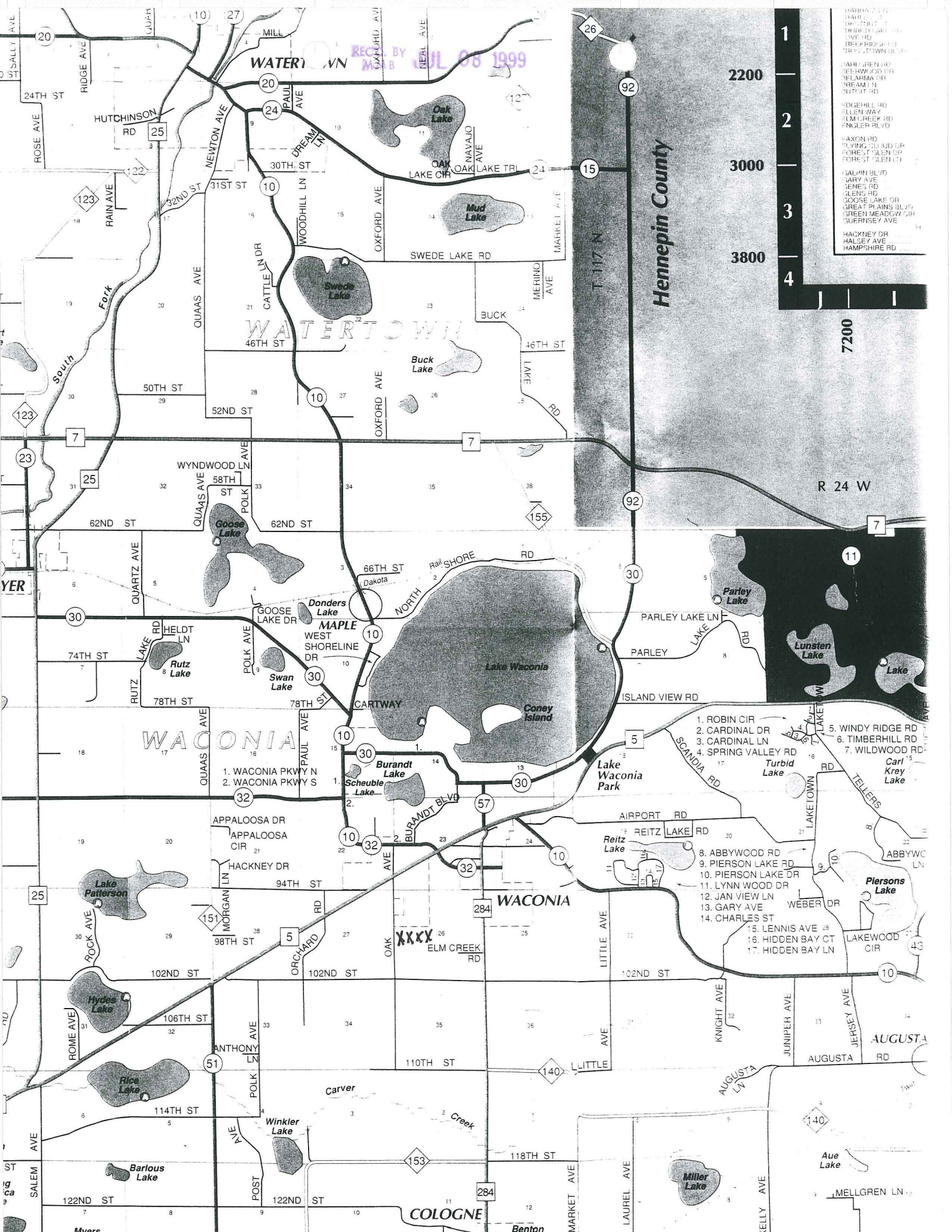

RECORDED BY MAPS JUL 08 1999

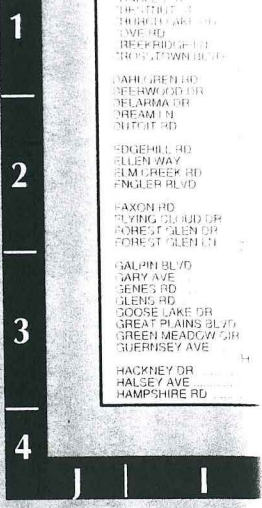

- 1. WILSON RD
- 2. WILSON RD
- 3. WILSON RD
- 4. WILSON RD
- 5. WILSON RD
- 6. WILSON RD
- 7. WILSON RD
- 8. WILSON RD
- 9. WILSON RD
- 10. WILSON RD
- 11. WILSON RD
- 12. WILSON RD
- 13. WILSON RD
- 14. WILSON RD
- 15. WILSON RD
- 16. WILSON RD
- 17. WILSON RD
- 18. WILSON RD
- 19. WILSON RD
- 20. WILSON RD
- 21. WILSON RD
- 22. WILSON RD
- 23. WILSON RD
- 24. WILSON RD
- 25. WILSON RD
- 26. WILSON RD
- 27. WILSON RD
- 28. WILSON RD
- 29. WILSON RD
- 30. WILSON RD
- 31. WILSON RD
- 32. WILSON RD
- 33. WILSON RD
- 34. WILSON RD
- 35. WILSON RD
- 36. WILSON RD
- 37. WILSON RD
- 38. WILSON RD
- 39. WILSON RD
- 40. WILSON RD
- 41. WILSON RD
- 42. WILSON RD
- 43. WILSON RD
- 44. WILSON RD
- 45. WILSON RD
- 46. WILSON RD
- 47. WILSON RD
- 48. WILSON RD
- 49. WILSON RD
- 50. WILSON RD
- 51. WILSON RD
- 52. WILSON RD
- 53. WILSON RD
- 54. WILSON RD
- 55. WILSON RD
- 56. WILSON RD
- 57. WILSON RD
- 58. WILSON RD
- 59. WILSON RD
- 60. WILSON RD
- 61. WILSON RD
- 62. WILSON RD
- 63. WILSON RD
- 64. WILSON RD
- 65. WILSON RD
- 66. WILSON RD
- 67. WILSON RD
- 68. WILSON RD
- 69. WILSON RD
- 70. WILSON RD
- 71. WILSON RD
- 72. WILSON RD
- 73. WILSON RD
- 74. WILSON RD
- 75. WILSON RD
- 76. WILSON RD
- 77. WILSON RD
- 78. WILSON RD
- 79. WILSON RD
- 80. WILSON RD
- 81. WILSON RD
- 82. WILSON RD
- 83. WILSON RD
- 84. WILSON RD
- 85. WILSON RD
- 86. WILSON RD
- 87. WILSON RD
- 88. WILSON RD
- 89. WILSON RD
- 90. WILSON RD
- 91. WILSON RD
- 92. WILSON RD
- 93. WILSON RD
- 94. WILSON RD
- 95. WILSON RD
- 96. WILSON RD
- 97. WILSON RD
- 98. WILSON RD
- 99. WILSON RD
- 100. WILSON RD

- 1. ROBIN CIR
- 2. CARDINAL DR
- 3. CARDINAL LN
- 4. SPRING VALLEY RD
- 5. WINDY RIDGE RD
- 6. TIMBERHILL RD
- 7. WILLOWOOD RD
- 8. ABBYWOOD RD
- 9. PIERSON LAKE DR
- 10. PIERSON LAKE DR
- 11. LYNN WOOD DR
- 12. JAN VIEW LN
- 13. GARY AVE
- 14. CHARLES ST
- 15. LENNIS AVE
- 16. HIDDEN BAY CT
- 17. HIDDEN BAY LN



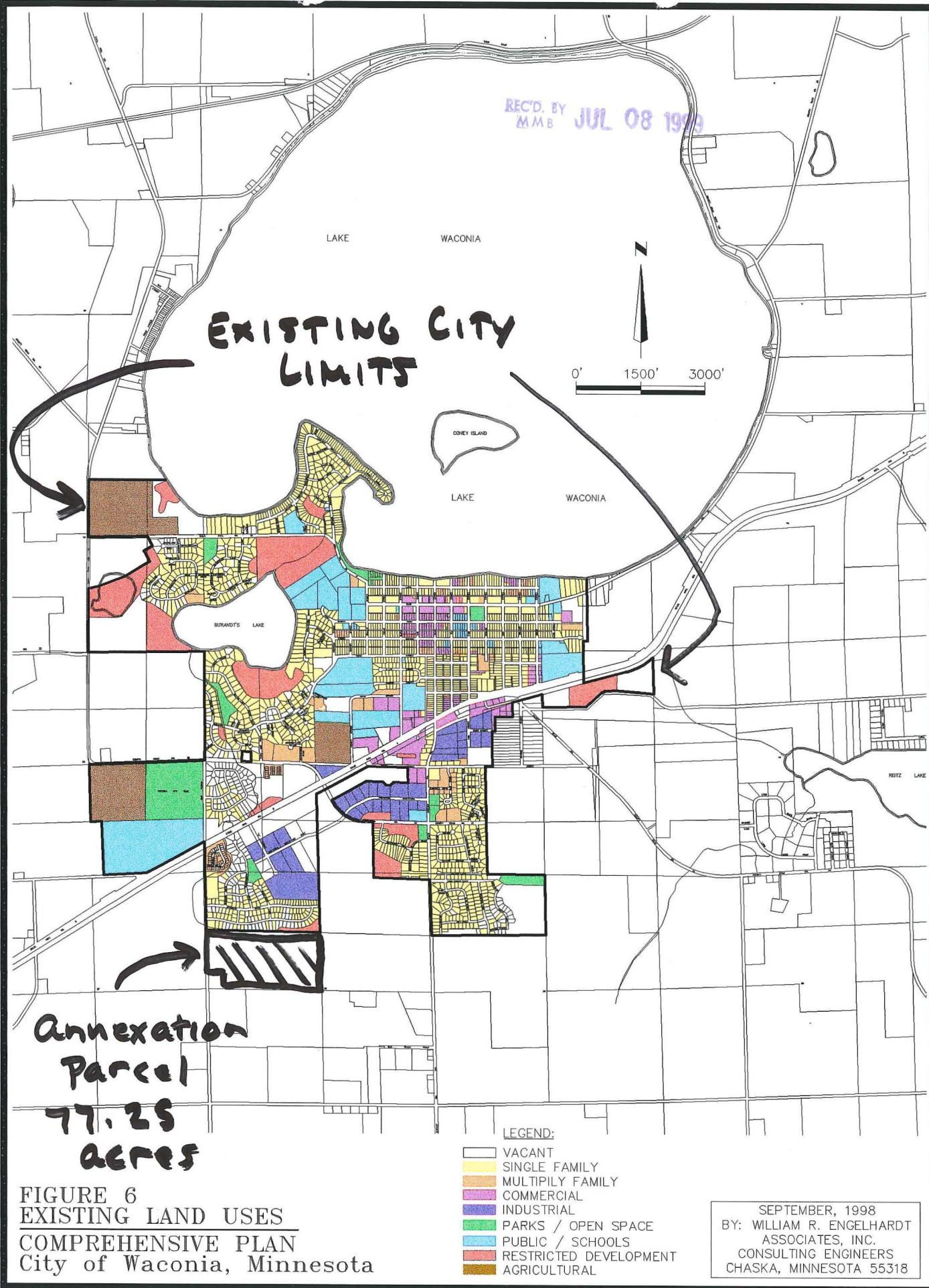



REC'D. BY JUL 08 1999  
MAM

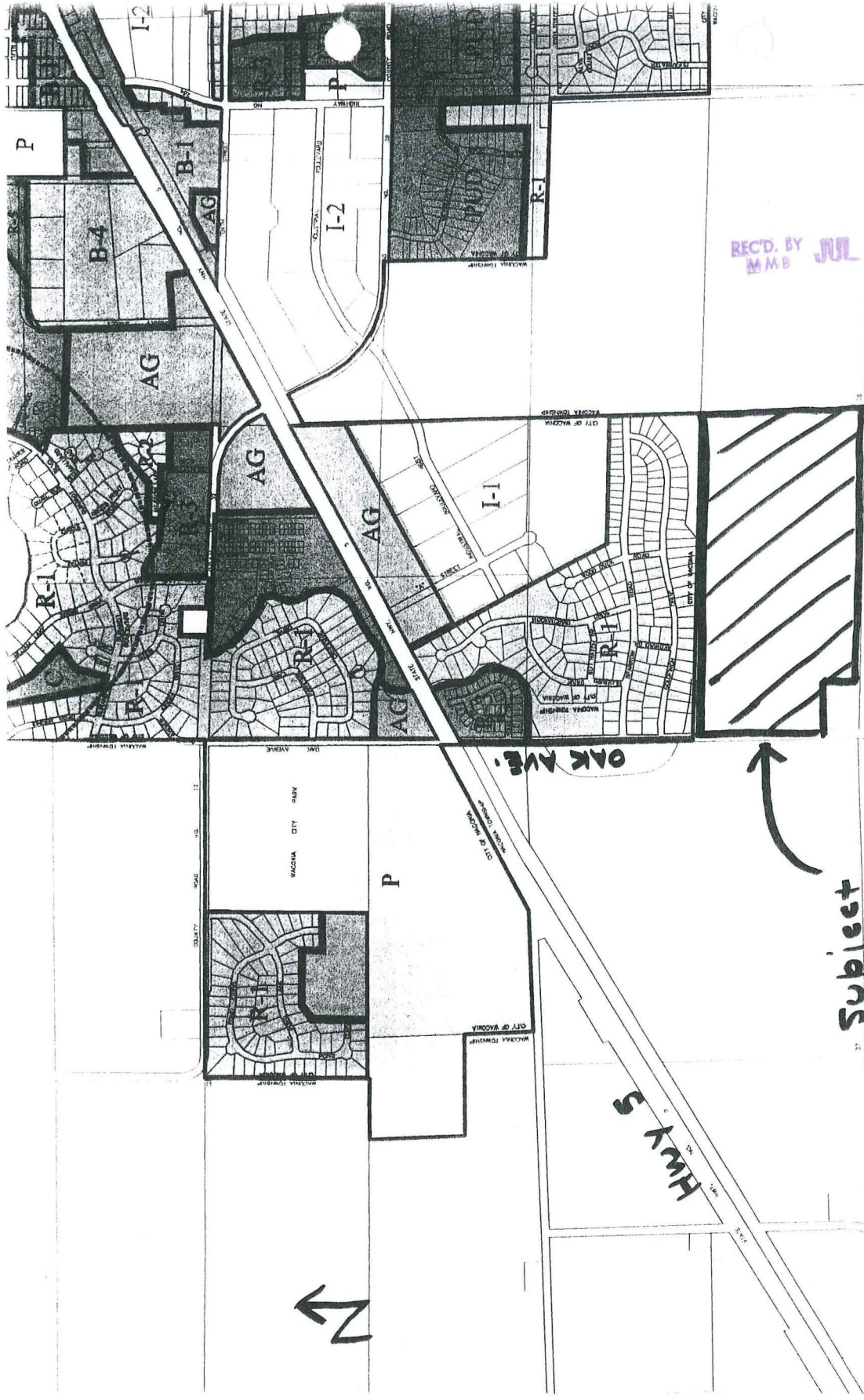

Subject  
Annexation  
Parcel

