

RECEIVED MAY 18 1999  
MAY 18 1999

ORDINANCE 27, 3d

Introduced by Councilor Amundson

AN ORDINANCE FOR ANNEXATION OF UNINCORPORATED PROPERTY  
PURSUANT TO M.S. 414.033

WHEREAS, the City of Albert Lea owns certain property within the Township of Albert Lea described as follows:

Tract 1

The S  $\frac{1}{2}$  NW  $\frac{1}{4}$  Section 18-T102N-R21W and Government Lots 1 & 2 in the SW  $\frac{1}{4}$  of said Section 18; together with the West 33.00 feet of the SW  $\frac{1}{4}$  NE  $\frac{1}{4}$  and the West 33.00 feet of the NW  $\frac{1}{4}$  SE  $\frac{1}{4}$  of said Section 18; less the following described Tracts A and B:

Tract A

Beginning at the Northeast Corner of the Southwest Quarter of Section 18; thence North 89 degrees 15 minutes 37 seconds West 33.00 feet, to the point of beginning; thence South 00 degrees 00 minutes 00 seconds West 200.00 feet; thence North 89 degrees 15 minutes 37 seconds West 187.00 feet parallel with the north line of the Southwest Quarter; thence North 00 degrees 00 minutes 00 seconds East 200.00 feet to the north line of the southwest Quarter; thence south 89 degrees 15 minutes 37 seconds East 187.00 feet along said line to the point of beginning.

Tract B

Beginning at a point on the east line of Government Lot Two (2) in Section Eighteen, Township 102 North of Range 21 West (18-102N-R21W) of the Fifth Principal Meridian, which point is also on the north shoreline of Pickerel Lake, 710.5 feet South of the East quarter corner of the southwest Quarter (SW  $\frac{1}{4}$ ) of said Section 18; thence North 0 degrees 00 minutes East on the east line of said Government Lot 2, 732.5 feet to a point 22.0 feet north of said East quarter corner of the SW  $\frac{1}{4}$ ; thence North 85 degrees 30 minutes West, 690.0 feet; thence South 0 degrees 00 minutes West, 367.0 feet to the north shoreline of Pickerel Lake; thence southeasterly along said north shoreline to the point of beginning;

containing 153.89 acres +/-.

AND,

Tract 2

Commencing at the southwest corner of Southgate Addition, as the same is platted and recorded in the office of the County Recorder of Freeborn County, Minnesota;

Thence Southerly on the easterly right-of-way line of U.S. Highway No. 69, as follows:

South 00 degrees 59 minutes 12 seconds East a distance of 292.16 feet;

REC'D MAY 13 1999  
MAY 13 1999

Southerly a distance of 125.60 feet, on a tangential curve concave to the east with a radius of 3752.20 feet and a central angle of 0 degrees 55 minutes 04 seconds;

North 89 degrees 05 minutes 44 seconds East a distance of 25.00 feet, on a nontangential line;

Southerly a distance of 252.35 feet, on a nontangential curve concave to the east with a radius of 3727.20 feet and a central angle of 3 degrees 52 minutes 45 seconds, to a point 684.62 feet south of the north line of said Government Lot 3;

thence South 89 degrees 52 minutes 27 seconds West a distance of 49.57 feet, to a point on the east line of said Government Lot 3;

thence North 00 degrees 46 minutes 02 seconds West a distance of 684.63 feet, on the east line of said Government Lot 3, to the northeast corner thereof;

thence South 89 degrees 52 minutes 27 seconds West a distance of 735.79 feet, on the north line of said Government Lot 3;

thence South 00 degrees 46 minutes 02 seconds East a distance of 59.95 feet, to a point on the south right-of-way line of Ninth Street (Township Road No. R-458);

thence South 89 degrees 04 minutes 52 seconds West a distance of 620.07 feet, on the south line of said West Ninth Street (Township Road No. T-458), to a point 33.00 feet west of the west line of said Government Lot 3;

thence North 00 degrees 52 minutes 08 seconds West a distance of 92.71 feet, on a line parallel with and 33.00 feet west of the east line of Government Lot 2 in said Section 18;

thence South 86 degrees 22 minutes 08 seconds East a distance of 33.10 feet, to a point on the east line of said Government Lot 2;

thence South 00 degrees 52 minutes 08 seconds East a distance of 22.00 feet, on the east line of said Government Lot 2;

thence North 89 degrees 52 minutes 27 seconds East a distance of 33.00 feet, on the north line of said Government Lot 3, to the east right-of-way line of Township Road No. T-369;

thence South 00 degrees 52 minutes 08 seconds East a distance of 1.62 feet, to a point on the north right-of-way line of West Ninth Street (Township Road No. T-458);

thence North 89 degrees 04 minutes 52 seconds East a distance of 1292.72 feet, on the north right-of-way line of said West Ninth Street (Township Road No. T-458), to the southwest corner of Lot 7, Block 6 in said Southgate;

thence South 00 degrees 59 minutes 12 seconds East a distance of 33.00 feet, to the point of beginning;

containing 1.43 acres more or less.

MAY 14 1996

WHEREAS, the City of Albert Lea intends to plat the above-described property into residential lots and extend City utilities; and

WHEREAS, the City of Albert Lea desires to annex the property described above and requests consideration for this annexation by the Minnesota Municipal Board pursuant to M.S. 414.033 Subd. 2 (a); now, therefore

THE CITY OF ALBERT LEA ORDAINS:

Sec. 1. That certain properties abutting the City of Albert Lea are presently urban or suburban in nature or are about to become so. Further, the City of Albert Lea is capable of providing services to this area within a reasonable time, or the existing township form of government is not adequate to protect the public health, safety or welfare, or the annexation would be in the best interests of the area proposed for annexation. Therefore, these properties would be immediately annexed to the City of Albert Lea. This area is described as follows:

Tract 1

The S  $\frac{1}{2}$  NW  $\frac{1}{4}$  Section 18-T102N-R21W and Government Lots 1 & 2 in the SW  $\frac{1}{4}$  of said Section 18; together with the West 33.00 feet of the SW  $\frac{1}{4}$  NE  $\frac{1}{4}$  and the West 33.00 feet of the NW  $\frac{1}{4}$  SE  $\frac{1}{4}$  of said Section 18; less the following described Tracts A and B:

Tract A

Beginning at the Northeast Corner of the Southwest Quarter of Section 18; thence North 89 degrees 15 minutes 37 seconds West 33.00 feet, to the point of beginning; thence South 00 degrees 00 minutes 00 seconds West 200.00 feet; thence North 89 degrees 15 minutes 37 seconds West 187.00 feet parallel with the north line of the Southwest Quarter; thence North 00 degrees 00 minutes 00 seconds East 200.00 feet to the north line of the southwest Quarter; thence south 89 degrees 15 minutes 37 seconds East 187.00 feet along said line to the point of beginning.

Tract B

Beginning at a point on the east line of Government Lot Two (2) in Section Eighteen, Township 102 North of Range 21 West (18-102N-R21W) of the Fifth Principal Meridian, which point is also on the north shoreline of Pickerel Lake, 710.5 feet South of the East quarter corner of the southwest Quarter (SW  $\frac{1}{4}$ ) of said Section 18; thence North 0 degrees 00 minutes East on the east line of said Government Lot 2, 732.5 feet to a point 22.0 feet north of said East quarter corner of the SW  $\frac{1}{4}$ ; thence North 85 degrees 30 minutes West, 690.0 feet; thence South 0 degrees 00 minutes West, 367.0 feet to the north shoreline of Pickerel Lake; thence southeasterly along said north shoreline to the point of beginning;

containing 153.89 acres +/-.

AND,

Tract 2

Commencing at the southwest corner of Southgate Addition, as the same is platted and recorded in the office of the County Recorder of Freeborn County, Minnesota;

Thence Southerly on the easterly right-of-way line of U.S. Highway No. 69, as follows:

South 00 degrees 59 minutes 12 seconds East a distance of 292.16 feet;

Southerly a distance of 125.60 feet, on a tangential curve concave to the east with a radius of 3752.20 feet and a central angle of 0 degrees 55 minutes 04 seconds;

North 89 degrees 05 minutes 44 seconds East a distance of 25.00 feet, on a nontangential line;

Southerly a distance of 252.35 feet, on a nontangential curve concave to the east with a radius of 3727.20 feet and a central angle of 3 degrees 52 minutes 45 seconds, to a point 684.62 feet south of the north line of said Government Lot 3;

thence South 89 degrees 52 minutes 27 seconds West a distance of 49.57 feet, to a point on the east line of said Government Lot 3;

thence North 00 degrees 46 minutes 02 seconds West a distance of 684.63 feet, on the east line of said Government Lot 3, to the northeast corner thereof;

thence South 89 degrees 52 minutes 27 seconds West a distance of 735.79 feet, on the north line of said Government Lot 3;

thence South 00 degrees 46 minutes 02 seconds East a distance of 59.95 feet, to a point on the south right-of-way line of Ninth Street (Township Road No. R-458);

thence South 89 degrees 04 minutes 52 seconds West a distance of 620.07 feet, on the south line of said West Ninth Street (Township Road No. T-458), to a point 33.00 feet west of the west line of said Government Lot 3;

thence North 00 degrees 52 minutes 08 seconds West a distance of 92.71 feet, on a line parallel with and 33.00 feet west of the east line of Government Lot 2 in said Section 18;

thence South 86 degrees 22 minutes 08 seconds East a distance of 33.10 feet, to a point on the east line of said Government Lot 2;

thence South 00 degrees 52 minutes 08 seconds East a distance of 22.00 feet, on the east line of said Government Lot 2;

thence North 89 degrees 52 minutes 27 seconds East a distance of 33.00 feet, on the north line of said Government Lot 3, to the east right-of-way line of Township Road No. T-369;

thence South 00 degrees 52 minutes 08 seconds East a distance of 1.62 feet, to a point on the north right-of-way line of West Ninth Street (Township Road No. T-458);

RECORDED  
MAY 13 1999

thence North 89 degrees 04 minutes 52 seconds East a distance of 1292.72 feet, on the north right-of-way line of said West Ninth Street (Township Road No. T-458), to the southwest corner of Lot 7, Block 6 in said Southgate;

thence South 00 degrees 59 minutes 12 seconds East a distance of 33.00 feet, to the point of beginning;

containing 1.43 acres more or less.

Sec. 2. That the property proposed for annexation is owned in fee by the City of Albert Lea and the City intends to develop the property into residential properties including the extension of water and sewer service, fire and police protection, the development of streets and other administrative and City services.

Sec. 3. That the City agrees to investigate the possibility of sharing facilities, equipment and personnel with the township to forestall the duplication of facilities and to reduce the overall costs of government in the area.

Sec. 4. That the area proposed for annexation contains no population.

Sec. 5. That planning throughout the orderly annexation area shall be pursuant to Minnesota Statutes 414.0325. Planning and zoning for the area shall be provided by the City of Albert Lea and the property shall be zoned R-1.

Sec. 6. That any person owning lands annexed to the City shall have all rights provided by Statute and Resolution 94-173 of the City of Albert Lea governing special assessments including any subsequent amendments. That the customary hookup charges approved for property in the City shall be used for connection to City utilities.

Sec. 7. That there will be no change in electric utility service as the result of the proposed annexation.

Sec. 8. That the City Clerk shall file a certified copy of this ordinance with the Minnesota Municipal Board, Albert Lea Township, the Freeborn County Auditor/Treasurer and the Secretary of State.

Sec. 9. That reading of this resolution is waived by Council consent.

Introduced and read the first time April 26, 1999.

Read the second time and passed May 10, 1999.

Filed and attested May 11, 1999.

Sandi Behrens  
Secretary of the Council  
paj: 5/11/99

Marion Ahlenger  
Mayor

STATE OF MINNESOTA }  
COUNTY OF FREEBORN } ss  
CITY OF ALBERT LEA }

I hereby certify that I have compared the within instrument with the original now on file in my office and that it is a true and correct copy of the same and of the whole thereof.

Dated May 11, 1999  
City Clerk Sandi Behrens

By authorized deputy \_\_\_\_\_





# MAP OF

# ALBERT LEA



TOWNSHIP: 102 N

MIDLAND ATLAS CO. INC. COPYRIGHT 1998

RANGE: 21 W

CODE: AB

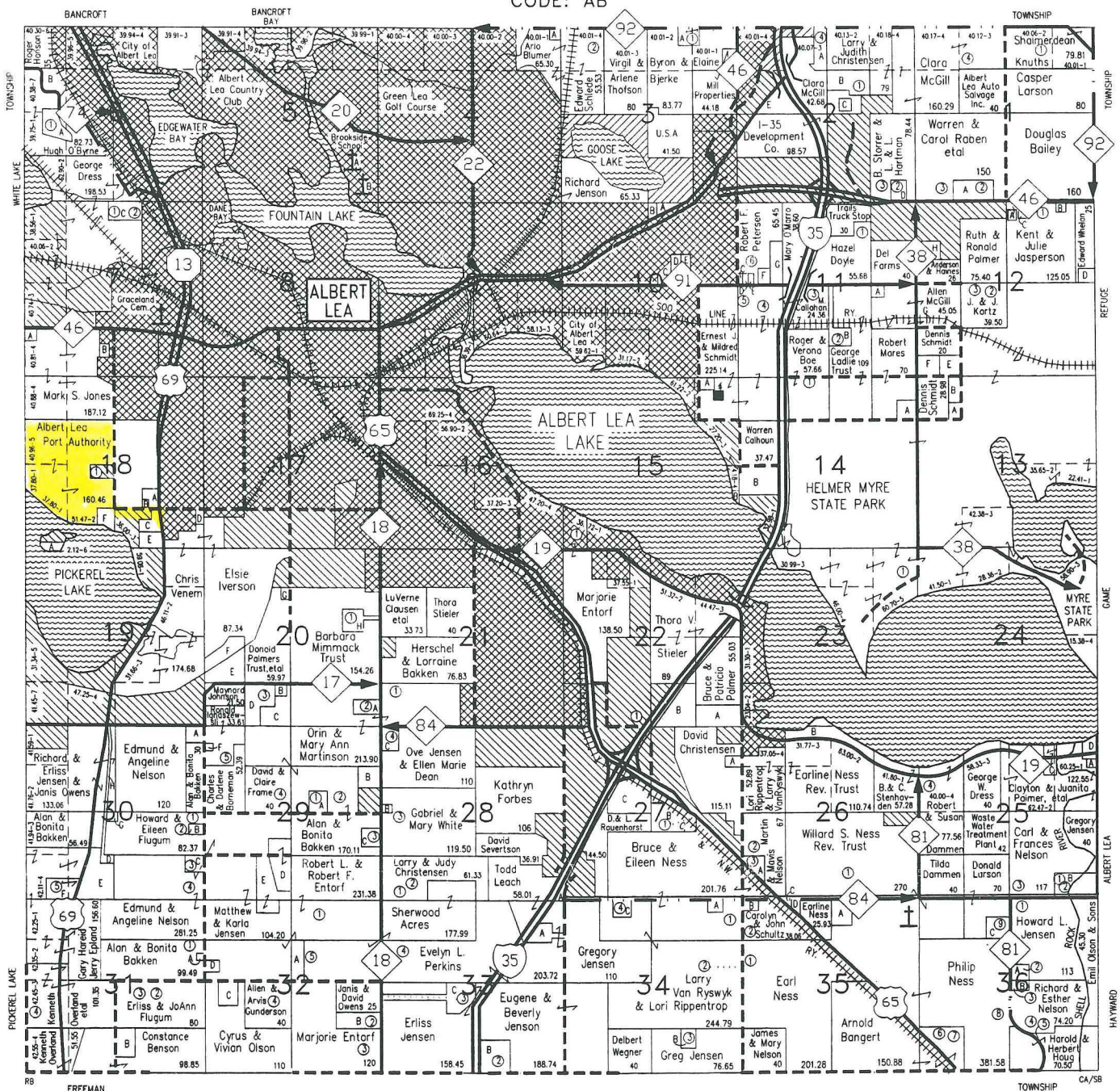

SEE SMALL TRACT OWNERS FOLLOWING TOWNSHIP MAPS

**PETERSON, SVELKOL, SCHLICHTING  
& DAVIES, LTD.**

**LAWYERS**

Real Estate, Family,  
Farm and Agricultural  
Law, Trusts, Wills,  
Estate Planning

211 South Newton  
Albert Lea, MN 56007

(507)373-6491

FREEBORN	HARTLAND	BATH	GENEVA	NEWRY
CARLSTON	MANCHESTER	BANCROFT	RICELAND	MOSCOW
ALDEN	PICKEREL LAKE		HAYWARD	OAKLAND
MANSFIELD	NUNDA	FREEMAN	SHELL ROCK	LONDON



# DRAWING OF TRACT FOR ANNEXATION PURPOSES

IN S 1/2 NW 1/4, GOVT LOTS 1, 2 & 3 SECTION 18-T102N-R21W  
CITY OF ALBERT LEA, FREEBORN COUNTY, MINNESOTA

