

ORDINANCE NO. 3221

AN ORDINANCE ANNEXING TO THE CITY OF ROCHESTER  
APPROXIMATELY 59.93 ACRES OF LAND LOCATED IN A PART OF THE  
WEST HALF OF SECTION 32, TOWNSHIP 107 NORTH, RANGE 14  
WEST, OL MSTED COUNTY, MINNESOTA.

THE COMMON COUNCIL OF THE CITY OF ROCHESTER DO ORDAIN:

Section 1. A petition has been filed with the Common Council of the City of Rochester, signed by the owner of land described herein, requesting the Common Council to annex said land to the City of Rochester. The land described in said petition for annexation is located in Cascade Township, Olmsted County, Minnesota, and is described as follows:

That part of the West Half of Section 32, Township 107 North, Range 14 West, Olmsted County, Minnesota, described as follows:

Beginning at the southwest corner of the Northwest Quarter of said Section 32; thence North 02 degrees 29 minutes 44 seconds West, assumed bearing, along the west line thereof, 457.84 feet; thence North 87 degrees 30 minutes 57 seconds East, 375.51 feet; thence North 39 degrees 10 minutes 32 seconds East, 380.30 feet; thence South 83 degrees 48 minutes 34 seconds East, 681.66 feet; thence North 02 degrees 09 minutes 04 seconds West, 185.88 feet to the southerly line of MANOR WOODS WEST EIGHTH SUBDIVISION; thence South 77 degrees 56 minutes 31 seconds East, along said southerly line, 123.18 feet to the southwesterly corner of MANOR WOODS WEST SEVENTH SUBDIVISION; thence South 81 degrees 47 minutes 28 seconds East, along said southerly line, 83.67 feet; thence South 80

degrees 37 minutes 40 seconds East, along said southerly line, 201.72 feet to the northwest corner of Block 6, MANOR WOODS WEST TENTH SUBDIVISION (the next three courses are along the westerly, southerly and easterly lines of said MANOR WOODS WEST TENTH); thence South 09 degrees 22 minutes 20 seconds West, 60.75 feet; thence South 39 degrees 23 minutes 50 seconds East, 768.97 feet; thence North 47 degrees 31 minutes 51 seconds East, 382.90 feet to the westerly line of MANOR WOOD WEST FOURTH SUBDIVISION; thence South 00 degrees 28 minutes 46 seconds East, 553.43 feet; thence North 64 degrees 03 minutes 02 seconds West, 206.76; thence South 32 degrees 31 minutes 27 seconds West, 600.00 feet; thence South 88 degrees 31 minutes 27 seconds West, 740.00 feet; thence North 86 degrees 36 minutes 09 minutes West, 1177.00 feet to the west line of the Southwest Quarter of said Section 32; thence North 01 degree 11 minutes 48 seconds West, along said west line, 503.68 feet to the point of beginning.

Containing 59.93 acres more or less.

Section 2. The total quantity of land included in said petition is approximately 59.93 acres in size.

Section 3. On December 21, 1998, the Common Council held a public hearing to consider this annexation petition after providing written notice of the hearing, by registered mail, to the property owner, the Cascade Township officers, and the adjacent property owners.

Section 4. The City provided notification to the petitioners pursuant to Minn. Stat. §414.033, subd. 2b, 11, 12 and 13 if applicable to this petitioned annexation.

Section 5. Following the public hearing, the Common Council of the City of Rochester determined that the land abuts the municipal limits, is less than 60 acres in area, the annexation petition is signed by all property owners of the land described in Section 1, and the land is or will soon become urban or suburban in character.

Section 6. Therefore, pursuant to Minn. Stat. §414.033, subd. 2(3), the land described in Section 1 above is hereby annexed, added to and made a part of the City of Rochester, Minnesota, as if it had originally been a part thereof.

Section 7. Present and future owners of the lands annexed by this ordinance are hereby notified that in addition to the usual assessments, it is the intention of the Common Council to assess against benefited property all or a portion of the cost of any storm sewer, water tower, pumping station, and trunk line sanitary sewer construction, heretofore or hereafter undertaken to serve the area annexed.

Section 8. This ordinance shall take effect and be in force from and after its official publication and from and after the filing of a certified copy hereof with the Minnesota Municipal Board, the Cascade Town Clerk, the County Auditor, and the Secretary of State.

REC'D. BY JAN 27 1999  
A M B

PASSED AND ADOPTED BY THE COMMON COUNCIL OF THE CITY OF  
ROCHESTER, MINNESOTA, THIS 20TH DAY OF JANUARY, 1998.9

*John Hunscher*  
PRESIDENT OF SAID COMMON COUNCIL

ATTEST: *Judy Kay Swear*  
CITY CLERK

APPROVED THIS 21ST DAY OF JANUARY, 1998.9

*G. J. Confield*  
MAYOR OF SAID CITY

(Seal of the City of  
Rochester, Minnesota)

# ANNEXATION EXHIBIT

DESCRIPTION:  
SEE ATTACHED:

REC'D. BY  
M/R JAN 27 1999



SCALE 1" = 600'

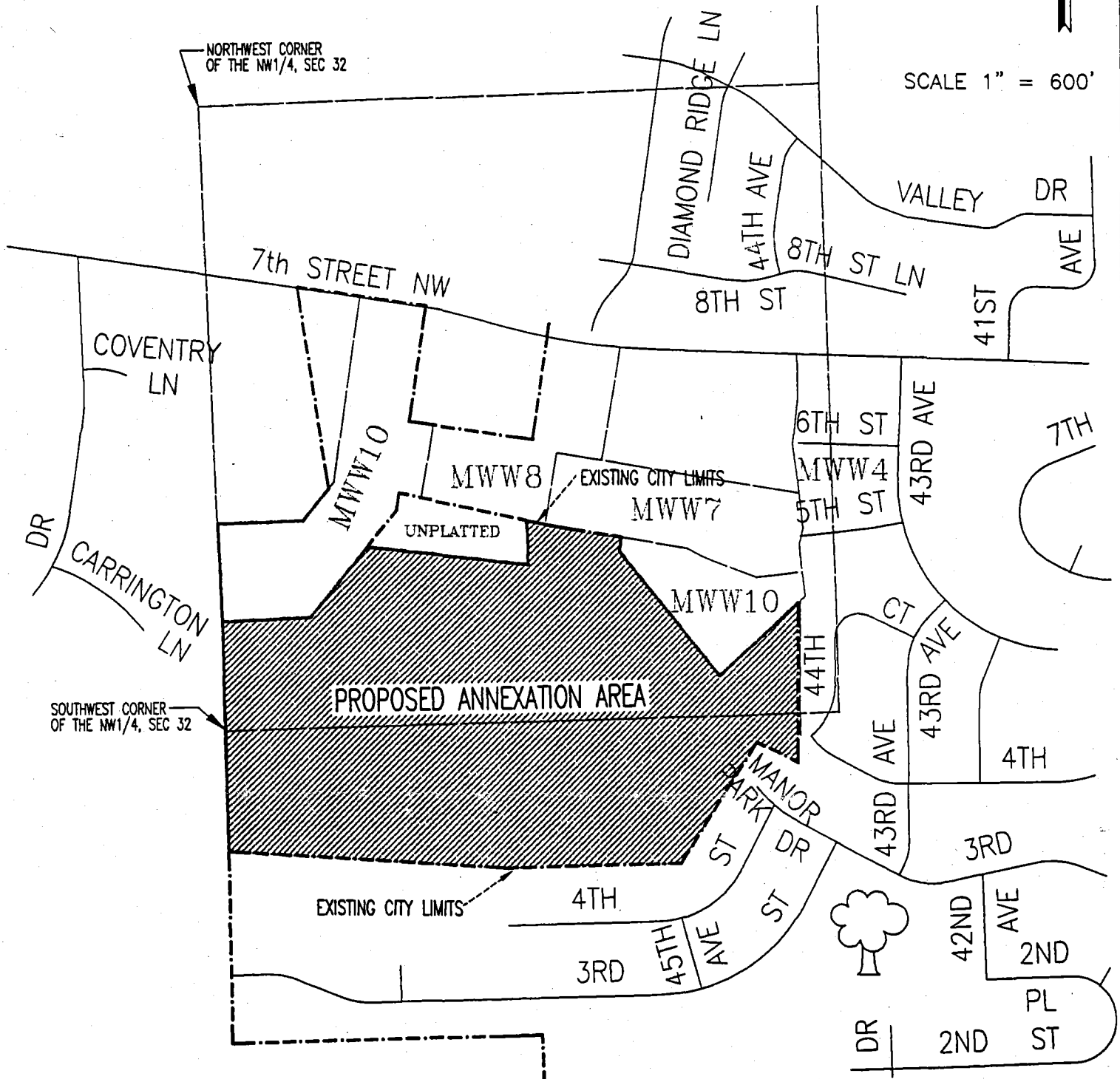

FOR :  
FORBROOK-BIGELOW DEVELOPMENT  
PO BOX 1373  
BYRON, MINNESOTA  
55920

**McGhie**  
Consulting Engineers

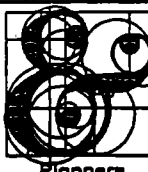

**Betts, Inc.**  
Land Surveyors

1648 3rd AVE. S.E. Rochester, MN 55904 507-289-3919

SCALE: 1" = 600'

DRAWN BY: BWC

DATE: 11/09/98

ACCT. NO.: 1121A/7593

CADD NO.: 7593EX01