

ORDINANCE NO. 51.060
EXTENDING THE CORPORATE LIMITS
OF THE CITY OF ELGIN
TO INCLUDE CERTAIN UNINCORPORATED LAND
ABUTTING THE CITY OF ELGIN

WHEREAS, Minnesota Statute §414.033 allows a city to annex land into the city limits by ordinance when: a) the land abuts the municipality, b) the land area is less than 60 acres, c) the city receives a petition for annexation from all property owners of the land, and d) the area to be annexed is not presently served by public sewer facilities, and

WHEREAS, the City of Elgin has received a Petition dated February 12, 1998 from Fred Ohm, Jr. and Irene Ohm, and a Petition dated March 23, 1998 from John A. Sell and Lucille R. Sell, the owners of the property described on Exhibit A hereto, no part of which is now included in the city limits of the City of Elgin, and

WHEREAS, the petitioners' lands abuts the City, and

WHEREAS, the land is approx. 59.25 acres in area, and

WHEREAS, the property to be annexed is not presently served by public sewer facilities, and

WHEREAS, the City believes the land is about to become urban or suburban in character because the area in which the property is located is between the City of Elgin on the north, which includes single-family housing, and Woodland Estates Subdivision, a residential single-family housing addition on the south, and the property to be annexed will be used for construction of new single-family homes in a residential subdivision to be developed by petitioners, and

WHEREAS, a public hearing was held on April 27, 1998 pursuant to Minnesota Statutes Section 414.033, Subd.2(b), and 30 days' written notice was given by certified mail to Elgin Township and to all landowners within and contiguous to the area to be annexed, and

EXHIBIT A

Legal description of property to be annexed:

State of Minnesota, County of Wabasha:

The South Twenty-Two and One-Half acres of the West Half of the Northeast Quarter ($W\frac{1}{2}NE\frac{1}{4}$) of Section 34-108-12.

Also: State of Minnesota, County of Wabasha:

The East Half of the Northeast Quarter ($E\frac{1}{2}NE\frac{1}{4}$) of Section 34-108-12, excepting therefrom:

- 1) the West 62.75 acres thereof,
- 2) the South 400 feet thereof, and
- 3) the East 28 feet of the North 500 feet thereof.

Also: State of Minnesota, County of Wabasha: Commencing at a point on the North - South section line between Sections 34 and 35, Township 108, Range 12, said point being 400 feet north of the northeast corner of the Southeast Quarter ($SE\frac{1}{4}$) of said Section 34-108-12 for a point of beginning; thence South along the easterly line of said Southeast Quarter ($SE\frac{1}{4}$) to the southeast corner of said Southeast Quarter ($SE\frac{1}{4}$); thence East 66 feet; thence North to a point which is 66 feet directly East of the point of beginning; thence West 66 feet to the point of beginning.

Also: State of Minnesota, County of Wabasha: the South 17 acres of the Southwest Quarter of the Southwest Quarter ($SW\frac{1}{4}SW\frac{1}{4}$) of Section 35-108-12.

MAP OF
ELGIN

TOWNSHIP: 108 N.



RANGE: 12 W.

CODE: EL

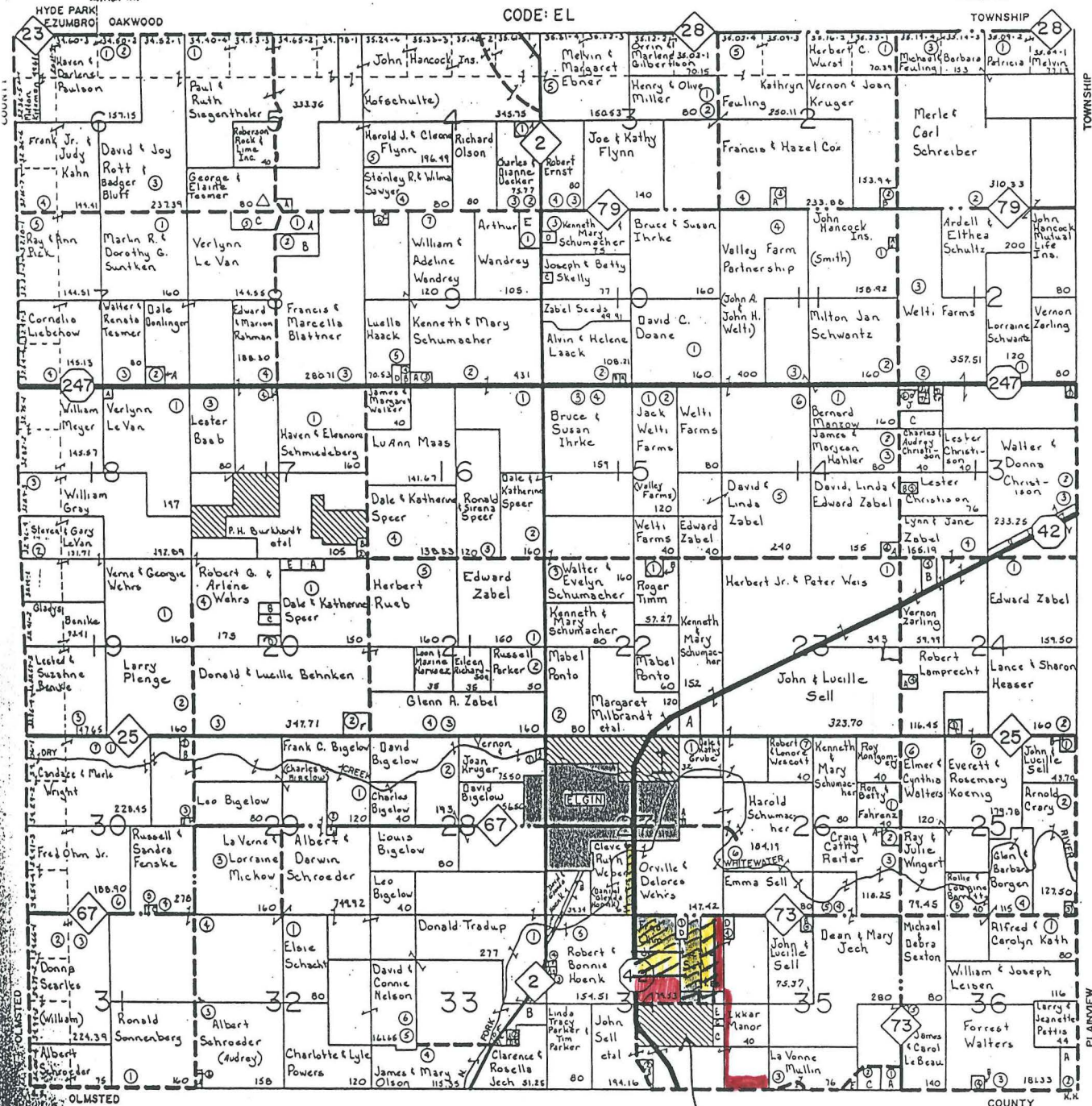
TOWNSHIP



SEE SMALL TRACT OWNERS FOLLOWING TOWNSHIP MAPS

 Property to be Annexed
 Phase III
Already Annexed

Woodland Estates
Residential
Subdivision

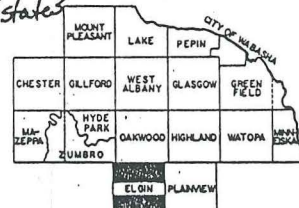

REC'D. BY
JMB JUL 20 1998

