

CITY OF BEMIDJI
ORDINANCE NO. 224, 2nd SERIES

AN ORDINANCE ANNEXING ST. ONGE PROPERTY
TO THE CORPORATE LIMITS OF THE CITY OF BEMIDJI

WHEREAS, certain properties, described below, are not presently included in the corporate limits of any incorporated city, village, or borough; and

WHEREAS, pursuant to M.S. 414.033, Subd. 2(3), the owner of said described properties have petitioned the City of Bemidji for annexation of such properties; and

WHEREAS, the properties are located adjacent to existing City boundaries; and

WHEREAS, the total area is 25 acres and is urban or suburban in character or about to become so; and

WHEREAS, there are zero (0) persons residing on the properties; and

WHEREAS, the legal description of the property is as follows:

The Southwest quarter of the Northeast quarter of Section 11, Township 146 North, Range 33 West, Beltrami County, Minnesota, less the South 475.00 feet thereof.

NOW, THEREFORE, the Council of the City of Bemidji hereby ordains that the corporate limits of the City of Bemidji are hereby extended to include land as described, and the same is hereby annexed and included within the City of Bemidji as effectively as if it had originally been a part thereof.

The City Clerk is hereby directed to file certified copies of this Ordinance with the Minnesota Municipal Board, the Beltrami County Auditor, the Bemidji Township Board, and the Secretary of State.

This Ordinance shall become effective thirty (30) days after its passage, due publication thereof, and approval by the Minnesota Municipal Board.

First Reading: March 2, 1998

Second Reading: March 16, 1998

Third Reading and passed: April 6, 1998

Ayes: Atwater, Peterson, Zachman, Oberg, Lehmann, Given Amble, O'Boyle

Nays: None

Absent: None

ATTEST:

Shirley J. Kuban, City Clerk

APPROVED:

Douglas E. Peterson, Mayor

Lake

Bemidji

REC'D. BY MAY 27 1998
M:18

T147 N R 33 W
35 36
2 7
T146 N R 33 W

POWER DAM ROAD

ST ONCE DRIVE

GRÖTTE AVE

TYLER AVE

TO BE ANNEXED

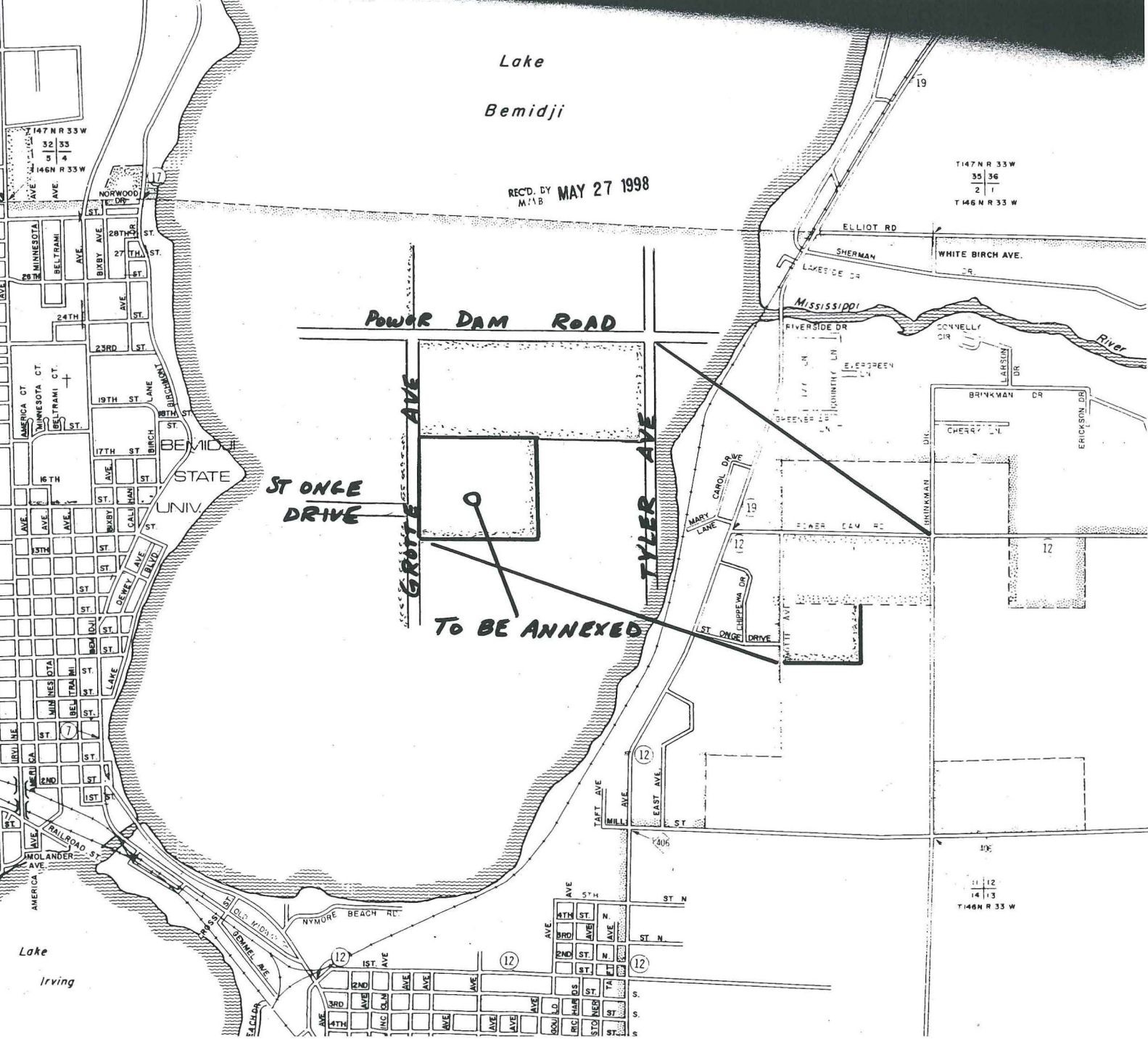

Lake
Irving

T147 N
14 13
T146 N R 33 W