

Proposed Ordinance No. 2/98

ORDINANCE NO. 1179

AN ORDINANCE EXTENDING THE CORPORATE LIMITS OF THE  
CITY OF OWATONNA TO INCLUDE CERTAIN UNINCORPORATED  
LAND ABUTTING THE CITY OF OWATONNA

WHEREAS, all owners of the property described herein have petitioned for annexation of the described property to the City of Owatonna; and

WHEREAS, the property described lies in the South Half of the Northeast Quarter of Section 7, Township 107 North, Range 20 West, and comprises approximately 16.74 acres including street right-of-way; and

WHEREAS, said property is suitably conditioned for and needs urban government; and

WHEREAS, no part of the property described herein is included within the limits of an incorporated city; and

WHEREAS, the City has authority, pursuant to Minnesota Statutes 414.033, Subdivision 2 (3) to declare the property described herein annexed to the City; and

WHEREAS, a public hearing on the annexation into the City of Owatonna of property herein described was held on Tuesday, March 17, 1998, and notification requirements of Minnesota Statutes 414.033, Subd. 2b were satisfied; and

WHEREAS, the City of Owatonna is a city of the third class operating under a Home Rule Charter adopted pursuant to the provisions of the Constitution and Laws of the State of Minnesota.

NOW THEREFORE, THE CITY COUNCIL OF THE CITY OF OWATONNA DO  
ORDAIN:

SECTION 1. The City Council hereby determines:

1. That the annexation will be to the best interest of the City of Owatonna and of the property affected.
2. All property owners have petitioned the City for annexation of this property and said property is suitably conditioned for and needs urban government.

3. That none of said properties are now included within the limits of any incorporated city.

SECTION 2. That the following described property, referred to in the preamble of this ordinance, situated in the County of Steele, State of Minnesota, to-wit:

All that part of the South Half of the Northeast Quarter of Section 7, Township 107 North, Range 20 West, Steele County, Minnesota, described by:

Beginning at the Northeast corner of said South Half of the Northeast Quarter; thence North 89° 55' 58" West, assumed bearing, 1150.00 feet along the North line of said South Half of the Northeast Quarter; thence South 0° 04' 14" West 634.00 feet along a line parallel with the East line of said Northeast Quarter, thence South 89° 55' 58" East 1150.00 feet to the East line of said Northeast Quarter; thence North 0° 04' 14" East 634.00 feet to beginning.

be and the same hereby is annexed to the City of Owatonna and shall, upon the effective date of this ordinance, become a part of the City of Owatonna as effectively as if it had been originally a part thereof, and the corporate limits of said City of Owatonna are hereby extended to include said land.

SECTION 3. Zone Classes shall be applied as follows:

All the property herein described shall be placed in the I-2 Heavy Industrial zoning district.

SECTION 4. This ordinance is enacted pursuant to the provisions of Minnesota Statutes, Chapter 414, Section 414.033, Subd. 2 (3).

SECTION 5. Upon its adoption, a certified copy of this ordinance shall be filed with each of the following:

Owatonna Town Clerk  
Minnesota Municipal Board  
Steele County Auditor  
Minnesota Secretary of State

as provided by law.

SECTION 6. This Ordinance shall take effect upon its passage, publication, and approval by the Minnesota Municipal Board.

Passed and adopted this 17th day of March, 1998, with  
the following vote: Aye 7; No 0; Absent 0.

Approved and signed this 17th day of March, 1998.

  
\_\_\_\_\_  
Mayor

ATTEST:

  
\_\_\_\_\_  
City Clerk



REC'D. BY  
MAB MAR 25 1998

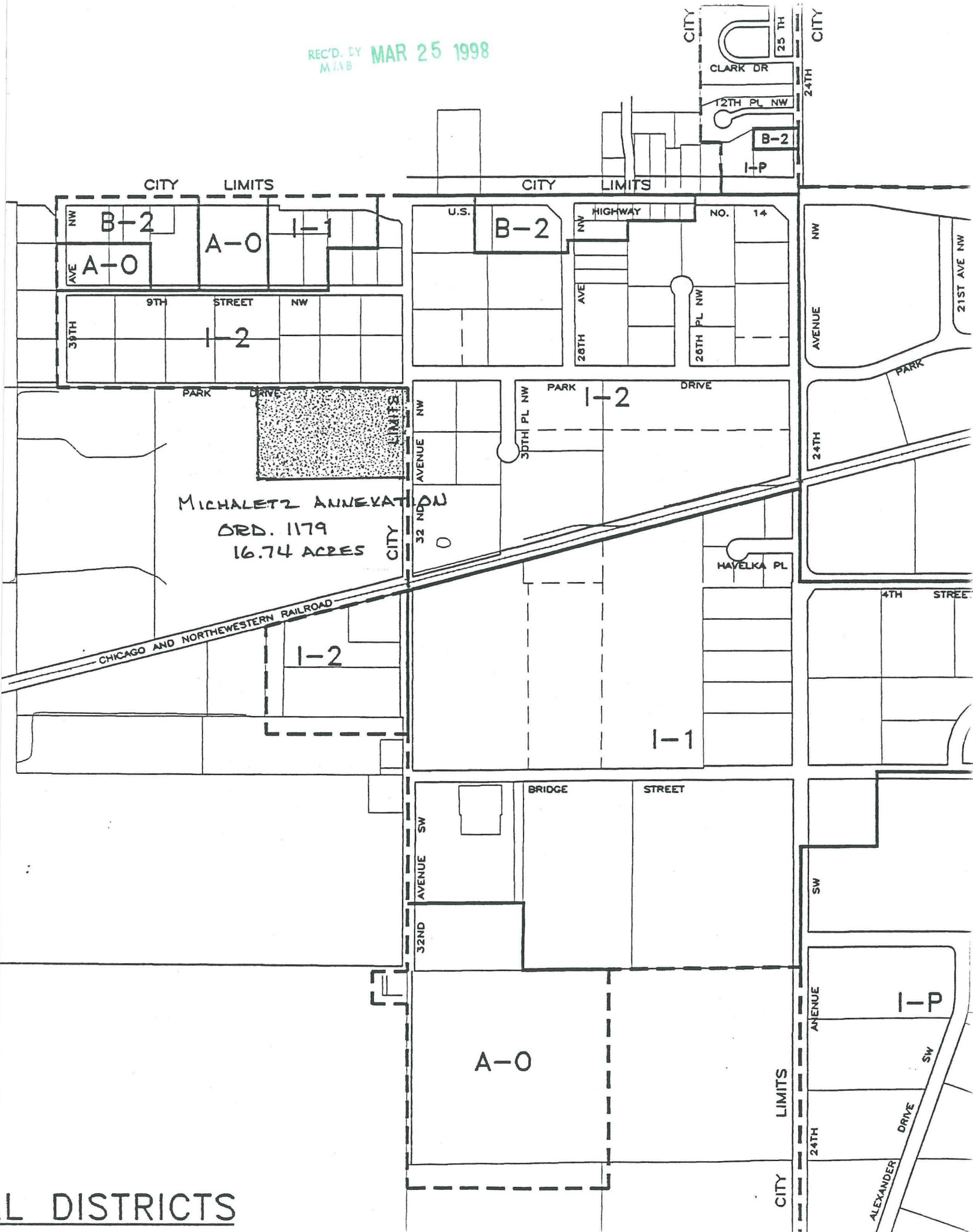

L DISTRICTS

ORD. 1179

