

ORDINANCE NO. 229

AN ORDINANCE EXTENDING THE CORPORATE LIMITS OF THE CITY OF STEWARTVILLE TO INCLUDE CERTAIN UNINCORPORATED, UNPLATTED LAND NOT EXCEEDING SIXTY (60) ACRES IN AREA ABUTTING UPON THE CITY LIMITS.

WHEREAS, a Petition dated the 27th day of June, 1996, requesting annexation of the territory hereinafter described was duly presented to the Council the 13th day of August, 1996 and

WHEREAS, a quantity of land embraced within the area described in the Petition and bounded as described is 2/3 acre more or less of unplatted land, no part of which is included within the limits of an incorporated city; and

WHEREAS, the petition was signed by the owner of the property and

WHEREAS, no objections to the annexation have been received from the Township Board or the governing body of any Municipality whose boundaries abut upon the boundaries of the lands to be annexed; and

WHEREAS, the land described in the Petition abuts the City limits at the south corner of the parcel; and

WHEREAS, the Municipality has conducted a public hearing and has given 30 days written notice by certified mail to the town or towns affected by the ordinance and to all landowners within and contiguous to the area to be annexed as required by MN Statute 414.033 Sub. 2b.

NOW THEREFORE BE IT RESOLVED THAT:

Section 1:

The Council of the City of Stewartville hereby determines:

1. That the annexation will be to the best interest of the City and of territory affected;
2. That the territory described herein abuts upon the City limits and is about to become urban or suburban in character;
3. That none of said territory is now included within the limits of any City or Borough.

Section 2:

Territory Annexed:

The corporate limits of the City are hereby extended to include the unplatted land described as follows and the same is hereby annexed to and included within the City as effectually as if it had originally been a part thereof:

Commencing at the Southwest corner of Lot Eleven (11), Wooldridge's Second Highland Addition to the Village of Stewartville, for a place of beginning, running thence West fifty (W50) feet, thence North two hundred twenty-five (N225) feet, thence east fifty (50) feet, thence South two hundred twenty-five (S225) feet, to the place of beginning, all lying and being in the Southeast Quarter (SE1/4) of Section Thirty Three (33), Town 105, Range 14.

And also, commencing at a point 50 feet west of the Southwest corner of Lot Eleven (11) in Wooldridge's Second Highland Addition to the Village of Stewartville; thence North 225 feet; thence west to the East shore line to a point due west of the place of beginning; thence East to the point of beginning beign lands located in the East half (E1/2) of the Southeast Quarter (SE1/4), of Section Thirty Three (33) in Township One Hundred Five (105) North of Range Fourteen (14) West.

Section 3:

Filing:

The City clerk is hereby directed to file certified copies of this Ordinance with the Minnesota Municipal Commission, the Secretary of State, the Township Clerk, and County Auditor.

Section 4:

Effective Date:

This ordinance takes effect upon its passage and publication and the filing of the certified copies as directed in Section 3, and approved from the Minnesota Municipal Board.

Adopted by the City Council of Stewartville, MN this 13th day of August, 1996.

  
Larry Gray, Mayor

ATTEST:

  
Larry D. Hansen  
City Administrator

# CITY OF STEWARTVILLE, MINNESOTA

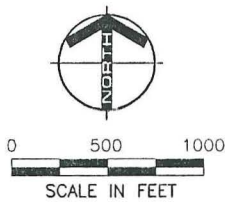

REC'D. BY SEP 16 1996  
M.A.R.

MMB #  
A 5707

Ordinance #  
229  
Proposed  
Annexation

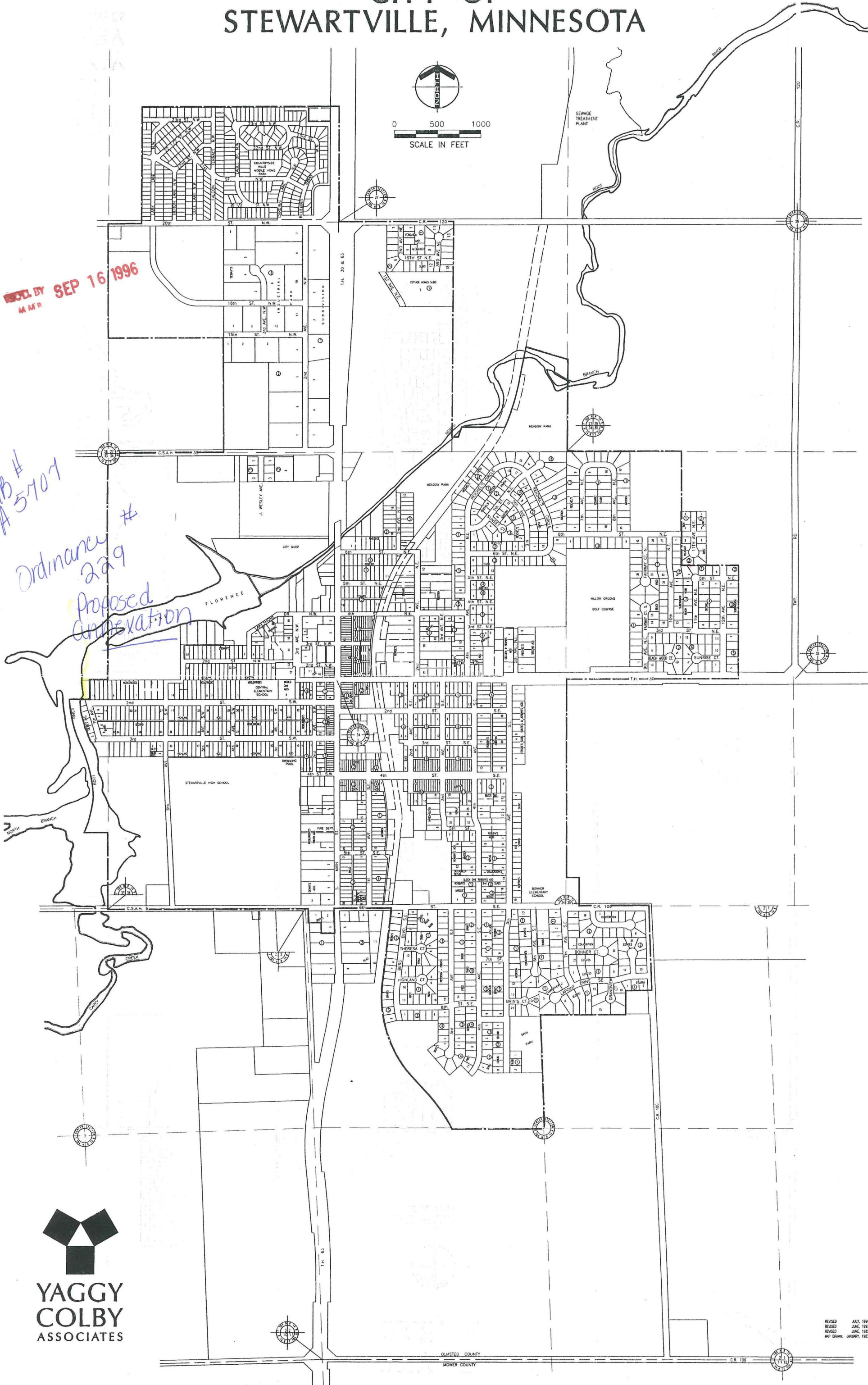

  
**YAGGY  
COLBY**  
ASSOCIATES

REVISED JULY, 1996  
REVISED JUNE, 1992  
REVISED JUNE, 1985  
MAP DRAWN JANUARY, 1983

COMPUTER FILE = CITYMAP.DWG



Ordinance #229

Proposed  
Annexation



**YAGGY  
COLBY  
ASSOCIATES**