

REC'D. BY AUG 12 1996
MMR

ORDINANCE NO. 96, 2ND SERIES

(Uncodified)

AN ORDINANCE EXTENDING THE CORPORATE LIMITS OF THE CITY OF ROSEAU, MINNESOTA, TO INCLUDE CERTAIN UNPLATTED LAND NOT EXCEEDING SIXTY (60) ACRES IN AREA ABUTTING UPON THE CITY LIMITS, PURSUANT TO MINNESOTA STATUTES, SECTION 414.033, SUBDIVISION 2(3).

WHEREAS, a certain Petition dated June 30, 1996, requesting annexation of the territory hereinafter described was duly presented to the City Council of the City of Roseau, Minnesota, on the 1st day of July, 1996; and

WHEREAS, written notice, by certified United States mail, was given to the town of Jadis, the town affected by the proposed Ordinance, and to all landowners within and contiguous to the area to be annexed, of a Public Hearing to be held on the proposed annexation on August 5, 1996, at 5:45 PM in the City Council Chambers, in the City Municipal Building, 100 2nd Avenue Northeast, Roseau, Minnesota; and

WHEREAS, said Public Hearing was duly held pursuant to said notice on said date and time at said location; and

WHEREAS, the Petition was signed by the sole owners of the real estate described herein; and

WHEREAS, no objections to the annexation were received by the Minnesota Municipal Board, within the time allowed by Minnesota Statutes,

from the Town Board of Jadis Township, Roseau County, Minnesota, or the governing body of any municipality whose boundaries abut upon the boundaries of the land to be annexed; and

WHEREAS, the land described in the Petition abuts upon the city limits of the City of Roseau at the northerly, westerly and easterly boundaries and none of the said territory is presently included within the corporate limits of any incorporated city; and

WHEREAS, the territory to be annexed is 60 acres or less.

The Council of the City of Roseau, Minnesota, ordains:

SECTION 1. COUNCIL FINDINGS. The City Council hereby determines that the annexation will be in the best interest of the city and of the territory affected; that the Petition is in proper form and has been signed by the requisite number of qualified persons, that the territory herein abuts upon the city limits and is or is about to become urban or suburban in character, that the territory to be annexed is 60 acres or less, and that none of said territory is now included within the limits of any city.

SECTION 2. POPULATION. The population of the territory is two (2).

SECTION 3. TERRITORY ANNEXED. The corporate limits of the City of Roseau are hereby extended to include the lands described as

follows and the same is hereby annexed to and included within the city as effectually as if it had originally been a part thereof:

A tract of land in the Northwest Quarter of the Southeast Quarter (NW¼ SE¼) of Section Thirteen (13), Township One Hundred Sixty-two (162) North, Range Forty (40) West, described as follows:

Beginning at the Northeast corner of Lot 6 in Block 1 of Larsen's Second Addition, according to the recorded Plat thereof; thence South 00° 01' 07" West, a distance of 306 feet; thence North 89° 18' 13" West, a distance of 270.33 feet; thence South 00° 01' 07" West to the North line of Halverson's First Subdivision, according to the recorded Plat thereof; thence East, on and along said North line to the Northeast corner of Block 2 of said Halverson's First Subdivision; thence South, on and along the East line of said Block 2 of Halverson's First Subdivision, to the Northwest corner of Block 3 of Halverson's First Subdivision; thence East, on and along the North line of said Block 3 and the North line of Block 3 extended, to the East line of the Northwest Quarter of the Southeast Quarter (NW¼ SE¼), of said Section 13, Township 162 North, Range 40 West; thence North, on and along the East line of said NW¼ SE¼, to the Northeast corner of the NW¼ SE¼, thence West, on and along the North line of said NW¼ SE¼ to the point of beginning. (Containing 14.43 acres more or less).

SECTION 4. **FILING.** The City Clerk is hereby directed to file certified copies of this Ordinance with the Minnesota Municipal Board, the Secretary of State, the Jadis Town Clerk and the Roseau County Auditor.

SECTION 5. **EFFECTIVE DATE.** This Ordinance takes effect upon its passage and publication and the filing of the certified copies as directed in Section 4, and approval of the Ordinance by the Minnesota Municipal Board.

Adopted by the City Council of the City of Roseau, Minnesota, this 5th
day of August, 1996.

Mayor

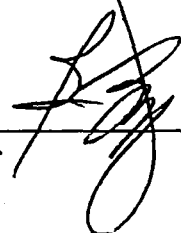
A handwritten signature in dark ink, appearing to be "R. J. [unclear]", written over a horizontal line.

ATTEST:

City Clerk

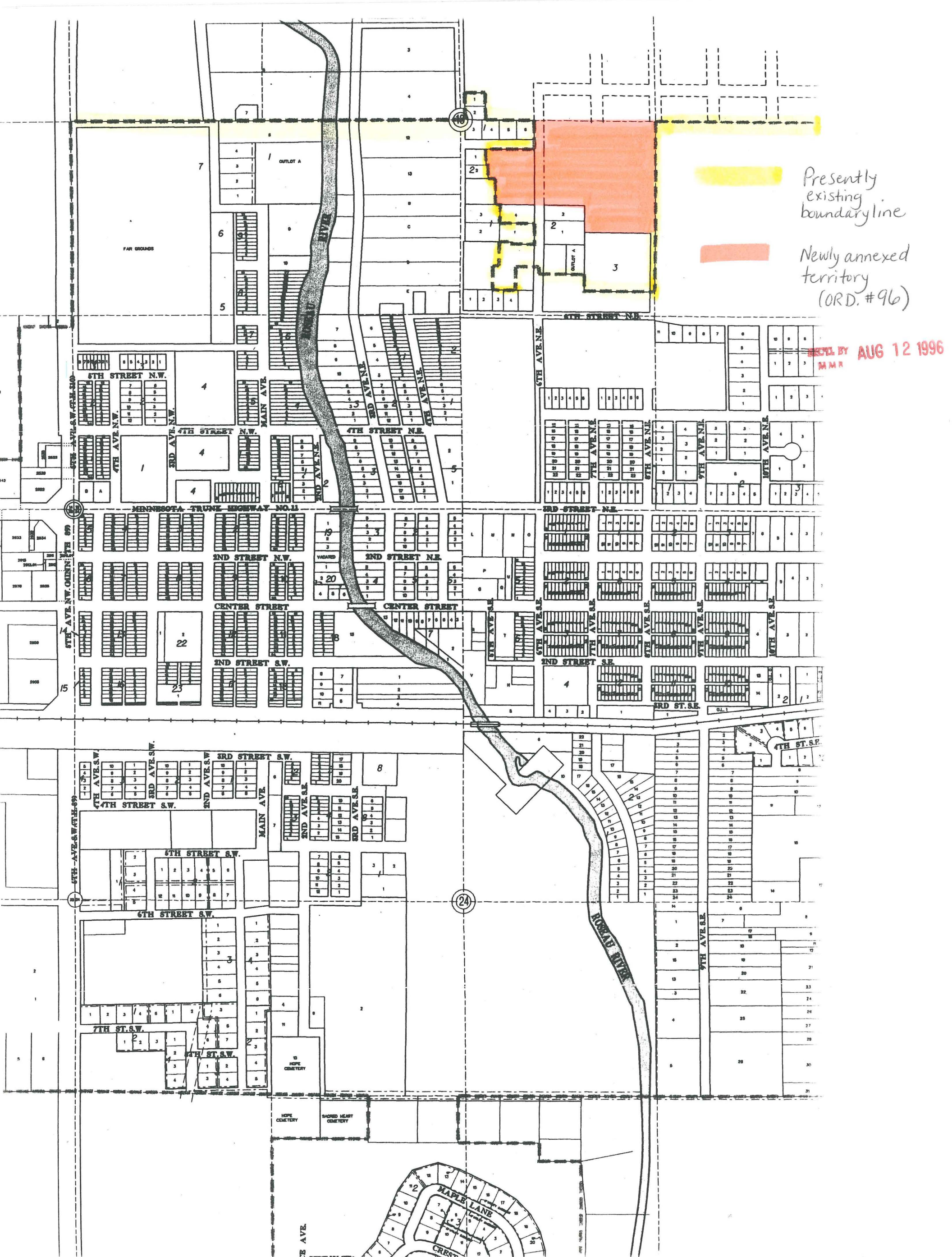

Presently
existing
boundaryline

Newly annexed
territory
(ORD. #96)

RECEIVED BY AUG 12 1996
MMR