

**CITY OF FARMINGTON  
DAKOTA COUNTY, MINNESOTA**

**ORDINANCE NO 095-367**

**An Ordinance Annexing Certain Properties Abutting the City of Farmington**

**WHEREAS**, the City of Farmington ("City") received a petition for annexation from all of the property owners of each of the following described properties (collectively "Properties"):

a. The West 80 feet of the East four (4) acres of the South six (6) acres of the South half ( $S\frac{1}{2}$ ) of the Northwest Quarter of the Northwest Quarter ( $NW\frac{1}{4}$  of  $NW\frac{1}{4}$ ) of Section 32, Township 114, Range 19, and the East 89 feet of the West 169 feet of the East four (4) acres of the South six (6) acres of the South half ( $S\frac{1}{2}$ ) of the  $NW\frac{1}{4}$  of the  $NW\frac{1}{4}$  of Section 32, Township 114, Range 19, all in Dakota County, Minnesota;

b. That part of the Northwest Quarter of the Northwest Quarter ( $NW\frac{1}{4}$  of  $NW\frac{1}{4}$ ) of Section 32, Township 114, Range 19, described as beginning at a point on the south line thereof 740.55 feet East along the said south line from the southwest corner of the said  $NW\frac{1}{4}$  of the  $NW\frac{1}{4}$ , thence North parallel with the West line of the said  $NW\frac{1}{4}$  of  $NW\frac{1}{4}$  193 feet; thence East parallel with the south line of said  $NW\frac{1}{4}$  of  $NW\frac{1}{4}$  320 feet; thence South parallel with the West line of said  $NW\frac{1}{4}$  of  $NW\frac{1}{4}$  193 feet to the south line of the said  $NW\frac{1}{4}$  of  $NW\frac{1}{4}$ , thence West along the south line of said  $NW\frac{1}{4}$  of  $NW\frac{1}{4}$  320 feet to the point of beginning, according to the Government Survey thereof.

**WHEREAS**, each of the Properties is located in Empire Township, Dakota County, Minnesota; and

**WHEREAS**, each of the Properties abuts the City; and

**WHEREAS**, the area of each of the Properties is sixty acres or less; and

**WHEREAS**, none of the Properties are served by public sewer facilities nor are public sewer facilities otherwise available; and

WHEREAS, the City held a public hearing on December 18, 1995, after providing 30 days written notice of the public hearing by certified mail to Empire Township and to all landowners within and contiguous to each of the Properties; and

WHEREAS, pursuant to the procedures set forth in Minn. Stat. § 414.033, the City Council of the City of Farmington may by ordinance declare the Properties to be annexed to the City; and

NOW, THEREFORE, BE IT ORDAINED THAT the City of Farmington hereby annexes the Properties, pursuant to the procedures set forth in Minnesota Statutes § 414.033.

Enacted and ordained the 18th day of December, 1995.

CITY OF FARMINGTON, COUNTY OF DAKOTA  
HEREBY CERTIFIES THAT THE ATTACHED IS  
A FULL AND TRUE COPY AS IT APPEARS ON  
FILE IN THE OFFICE OF THE CITY CLERK.  
DATED THIS 8<sup>th</sup> DAY OF February 1996

Harv Zinstue  
Interim City Administrator

Attest:

[Signature]

CITY OF FARMINGTON

Eugene "Babe" Kuchera  
Mayor

Harv M. Zinstue  
City Administrator (Interim)

SEAL

This ordinance approved as to form the 5<sup>th</sup> day of February, 1996

[Signature]  
City Attorney

Published in the Farmington Independent the 15<sup>th</sup> day of February, 1996

RECEIVED FEB 14 1996

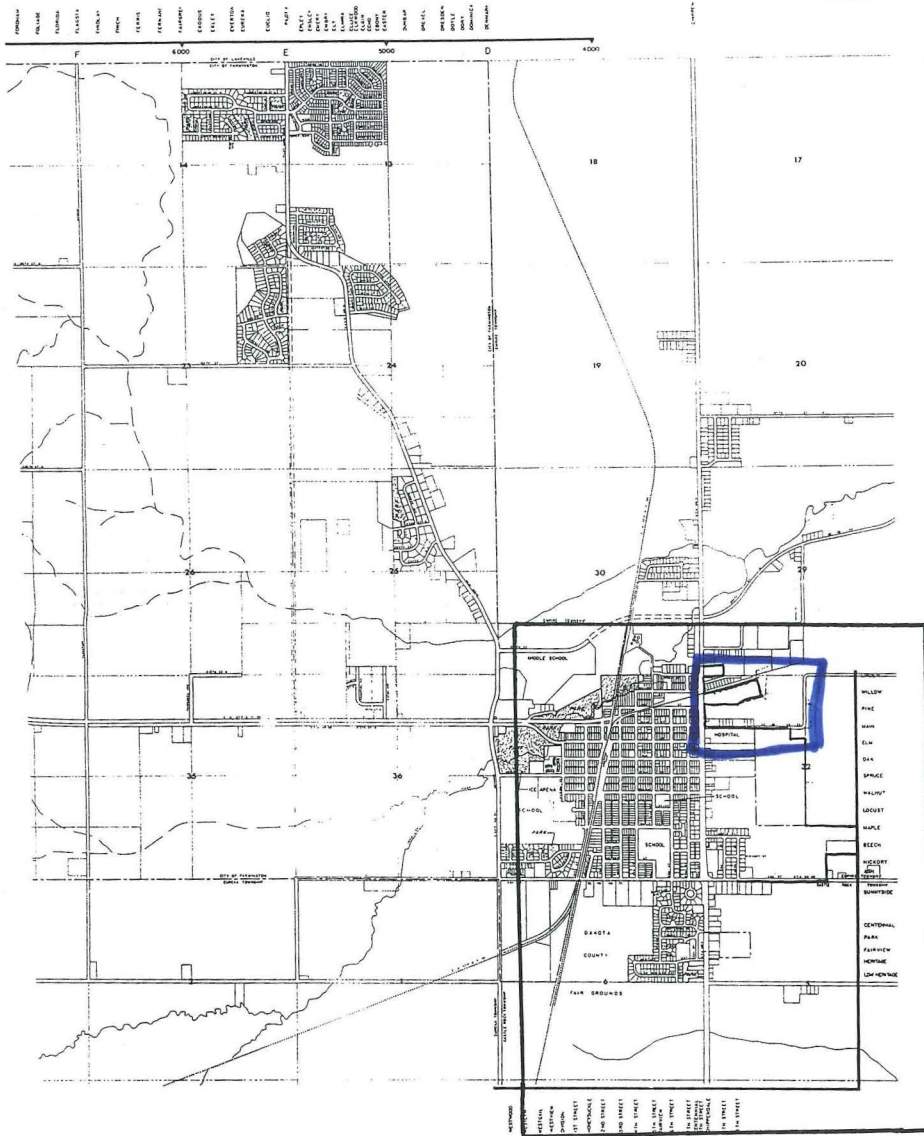

CITY OF FARMINGTON

AREA OF  
DETAIL

A A B

SW 1/4 SEC 29

NW CORNER

NW 1/4 SEC. 32

