

CITY OF BUHL
AMENDED ORDINANCE NO. 19-2ND SERIES

AN ORDINANCE CLARIFYING THE LEGAL DESCRIPTION OF CERTAIN PARCELS TO BE ANNEXED TO THE CITY OF BUHL, MINNESOTA.

THE CITY COUNCIL OF BUHL, MINNESOTA ORDAINS:

The Council, in and for the City of Buhl, Minnesota, has enacted an Ordinance annexing certain parcels to the City of Buhl, Minnesota and placing the same within the jurisdiction of said City by Ordinance No. 19-2nd Series.

WHEREAS, the legal description in the Ordinance is unclear as to whether Highway 169 itself is included in the area annexed; and

WHEREAS, it is the intent of the Council that said property be annexed to and become a part of said City including that portion of the right of way of Highway 169 located upon said property; and

WHEREAS, said land to be annexed is legally described as follows and includes the highway right of way, to-wit:

Northeast Quarter of the Southwest Quarter (NE 1/4 SW 1/4) (STUBLER PIT), AND Southeast Quarter of the Southwest Quarter (SE 1/4 SW 1/4) (NORTH HALF (N 1/2) JUDSON PIT), Section Twenty (20), Township Fifty-eight (58), Range Nineteen (19), AND Northeast Quarter of the Northwest Quarter (NE 1/4 NW 1/4) (SOUTH HALF (S 1/2) JUDSON PIT), AND Northwest Quarter of the Northeast Quarter (NW 1/4 NE 1/4), Section Twenty-nine (29), Township Fifty-eight (58), Range Nineteen (19), according to the Government Survey thereof on file and of record in the Office of the County Recorder, St. Louis County, Minnesota, subject to restrictions, reservations and easements of record.

NOW, THEREFORE, the Council in and for the City of Buhl, Minnesota, hereby determines, ordains, and declares as follows:

Section 1. **BEST INTEREST OF THE CITY OF BUHL AND AREA TO BE ANNEXED.** The annexation will be in the best interest of the City of Buhl and of the territory affected.

Section 2. **ANNEXATION.** The said real estate is hereby annexed to and included within the City of Buhl, Minnesota as effectually as if it had originally been a part hereof.

Section 3. **EFFECTIVE DATE.** This Ordinance shall be filed and shall take effect and be in full force and effect from and after filing certificate thereof with the Minnesota Municipal Commission, the County of St. Louis, Minnesota, and the Secretary of State of the State of Minnesota, and from and after its adoption and publication.

This Ordinance introduced by Mayor Battaglia
This Ordinance adopted on 11/08/95

This Ordinance introduced on 11/08/95

Adopted this 8th day of November, 19 95.

ATTEST:
Donna M. Esterberg
Donna M. Esterberg, Clerk

CITY OF BUHL
Ray Battaglia
BY: Raymond A. Battaglia
Its Mayor

REC'D BY
AEMB JUL 21 1995

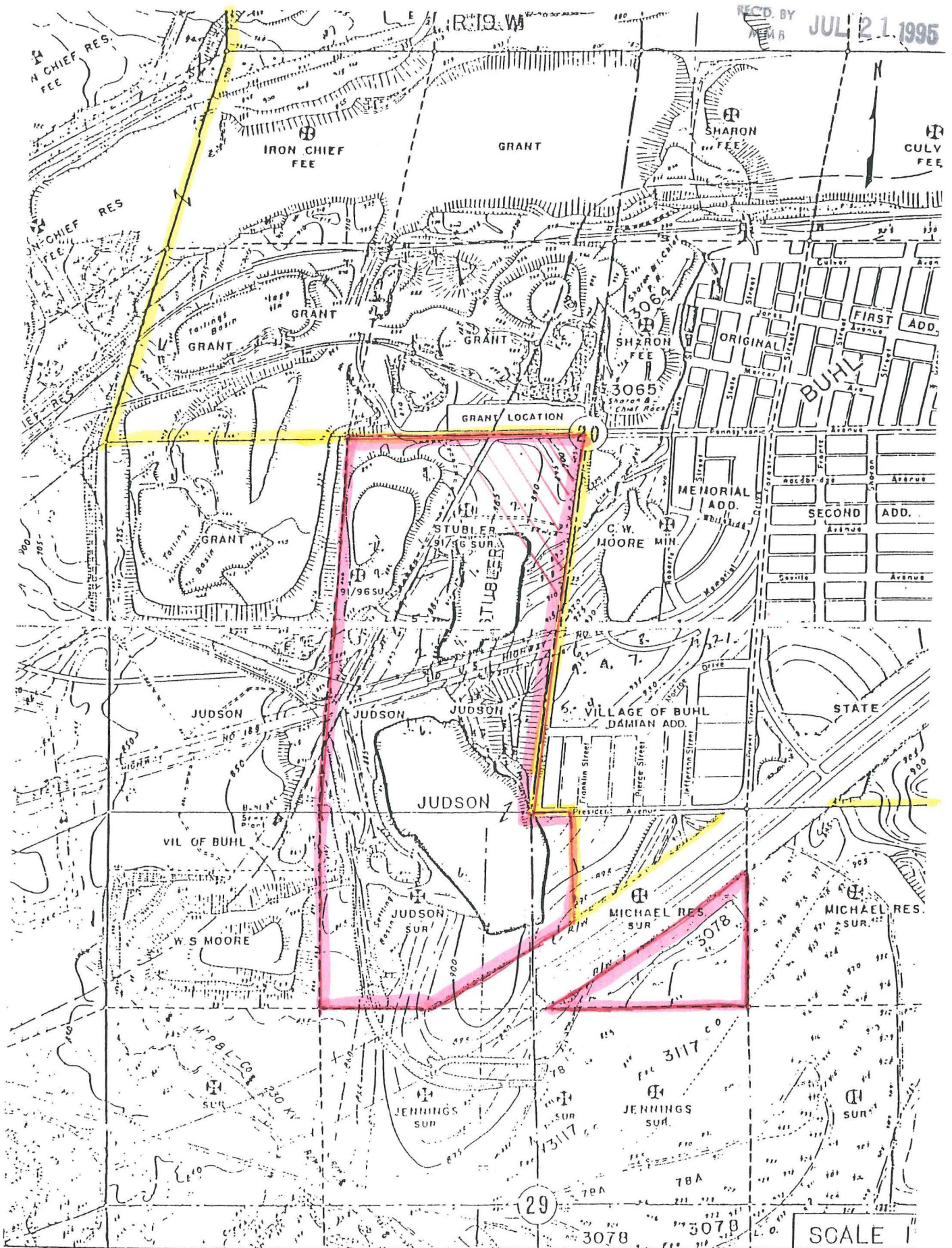

City of Buhl
 Proposed annexation = —
 Existing City Limits = —