

ORDINANCE NO. 1047

AN ORDINANCE EXTENDING THE CORPORATE LIMITS OF THE CITY OF WILLMAR, A MUNICIPAL CORPORATION OF THE STATE OF MINNESOTA, TO INCLUDE CERTAIN LANDS OWNED BY THE CITY

WHEREAS, the City of Willmar acquired certain property for the purpose of airport development; and

WHEREAS, said property is owned in fee by the City of Willmar; and

WHEREAS, it is proposed to annex by virtue hereof to the said City of Willmar, said property, all of which said property is in Kandiyohi County, Minnesota; and

WHEREAS, pursuant to Minnesota law, said land may be annexed by ordinance; and

WHEREAS, the said real estate to be annexed is described as follows, to-wit:

The Southwest 1/4 of the Southeast 1/4, and part of the Northwest 1/4 of the Southeast 1/4 described as the South 215 feet of the West 565 feet, Section 17, Township 119, Range 35.

and

The North 1320 feet of the West 1980 feet of the Northwest 1/4 of Section 20, Township 119, Range 35.

NOW, THEREFORE, the City Council of the City of Willmar hereby determines, ordains, and declares as follows:

Section 1. STATUTORY COMPLIANCE. The City Council hereby determines and finds that the property abuts the municipality, and that the annexation complies with all of the provisions of Minnesota Statute 414.033.

Section 2. BEST INTEREST OF THE CITY OF WILLMAR AND AREA TO BE ANNEXED. That the annexation will be in the best interest of the City of Willmar, Minnesota, and of the territory affected.

Section 3. OWNED BY THE CITY. That the real estate above described is owned in fee title by the City of Willmar.

Section 4. ANNEXATION. That the said real estate is hereby annexed to, and included within, the City of Willmar, Minnesota, as effectually as if it had originally been a part hereof.

Section 5. ZONING. That the above described real estate shall be zoned A-Agriculture.

Section 6. ACREAGE. The parcels have a combined area of 102.79 acres.

Section 7. EFFECTIVE DATE. This Ordinance shall be filed and shall take effect and be in full force and effect from and after filing a certificate thereof with the Minnesota Municipal Board, the County of Kandiyohi, Minnesota, and the Secretary of State of the State of Minnesota, and from and after its adoption and publication.

This Ordinance introduced by Councilman: Enockson
This Ordinance introduced on: December 15, 1993
This Ordinance published on: December 21, 1993
This Ordinance given a hearing on: January 5, 1994
This Ordinance adopted on: January 5, 1994
This Ordinance published on: January 11, 1994

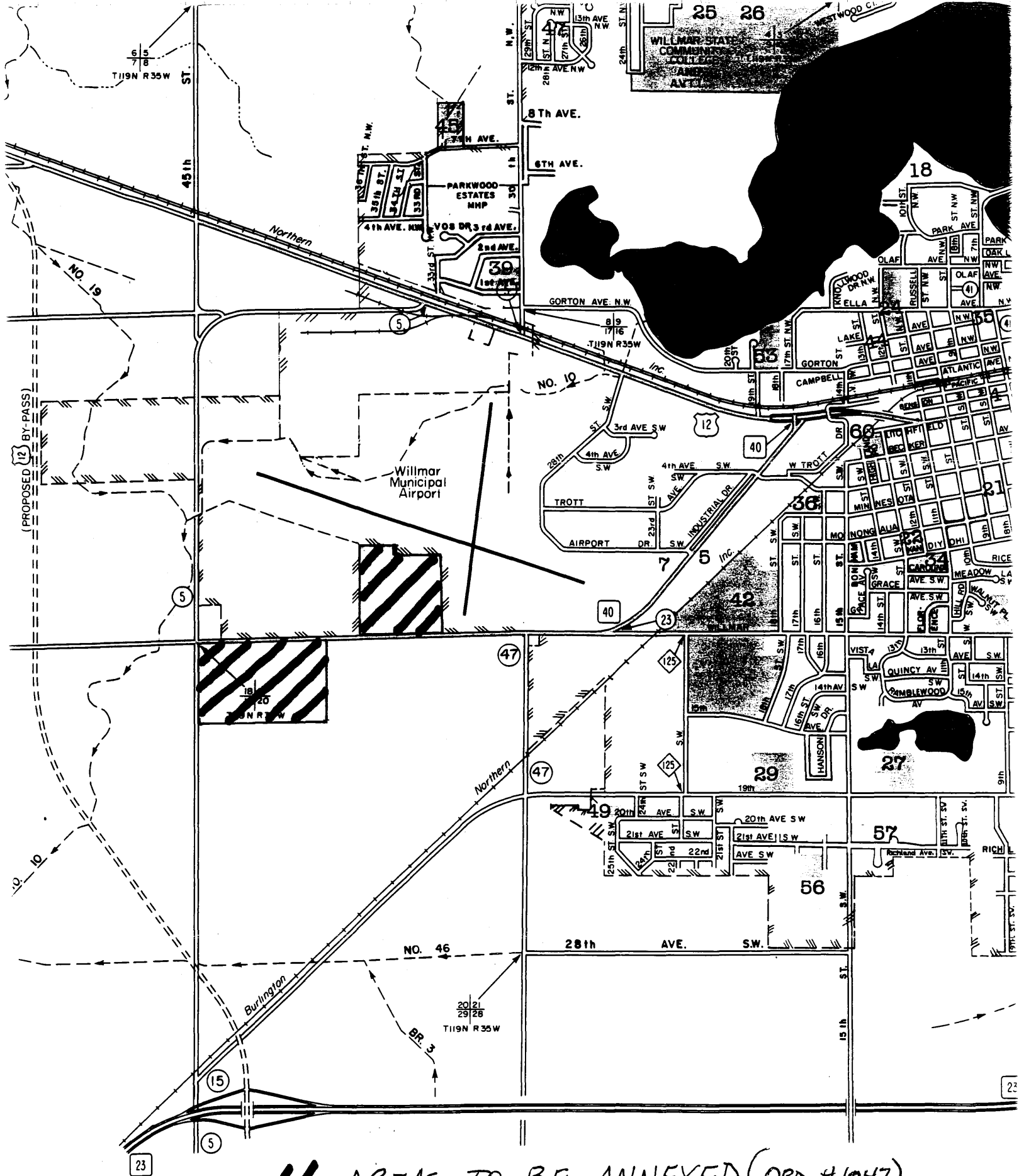

AREAS TO BE ANNEXED (ORD. #1047)

REC'D BY JAN 21 1994