

ORDINANCE NO. 311

AN ORDINANCE ANNEXING UNINCORPORATED LAND IN THE TOWN OF
LA CRESCENT, HOUSTON COUNTY, MINNESOTA TO THE CITY OF LA
CRESCENT, HOUSTON COUNTY, MINNESOTA PURSUANT TO MINNESOTA
STATUTES § 414.033, SUBD. 2(1), PERMITTING ANNEXATION BY ORDINANCE

The City Council of the City of La Crescent, Houston County, Minnesota hereby ordains:

SECTION I. That the unincorporated land described in Section IV is owned exclusively by the City of La Crescent. The described lands currently are within the Town of La Crescent, Houston County, Minnesota.

SECTION II. That said land is urban or suburban in character or are about to become so.

SECTION III. Said land abuts the existing corporate limits of the City of La Crescent, is unplatted and consists of approximately nine acres.

SECTION IV. Said land is legally described as follows:

A tract of land in the south half of the Northeast Quarter of the Southeast Quarter, Section 4, Township 104 North, Range 4 West, bordered on the West by the East line of Lot 2, Block 1, Crescent Hills First Addition, bordered on the North by the South line of Valley View Estates Addition, bordered on the East by the West line of Crescent Hills Third Addition, and bordered on the South by Crescent Hills Drive, a township road as described by resolution establishing a town road, recorded in book 287 of miscellaneous, Page 75, in the Office of the County Recorder, Houston County, Minnesota containing nine acres more or less.

SECTION V. The City Clerk is hereby directed to file certified copies of this ordinance with the Minnesota Municipal Board, the Secretary of State, the Town of La Crescent Clerk, and the Houston County Auditor.

SECTION VI. This ordinance shall become effective and said land duly annexed to the City of La Crescent upon the due passage and enactment, approval by the Minnesota Municipal Board and publication of this Ordinance according to law.

Passed and enacted this 6th day of December, 1993.

APPROVED:



ATTEST:



City Clerk-Administrator

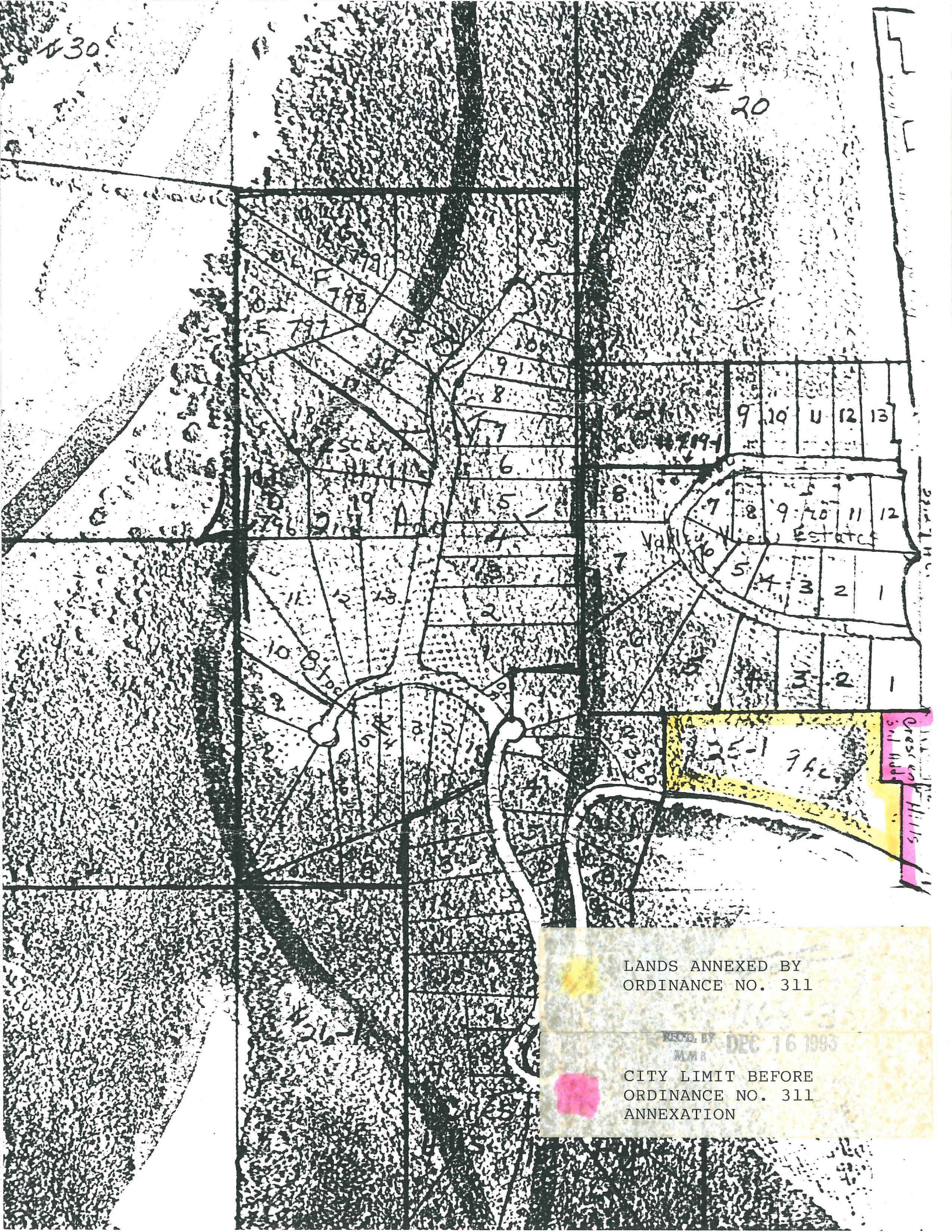

LANDS ANNEXED BY
ORDINANCE NO. 311

REC'D BY DEC 16 1993
MMB

CITY LIMIT BEFORE
ORDINANCE NO. 311
ANNEXATION