

ORDINANCE NO. 2887

AN ORDINANCE ANNEXING TO THE CITY OF ROCHESTER A PORTION OF THE SOUTHEAST QUARTER OF THE SOUTHEAST QUARTER OF SECTION 8, A PORTION OF THE NORTH HALF OF THE NORTHEAST QUARTER OF SECTION 17, AND A PORTION OF THE NORTHEAST QUARTER OF THE NORTHEAST QUARTER OF SECTION 25, TOWNSHIP 107 NORTH, RANGE 14 WEST, OLMSTED COUNTY, MINNESOTA.

THE COMMON COUNCIL OF THE CITY OF ROCHESTER DO ORDAIN:

Section 1. The Common Council of the City of Rochester has initiated the annexation of the lands described in Exhibit A, attached hereto and incorporated herein, located in Cascade Township, Olmsted County, Minnesota.

Section 2. The quantity of land included in this annexation is approximately 33.68 acres in size.

Section 3. The Common Council of the City of Rochester does hereby determine that the land described in Exhibit A is subject to annexation by the City of Rochester pursuant to a Joint Resolution For Orderly Annexation executed by the City of Rochester and the Town of Cascade.

Section 4. Therefore, pursuant to the Joint Resolution For Orderly Annexation, the land described in Exhibit A is hereby annexed, added to and made a part of the City of Rochester, Minnesota, as effectually as if it had originally been a part thereof.

Section 5. This ordinance shall take effect and be in force from and after its official publication and from and after the filing of a certified copy hereof with the Minnesota Municipal board, the Cascade Town Clerk, the County Auditor, and the Secretary of State.

PASSED AND ADOPTED BY THE COMMON COUNCIL OF THE CITY OF ROCHESTER, MINNESOTA, THIS 2 DAY OF August, 1993.

Dee B. Selby
PRESIDENT OF SAID COMMON COUNCIL

ATTEST: Carole G. Drimmer
CITY CLERK

APPROVED THIS 3 DAY OF August, 1993.

Dee B. Selby
MAYOR OF SAID CITY

(Seal of the City of
Rochester, Minnesota)

EXHIBIT A

Parcel 1

That part of the Southeast Quarter of the Southeast Quarter of Section 8, Township 107 North, Range 14 West, Olmsted County, Minnesota, described as follows:

Commencing at the southeast corner of the Southeast Quarter of said Section 8; thence WEST, assumed bearing, along the south line thereof, 986.33 feet to the southwest corner of NORTH PARK for the point of beginning (the next 2 courses are along the westerly line of said NORTH PARK); thence North 01 degree 14 minutes 00 seconds East, 590.64 feet; thence WEST, 297.00 feet to the northeast corner of Outlot "A", NORTH PARK THIRD SUBDIVISION; thence South 01 degree 14 minutes 00 seconds West, along the east line of said Outlot "A" and the southerly prolongation thereof, 590.64 feet to the south line of said Southeast Quarter; thence EAST, 297.00 feet to the point of beginning.

ALSO:

A part of the North Half of the Northeast Quarter of Section 17, Township 107 North, Range 14 West, Olmsted County, Minnesota, described as follows:

Commencing at the northwest corner of said Northeast Quarter; thence EAST, assumed bearing, along the north line thereof, 887.08 feet for the point of beginning; thence continue EAST, along said north line, 512.50 feet; thence South 01 degree 04 minutes 00 seconds West, 260.00 feet; thence South 36 degrees 16 minutes 00 seconds West, 48.95 feet; thence North 88 degrees 56 minutes 00 seconds West, 141.78 feet; thence North 57 degrees 15 minutes 00 seconds West, 400.65 feet; thence NORTH, 80.00 feet to the point of beginning.

Containing in all 6.6 acres, more or less.

Parcel 2

That part of the Northeast Quarter of the Northeast Quarter of Section 25, Township 107 North, Range 14 West, Olmsted County, Minnesota, described as follows:

Beginning at the northeast corner of said Northeast Quarter of the Northeast Quarter; thence southerly on a Minnesota State Plane Grid Azimuth from north of 179 degrees 42 minutes 20 seconds along the east line of said Northeast Quarter of the Northeast Quarter 640.29 feet to the northerly corner of Lot 12, Block 1 of Northern Heights East Sixth Subdivision; thence southwesterly 238 degrees 00 minutes 03 seconds azimuth along the northwesterly line of said Northern Heights East Sixth Subdivision 225.01 feet to the westerly corner of Lot 13, Block 1 of said Northern Heights East Sixth Subdivision; thence westerly 285 degrees 59 minutes 33 seconds azimuth

along the northerly line of said Northern Heights East Sixth Subdivision 515.00 feet to the northwesterly corner of Lot 30, Block 1 of said Northern Heights East Sixth Subdivision; thence southerly 195 degrees 59 minutes 33 seconds azimuth along the westerly line of said Lot 30, a distance of 220.00 feet to the westerly corner of said Lot 30; thence southeasterly 153 degrees 34 minutes 51 seconds azimuth along the southwesterly line of Lots 30 and 31, Block 1 of said Northern Heights East Subdivision 200.92 feet to the northerly corner of Lot 51, Block 1 of Northern Heights East Sixth Subdivision; thence southwesterly 212 degrees 29 minutes 33 seconds azimuth along the northwesterly line of said Lot 51 and a southwesterly extension thereof 205.97 feet to the northerly corner of Northern Heights East Fifth Subdivision, according to the plat thereof on file at the County Recorder's Office, Olmsted County, Minnesota; thence northwesterly 393.26 feet on a nontangential curve concave northeasterly, with a radius of 437.50 feet and a central angle of 51 degrees 30 minutes 07 seconds and a chord azimuth of 328 degrees 14 minutes 40 seconds; thence westerly 263 degrees 59 minutes 40 seconds azimuth 150.00 feet; thence northerly 353 degrees 59 minutes 40 seconds azimuth 293.40 feet; thence northwesterly 320 degrees 53 minutes 29 seconds azimuth 122.88 feet; thence westerly 287 degrees 47 minutes 18 seconds azimuth 82.42 feet to the west line of said Northeast Quarter of the Northeast Quarter; thence northerly 359 degrees 42 minutes 12 seconds azimuth along said west line 457.61 feet to the northwest corner of said Northeast Quarter of the Northeast Quarter; thence easterly 89 degrees 46 minutes 01 seconds azimuth along the north line of said Northeast Quarter of the Northeast Quarter 1302.79 feet to the point of beginning.

Said tract contains 22.95 acres more or less.

Parcel 3

A part of the Northeast Quarter of the Northeast Quarter (NE 1/4 of NE 1/4) of Section Seventeen (17), Township One Hundred Seven (107) North, Range Fourteen (14) West, described as follows: Beginning at the Northeast corner of said Northeast Quarter of Section 17; thence West, along the North line of said Northeast Quarter (bearings assumed) a distance of 530.00 feet; thence South, 349.82 feet to the North line of lands previously conveyed to the City of Rochester; thence South 75 degrees 56 minutes 30 seconds East along said North line, 535.43 feet to the East line of the Northeast Quarter of Section 17; thence North 1 degree 16 minutes 00 seconds East along the East line of said Section 17, a distance of 480.00 feet to the point of beginning, EXCEPT that part of the above described property which lies south and east of the southerly right of way line of County State Aid Highway No. 22 as shown on OLMSTED COUNTY HIGHWAY RIGHT OF WAY PLAT NO. 77 recorded in the office of the County Recorder as Document No. 624144, Book J-5 of Misc. on Page 366.

Containing 4.13 acres, more or less.

From: TROCH.PUBLIC
SERVICES

SCALE:
1" = 30'

PREPARED BY:
McGHEE & BETTS, INC.
CONSULTING ENGINEER
PLANNERS
LAND SURVEYORS

PROPOSED NORTHERN
HEIGHTS EAST EIGHTH

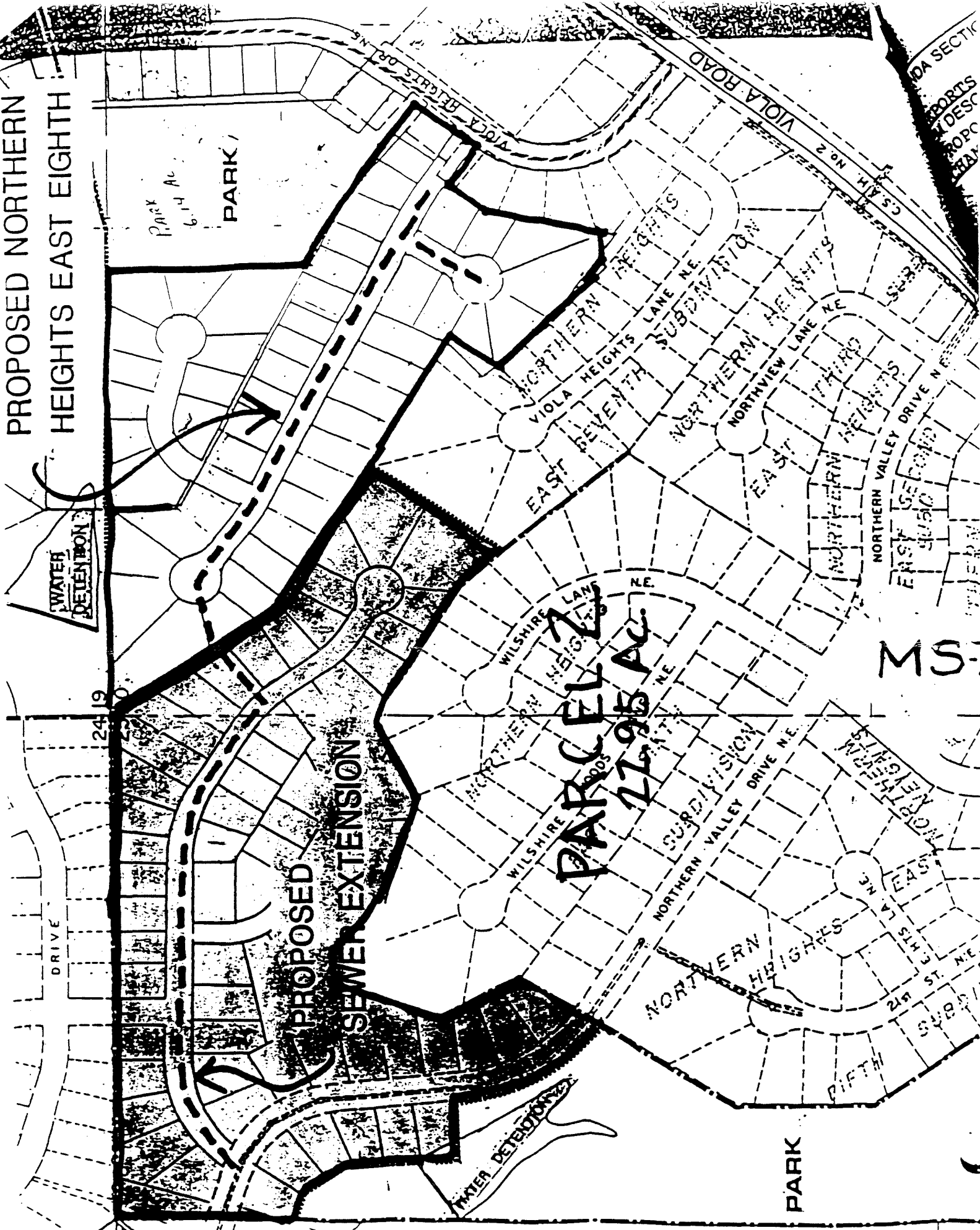

PROPOSED ANNEXATION EXHIBIT

FOR: ~~DOCH.~~ PUBLIC
SERVICES

PARCEL 3
4.13 AC.

SCALE:
1"=200'

REC'D BY
AUG 06 1993

PREPARED BY:
McGHEE & BETTS, INC.
CONSULTING ENGINEER:
PLANNERS
LAND SURVEYORS

