

ORDINANCE NO. 220 2ND SERIES

RECEIVED BY JUL 19 1993  
MMR

AN ORDINANCE OF THE CITY OF THIEF RIVER FALLS, MINNESOTA, AMENDING CITY CODE CHAPTER 20 ENTITLED "LISTING OF UNCODED ORDINANCES IN EFFECT" BY EXTENDING THE CORPORATE LIMITS OF THE CITY OF THIEF RIVER FALLS TO INCLUDE UNINCORPORATED UNPLATTED LAND NOT EXCEEDING 60 ACRES IN AREA ABUTTING UPON THE CITY LIMITS

WHEREAS, A certain petition dated July 22, 1992 requesting annexation of the territory hereinafter described was duly presented to the Thief River Falls City Council, and

WHEREAS, No objections to the annexation have been received from the North Town Board, and

WHEREAS, The territory described herein abuts upon the City limits and is urban or suburban in character and none of the territory is now included within the limits of any city, and

WHEREAS, The approximate population of this territory is one business.

THE CITY COUNCIL OF THIEF RIVER FALLS ORDAINS:

Section 1. City Code Chapter 20 entitled "Listing of Uncoded Ordinances in Effect" is hereby amended by adding this Section to read:

Territory Annexed. The corporate limits of the City of Thief River Falls are hereby extended to include the unplatted territory described as follows and the same is hereby annexed to and included within the City of Thief River Falls as effectually as if it had originally been a part thereof:

A parcel of land which is part of the South Half of the Southeast Quarter (S $\frac{1}{2}$ SE $\frac{1}{4}$ ) of Section Thirty-two (32), Township One Hundred Fifty-four (154) North of Range Forty-three (43) West, Pennington County, Minnesota, bounded as follows:

Beginning at a point on the South line of said Section 32 lying 845.16' West of the Southeast Corner of said Section 32; thence continuing West along said South line a distance of 740'; thence North along a line parallel with the East line of said Section a distance of 610'; thence East along a line parallel with the said South line a distance of 740'; thence South a distance of 610' to the point of beginning, containing 10.4 acres.

Section 2. Filing. The City Clerk is hereby directed to file certified copies of this Ordinance with the Minnesota Municipal Board, Secretary of State, the North Town Clerk, and the Pennington County Auditor.

RECEIVED JUL 19 1993  
MAYOR

Section 3. This ordinance shall be in force and effect from and after its passage, approval and publication.

Passed by the City Council of Thief River Falls, Minnesota, on the 13th day of July, 1993.

VOTING AYE: Barron, Burstad, Anderson, Carlson, Heinrichs, Wennberg, Hamerlinck and Mayor Reeve

VOTING NO: None

ABSENT: None

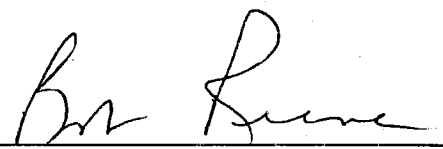
  
\_\_\_\_\_  
Mayor

ATTEST:

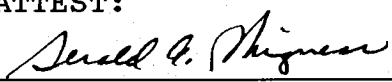
  
\_\_\_\_\_  
City Clerk - Treasurer

(Published in the Times Newspaper on the 21st day of July, 1993)

RECEIVED BY  
JUN 23 1993 06 1993

# NORTH

CODE -11

TOWNSHIP 154 NORTH

RANGE 43 WEST

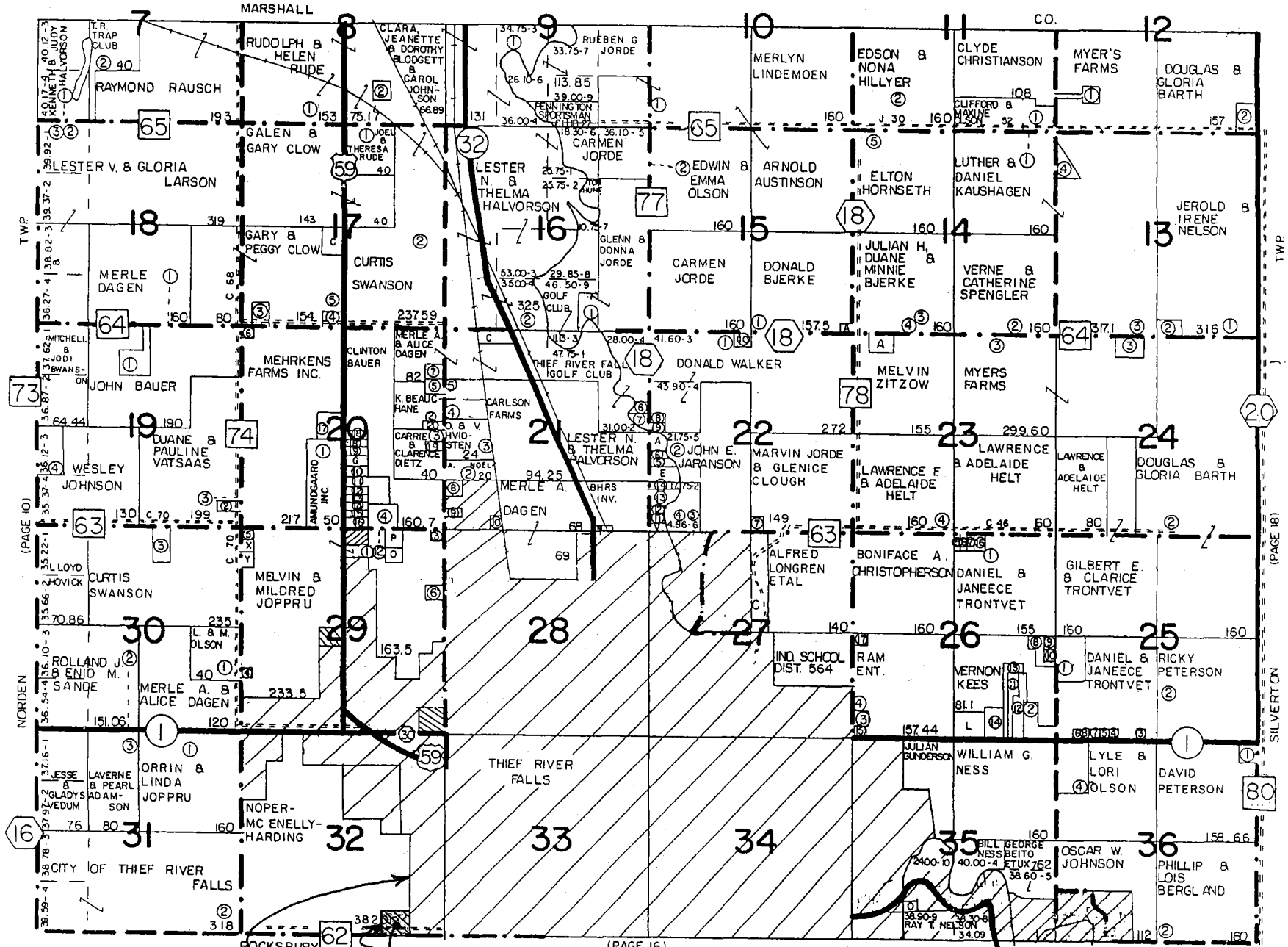

EXHIBIT "B"  
SKETCH OF PROPOSED ANNEXATION  
TO THE CITY OF THIEF RIVER FALLS, MN.  
BY: STRATA INC.  
DATED: MAY 20TH, 1992

EXISTING CITY LIMITS

PROPOSED CITY LIMITS

10.4 ACRES (DESCRIPTION ON REVERSE SIDE)

TWP.