

ORDINANCE NO. 219 2ND SERIES

AN ORDINANCE OF THE CITY OF THIEF RIVER FALLS, MINNESOTA, AMENDING CITY CODE CHAPTER 20 ENTITLED "LISTING OF UNCODED ORDINANCES IN EFFECT" BY EXTENDING THE CORPORATE LIMITS OF THE CITY OF THIEF RIVER FALLS TO INCLUDE UNINCORPORATED UNPLATTED LAND NOT EXCEEDING 60 ACRES IN AREA ABUTTING UPON THE CITY LIMITS

WHEREAS, A certain petition dated June 21, 1993 requesting annexation of the territory hereinafter described was duly presented to the Thief River Falls City Council, and

WHEREAS, No objections to the annexation have been received from the Rocksbury Town Board, and

WHEREAS, The territory described herein abuts upon the City limits and is urban or suburban in character and none of the territory is now included within the limits of any city, and

WHEREAS, The approximate population of this territory is one business with one multiple family unit expected.

THE CITY COUNCIL OF THIEF RIVER FALLS ORDAINS:

Section 1. City Code Chapter 20 entitled "Listing of Uncoded Ordinances in Effect" is hereby amended by adding this Section to read:

Territory Annexed. The corporate limits of the City of Thief River Falls are hereby extended to include the unplatted territory described as follows and the same is hereby annexed to and included within the City of Thief River Falls as effectually as if it had originally been a part thereof:

That part of Government Lot 1, Section 3 and that part of Government Lot 1, Section 2, all in Township 153 North, Range 43 West of the Fifth Principal Meridian described as follows:

Commencing at an iron monument at the northwest corner of said Government Lot 1, Section 2; thence South 00 degrees 30 minutes 42 seconds East, assumed bearing, along the west line of said Government Lot 1, Section 2 a distance of 33.00 feet to an iron pipe monument being the point of beginning of the tract to be described, also being on the south line of Greenwood Street; thence South 89 degrees 39 minutes 50 seconds East along said south line 131.52 feet to an iron pipe monument; thence South 42 degrees 21 minutes 41 seconds East 284.43 feet to an iron pipe monument; thence South 89 degrees 39 minutes 50 seconds East, parallel with the north line of said Government Lot 1, Section 2 a distance of 975.81 feet, more or less to the centerline of Trunk Highway No. 59; thence South 40 degrees 27

RECD. BY JUL 19 1993
MAG

minutes 00 seconds East along said centerline 33.02 feet; thence North 89 degrees 39 minutes 50 seconds West, parallel with the north line of said Government Lot 1, Section 2 a distance of 871.80 feet; thence South 00 degrees 30 minutes 42 seconds East 64.27 feet; thence South 89 degrees 59 minutes 59 seconds West 565.76 feet to the centerline of County Ditch No. 1; thence North 25 degrees 11 minutes 04 seconds West along said centerline 326.18 feet to the said south line of Greenwood Street; thence North 88 degrees 42 minutes 22 seconds East along said south line 255.45 feet to the point of beginning, containing 3.79 acres, more or less, subject to easements, restrictions or reservations of record, if any.

Section 2. Filing. The City Clerk is hereby directed to file certified copies of this Ordinance with the Minnesota Municipal Board, Secretary of State, the Rocksbury Town Clerk, and the Pennington County Auditor.

Section 3. This ordinance shall be in force and effect from and after its passage, approval and publication.

CERTIFICATION BY CITY CLERK

Second

I hereby certify that the attached Ordinance No. 219, Series is a true and correct copy of the original now on file in my office and is still in full force and effect.

Dated this 16th day of July, 1993

Municipal Seal

Gerald A. Wigness
Gerald A. Wigness, City Clerk-Treasurer

ATTEST:

Shall A. Wigness
City Clerk - Treasurer

(Published in the Times Newspaper on the 21st day of July, 1993)

ROCKSBURY

CODE -16

Area to be annexed

TOWNSHIP 153 NORTH

RANGE 43 WEST

(PAGE 11)

(PAGE 15)

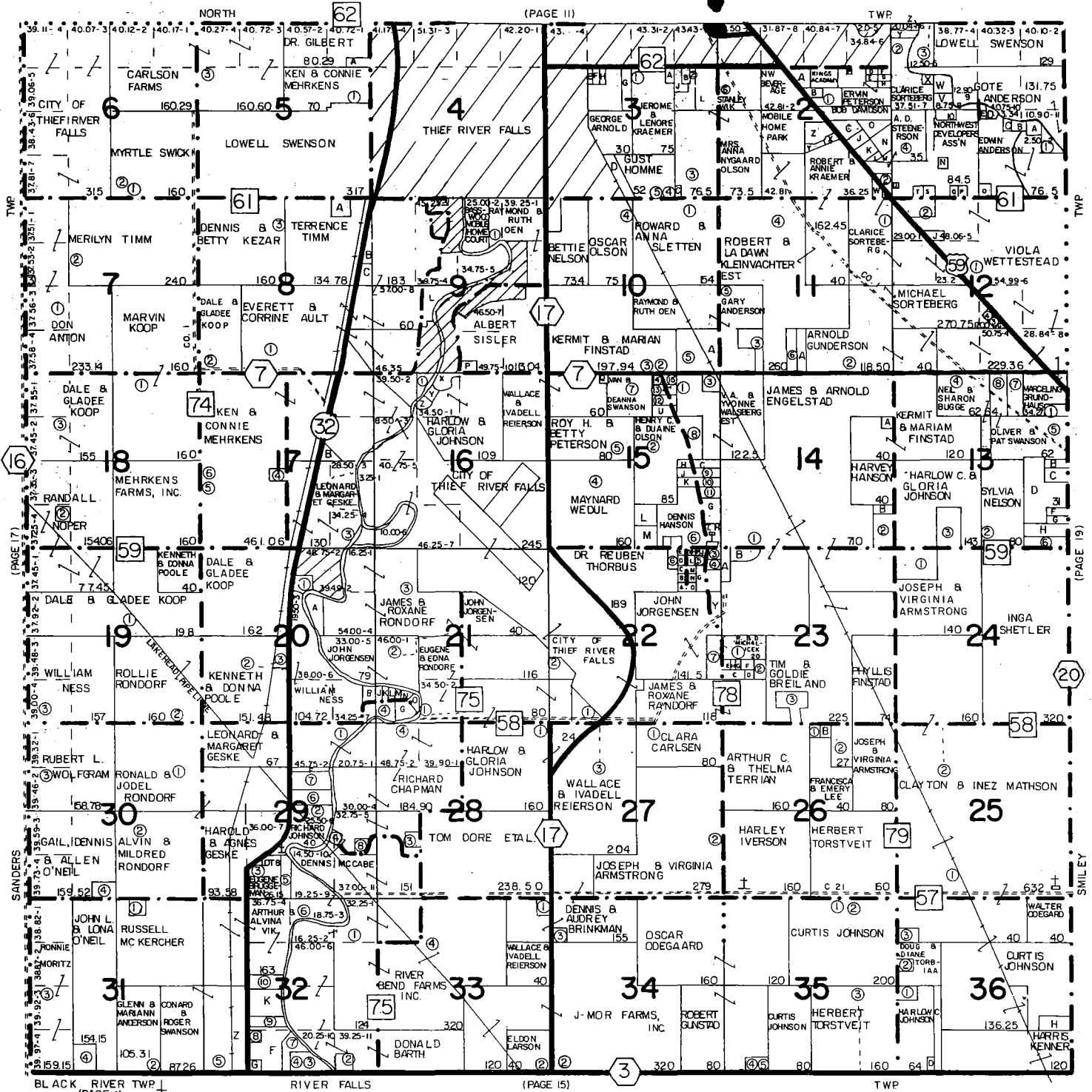

1	2	3	4	5	6	7	8	9	10	11	12	13	14	15	16	17	18	19	20	21	22	23	24	25	26	27	28	29	30	31	32	33	34	35	36
1	2	3	4	5	6	7	8	9	10	11	12	13	14	15	16	17	18	19	20	21	22	23	24	25	26	27	28	29	30	31	32	33	34	35	36