

REC'D BY JUN 23 1993
MAB

ORDINANCE No. 040593

AN ORDINANCE EXTENDING THE CORPORATE LIMITS OF THE CITY OF MAHNOMEN
TO INCLUDE CERTAIN UNINCORPORATED PROPERTY OWNED BY AND ABUTTING
UPON THE LIMITS OF THE CITY OF MAHNOMEN

WHEREAS, the territory described below is not presently within
the corporate limits of any incorporated city; and

WHEREAS, this territory abuts the corporate limits of the city
at the Easterly Boundary thereof and is deemed to be urban or
suburban in character; and

WHEREAS, this territory is owned in fee by the City; and

The City Council of Mahnomen ordains:

SECTION 1. TERRITORY ANNEXED

The corporate limits of the City of Mahnomen are hereby
extended to include property described as follows now owned by
the City:

The Easterly 210 feet of the Northwest Quarter of the
Southeast Quarter (NW 1/4 SE 1/4) and the Northeast Quarter of
the Southeast Quarter (NE 1/4 SE 1/4) except the South Eleven
(11) rods thereof in Section Two (2); and also the Northwest
Quarter of the Southwest Quarter (NW 1/4 SW 1/4) except the
South Eleven (11) rods thereof in Section One (1), all in
Township One Hundred Forty Four (144) North, Range Forty Two
(42) West, containing 76 acres, more or less, subject to
easements, reservations and restrictions of record.

SECTION 2. The City Clerk/Administrator is directed to
file certified copies of this Ordinance with the Secretary of
State, the County Auditor of Mahnomen County, the Town Clerk of the
affected Township and the Minnesota Municipal Board.

SECTION 23. EFFECTIVE DATE OF ANNEXATION

This Ordinance takes effect upon its passage and publication
and the filing of certified copies as directed in Section 2.

Adopted by the City of Mahnomen, Minnesota this 5th day of
April, 1993.

MAYOR

ATTEST:

CITY CLERK/ADMINISTRATOR

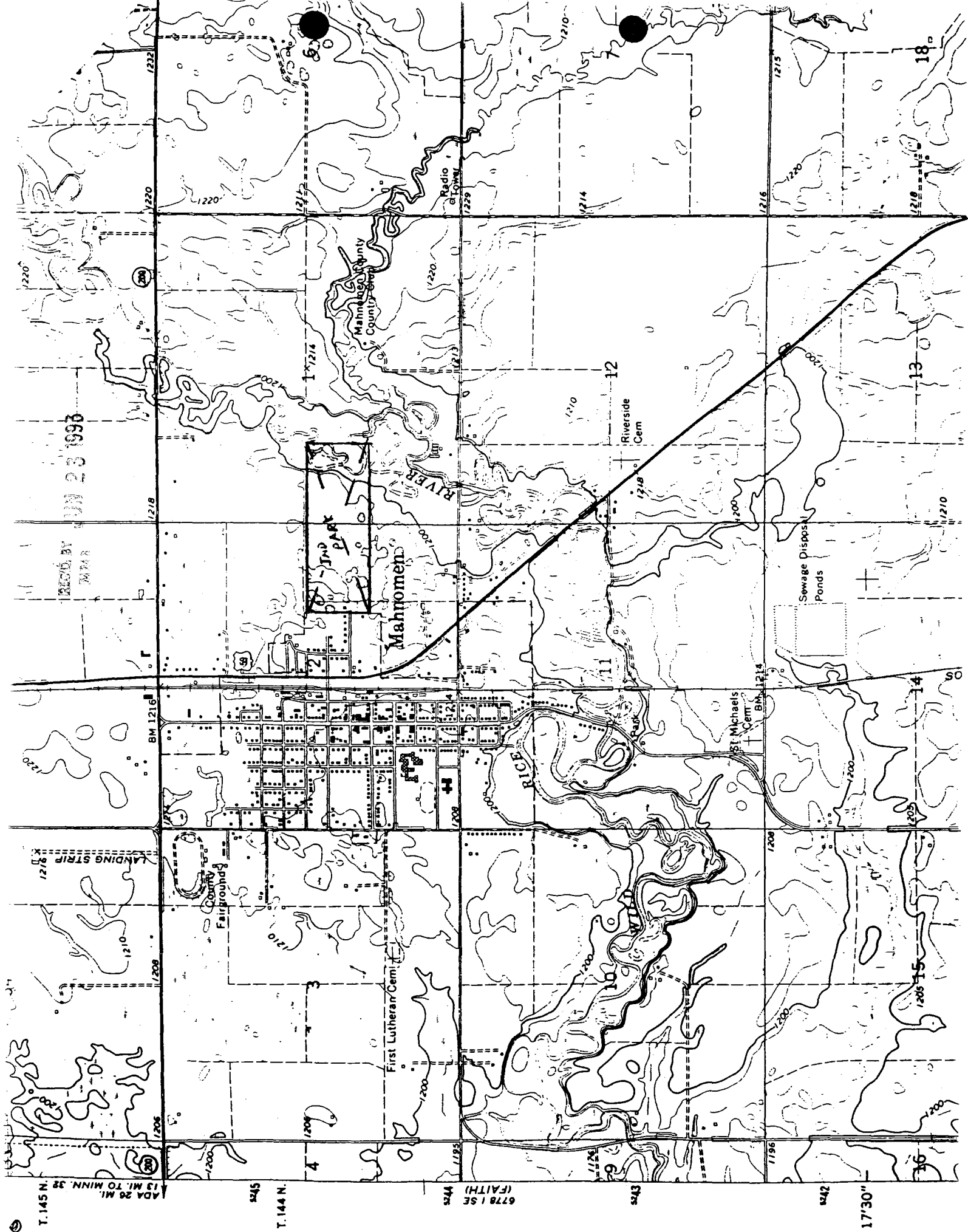

REC'D BY JUN 23 1993
EAB

