

REC'D BY MAY 03 1993  
MMP

CITY OF BUFFALO  
ORDINANCE NO. 4, Series 4

AN ORDINANCE ANNEXING CERTAIN PROPERTIES TO  
THE CITY OF BUFFALO

SECTION 1. That as a result of petition for annexation submitted by an owner of real estate described therein, which lands abut the City of Buffalo and the subject area is less than 60 acres, the City of Buffalo is permitted to annex the lands by ordinance pursuant to Minnesota Statutes, Chapter 414.033, Subdivision 2(3), and in as much as the required notice of utility data has been provided for more than 30 days pursuant to Minnesota Statutes, Chapter 414.0325, Subdivision 1a;

IT IS HEREBY ORDAINED that the land described on Attachment 1 shall be, and hereby is, annexed to the City of Buffalo.

SECTION 2. This ordinance shall be of full force and effect from and after its passage, publication and filing with the Minnesota Municipal Board, Rockford Township, the Wright County Auditor and the Minnesota Secretary of State and final approval of this ordinance by the Municipal Board.

ADOPTED by the City Council of the City of Buffalo this  
29th day of April, 1993.

YES: Brad Nauman, Delvin Haag, Fred Naaktgeboren, and Marcia Paulsen

NO:: None

ABSENT: Mike Demmer

  
Fred Naaktgeboren, Mayor

ATTEST:

  
Merton T. Auger, City Administrator

ATTACHMENT 1  
TO AN ORDINANCE ANNEXING CERTAIN PROPERTIES TO  
THE CITY OF BUFFALO

That part of the North Half of the Northeast Quarter and that part of the north one rod of the East Half of the Southeast Quarter of the Northeast Quarter and that part of the Southwest Quarter of the Northeast Quarter of Section 6, Township 119, Range 25, Wright County, Minnesota, described as follows: Beginning at the northeast corner of the said North Half of the Northeast Quarter; thence North  $89^{\circ} 02' 51''$  West, assumed bearing, along the north line of the said North Half of the Northeast Quarter, a distance of 2290.54 feet; thence South  $0^{\circ} 57' 09''$  West, a distance of 40.00 feet; thence North  $89^{\circ} 02' 51''$  West, a distance of 150.00 feet; thence South  $0^{\circ} 58' 00''$  West, a distance of 135.00 feet; thence South  $35^{\circ} 50' 00''$  East, a distance of 137.83 feet; thence South  $53^{\circ} 50' 00''$  East, a distance of 618.00 feet; thence South  $74^{\circ} 25' 00''$  East, a distance of 301.64 feet; thence southwesterly along a nontangential curve, concave to the southeast, having a radius of 335.03 feet and a central angle of  $19^{\circ} 29' 58''$ , a distance of 114.02 feet, the chord of said curve bears South  $26^{\circ} 32' 08''$  West, distance 113.47 feet; thence South  $16^{\circ} 47' 09''$  West, tangent to said curve, a distance of 105.00 feet; thence North  $73^{\circ} 00' 00''$  West, a distance of 210.00 feet; thence South  $82^{\circ} 20' 00''$  West, a distance of 195.00 feet; thence South  $8^{\circ} 30' 00''$  West, a distance of 195.00 feet; thence South  $25^{\circ} 05' 00''$  East, a distance of 310.00 feet; thence South  $10^{\circ} 40' 00''$  East, a distance of 150.00 feet; thence South  $51^{\circ} 00' 00''$  East, a distance of 192.00 feet; thence North  $66^{\circ} 00' 00''$  East, a distance of 192.00 feet; thence North  $66^{\circ} 00' 00''$  East, a distance of 205.00 feet; thence North  $17^{\circ} 55' 00''$  East, a distance of 145.00 feet; thence North  $3^{\circ} 30' 00''$  East, a distance of 180.00 feet; thence North  $15^{\circ} 29' 27''$  East, a distance of 270.45 feet; thence North  $73^{\circ} 12' 51''$  West, a distance of 145.00 feet; thence North  $16^{\circ} 47' 09''$  East, a distance of 45.00 feet; thence South  $73^{\circ} 12' 51''$  East, a distance of 150.00 feet; thence North  $42^{\circ} 00' 00''$  East, a distance of 205.00 feet; thence North  $62^{\circ} 30' 00''$  East, a distance of 415.000 feet; thence North  $34^{\circ} 00' 00''$  East, a distance of 140.00 feet; thence North  $26^{\circ} 14' 53''$ , a distance of 105.07 feet; thence South  $89^{\circ} 02' 51''$  East, a distance of 330.00 feet; thence South  $48^{\circ} 00' 00''$  East, a distance of 75.00 feet; thence South  $13^{\circ} 05' 00''$  West, a distance of 635.00 feet; thence South  $13^{\circ} 01' 59''$  East, a distance of 216.60 feet to the south line of the north one rod of the said East Half of the Southeast Quarter of the Northeast Quarter; thence North  $89^{\circ} 45' 57''$  East along the said south line, a distance of 536.27 feet, to the east line of the said Northeast Quarter; thence North  $1^{\circ} 00' 12''$  West along the east line of the said Northeast Quarter, a distance of 1226.06 feet to the point of beginning. Containing 47.26 acres and subject to the right of way of Minnesota State Highway No. 25 along the east line of the said Northeast Quarter.

## WEST ROCKFORD NORTHWEST FRANKLIN

T. 119N.-R. 25 W.

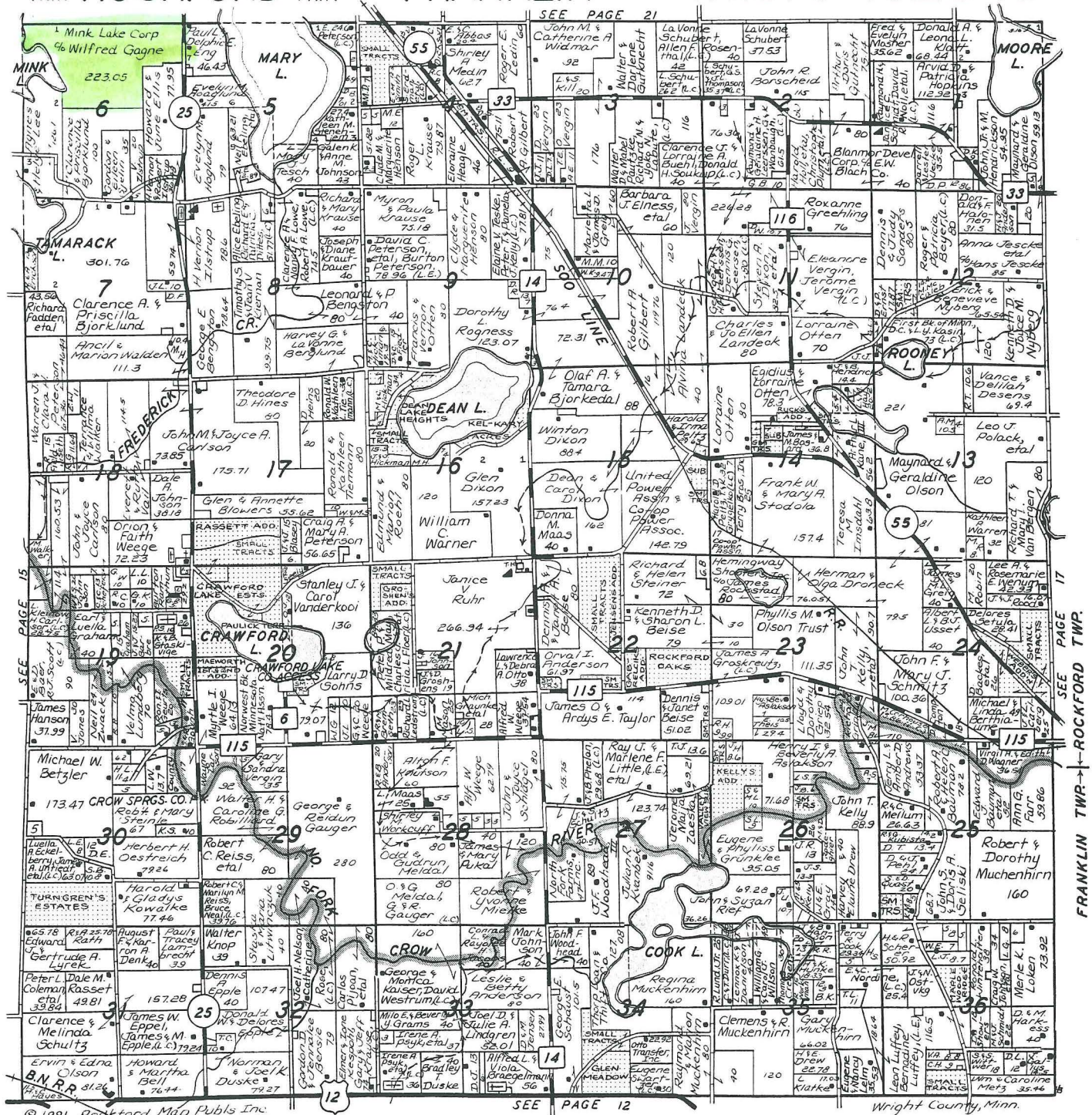

## GRINLEY &amp; TUKUA

RICHARD GRINLEY  
ATTORNEY AT LAWKRISTI L. TUKUA  
ATTORNEY AT LAWBox F — 120 North River Street  
Delano, Minnesota 55328

Phone:

(612) 479-2531 (Metro) or (612) 972-2926

ROW  
RIVER  
REALTY, INC.

Local: 972-3389

Minneapolis: 479-3389

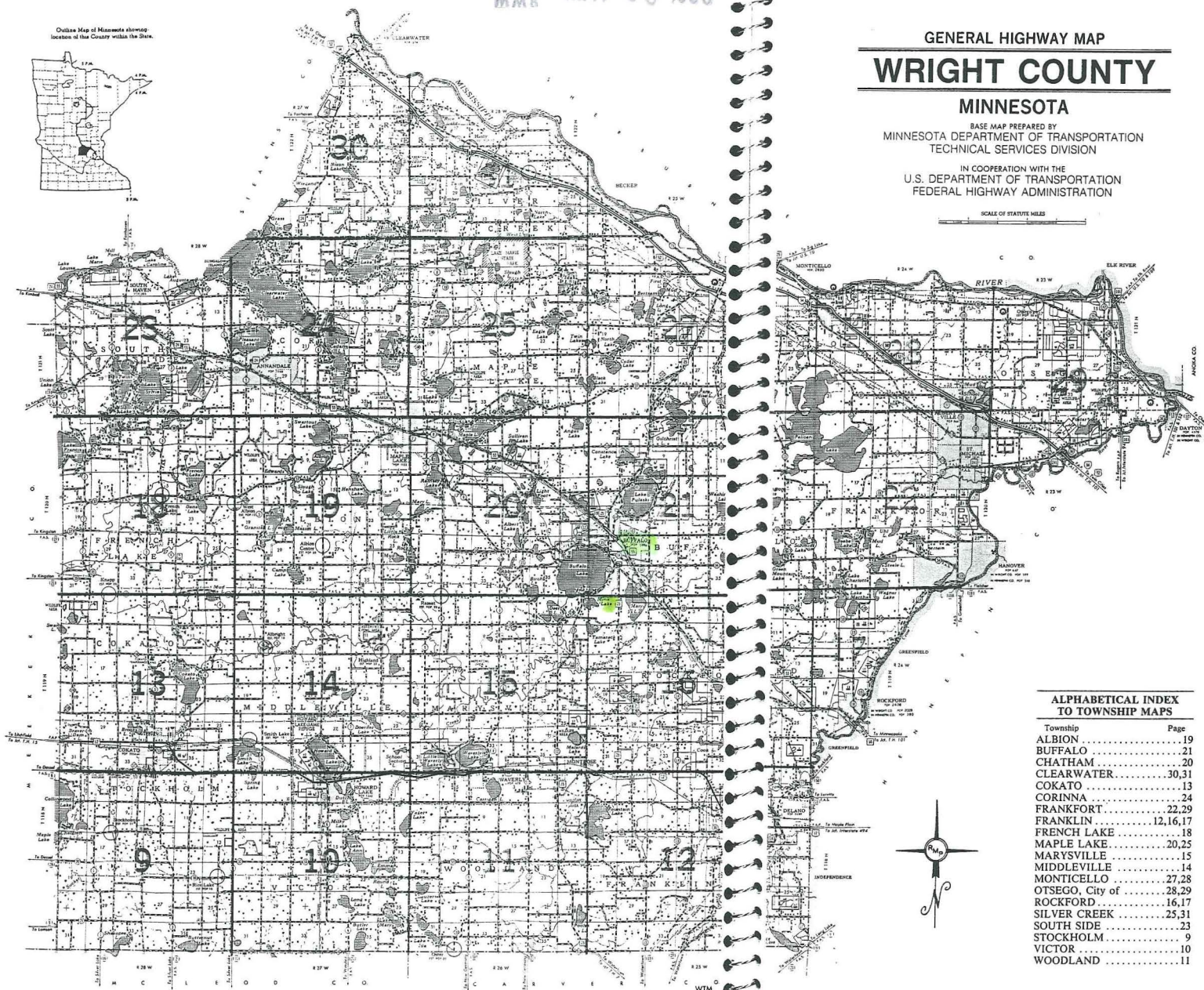

## MINNESOTA

BASE MAP PREPARED BY  
MINNESOTA DEPARTMENT OF TRANSPORTATION  
TECHNICAL SERVICES DIVISION

IN COOPERATION WITH THE  
U.S. DEPARTMENT OF TRANSPORTATION  
FEDERAL HIGHWAY ADMINISTRATION

SCALE OF STATUTE MILES

### LEGEND

#### ROAD AND ROADWAY FEATURES

## NAVIGATOR

- [illegible]

ALPHABETICAL INDEX  
TO TOWNSHIP MAPS

Township	Page
ALBION	15
BUFFALO	21
CHATHAM	21
CLEARWATER	30, 31
COKATO	13
CORINNA	24
FRANKFORT	22, 29
FRANKLIN	12, 16, 17
FRENCH LAKE	18
MAPLE LAKE	20, 25
MARYSVILLE	15
MONTICELLO	14
MONTICELLO	27, 28
OTSEGO, City of	28, 29
ROCKFORD	16, 17
SILVER CREEK	25, 31
SOUTH SIDE	23
STOCKHOLM	9
VICTOR	10
WOODLAND	11

MAP PAGE DIVISIONS  
SHOWN IN RED