

## ORDINANCE NO. 1993-1

**AN ORDINANCE EXTENDING THE CORPORATE LIMITS OF THE  
CITY OF RUSH CITY, MINNESOTA, TO INCLUDE CERTAIN LAND OWNED BY  
ADRIAN ROBINSON, EVELYN ROBINSON, AND ISD NUMBER 139 AND  
ABUTTING THE CITY OF RUSH CITY**

WHEREAS, Adrian Robinson, Evelyn Robinson, and Independent School District Number 139 have petitioned for annexation of certain lands described in Attachment "A" to be annexed to the City of Rush City.

WHEREAS, Adrian Robinson, Evelyn Robinson, and Independent School District Number 139 represent that they are the sole owners of the property, that the property is unincorporated, abuts the city limits of the City of Rush City, is not included within another municipality, is not included in any area that has already been designated for orderly annexation pursuant to Minnesota Statutes 414.0325, and is approximately  $\pm$  28.29 acres in size.

NOW, THEREFORE, the City Council of Rush City, Minnesota does ordain:

Section 1. The City Council hereby determines and finds that the property abuts the municipality, that the area to be annexed is sixty (60) acres or less, that the property is not included in any area that has already been designated for orderly annexation pursuant to Minnesota Statutes 414.0325, that the municipality has received a properly prepared petition for annexation from all the owners of the property, and that the petition complies with all the provisions of Minnesota Statute 414.033.

Section 2. The property is urban in nature or about to become so.

Section 3. The corporate limits of the City of Rush City are hereby extended to include the property and the same is hereby annexed to and included within the City of Rush City as if the property had originally been a part thereof.

Section 4. The City Administrator is hereby directed to file certified copies of the ordinance with the Minnesota Municipal Board, Rushseba Township, the Chisago County Auditor, and the Minnesota Secretary of State.

Section 5. This ordinance takes effect upon its passage and publication and the filing of the certified copies as directed in Section 4 and approval of the ordinance by the Minnesota Municipal Board.

Adopted this 26th day of January, 1993

ATTEST:

Mike F. Thompson  
Mike F. Thompson, City Administrator

Michael Skalsky  
Michael Skalsky, Mayor

**HULT & ASSOCIATES, Inc.***Land Surveyors*

8895 Lake Blvd. (Hwy. 8)  
Forest Lake, Minn. 55025  
Phone 464-3130

February 5, 1993

Mailing Address:

P.O. Box 37  
Forest Lake, Minn. 55025

DESCRIPTION FOR: City of Rush City

DESCRIPTION: Proposed extension of Colfax Street

A perpetual non-exclusive easement for public roadway and public utility purposes extending over, under and across that part of the North 30 feet of the South Half of the Southeast Quarter of Section 16, Township 37 North, Range 21 West, Chisago County, Minnesota, lying westerly of the northerly extension of the westerly line of Eliot Avenue as dedicated on the recorded plat of ADRIAN PINEVIEW, Chisago County, Minnesota and lying easterly of the West 16.5 feet of said South Half of the Southeast Quarter.

ALSO

A perpetual non-exclusive easement for public roadway and public utility purposes extending over, under and across that part of the South 30 feet of the North Half of the Southeast Quarter of Section 16, Township 37 North, Range 21 West, Chisago County, Minnesota, lying westerly of the northerly extension of the westerly line of Eliot Avenue as dedicated on the recorded plat of ADRIAN PINEVIEW, Chisago County, Minnesota and lying easterly of the West 16.5 feet of said South Half of the Southeast Quarter.

Rec'd 2-9-93

CITY OF RUSA CITY

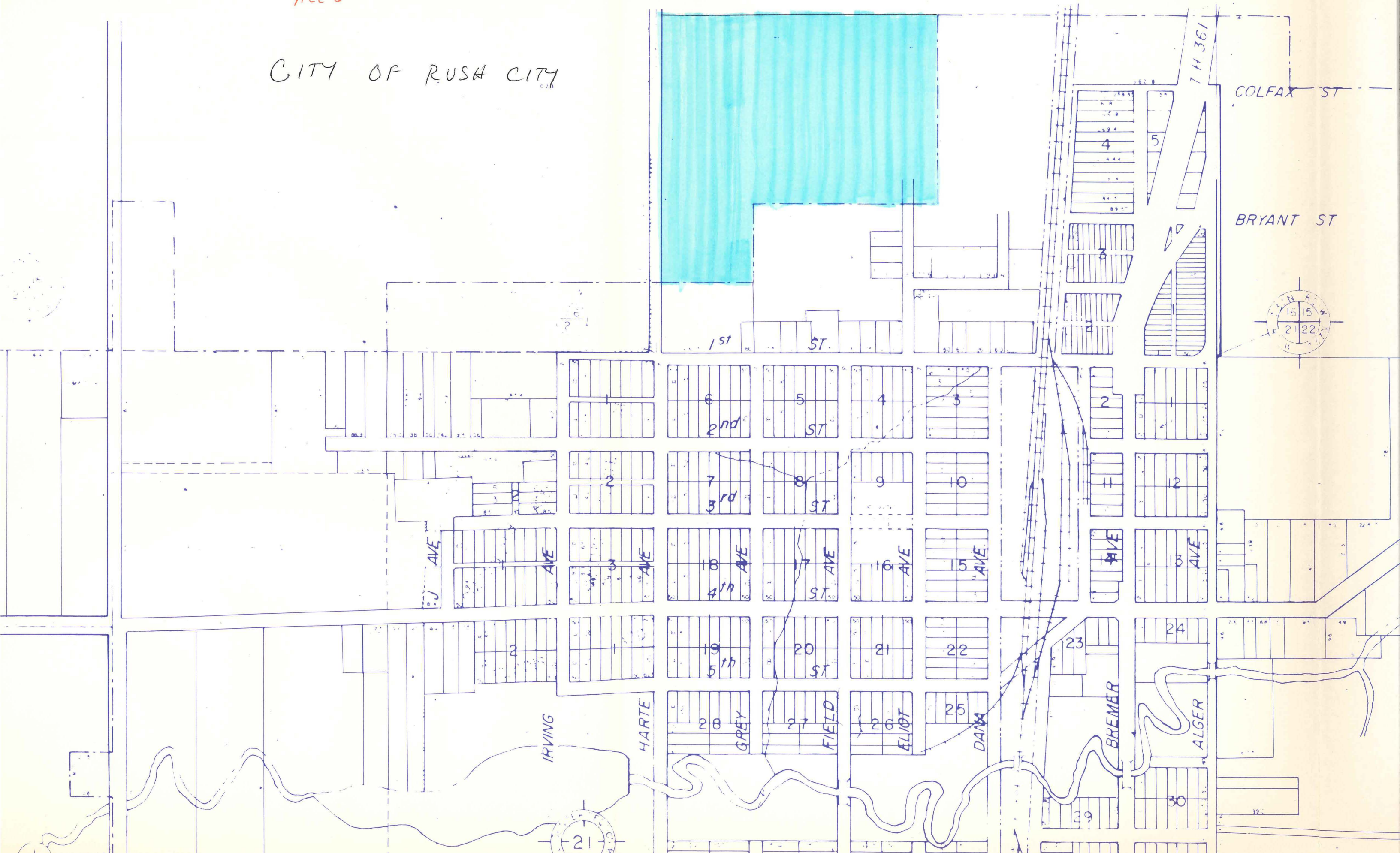



# ATTACHMENT "A"

SCALE: 1 INCH = 200 FEET

JAN. 11, 1993

