

REC'D. BY  
MMB OCT 14 1992

Proposed Ordinance No. 14/92

ORDINANCE NO. 1066

AN ORDINANCE EXTENDING THE CORPORATE LIMITS  
OF THE CITY OF OWATONNA TO INCLUDE CERTAIN UNINCORPORATED LAND  
ABUTTING THE CITY OF OWATONNA.

WHEREAS, all owners of the property described herein have petitioned for annexation of the described property to the City of Owatonna; and

WHEREAS, the property described lies in the Southeast Quarter of Section 2, Township 107 North, Range 20 West, and comprises approximately .83 acres including street right-of-way; and

WHEREAS, said property is suitably conditioned for and needs urban government; and

WHEREAS, no part of the property described herein is included within the limits of an incorporated city; and

WHEREAS, the City has authority, pursuant to Minnesota Statutes 414.033, Subdivision 2 (3) to declare the property described herein annexed to the City; and

WHEREAS, the City of Owatonna is a city of the third class operating under a Home Rule Charter adopted pursuant to the provisions of the Constitution and Laws of the State of Minnesota.

NOW THEREFORE, THE CITY COUNCIL OF THE CITY OF OWATONNA DO ORDAIN:

SECTION 1. The City Council hereby determines:

1. That the annexation will be to the best interest of the City of Owatonna and of the property affected.
2. All property owners have petitioned the City for annexation of this property and said property is suitably conditioned for and needs urban government.
3. That none of said properties are now included within the limits of any incorporated city.

SECTION 2. That the following described property, referred to in the preamble of this ordinance, situated in the County of Steele, State of Minnesota, to-wit:

That property in the Southeast Quarter of Section 2,  
Township 107 North, Range 20 West, described as:

Commencing at the Southwest corner of the East Half of the Southeast Quarter of Section 2, Township 107 North, Range 20 West, running thence North along the West line of said tract 152 feet, thence East parallel with the South line of said tract 236.92 feet, thence South parallel with the West line of said tract 152 feet, thence West along the South line of said tract 236.92 feet to the place of beginning.

be and the same hereby is annexed to the City of Owatonna and shall, upon the effective date of this ordinance, become a part of the City of Owatonna as effectively as if it had been originally a part thereof, and the corporate limits of said City of Owatonna are hereby extended to include said unplatted land.

**SECTION 3.** The Zone Class R-1 shall be applied to the lands herein described.

**SECTION 4.** This ordinance is enacted pursuant to the provisions of Minnesota Statutes, Chapter 414, Section 414.033, Subd. 2 (3).

**SECTION 5.** Upon its adoption, a certified copy of this ordinance shall be filed with each of the following:

Owatonna Town Clerk  
Minnesota Municipal Board  
Steele County Auditor  
Minnesota Secretary of State

as provided by law.

**SECTION 6.** This Ordinance shall take effect upon its passage, publication and approval by the Minnesota Municipal Board.

Passed and adopted this 6th day of October, 1992, with the following vote: Aye 7; No 0; Absent 0.

Approved and signed this 6th day of October, 1992.

  
\_\_\_\_\_  
Mayor

ATTEST:

  
\_\_\_\_\_  
City Clerk

ET N.E.

IRON

49.5'

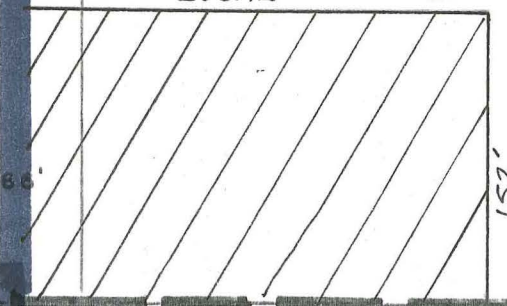

ANNEXATION UNDER ORDINANCE 1066

21A

CITY LIMITS

REC'D BY  
MMB OCT 14 1992

2	1
11	12

REC'D. BY OCT 14 1992  
MMB

RECENTLY ANNEXED

ANNEXATION ORDINANCE 1066

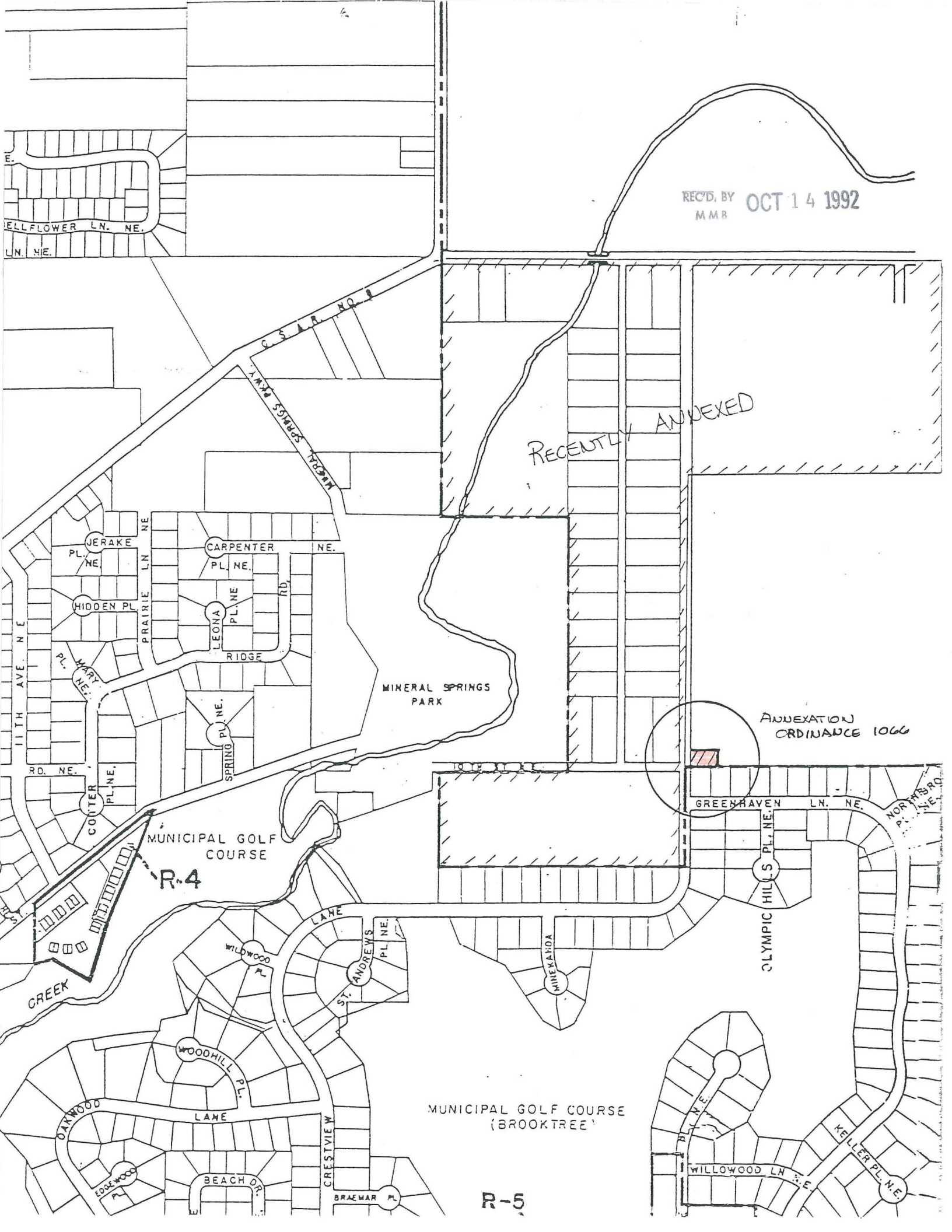

ELLFLOWER LN. NE.

LN. NE.

MINERAL SPRINGS ROAD

MINERAL SPRINGS PARK

MUNICIPAL GOLF COURSE

R-4

MUNICIPAL GOLF COURSE (BROOKTREE)

R-5

GREENHAVEN LN. NE.

OLYMPIC HILLS PL. NE.

NORTHBROOK PL. NE.

LAKE

ST. ANDREWS PL. NE.

MINERAKA

WOODHILL PL.

LAKE

CRESTVIEW

BRAEMAR PL.

WILLOWOOD LN. N.E.

KELLER PL. N.E.

OAKWOOD

EDGEWOOD PL.

BEACH DR.