

CITY OF FARMINGTON
DAKOTA COUNTY, MINNESOTA

ORDINANCE NO. 092-281

REC'D. BY AUG 28 1992
M M B

An Ordinance Annexing Certain Unplatted Land from Castle Rock Township Pursuant to Minnesota Statutes 414.033(5)

THE CITY COUNCIL OF THE CITY OF FARMINGTON HEREBY ORDAINS AS FOLLOWS:

SECTION I:

The property described below is hereby annexed
to the City of Farmington pursuant to Minnesota

Statutes 414.033(5), to wit:

PARCEL #07-00600-013-27

The West Half of the Northwest Quarter (W $\frac{1}{2}$ of NW $\frac{1}{4}$) of Section 6, Township 113 North, Range 19 West, Dakota County, Minnesota EXCEPTING therefrom railroad right of way and ALSO EXCEPTING a tract of land described as follows:

Beginning at the intersection of the East line of the said West Half of the Northwest Quarter (W $\frac{1}{2}$ of NW $\frac{1}{4}$) and the Southeasterly right of way of the Milwaukee Railroad, said point lying 1,392.40 feet South of the Northeast corner of the said West Half of the Northwest Quarter (W $\frac{1}{2}$ of NW $\frac{1}{4}$); thence South along said East line a distance of 320.0 feet; thence deflecting to the right at an angle of 104° 44' 30" a distance of 393.50 feet to a point on the Southeasterly right of way; thence Northeasterly along said right of way a distance of 440.0 feet, more or less, to the point of beginning. ALSO EXCEPTING therefrom a tract of land North and West of the Chicago, Milwaukee, St. Paul and Pacific Railroad right of way, already annexed to the City of Farmington.

Subject to road and utility easements of record, if any.

Containing in all 75.43 acres, more or less according to the Government Survey thereof.

PARCEL #07-00600-010-28

All that part of the East $\frac{1}{2}$ of the Northwest Quarter of Section 6, T 113, R 19, lying west of the right of way of the Iowa and Minnesota Division of the Chicago, Milwaukee, St. Paul Railway Company and south of the right of way of the Farmington and Mankato Line of said Chicago, Milwaukee, St. Paul Railway Company as are now located across said lands, being about twelve acres more or less, being the same lands conveyed to the within Grantee by William Nicolay and Belle Nicolay his wife by Warranty Deed dated October 1st, 1901 and recorded on the 8th day of October, 1901, in Book 70 of Deeds; on page 447 of the records of Dakota County, State of Minnesota (Recorded April 29, 1905, in Book 117, Page 320).

A strip, belt, or piece of land, one hundred feet wide, extending across in the northeasterly and southwesterly direction of all that part of the East half of the Northwest Quarter of Section 6, Township 113, Range 19, which lies west of the right of way of the Iowa and Minnesota Division of the Chicago, Milwaukee, ST. Paul and Pacific Railway Company. The center of said strip being marked on the ground by a line of stakes, marked (L) together with the strip of land twenty-five feet wide adjoining the right of way of said Iowa and Minnesota Division of said Railway, extending from the North line of said premises herein before described to the point where said right of way running northeasterly and southwesterly leaves said main line of said Railway, all in Dakota County, Minnesota. (Recorded October 8, 1901, in Book 110, Page 303).

PARCEL #07-00600-010-29

A strip, belt, or piece of land one hundred feet wide, extending across from the East side to the West side of the west Half of the West Half of the Northwest Quarter of Section 6, Township 113, Range 19, in the County of Dakota, State of Minnesota. Hereby conveying a strip of land fifty feet wide on each side of the centerline of the Railway of said Company, as now located and established across said land. (Recorded June 16th, 1902, in Book 109, Page 155).

A strip, belt or piece of land, one hundred feet wide, extending across from the East side to the West side of the East Half of the West Half of the Northwest Quarter of Section 6, Township 113, Range 19, in the County of Dakota, State of Minnesota. Hereby conveying a strip of land fifty feet wide on each side of the centerline of the Railway of said Company, as now located and established across said land. (Recorded June 16th, 1902, in Book 109, Page 157).

A tract of land in the West Half of the Northwest Quarter of Section 6, Township 113, Range 19, described as follows: Beginning at the intersection of the East line of said West Half of the Northwest Quarter and the southeasterly right of way line of the Milwaukee Railroad, said point lying 1,392.4 feet south of the Northeast corner of said West Half of the Northwest Quarter; thence south and along said East line a distance of 320.0 feet; thence deflecting to the right at an angle of 104 degrees 44 minutes 30 seconds a distance of 393.5 feet to a point on said southeasterly right of way; thence northeasterly along said right of way a distance of 440 feet more or less to the point of beginning. Containing 1.32 acres. (Recorded February 7, 1966, in Book 264, Page 351).

SECTION II: The City Administrator is hereby directed to file certified copies of this Ordinance with the Minnesota Secretary of State, the Minnesota Municipal Board, the Dakota County Auditor, and the Castle Rock Town Board.

SECTION III: This annexation shall be effective at such time as this ordinance has been approved by the Minnesota Municipal Board and the ordinance has been published in the official newspaper.

Enacted and ordained the 17th day of August, 1992.

ATTEST:

CITY OF FARMINGTON

SEAL

Mary Hanson
Eugene "Balke" Kuchera
Mayor

[Signature]
Clerk/Administrator

Approved as to form the 26th day of August 1992.

[Signature]
City Attorney

Published in the Farmington Independent the _____ day of _____, 1992.

Legal Description

The West Half of the Northwest Quarter ($W\frac{1}{2}$ of $NW\frac{1}{4}$) of Section 6, Township 113 North, Range 19 West, Dakota County, Minnesota, EXCEPTING therefrom railroad right of way and ALSO EXCEPTING a tract of land described as follows: Beginning at the intersection of the East line of the said West Half of the Northwest Quarter ($W\frac{1}{2}$ of $NW\frac{1}{4}$) and the Southeasterly right of way of the Milwaukee Railroad, said point lying 1,392.40 feet South of the Northeast corner of the said West Half of the Northwest Quarter ($W\frac{1}{2}$ of $NW\frac{1}{4}$); thence South along said East line a distance of 320.0 feet; thence deflecting to the right at an angle of $104^{\circ} 44' 30''$ a distance of 393.50 feet to a point on the Southeasterly right of way; thence Northeasterly along said right of way a distance of 440.0 feet, more or less, to the point of beginning. ALSO EXCEPTING therefrom a tract of land North and West of the Chicago, Milwaukee, St. Paul and Pacific Railroad right of way, already annexed to the City of Farmington. Subject to road and utility easements of record, if any.

Containing in all 75.43 acres, more or less according to the Government Survey thereof.

PARCEL #07-00600-013-27

Legal Description

All that part of the East 1/2 of the Northwest Quarter of Section 6, T 113, R 19, lying west of the right of way of the Iowa and Minnesota Division of the Chicago, Milwaukee, St. Paul Railway Company and south of the right of way of the Farmington and Mankato Line of said Chicago, Milwaukee, St. Paul Railway Company as are now located across said lands, being about twelve acres more or less, being the same lands conveyed to the within Grantee by William Nicolay and Belle Nicolay his wife by Warranty Deed dated October 1st, 1901 and recorded on the 8th day of October, 1901, in Book 70 of Deeds; on page 447 of the records of Dakota County, State of Minnesota (Recorded April 29, 1905, in Book 117, Page 320).

A strip, belt, or piece of land, one hundred feet wide, extending across in the northeasterly and southwesterly direction of all that ^{part} of the East half of the Northwest Quarter of Section 6, Township 113, Range 19, which lies west of the right of way of the Iowa and Minnesota Division of the Chicago, Milwaukee, St. Paul and Pacific Railway Company. The center of said strip being marked on the ground by a line of stakes, marked (L) together with the strip of land twenty-five feet wide adjoining the right of way of said Iowa and Minnesota Division of said Railway, extending from the North line of said premises herein before described to the point where said right of way running northeasterly and southwesterly leaves said main line of said Railway, all in Dakota County, Minnesota. (Recorded October 8, 1901, in Book 110, Page 303).

PARCEL #07-00600-010-28

Legal Description

A strip, belt, or piece of land one hundred feet wide, extending across from the East side to the West side of the west Half of the West Half of the Northwest Quarter of Section 6, Township 113, Range 19, in the County of Dakota, State of Minnesota. Hereby conveying a strip of land fifty feet wide on each side of the centerline of the Railway of said Company, as now located and established across said land. (Recorded June 16th, 1902, in Book 109, Page 155).

A strip, belt or piece of land, one hundred feet wide, extending across from the East side to the West side of the East Half of the West Half of the Northwest Quarter of Section 6, Township 113, Range 19, in the County of Dakota, State of Minnesota. Hereby conveying a strip of land fifty feet wide on each side of the centerline of the Railway of said Company, as now located and established across said land. (Recorded June 16th, 1902, in Book 109, Page 157).

A tract of land in the West Half of the Northwest Quarter of Section 6, Township 113, Range 19, described as follows: Beginning at the intersection of the East line of said West Half of the Northwest Quarter and the southeasterly right of way line of the Milwaukee Railroad, said point lying 1,392.4 feet south of the Northeast corner of said West Half of the Northwest Quarter; thence south and along said East line a distance of 320.0 feet; thence deflecting to the right at an angle of 104 degrees 44 minutes 30 seconds a distance of 393.5 feet to a point on said southeasterly right of way; thence northeasterly along said right of way a distance of 440 feet more or less to the point of beginning. Containing 1.32 acres. (Recorded February 7, 1966, in Book 264, Page 351).

PARCEL #07-00600-010-29

REC'D. BY AUG 28 1992
M.A.B.

EMPIRE TWP

030-26	020-26
100	100

18

John L. & Eliz.
Turek

129 Ac.

1058-A
010-16

013-27

012-27

1058

07-00600 010 29

07-00600 010 28

07-00600 013 27

CHICAGO, MILWAUKEE, ST. PAUL

CHICAGO, MILWAUKEE, ST. PAUL & PACIFIC R.R.

150 AC.

1062
011-52

MILWAUKEE, ST. PAUL & PACIFIC R.R.

- GALAXIE
- FRANCHISE
- FORDHAM
- FOLIAGE
- FLORIDA
- FLAGSTAFF
- FINDLAY
- FINCH
- FERRIS
- FERNANDO
- FAIRGREEN
- EXODUS
- EXLEY
- EVERTON
- EUREKA
- EUCLID
- PILOT KNOB RD.
- EPLEY
- ENSLEY
- EMERY
- EMBRY
- ELY
- ELMIRA
- ELLICE
- ELKWOOD
- ELGIN
- ECHO
- EBONY
- EASTER
- DUNBAR
- DREXEL
- DRESDEN
- DOYLE
- DORY
- DOMINICA
- DENMARK
- CHIPPENDALE

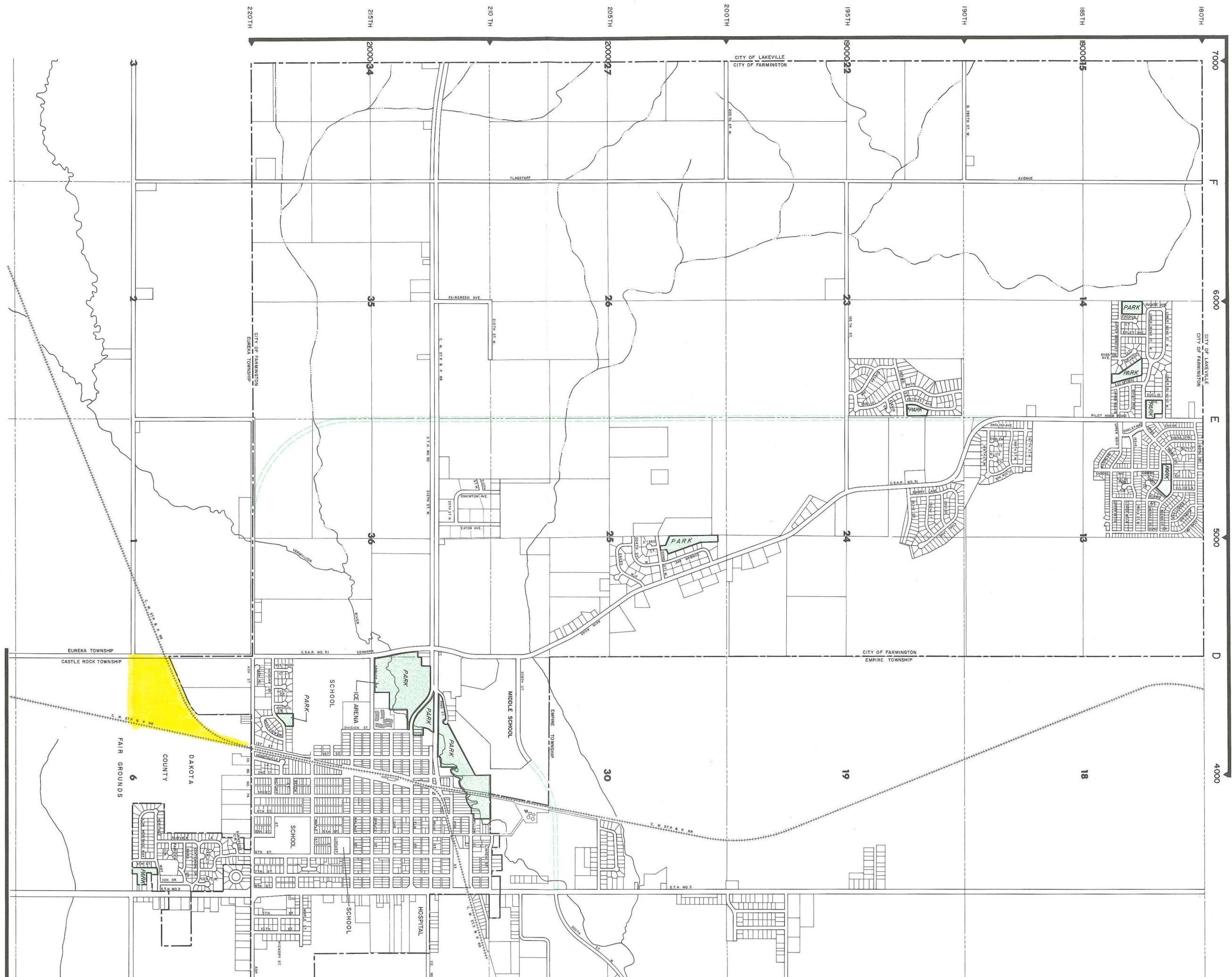

CITY OF FARMINGTON

REC'D BY AUG 28 1992
M M B

LEGEND:

- PARK
- FUTURE MINOR ARTERIAL

SCALE IN FEET

1000 500 0 500 1000

NORTH

REVISIONS

NO.	DATE	DESCRIPTION
1	8/28/92	PREPARED BY ROBERTO, ROSENE, ANDERSON - SANITARY, MINNESOTA