

IN THE MATTER OF THE PETITION OF  
\_\_\_\_\_  
FOR ANNEXATION PURSUANT TO  
MINNESOTA STATUTES §414.033, SUBD. 5

-----  
TO: The City Council of the City of Farmington, Minnesota  
and

Minnesota Municipal Board  
165 Metro Square Building  
St. Paul, Minnesota 55101

PETITIONERS STATE: The property owner or a majority of the property owners in number are required to commence a proceeding under Minnesota Statutes §414.033, Subd. 5.

It is hereby requested by:

  x   the sole property owner; or  
       all of the property owners; or  
       a majority of the property owners of the area proposed for annexation to annex certain property described herein lying in the Town of Castle Rock Twp to the City of Farmington, County of Dakota, State of Minnesota.

The area proposed for annexation is described as follows:

Parcel #07-00600-013-27  
Parcel #07-00600-010-28  
Parcel #07-00600-010-29

1. There are   1   property owners in the area proposed for annexation.
2.   1   property owners have signed this petition. (If the land is owned by both husband and wife, both must sign the petition to represent all owners.)
3. The population of the annexation area is   0  .
4. Said property is unincorporated and abuts upon the City's N (S) E W (circle one) boundary(ies) and is not included within any other municipality.

5. The area of land to be annexed in acres is: Approximately 50  
Platted\_\_\_\_\_ Unplatted x Total\_\_\_\_\_
6. The reason for the requested annexation is \_\_\_\_\_  
To connect to services\_\_\_\_\_.
7. All of the annexation area is or is about to become urban or suburban in character.
8. The area proposed for annexation is not included in any area that has already been designated for orderly annexation pursuant to Minnesota Statutes §414.0325.

PETITIONERS REQUEST: That pursuant to Minnesota Statutes §414.033, the property described herein be annexed to and included within the City of Farmington.

Dated: 7-2-92

Robert F. Adelman  
\_\_\_\_\_  
\_\_\_\_\_  
\_\_\_\_\_  
\_\_\_\_\_  
\_\_\_\_\_  
\_\_\_\_\_  
\_\_\_\_\_

RECEIVED BY AUG 28 1992  
M M B

Legal Description

A strip, belt, or piece of land one hundred feet wide, extending across from the East side to the West side of the west Half of the West Half of the Northwest Quarter of Section 6, Township 113, Range 19, in the County of Dakota, State of Minnesota. Hereby conveying a strip of land fifty feet wide on each side of the centerline of the Railway of said Company, as now located and established across said land. (Recorded June 16th, 1902, in Book 109, Page 155).

A strip, belt or piece of land, one hundred feet wide, extending across from the East side to the West side of the East Half of the West Half of the Northwest Quarter of Section 6, Township 113, Range 19, in the County of Dakota, State of Minnesota. Hereby conveying a strip of land fifty feet wide on each side of the centerline of the Railway of said Company, as now located and established across said land. (Recorded June 16th, 1902, in Book 109, Page 157).

A tract of land in the West Half of the Northwest Quarter of Section 6, Township 113, Range 19, described as follows: Beginning at the intersection of the East line of said West Half of the Northwest Quarter and the southeasterly right of way line of the Milwaukee Railroad, said point lying 1,392.4 feet south of the Northeast corner of said West Half of the Northwest Quarter; thence south and along said East line a distance of 320.0 feet; thence deflecting to the right at an angle of 104 degrees 44 minutes 30 seconds a distance of 393.5 feet to a point on said southeasterly right of way; thence northeasterly along said right of way a distance of 440 feet more or less to the point of beginning. Containing 1.32 acres. (Recorded February 7, 1966, in Book 264, Page 351).

PARCEL #07-00600-010-29

Legal Description

All that part of the East 1/2 of the Northwest Quarter of Section 6, T 113, R 19, lying west of the right of way of the Iowa and Minnesota Division of the Chicago, Milwaukee, St. Paul Railway Company and south of the right of way of the Farmington and Mankato Line of said Chicago, Milwaukee, St. Paul Railway Company as are now located across said lands, being about twelve acres more or less, being the same lands conveyed to the within Grantee by William Nicolay and Belle Nicolay his wife by Warranty Deed dated October 1st, 1901 and recorded on the 8th day of October, 1901, in Book 70 of Deeds; on page 447 of the records of Dakota County, State of Minnesota (Recorded April 29, 1905, in Book 117, Page 320).

A strip, belt, or piece of land, one hundred feet wide, extending across in the northeasterly and southwesterly direction of all that <sup>part</sup> of the East half of the Northwest Quarter of Section 6, Township 113, Range 19, which lies west of the right of way of the Iowa and Minnesota Division of the Chicago, Milwaukee, St. Paul and Pacific Railway Company. The center of said strip being marked on the ground by a line of stakes, marked (L) together with the strip of land twenty-five feet wide adjoining the right of way of said Iowa and Minnesota Division of said Railway, extending from the North line of said premises herein before described to the point where said right of way running northeasterly and southwesterly leaves said main line of said Railway, all in Dakota County, Minnesota. (Recorded October 8, 1901, in Book 110, Page 303).

PARCEL #07-00600-010-28

REC'D. BY AUG 28 1992  
MMB

Legal Description

The West Half of the Northwest Quarter ( $W\frac{1}{2}$  of  $NW\frac{1}{4}$ ) of Section 6, Township 113 North, Range 19 West, Dakota County, Minnesota, EXCEPTING therefrom railroad right of way and ALSO EXCEPTING a tract of land described as follows: Beginning at the intersection of the East line of the said West Half of the Northwest Quarter ( $W\frac{1}{2}$  of  $NW\frac{1}{4}$ ) and the Southeasterly right of way of the Milwaukee Railroad, said point lying 1,392.40 feet South of the Northeast corner of the said West Half of the Northwest Quarter ( $W\frac{1}{2}$  of  $NW\frac{1}{4}$ ); thence South along said East line a distance of 320.0 feet; thence deflecting to the right at an angle of  $104^{\circ} 44' 30''$  a distance of 393.50 feet to a point on the Southeasterly right of way; thence Northeasterly along said right of way a distance of 440.0 feet, more or less, to the point of beginning. ALSO EXCEPTING therefrom a tract of land North and West of the Chicago, Milwaukee, St. Paul and Pacific Railroad right of way, already annexed to the City of Farmington. Subject to road and utility easements of record, if any.

Containing in all 75.43 acres, more or less according to the Government Survey thereof.

PARCEL #07-00600-013-27

REC'D. BY AUG 28 1992  
M.A.B.

EMPIRE TWP

030-26	020-26
100	100

18

John L. & Eliz.  
Turek

129 Ac.

1058-A  
010-16

013-27

012-27

1058

07-00600 010 29

07-00600 010 28

CHICAGO, MILWAUKEE, ST. PAUL

CHICAGO, MILWAUKEE, ST. PAUL & PACIFIC R.R.

07-00600 013 27

150 AC.

1062  
011-52

MILWAUKEE, ST. PAUL & PACIFIC R.R.



- GALAXIE
- FRANCHISE
- FORDHAM
- FOLIAGE
- FLORIDA
- FLAGSTAFF
- FINDLAY
- FINCH
- FERRIS
- FERNANDO
- FAIRGREEN
- EXODUS
- EXLEY
- EVERTON
- EUREKA
- EUCLID
- PILOT KNOB RD.
- EPLEY
- ENSLEY
- EMERY
- EMBRY
- ELY
- ELMIRA
- ELLICE
- ELKWOOD
- ELGIN
- ECHO
- EBONY
- EASTER
- DUNBAR
- DREXEL
- DRESDEN
- DOYLE
- DORY
- DOMINICA
- DENMARK
- CHIPPENDALE

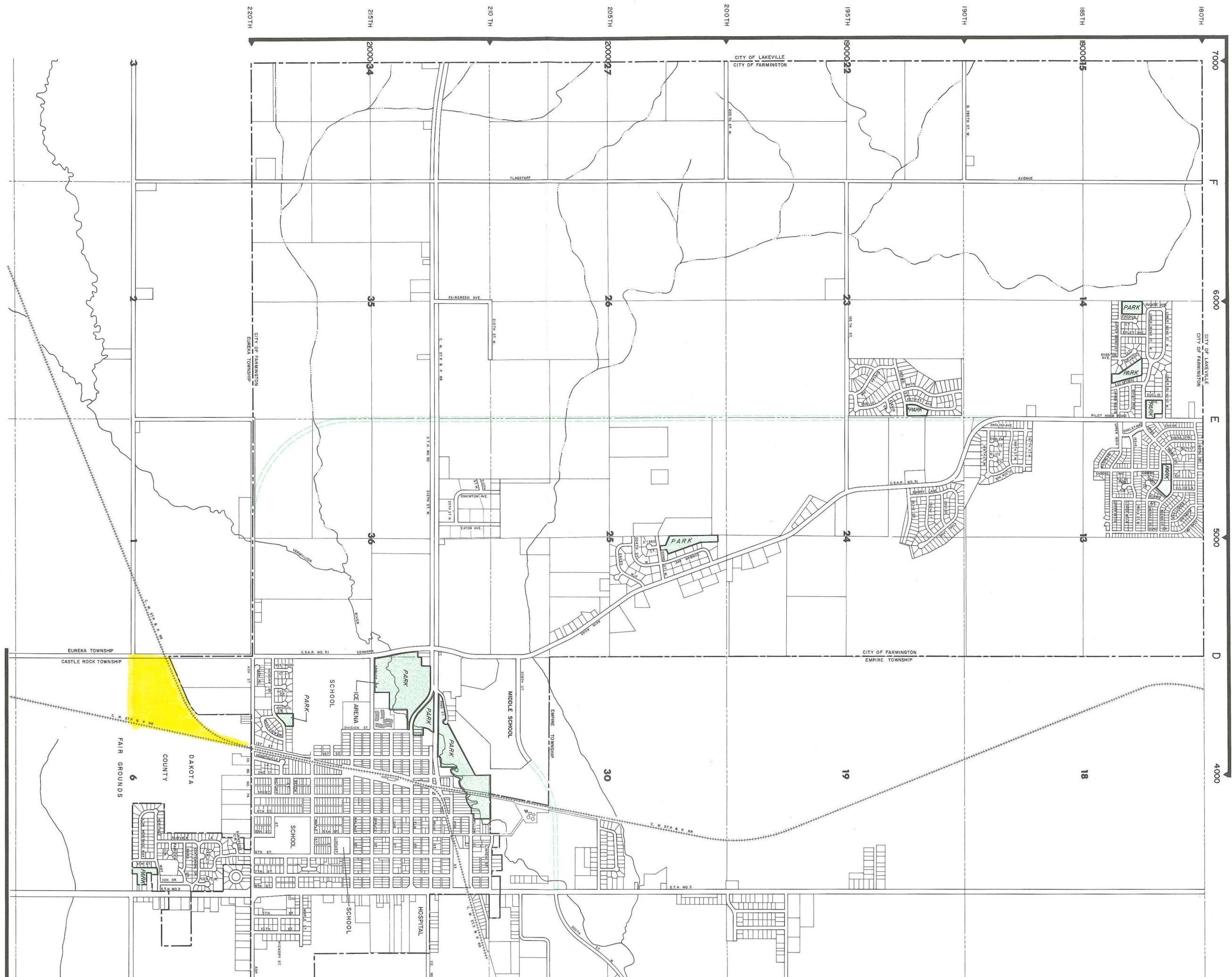

# CITY OF FARMINGTON

REC'D BY AUG 28 1992  
M M B

LEGEND:

- PARK
- FUTURE MINOR ARTERIAL

SCALE IN FEET

1000 500 0 500 1000

NORTH

REVISIONS

NO.	DATE	DESCRIPTION
1	8/28/92	PREPARED BY ROBERTSON, ROSEN, AND ASSOCIATES, FARMINGTON, MINN.
2	8/28/92	AMENDMENTS - SANITARY PAVEMENT

- WESTWOOD
- WESTLYN
- WESTGAIL
- WESTVIEW
- DIVISION
- 1ST STREET
- HONEYSUCKLE
- 2ND STREET
- 3RD STREET
- 4TH STREET
- 5TH STREET
- FAIRVIEW
- 6TH STREET
- 7TH STREET
- CENTENNIAL
- 8TH STREET
- CHIPPENDALE
- 9TH STREET
- 10TH STREET