

STATE OF MINNESOTA

COUNTY OF SIBLEY

TOWNSHIP OF CORNISH

In the Matter of the Petition  
of Timothy L. Woods for  
Annexation pursuant to Minn.  
Stat. 414.033, Subd. 5.

PETITION BY PROPERTY  
OWNER FOR ANNEXATION  
OF ADJACENT REAL  
PROPERTY TO THE CITY  
OF WINTHROP

=====

TO: THE CITY OF WINTHROP

Timothy L. Woods, does hereby state as follows:

1. Woods is the owner of real property described on Attachment A hereto. Said property is adjacent to and abuts to the municipal corporate boundary to the City of Winthrop.

2. Woods desires to develop said real property as residential property and the City of Winthrop is able to provide governmental services for the property.

3. Copies of this petition shall be filed with the Township of Cornish and the County of Sibley, and Woods expects each entity to consent to this petition and waive the timeline to file objection to the petition.

4. Woods requests the City of Winthrop upon receipt of this petition and the consents and waivers of the township and county, to adopt an ordinance declaring this property to be annexed to the City of Winthrop pursuant to Minn. Stat. 414.033, Subd. 5, and then submit said ordinance to the Minnesota Municipal Board for approval pursuant to Minn. Stat. 414.033, Subd. 7.

Dated: 7/8/92

Timothy L. Woods  
Timothy L. Woods

Subscribed and sworn to this  
8th day of July, 1992.

David E. Schauer  
Notary

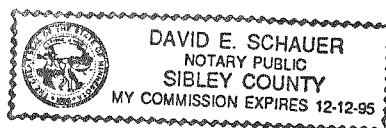

REC'D BY AUG 10 1992  
MMB

Timothy L. Woods Annexation  
Real Property Description  
Attachment A

That part of the East Half of the Southeast Quarter (E 1/2 of SE 1/4) lying east and north of Parcel 224 on Minnesota Department of Transportation Right of Way Plat Numbered 72-7 as the same is on file and of record in the Office of the County Recorder in and for Sibley County; all in Section 1, Township 112, Range 30, Sibley County, Minnesota.

REC'D BY AUG 10 1992  
MMB

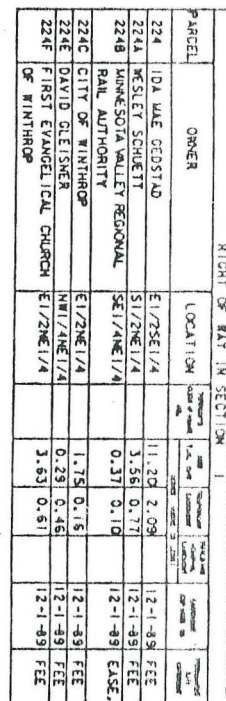

POINT		DISTANCE		COORDINATE	
31	101.41	77.00	779.13	101.41	779.13
32	101.42	77.00	779.13	101.42	779.13
33	101.43	77.00	779.13	101.43	779.13
34	101.44	77.00	779.13	101.44	779.13
35	101.45	77.00	779.13	101.45	779.13
36	101.46	77.00	779.13	101.46	779.13
37	101.47	77.00	779.13	101.47	779.13
38	101.48	77.00	779.13	101.48	779.13
39	101.49	77.00	779.13	101.49	779.13
40	101.50	77.00	779.13	101.50	779.13
41	101.51	77.00	779.13	101.51	779.13
42	101.52	77.00	779.13	101.52	779.13
43	101.53	77.00	779.13	101.53	779.13
44	101.54	77.00	779.13	101.54	779.13
45	101.55	77.00	779.13	101.55	779.13
46	101.56	77.00	779.13	101.56	779.13
47	101.57	77.00	779.13	101.57	779.13
48	101.58	77.00	779.13	101.58	779.13
49	101.59	77.00	779.13	101.59	779.13
50	101.60	77.00	779.13	101.60	779.13
51	101.61	77.00	779.13	101.61	779.13
52	101.62	77.00	779.13	101.62	779.13
53	101.63	77.00	779.13	101.63	779.13
54	101.64	77.00	779.13	101.64	779.13
55	101.65	77.00	779.13	101.65	779.13
56	101.66	77.00	779.13	101.66	779.13
57	101.67	77.00	779.13	101.67	779.13
58	101.68	77.00	779.13	101.68	779.13
59	101.69	77.00	779.13	101.69	779.13
60	101.70	77.00	779.13	101.70	779.13
61	101.71	77.00	779.13	101.71	779.13
62	101.72	77.00	779.13	101.72	779.13
63	101.73	77.00	779.13	101.73	779.13
64	101.74	77.00	779.13	101.74	779.13
65	101.75	77.00	779.13	101.75	779.13
66	101.76	77.00	779.13	101.76	779.13
67	101.77	77.00	779.13	101.77	779.13
68	101.78	77.00	779.13	101.78	779.13
69	101.79	77.00	779.13	101.79	779.13
70	101.80	77.00	779.13	101.80	779.13
71	101.81	77.00	779.13	101.81	779.13
72	101.82	77.00	779.13	101.82	779.13
73	101.83	77.00	779.13	101.83	779.13
74	101.84	77.00	779.13	101.84	779.13
75	101.85	77.00	779.13	101.85	779.13
76	101.86	77.00	779.13	101.86	779.13
77	101.87	77.00	779.13	101.87	779.13
78	101.88	77.00	779.13	101.88	779.13
79	101.89	77.00	779.13	101.89	779.13
80	101.90	77.00	779.13	101.90	779.13
81	101.91	77.00	779.13	101.91	779.13
82	101.92	77.00	779.13	101.92	779.13
83	101.93	77.00	779.13	101.93	779.13
84	101.94	77.00	779.13	101.94	779.13
85	101.95	77.00	779.13	101.95	779.13
86	101.96	77.00	779.13	101.96	779.13
87	101.97	77.00	779.13	101.97	779.13
88	101.98	77.00	779.13	101.98	779.13
89	101.99	77.00	779.13	101.99	779.13
90	102.00	77.00	779.13	102.00	779.13
91	102.01	77.00	779.13	102.01	779.13
92	102.02	77.00	779.13	102.02	779.13
93	102.03	77.00	779.13	102.03	779.13
94	102.04	77.00	779.13	102.04	779.13
95	102.05	77.00	779.13	102.05	779.13
96	102.06	77.00	779.13	102.06	779.13
97	102.07	77.00	779.13	102.07	779.13
98	102.08	77.00	779.13	102.08	779.13
99	102.09	77.00	779.13	102.09	779.13
100	102.10	77.00	779.13	102.10	779.13
101	102.11	77.00	779.13	102.11	779.13
102	102.12	77.00	779.13	102.12	779.13
103	102.13	77.00	779.13	102.13	779.13
104	102.14	77.00	779.13	102.14	779.13
105	102.15	77.00	779.13	102.15	779.13
106	102.16	77.00	779.13	102.16	779.13
107	102.17	77.00	779.13	102.17	779.13
108	102.18	77.00	779.13	102.18	779.13
109	102.19	77.00	779.13	102.19	779.13
110	102.20	77.00	779.13	102.20	779.13
111	102.21	77.00	779.13	102.21	779.13
112	102.22	77.00	779.13	102.22	779.13
113	102.23	77.00	779.13	102.23	779.13
114	102.24	77.00	779.13	102.24	779.13
115	102.25	77.00	779.13	102.25	779.13
116	102.26	77.00	779.13	102.26	779.13
117	102.27	77.00	779.13	102.27	779.13
118	102.28	77.00	779.13	102.28	779.13
119	102.29	77.00	779.13	102.29	779.13
120	102.30	77.00	779.13	102.30	779.13
121	102.31	77.00	779.13	102.31	779.13
122	102.32	77.00	779.13	102.32	779.13
123	102.33	77.00	779.13	102.33	779.13
124	102.34	77.00	779.13	102.34	779.13
125	102.35	77.00	779.13	102.35	779.13
126	102.36	77.00	779.13	102.36	779.13
127	102.37	77.00	779.13	102.37	779.13
128	102.38	77.00	779.13	102.38	779.13
129	102.39	77.00	779.13	102.39	779.13
130	102.40	77.00	779.13	102.40	779.13
131	102.41	77.00	779.13	102.41	779.13
132	102.42	77.00	779.13	102.42	779.13
133	102.43	77.00	779.13	102.43	779.13
134	102.44	77.00	779.13	102.44	779.13
135	102.45	77.00	779.13	102.45	779.13
136	102.46	77.00	779.13	102.46	779.13
137	102.47	77.00	779.13	102.47	779.13
138	102.48	77.00	779.13	102.48	779.13
139	102.49	77.00	779.13	102.49	779.13
140	102.50	77.00	779.13	102.50	779.13
141	102.51	77.00	779.13	102.51	779.13
142	102.52	77.00	779.13	102.52	779.13
143	102.53	77.00	779.13	102.53	779.13
144	102.54	77.00	779.13	102.54	779.13
145	102.55	77.00	779.13	102.55	779.13
146	102.56	77.00	779.13	102.56	779.13
147	102.57	77.00	779.13	102.57	779.13
148	102.58	77.00	779.13	102.58	779.13
149	102.59	77.00	779.13	102.59	779.13
150	102.60	77.00	779.13	102.60	779.13
151	102.61	77.00	779.13	102.61	779.13
152	102.62	77.00	779.13	102.62	779.13
153	102.63	77.00	779.13	102.63	779.13
154	102.64	77.00	779.13	102.64	779.13
155	102.65	77.00	779.13	102.65	779.13
156	102.66	77.00	779.13	102.66	779.13
157	102.67	77.00	779.13	102.67	779.13
158	102.68	77.00	779.13	102.68	779.13
159	102.69	77.00	779.13	102.69	779.13
160	102.70	77.00	779.13	102.70	779.13
161	102.71	77.00	779.13	102.71	779.13
162	102.72	77.00	779.13	102.72	779.13
163	102.73	77.00	779.13	102.73	779.13
164	102.74	77.00	779.13	102.74	779.13
165	102.75	77.00	779.13	102.75	779.13
166	102.76	77.00	779.13	102.76	779.13
167	102.77	77.00	779.13	102.77	779.13
168	102.78	77.00	779.13	102.78	779.13
169	102.79	77.00	779.13	102.79	779.13
170	102.80	77.00	779.13	102.80	779.13
171	102.81	77.00	779.13	102.81	779.13
172	102.82	77.00	779.13	102.82	779.13
173	102.83	77.00	779.13	102.83	779.13
174	102.84	77.00	779.13	102.84	779.13
175	102.85	77.00	779.13	102.85	779.13
176	102.86	77.00	779.13	102.86	779.13
177	102.87	77.00	779.13	102.87	779.13
178	102.88	77.00	779.13	102.88	779.13
179	102.89	77.00	779.13	102.89	779.13
180	102.90	77.00	779.13	102.90	779.13
181	102.91	77.00	779.13	102.91	779.13
182	102.92	77.00	779.13	102.92	779.13
183	102.93	77.00	779.13	102.93	779.13
184	102.94	77.00	779.13	102.94	779.13
185	102.95	77.00	779.13	102.95	779.13
186	102.96	77.00	779.13	102.96	779.13
187	102.97	77.00	779.13	102.97	779.13
188	102.98	77.00	779.13	102.98	779.13
189	102.99	77.00	779.13	102.99	779.13
190	103.00	77.00	779.13	103.00	779.13
191	103.01	77.00	779.13	103.01	779.13
192	103.02	77.00	779.13	103.02	779.13
193	103.03	77.00	779.13	103.03	779.13
194	103.04	77.00	779.13	103.04	779.13
195	103.05	77.00	779.13	103.05	779.13
196	103.06	77.00	779.13	103.06	779.13
197	103.07	77.00	779.13	103.07	779.13
198	103.08	77.00	779.13	103.08	779.13
199	103.09	77.00	779.13	103.09	779.13
200	103.10	77.00	779.13	103.10	779.13
201	103.11	77.00	779.13	103.11	779.13
202	103.12	77.00	779.13	103.12	779.13
203	103.13	77.00	779.13	103.13	779.13
204	103.14	77.00	779.13	103.14	779.13
205	103.15	77.00	779.13	103.15	779.13
206	103.16	77.00	779.13	103.16	779.13
207	103.17	77.00	779.13	103.17	779.13
208	103.18	77.00	779.13	103.18	779.13
209	103.19	77.00	779.13	103.19	779.13
210	103.20	77.00	779.13	103.20	779.13
211	103.21	77.00	779.13	103.21	779.13
212	103.22	77.00	779.13	103.22	779.13
213	103.23	77.00	779.13	103.23	779.13
214	103.24	77.00	779.13	103.24	779.13
215	103.25	77.00	779.13	103.25	779.13
216	103.26	77.00	779.13	103.26	779.13
217	103.27	77.00	779.13	103.27	779.13
218	103.28	77.00	779.13	103.28	779.13
219					

MINNESOTA DEPARTMENT OF TRANSPORTATION  
RIGHT OF WAY PLAT NO. 72-7

STATE PROJECT NO. 7202 (15-15-30)  
IN THE EAST HALF OF SECTION 1, T. 112 N., R. 30 W., AND  
IN THE SOUTHWEST QUARTER OF SECTION 5, T. 112 N., R. 29 W.,  
SIBLEY COUNTY, MINNESOTA

THE COMPOUND OF TRANSPORTATION IS BEING DESIGNATING THE IDENTIFICATION OF TRUCK HIGHWAY NO. 5 FROM TRUCK HIGHWAY NO. 1 IN WASHINGTON TO 50 MILES SOUTH

[illegible][illegible]

SIBLEY CO. CAST IRON MONUMENT  
AT 124 CONGER

OMISSIONED 2" IN CONCRETE  
PAVEMENT AT SECTION CORNER

3/4" IRON ROD OVER STONE

[illegible]

**ACQUITTORISATION AND GRID ORIENTATION**  
The models are oriented to Remotely Sensed Data Time-Stamped Space with 5 degrees  
Bearing 5 seconds long 100 seconds.  
All distances are ground lengths and are converted to Remotely Sensed Data Time-  
Stamped by adopting the distance of 4,200,000.

[illegible]

DEC. 13 1950

OFFICE OF CREDIT RECORDS  
STATE OF CALIFORNIA, BUREAU

I HEREBY CERTIFY THAT THIS  
HAS BEEN FILED IN THIS OFFICE  
AT LOS ANGELES ON 12/13/50

WILLIAM H. BROWN, JR.  
CLERK, STATE BUREAU



EXHIBIT "B"  
PROXIMITY OF PARCEL TO CITY  
CITY LIMITS INDICATED BY  
GRAY SHADING.

REC'D. BY **AUG 10 1992**  
MMB

