

AN ORDINANCE RELATING TO ANNEXATION; ANNEXING TO THE CITY OF ROCHESTER APPROXIMATELY 19.46 ACRES OF LANDS SITUATED IN PORTIONS OF THE NORTHWEST QUARTER OF SECTION 32 AND THE SOUTHWEST QUARTER OF SECTION 29, TOWNSHIP 107 NORTH, RANGE 14 WEST, OLMSTED COUNTY, MINNESOTA.

THE COMMON COUNCIL OF THE CITY OF ROCHESTER DO ORDAIN:

Section 1. A petition has been filed with the Common Council of the City of Rochester, signed by the owner of land described herein, requesting the Common Council to annex said land to the City of Rochester. The land described in said petition for annexation is located in Cascade Township, Olmsted County, Minnesota, and is described as follows:

That part of the Northwest Quarter of Section 32, Township 107 North, Range 14 West, Olmsted County, Minnesota, described as follows:

Commencing at the northwest corner of the Northwest Quarter of said Section 32; thence North 88 degrees 00 minutes 04 seconds East, assumed bearing, along the north line of said Northwest Quarter, 1713.74 feet for the point of beginning; thence continue North 88 degrees 00 minutes 04 seconds East along said north line, 284.96 feet; thence South 62 degrees 23 minutes 20 seconds East, 362.41 feet; thence South 07 degrees 37 minutes 10 seconds West, 934.19 feet more or less to the centerline of 7th Street N.W. (formerly Fairway Road) (the next three courses are along said centerline); thence northwesterly 207.26 feet along a nontangential curve, concave to the north, radius of 3000.00 feet, delta angle of 03 degrees 57 minutes 30 seconds, and the chord of said curve bears North 82 degrees 36 minutes 26 seconds West, 207.22 feet; thence North 80 degrees 37 minutes 40 seconds West, tangent to said curve, 419.71 feet; thence northwesterly 13.01 feet along a tangential curve, concave to the south, radius of 4860.45 feet, and delta angle of 00 degrees 09 minutes 12 seconds; thence North 08 degrees 39 minutes 52 seconds East, not tangent to the last described curve, 998.25 feet to the point of beginning.

Also:

That part of the Southwest Quarter of Section 29, Township 107 North, Range 14 West, Olmsted County, Minnesota, described as follows:

Commencing at the southwest corner of the Southwest Quarter of said Section 29; thence North 88 degrees 00 minutes 04 seconds East, assumed bearing, along the south line of said Southwest Quarter, 1713.74 feet for the point of beginning; thence continue North 88 degrees 00 minutes 04 seconds East along said south line, 284.96 feet; thence North 22 degrees 10

minutes 03 seconds East, 599.33 feet; thence North 81 degrees 50 minutes 49 seconds West, 420.00 feet; thence South 08 degrees 39 minutes 52 seconds West, 631.74 feet to the point of beginning.

Said tract contains 19.46 acres more or less.

Said petition has also been filed with the Town Board of Cascade Township and the Town Board of Cascade Township has notified the City that it has no objections to the annexation of the above-described land.

Section 2. The quantity of land included in said petition is approximately 19.46 acres in size.

Section 3. The Common Council of the City of Rochester does hereby determine that the land described in Section 1 abuts upon the present territorial limits of the City of Rochester, is so conditioned as to be properly subjected to municipal government, and the annexation of said land will be in the best interest of the City of Rochester and the land described.

Section 4. Therefore, the land described in Section 1 above is hereby annexed, added to and made a part of the City of Rochester, Minnesota, as effectually as if it had originally been a part thereof.

Section 5. Present and future owners of the lands annexed by this ordinance are hereby notified that in addition to the usual assessments, it is the intention of the Common Council to assess against benefitted property all or a portion of the cost of any storm sewer, water tower, pumping station, and trunk line sanitary sewer construction, heretofore or hereafter undertaken to serve the area annexed.

Section 6. This ordinance shall take effect and be in force from and after its official publication and from and after the filing of a certified copy hereof with the Minnesota Municipal board, the Cascade Town Clerk, the County Auditor, and the Secretary of State.

PASSED AND ADOPTED BY THE COMMON COUNCIL OF THE CITY OF ROCHESTER, MINNESOTA, THIS 2 DAY OF March, 1992.

Deane B. Selby
PRESIDENT OF SAID COMMON COUNCIL

ATTEST: Carole A. Brunson
CITY CLERK

APPROVED THIS 3 DAY OF March, 1992.

Deane B. Selby
Acting MAYOR OF SAID CITY

(Seal of the City of
Rochester, Minnesota)

REC'D BY MAR 25 1992

LOCATION OF
19.46 ACRES TO
BE ANNEXYED

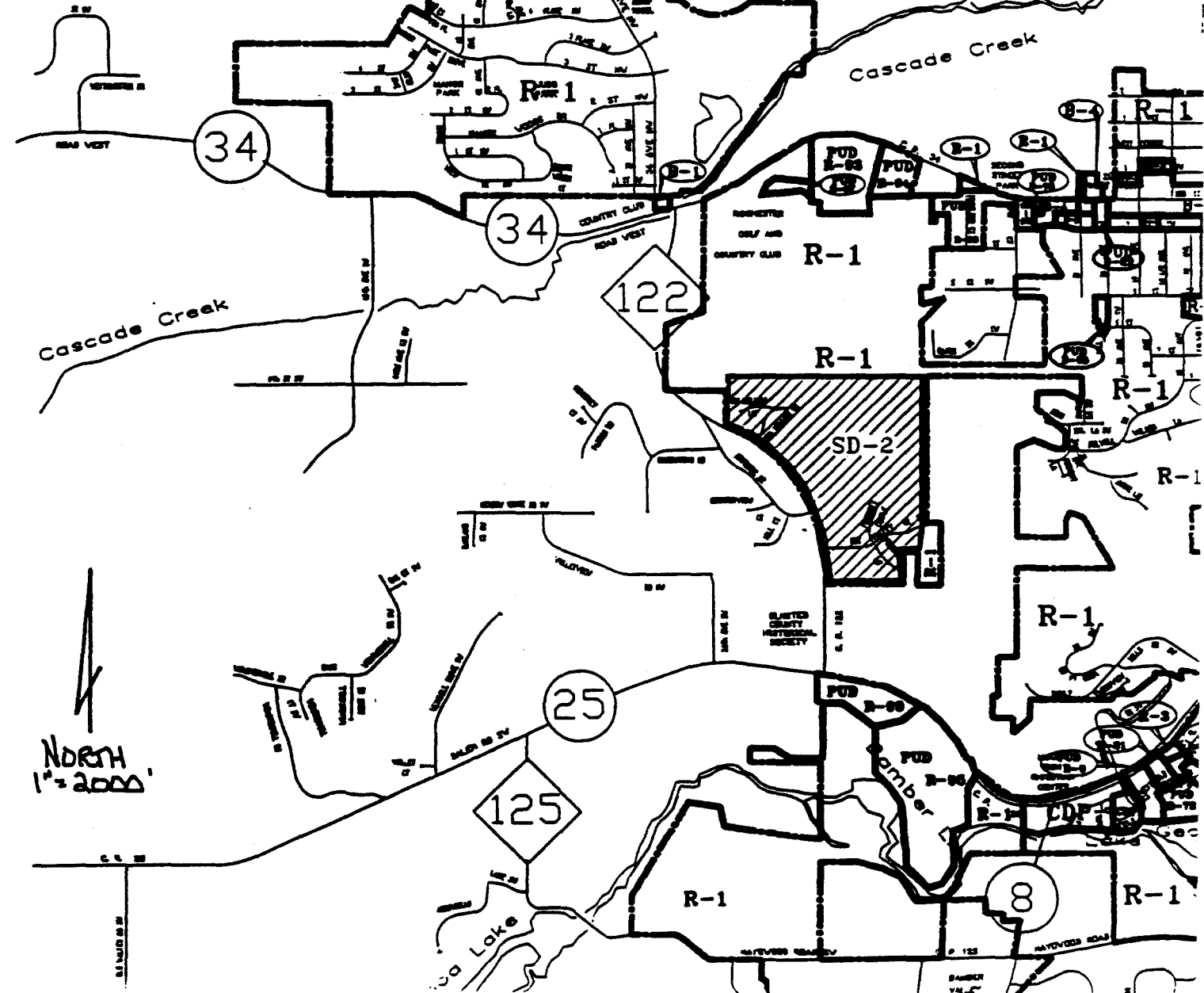

FOR:
BOB DEWITZ
A-4929

REC'D. BY
MAGS JAN 10 1992

FOR:
BOB DEWITZ
A-4929

NOT TO
SCALE

DESCRIPTION:
SEE
ATTACHED

PREPARED: 1-6-92

PREPARED BY:
McGhie & Betts, Inc.
CONSULTING ENGINEERS
PLANNERS
LAND SURVEYORS
ROCHESTER, MINNESOTA