

Revised 6-11-76

REC'D. BY AUG 07 1991
MMB

PROPERTY DESCRIPTION

A part of Section 9, Township 106 North, Range 14 West, Olmsted County, Minnesota described as follows:

Commencing at the northwest corner of the Northeast Quarter of said Section 9; thence South 01 degree 19 minutes 04 seconds East, assumed bearing along the west line of said Northeast Quarter, 1748.94 feet for a point of beginning; thence South 88 degrees 40 minutes 56 seconds West, 7.69 feet; thence southerly 108.58 feet along a nontangential curve concave westerly, central angle of 34 degrees 45 minutes 13 seconds, radius of 179.00 feet, and the chord of said curve bears South 18 degrees 04 minutes 40 seconds East, 106.92 feet; thence South 01 degree 19 minutes 04 seconds East, 212.03 feet; thence southerly 47.87 feet along a tangential curve concave northwesterly, central angle of 41 degrees 14 minutes 48 seconds, and radius of 66.50 feet; thence southerly and easterly 163.51 feet along a reverse curve concave northeasterly, central angle of 140 degrees 52 minutes 33 seconds, radius of 66.50 feet, and the chord of said curve bears South 30 degrees 30 minutes 33 seconds East, 125.32 feet; thence South 18 degrees 10 minutes 12 seconds West, 58.82 feet; thence South 01 degree 19 minutes 04 seconds East, 365.00 feet; thence North 89 degrees 17 minutes 21 seconds East, 34.37 feet; thence South 02 degrees 34 minutes 50 seconds East, 305.00 feet; thence South 85 degrees 18 minutes 21 seconds East, 426.63 feet to the westerly line of Lot 38, Block 1, SALEM POINT; thence North 01 degree 19 minutes 04 seconds West, along said westerly line 865.00 feet to the most southerly corner of Outlot "A" SALEM SOUND SECOND; thence North 39 degrees 38 minutes 05 seconds West, along the westerly line thereof, 475.17 feet; thence South 88 degrees 40 minutes 56 seconds West, along the southerly line thereof, 219.93 feet to the point of beginning.

Containing 11.78 acres more or less.

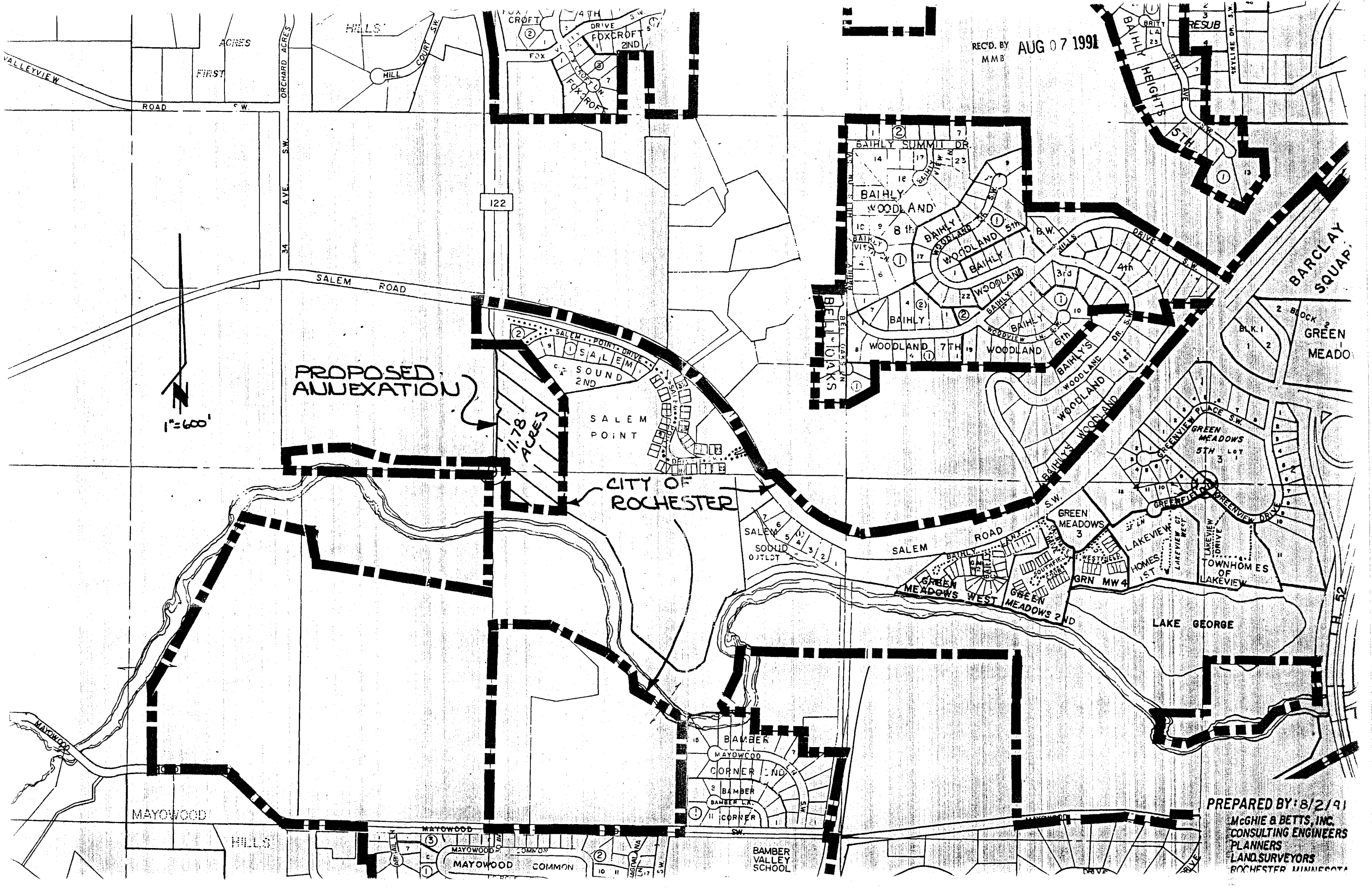

REC'D. BY
MMB
AUG 07 1991

PROPOSED
ANNEXATION

11.78
ACRES

CITY OF
ROCHESTER

PREPARED BY: 8/2/91
MCGHIE & BETTS, INC.
CONSULTING ENGINEERS
PLANNERS
LAND SURVEYORS
ROCHESTER MINNESOTA