

REC'D. BY
MMB OCT 29 1990

PETITION FOR ANNEXATION

In the matter of the Petition of Certain Persons for the annexation pursuant to Minnesota Statutes Section 414.033, Subdivision 5.

TO THE COUNCIL OF THE CITY OF COTTONWOOD, MINNESOTA:

We, the undersigned, all of the owners of the territory described below, hereby request the City Council to annex this territory to the City and to extend the City boundaries to include the same, and for that purpose respectfully state:

1. The territory to be annexed consists of certain unplatted lands not exceeding 200 acres in area. All of these lands lie entirely within the County of Lyon, Minnesota, and the description of such land is as follows:

All that part of the West Half of the Northeast Quarter of Section 16, Township 113 North, Range 40 West, Lyon County, Minnesota, described as follows:

Commencing at the intersection of the center line of West First Street in the City of Cottonwood, with the north line of said Northeast Quarter, thence South 00 degrees 22 minutes 12 seconds West, assumed bearing, along the center line of County State Aid Highway Number 9, which is also the extended centerline of said West First Street, 622.00 feet to the point of beginning; thence South 89 degrees 11 minutes 33 seconds East, parallel with said north line of the Northeast Quarter 872.75 feet to a point on the east line of said West Half of the Northeast Quarter; thence South 01 degrees 08 minutes 05 seconds West along said east line of the West Half of the Northeast Quarter 605.20 feet to a point on the northwesterly line of Minnesota State Highway Number 23 as shown on the plat entitled State Highway Right of Way Plat No. 42-2 as filed and recorded in the office of the County Recorder in and for said Lyon County; thence Southwesterly along said northwesterly line along a curve to the right having a central angle of 15 degrees 25 minutes 59 seconds, a radius of 5629.58 feet an arc length of 1516.37 feet and a chord that bears South 55 degrees 24 minutes 44 seconds West; thence Northeasterly along the easterly line of said plat entitled State Highway Right of Way Plat No. 42-2, along a curve to the right having a central angle of 19 degrees 06 minutes 52 seconds, a radius of 683.20 feet, an arc length of 227.92 feet and a chord that bears North 36 degrees 47 minutes 35 seconds East; thence continuing along said easterly line North 46 degrees 21 minutes 01 seconds East tangent to said curve 66.16 feet; thence continuing along said easterly line along a tangential curve to the left having a central angle of 47 degrees 15 minutes 48 seconds, a radius of 749.20 feet, and an arc length of 618.02 feet; thence continuing along said easterly line tangent to said curve North 00 degrees 05 minutes 13 seconds West 338.40 feet; thence South 89 degrees 05 minutes 13 seconds West 33.58 feet to a point on said center line of County State Aid Highway Number 9; thence North 00 degrees 22 minutes 12 seconds East along said center line 356.35 feet to the point of beginning.

Said tract of land is subject to any existing highways, roadways or easements.

OCT 29 1990

2. The territory described below abuts upon the City limits at the southern boundary thereof and none of it is presently included within the corporate limits of any incorporated city.
3. All of this territory is or is about to become urban or suburban in character.
4. The population of the area is zero (0).
5. The property owner or a majority of the property owners in number are required to constitute a sufficient petition under M.S. 414.033, Subdivision 5.

Cottonwood Coop. Hl. Co.By Mark Fisher mgr10-18-90

CITY OF COTTONWOOD

REC'D. BY OCT 29 1990
MMB

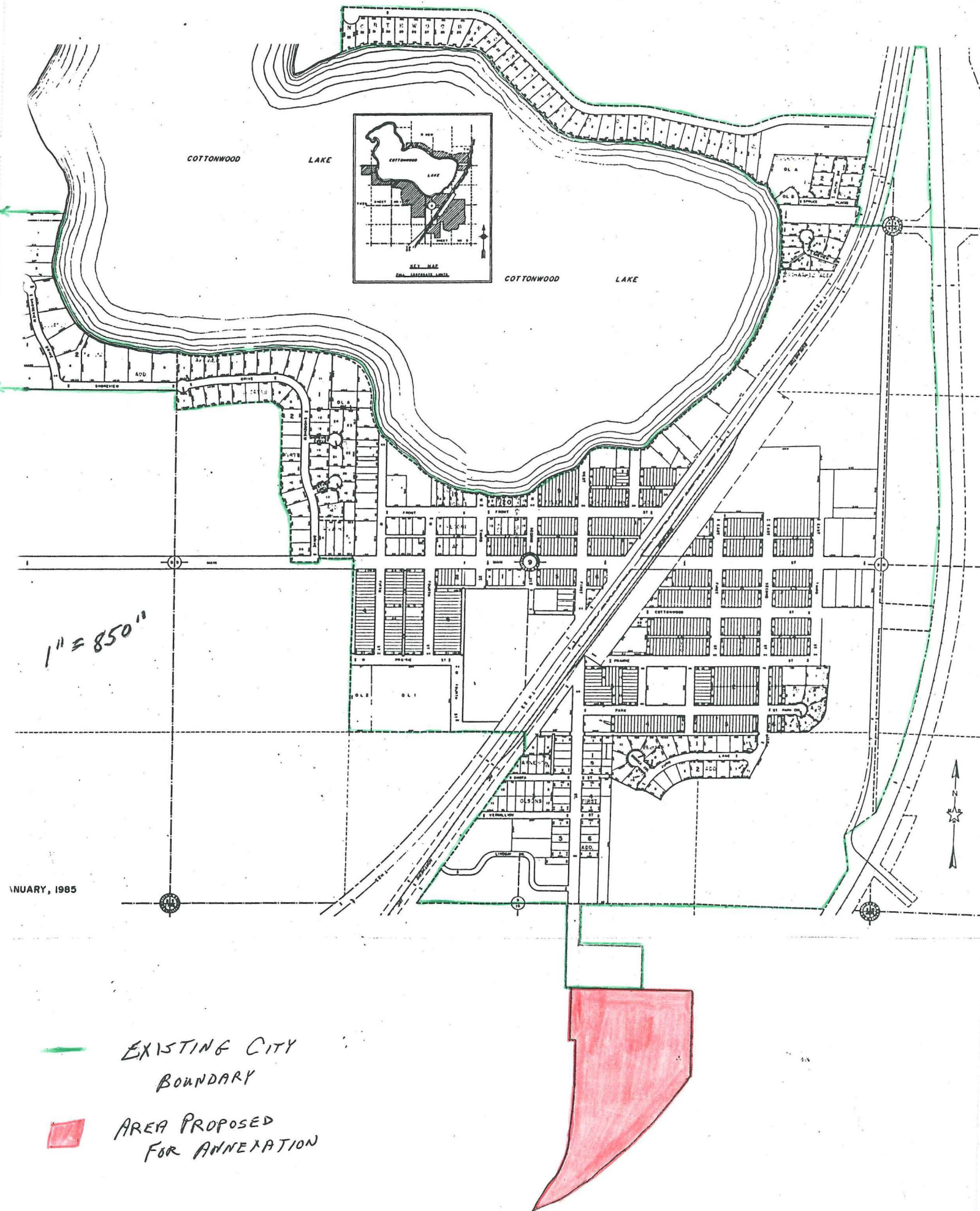

EXISTING CITY
BOUNDARY

AREA PROPOSED
FOR ANNEXATION

JANUARY, 1985