

City of Little Falls

ORDINANCE NO. 87
THIRD SERIES

AN ORDINANCE EXTENDING THE CORPORATE LIMITS OF THE CITY OF LITTLE FALLS TO INCLUDE CERTAIN UNINCORPORATED UNPLATTED LAND NOT EXCEEDING 200 ACRES IN AREA ABUTTING THE CITY LIMITS

WHEREAS, Eugene & Geraldine Wiczek, Raymond O. Paulsen, Jr. & Sharon E. Paulsen, Leo & Nancy Brausen, John P. & Joan Saehr, Edwin & Marion C. Stumpf, and Robert Bray, partner, Little Falls Development Company I, are owners of property, and have presented a petition requesting annexation of the territory hereinafter described, and said petition was duly presented to the City Council on the 21st day of May 1990, and whereas said petition incorrectly described the property as being platted; and

WHEREAS, and amended corrected petition signed by the same above named property owners, indicating the hereinafter described territory is unplatted, was duly presented to the City Council on the 4th day of June 1990; and

WHEREAS, the quantity of land embraced within the area described in the petition and bounded as herein described is 14.39 acres more or less of unplatted land, no part of which is included within the limits of an incorporated city; and

WHEREAS, the petition was signed by all owners; and

WHEREAS, the Town Board of Little Falls Township by Waiver dated June 4, 1990 waived its right to object to said annexation; and

WHEREAS, there are no townships or other municipalities whose boundaries abut upon the boundaries of the territory to be annexed except the Township of Little Falls; and

WHEREAS, the territory described in the petition abuts upon the City limits of the City of Little Falls at the easterly boundary thereof; and

WHEREAS, pursuant to the provisions of the City Code, Chapter 11, Section 11.03, Subdivision 6, the City Council and Planning Commission held a Public Hearing to determine the zoning district into which the annexed territory should be placed on June 18, 1990.

THE CITY OF LITTLE FALLS ORDAINS:

Section 1. Determination The City Council hereby determines: (1) that the annexation will be in the best interest of the City and of the territory affected; (2) the territory described herein abuts upon the easterly City limits; and (3) none of hereinafter described territory is now included within the limits of any city.

RECEIVED BY
MMB JUL 16 1990

Section 2. Territory Annexed The corporate limits of the City are hereby extended to include the unplatted land as hereinafter described as, and the same is hereby annexed to be included within the City of Little Falls as effectually as if it had originally been a part thereof.

The territory to be annexed consists entirely of unplatted lands. All of these lands lie entirely within the County of Morrison, State of Minnesota, and the description of such lands is as follows:

That part of the West Half of the Southeast Quarter of Section 9, Township 40, Range 32, Morrison County, Minnesota, described as follows:

Commencing at the southwest corner of said West Half of the Southeast Quarter of Section 9; thence North 0 degrees 53 minutes 59 seconds East, assumed bearing, 1988.70 feet along the west line of said West Half of the Southeast Quarter of Section 9 to its intersection with the southerly right-of-way line of State Highway No. 27, the point of beginning; thence South 0 degrees 53 minutes 59 seconds West 1146.94 feet along said west line of the West Half of the Southeast Quarter of Section 9; thence South 89 degrees 06 minutes 01 seconds East 554.00 feet; thence North 0 degrees 53 minutes 59 seconds East 513.10 feet to the west line of a tract of land described in Doc. 263358, on file and of record in the Office of the County Recorder in said Morrison County; thence North 0 degrees 50 minutes 32 seconds East 586.90 feet along said west line of a tract described in Doc. 263358 and the west line of a tract of land described in Doc. 263360 and their extension northerly to said southerly right-of-way line of State Highway No. 27; thence northwesterly along said southerly right-of-way line along a non-tangential spiral curve whose chord bears North 84 degrees 15 minutes 06 seconds West a distance of 555.40 feet to the point of beginning. Said spiral curve has total centerline dimensions of total central angle 29 degrees 28 minutes, degree of curve 1 degree 30 minutes, tangent 1079.55 feet, theta angle 1 degree 07 minutes 30 seconds, central angle of curve 27 degrees 13 minutes, length of spiral 150.00 feet, length of curve 1814.40 feet; being 14.39 acres more or less.

Section 3. Zoning The annexed property shall be placed in the Non-Central Business District (B-3).

REC'D BY
MMB JUL 16 1990

Section 4. Filing The City Administrator is hereby directed to file certified copies of this Ordinance with the Minnesota Municipal Board, the Minnesota Secretary of State, the Town Clerk of Little Falls Township, the Morrison County Auditor, and the Morrison County Recorder.

Section 5. Effective Date This Ordinance shall be in full force and effect seven (7) days after its passage and publication and the filing of the certified copy as directed in Section Four (4) hereof, and approval of this Ordinance by the Minnesota Municipal Board.

Adopted by the City Council of the City of Little Falls, Minnesota, this 2nd day of July, 1990, by the following vote:

Voting in Favor Thereof: Manlick, Olson, Spence, Doucette,
Manske, Schreiber, Zyvoloski, and Otremba.

Voting
Against: None.

ATTEST:

City Administrator

Council President

Approved this 2nd day of July, 1990.



Mayor

(SEAL)

Published : July 9, 1990

REC'D. BY
MMB JUL 16 1990

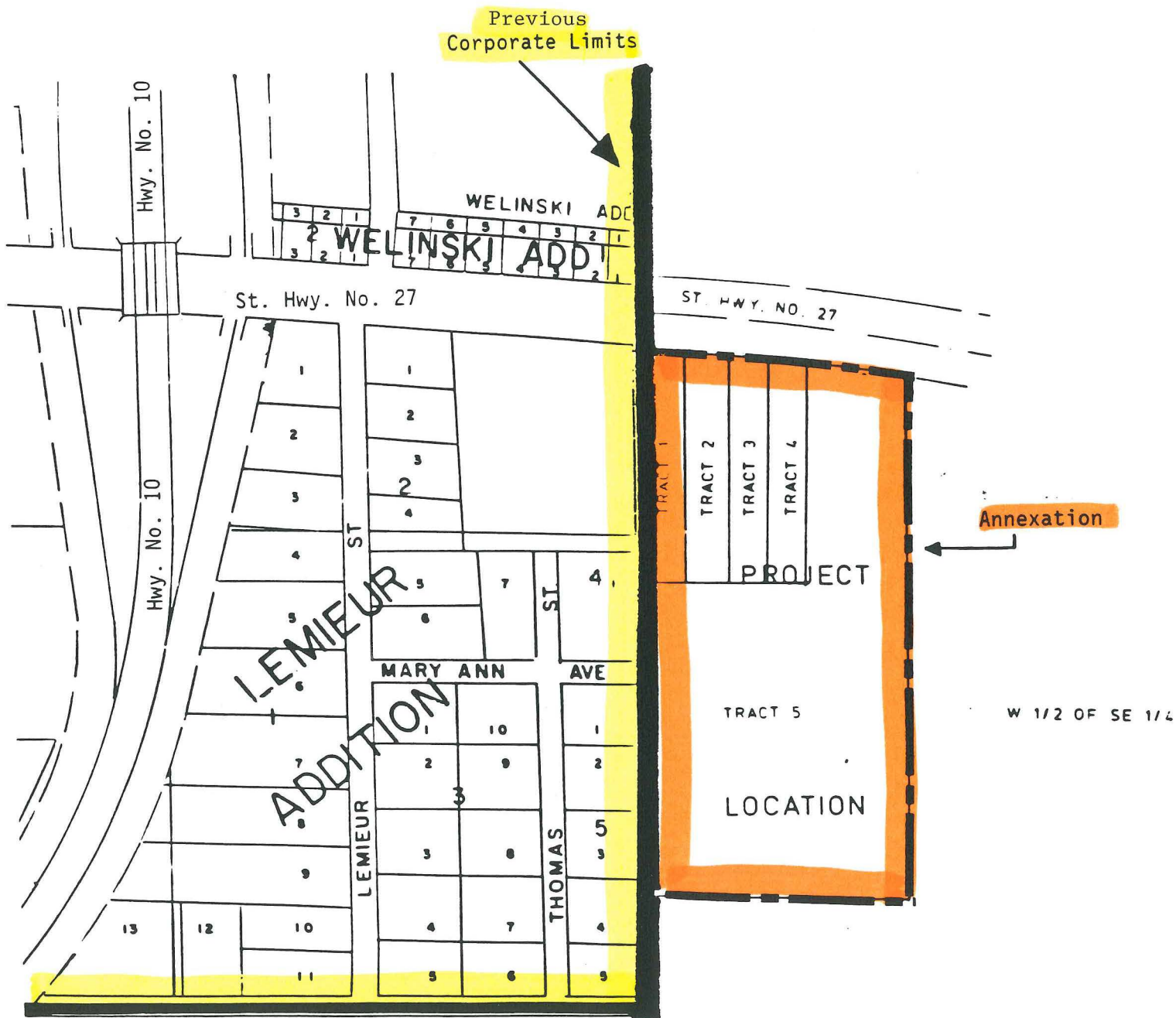
SITE OF ANNEXATION



** map not to scale

CITY OF LITTLE FALLS, MINNESOTA

MORRISON COUNTY, DRAWN JANUARY 1974

SCALE 1 INCH = 400 FEET

REC'D BY JUL 16 1990
MMB

CITY OF
LITTLE FALLS
MORRISON CO MINNESOTA
SCALE 1" = 400'
DATE FEB 1979

