

A Regular meeting of the City Council of the City of Rockford, Minnesota, was called to order by Mayor White at 7:00 p.m. in the Council Chambers of the City Hall, 6031 Main Street, Rockford, Minnesota on April 24, 1990. The following Council members were present: White, Ausen, Diesen and Heairet; the following Council members were absent: Englund. A Motion to adopt the following Resolution was made by Ausen and seconded by Diesen.

* * * * *

RESOLUTION # 90-22

NOTICE OF INTENT TO ANNEX CERTAIN PROPERTY GENERALLY BOUNDED BY THE 500 LINE RAILROAD RIGHT OF WAY ON THE SOUTH; STATE HIGHWAY #55 ON THE NORTH, LONE OAKS DEVELOPMENT ON THE EAST AND THE WESTERN BOUNDARY OF THE CITY IF EXTENDED ON THE WEST

WHEREAS, the territory described below is not presently within the corporate limits of any incorporated city, and

WHEREAS, this territory abuts upon the corporate limits of the City, and

WHEREAS, 60% or more of the perimeter of this territory is bordered by the City of Rockford, and

WHEREAS, this territory is 40 acres or less in the area, and

WHEREAS, one property owner in this area has requested that the City consider annexation of their property into the City's corporate limits, and

WHEREAS, the Planning Commission has recommended to the City Council to serve notice of intent to annex this property into the City of Rockford.

NOW, THEREFORE, BE IT RESOLVED BY THE CITY COUNCIL OF ROCKFORD, MINNESOTA, THAT WE hereby serve to the Township of Rockford, Wright County and the Minnesota Municipal Commission a Notice of Intent to Annex the following described property into the corporate limits of the City of Rockford:

Description: NW Quarter (NW 1/4) and the Southwest Quarter (SW 1/4) of the Northwest Quarter (NW 1/4), Section 29, T.119, Range 24 and E. 200' of NE 1/4 of Section 30, T. 119N, R24W, including all the property presently located in Rockford Township.

The following Council members voted in favor: White, Ausen, Diesen and Heairet; the following Council members voted against or abstained: None

Whereupon the motion was declared duly passed and executed.

REC'D. BY
M.M.B. MAY 25 1990



NORTH SECTION
LINE SEC. 29,
T. 119, R. 24

STATE HWY NO. 55

WALNUT PL

PROPOSED ANNEXATION
TO THE CITY OF ROCKFORD

PROPOSED
80' STREET
R.O.W.

200'

20' ADDITIONAL
STREET R.O.W.

PROPOSED
FUTURE
80' STREET
R.O.W.

CORPORATE LIMITS

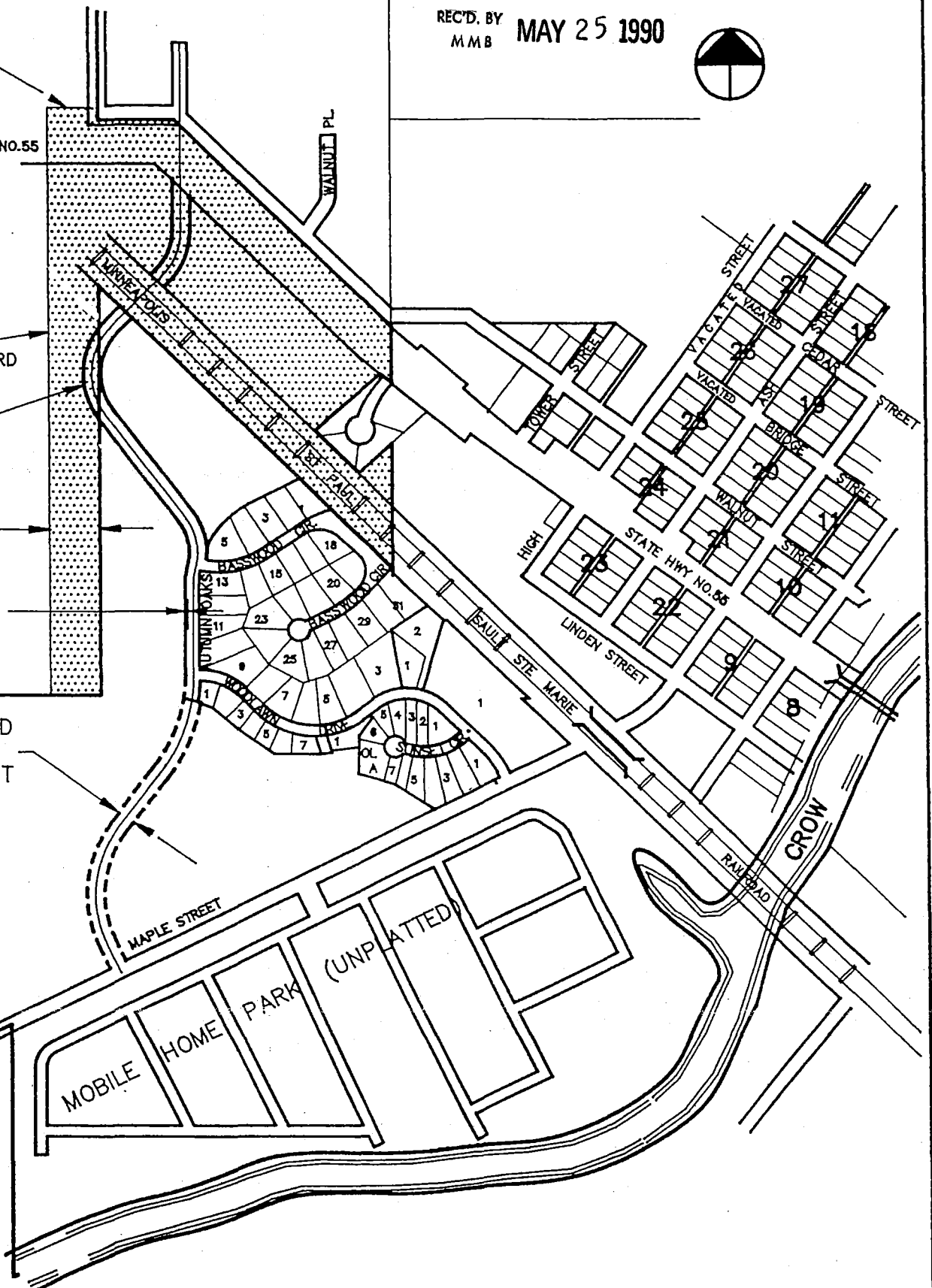

MOBILE HOME PARK (UNPLATTED)

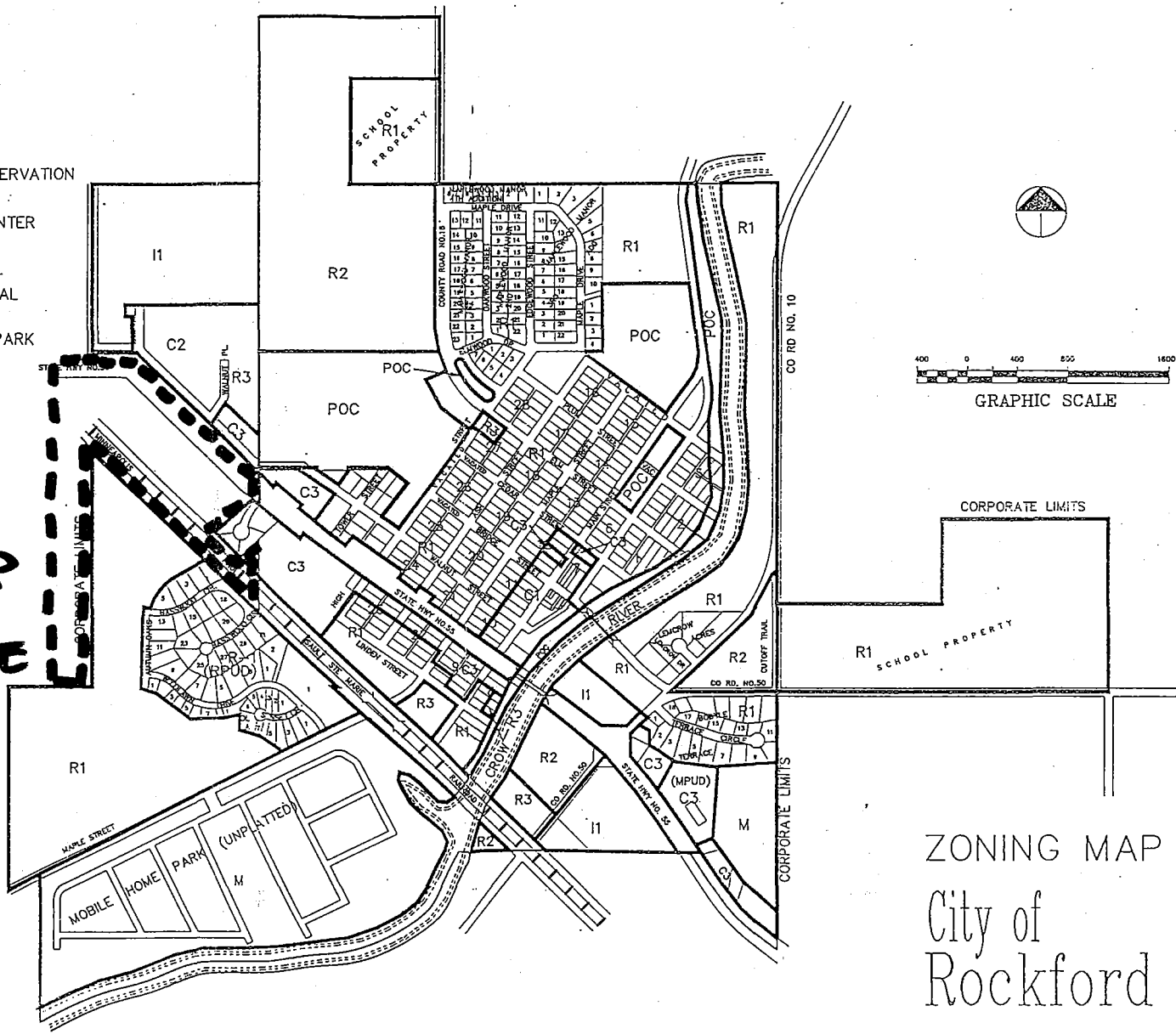

EXHIBIT B
RIGHT OF WAY &
PROPOSED ANNEXATION TO
CITY OF ROCKFORD

City of
Rockford

- LEGEND
- I1 INDUSTRIAL
 - POC PUBLIC, OPEN SPACE, CONSERVATION
 - C1 COMMERCIAL SERVICE
 - C2 COMMERCIAL SHOPPING CENTER
 - C3 COMMERCIAL HIGHWAY
 - R1 SINGLE FAMILY RESIDENTIAL
 - R2 MEDIUM DENSITY RESIDENTIAL
 - R3 MULTI-FAMILY RESIDENTIAL
 - M MANUFACTURED HOUSING PARK

**PROJECT
LOCATION MAP
NOT TO SCALE**

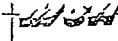

ZONING MAP
City of
Rockford

PREPARED BY:
 Keiser Stewart & Associates Inc.
 1936 KILB PLACE (815) 776-4491 ST. PAUL, MINN. 55111

REC'D. BY
M.M.B.
MAY 25 1990