

CITY OF FARMINGTON
DAKOTA COUNTY, MINNESOTA

REC'D. BY
MMB FEB 08 1990

ORDINANCE NO. 090-226

An Ordinance Annexing Certain Unplatted Land From Empire Township Pursuant To Minnesota Statutes §414.033(5)

THE CITY COUNCIL OF THE CITY OF FARMINGTON, MINNESOTA HEREBY ORDAINS AS FOLLOWS:

SECTION I: The property described below is hereby annexed to the City of Farmington pursuant to Minnesota Statutes §414.033(5), to wit:

The South 200 feet of the West 80 feet of the East 940 feet of the South 1/2 of the Southeast 1/4 of Section 30, Township 114, Range 19 West, all in Dakota County, Minnesota.

SECTION II: The City Administrator is hereby directed to file certified copies of this Ordinance with the Minnesota Secretary of State, the Minnesota Municipal Board, the Dakota County Auditor, and the Empire Town Board.

SECTION III: This annexation shall be effective at such time as this Ordinance has been approved by the Minnesota Municipal Board and the Ordinance has been published in the official newspaper.

SECTION IV: After adoption, signing and attestation, this ordinance shall be published one time in the official newspaper of the City and shall be in effect on and after the day following such publication.

Enacted and ordained the 16th day of January, 1990.

ATTEST:

Harv. M. Zinstuen

CITY OF FARMINGTON

Eugene "Balee" Kuchera
MAYOR

Kerry Thoy
CLERK/ADMINISTRATOR

Approved as to form the 16th day of January, 1990.

SEAL

[Signature]
CITY ATTORNEY

REC'D BY JAN 03 1990
HMB

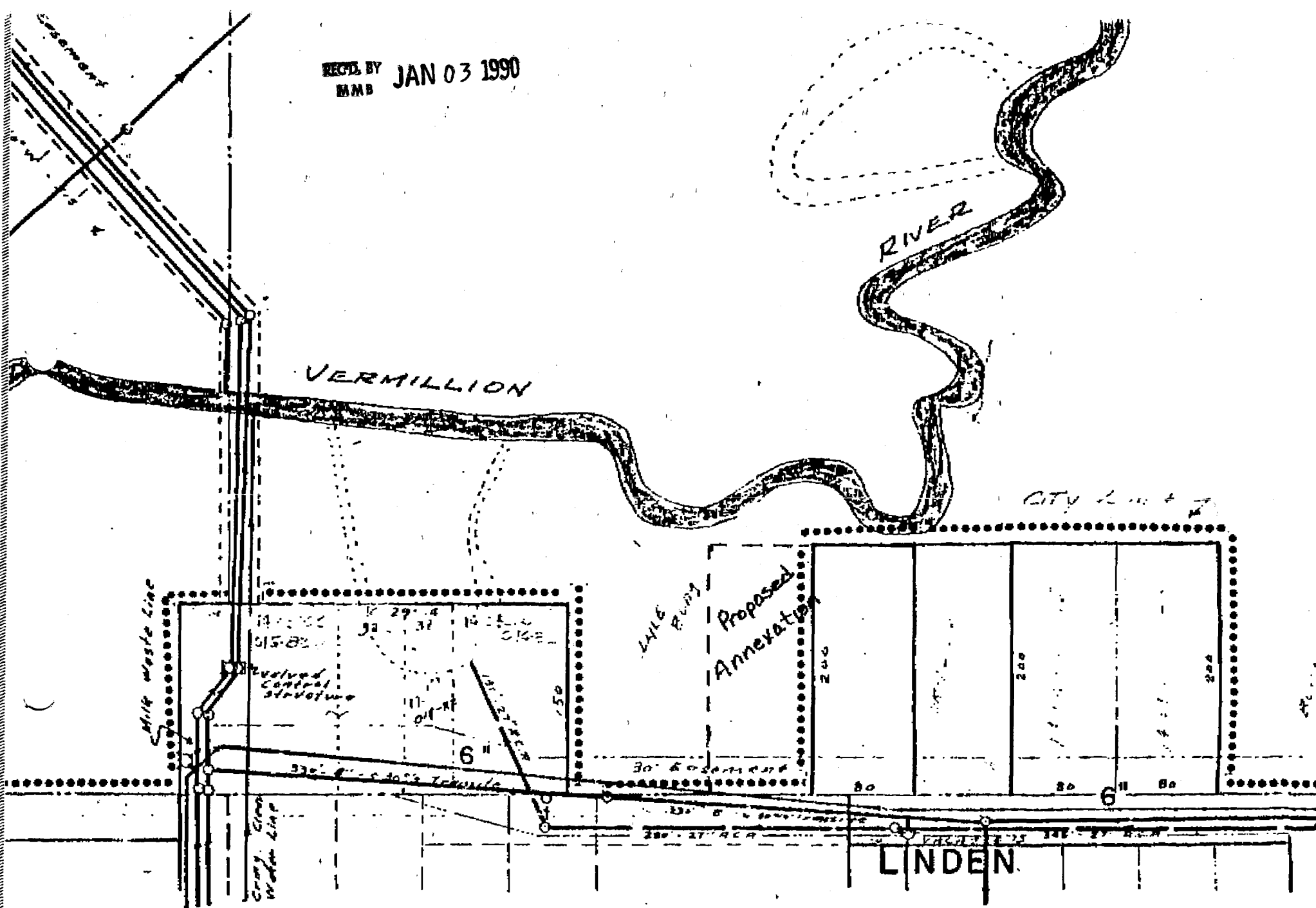

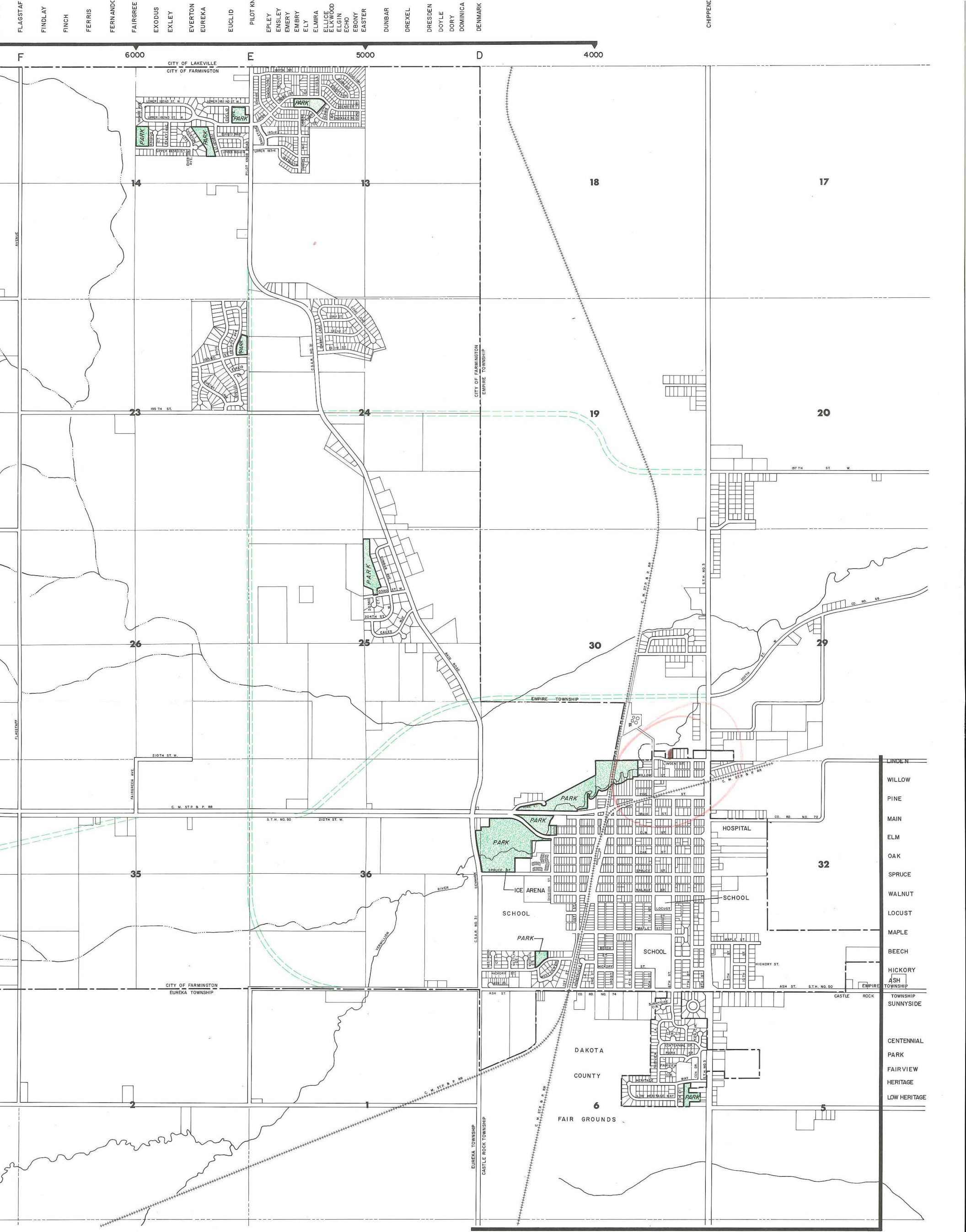

CITY OF FARMINGTON

REVISIONS	1000 500 0 1000	
MAY 15, 1980	SCALE IN FEET	
AUGUST 1981	PREPARED BY BONESTROO, ROSENE, ANDERLIK & ASSOCIATES-CONSULTING ENGINEERS-SAINT PAUL, MINNESOTA	
NOV. 1987		

- LEGEND:
- PARK
 - FUTURE MINOR ARTERIAL

REC'D. BY
MMB JAN 03 1990