

STATE OF MINNESOTA

CITY OF SPICER

COUNTY OF KANDIYOHI

PETITION FOR ANNEXATION

-----  
TO: CITY COUNCIL, CITY OF SPICER, MINNESOTA

The undersigned, being all of the owners of the parcels of property described below, herein petition that all of said parcel be annexed to the City of Spicer, State of Minnesota. Said property described as follows:

SEE ATTACHED LEGAL DESCRIPTION

Your Petitioners certify and state that said area is contiguous to the City of Spicer and that it is suitable and proper for annexation under the laws of the State of Minnesota and ordinances of the City of Spicer.

The Petitioners further request that the property be zoned upon annexation to the City of Spicer as follows: R-2

Your Petitioners further request that any existing or future development of said property be served with city facilities, including sanitary sewer, water, electricity, and any other utility required by the area within the capability of the City to so provide.

Your petitioners further represent that the property is, or about to be, urban in character, and that it is appropriate for the public safety, health, and its welfare that it be served with city services and be incorporated within the city limits.

Your Petitioners finally represent and state that they have read the contents of this Petition and understand the same, and covenant and agree by signing the same that it is irrevocable as to us and binding upon our heirs, representatives, and assigns.

Dated this \_\_\_18\_\_\_day of \_September\_, 1989.

REC'D. BY SEP 29 1989  
MMB

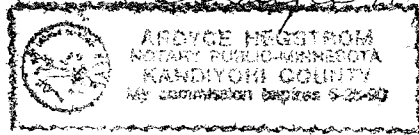

*Ardyce Hegstrom*  
*Willard L. Powell*

Willard L. Powell

*Nancy E. Powell*

Nancy E. Powell

*Ardyce Hegstrom*

Notary Public

STATE OF MINNESOTA )ss  
COUNTY OF KANDIYOHI )

18<sup>th</sup> DAY OF September, 1989

The following property in Kandiyohi County, Minnesota

✓ Lots 1, 2, 3, 4, 5, 6, 7, 8, 9, 10 and 11 of Block 4, and Lot "B",  
all in Haverly's Addition to Crescent Beach. ✓

✓ Part of Government Lot 1 of Section 3, Township 120, Range 34, described as follows, to-wit: The East 42 feet of the following described tract of land; Commencing at a point 25 feet South of the South boundary line of Lake Avenue in Park Addition to Spicer, and 33 feet West of the Section line between Sections 2 and 3 of Twp. 120, Rge. 34; thence running South and parallel to the said Section line, a distance of 83 feet to a point; thence running in a Westerly direction, a distance of 400 feet to a point on the South boundary line of said Lake Avenue, which point is 413 feet West of said Section line between Sections 2 and 3; thence running Easterly along the South boundary line of said Lake Avenue, a distance of 280 feet to a point thereon; thence running in an Easterly direction to the point of beginning.

Also

✓ Part of Government Lot 5 of Section 2, Township 120, Range 34, described as follows, to wit: Commencing at a stone on the North side of Lake Avenue in Haverly's Addition to Crescent Beach where it crosses the Section line between Sections 2 and 3 of said Township and Range; thence running South on said Section line 50 feet; thence in an Easterly direction and along the South side of said Lake Avenue a distance of 409 feet to a point; thence Southerly and at right angles to said Lake Avenue a distance of 116 feet to a point; thence Westerly and parallel with the South line of said Section to the South line of the Public Highway; thence Westerly along the South line of said Public Highway to a point on the Section line between Sections 2 and 3; thence North on said Section line to the point of beginning.

Also

✓ That part of Government Lot 5, of Section 2, Township 120, Range 34, described as follows, to wit: Commencing at a point on the South side of Lake Avenue in Haverly's Addition to Crescent Beach, 409 feet East of the Section line between Sections 2 and 3 of Twp. 120, Rge. 34, measured along the South line of said Lake Avenue; thence Southwesterly at right angles to said Lake Avenue a distance of 116 feet to a point; thence Southeasterly a distance of 62.5 feet to a point, which point is 116 feet South of the point of beginning; thence North 116 feet to the point of beginning.

Also

✓ That part of Government Lot 5 of Section 2, Township 120, Range 34, described as follows, to wit: Commencing at a point on the center line of Lake Avenue in Haverly's Addition to Crescent Beach, a distance of 409 feet Southeasterly from the Section line common to Sections 2 and 3 of Twp. 120, Rge. 34, measured from said Section line along the center of said Lake Avenue; thence running South and parallel with the West line of said Section 2, a distance of 90 feet to a point; thence in a Northeasterly direction to a point in the center of said Lake Avenue, which point is 66.7 feet Southeasterly from the place of beginning; thence Westerly and along the center line of said Lake Avenue to the point of beginning,

all of which is subject to easements of record.

LEGAL DESCRIPTION

Lots 6, 7, and 8 of Block 3 of Haverly's Addition to Crescent Beach. That part of Government Lot 5 of Section 2, Township 120, Range 34, described as follows: Beginning at a point on the center line of Lake Avenue in Haverly's Addition to Crescent Beach, which point is the intersection of said center line with the East line of Lot 6 of Block 3 in Haverly's Addition to Crescent Beach, extended Southerly; thence Southerly along said extended East line, a distance of 132.5 feet; thence Westerly and parallel with the South line of said Lake Avenue to a point distant 382 feet Easterly, measured along the center line of public highway running East and West across said Government Lot 5 at said point, from the West line of said Section 2; thence Northeasterly to a point in the center line of said Lake Avenue distant 475.7 feet Easterly, measured along said center line, from the West line of said Section 2; thence Easterly along the center line of said Lake Avenue to the point of beginning.

AND

That part of Government Lot 5 of Section 2, Township 120, Range 34, described as follows: Beginning at a point on the center line of Lake Avenue in Haverly's Addition to Crescent Beach, which point is the intersection of said center line with the East line of Lot 6 of Block 3 in Haverly's Addition to Crescent Beach, extended Southerly; thence Southerly along said extended East line, a distance of 132.5 feet; thence Easterly and parallel with the South line of said Lake Avenue a distance of 41.5 feet; thence Northerly to a point in the center line of said Lake Avenue, distant 41.5 feet Easterly from the point of beginning; thence Westerly along the center line of said Lake Avenue, a distance of 41.5 feet to the point of beginning, EXCEPTING THEREFROM the Easterly 15 feet thereof.





# MAP OF GREEN LAKE



TOWNSHIP : 120 N

RANGE : 34 W

NEW LONDON

CODE : GR

TOWNSHIP

IRVING TOWNSHIP

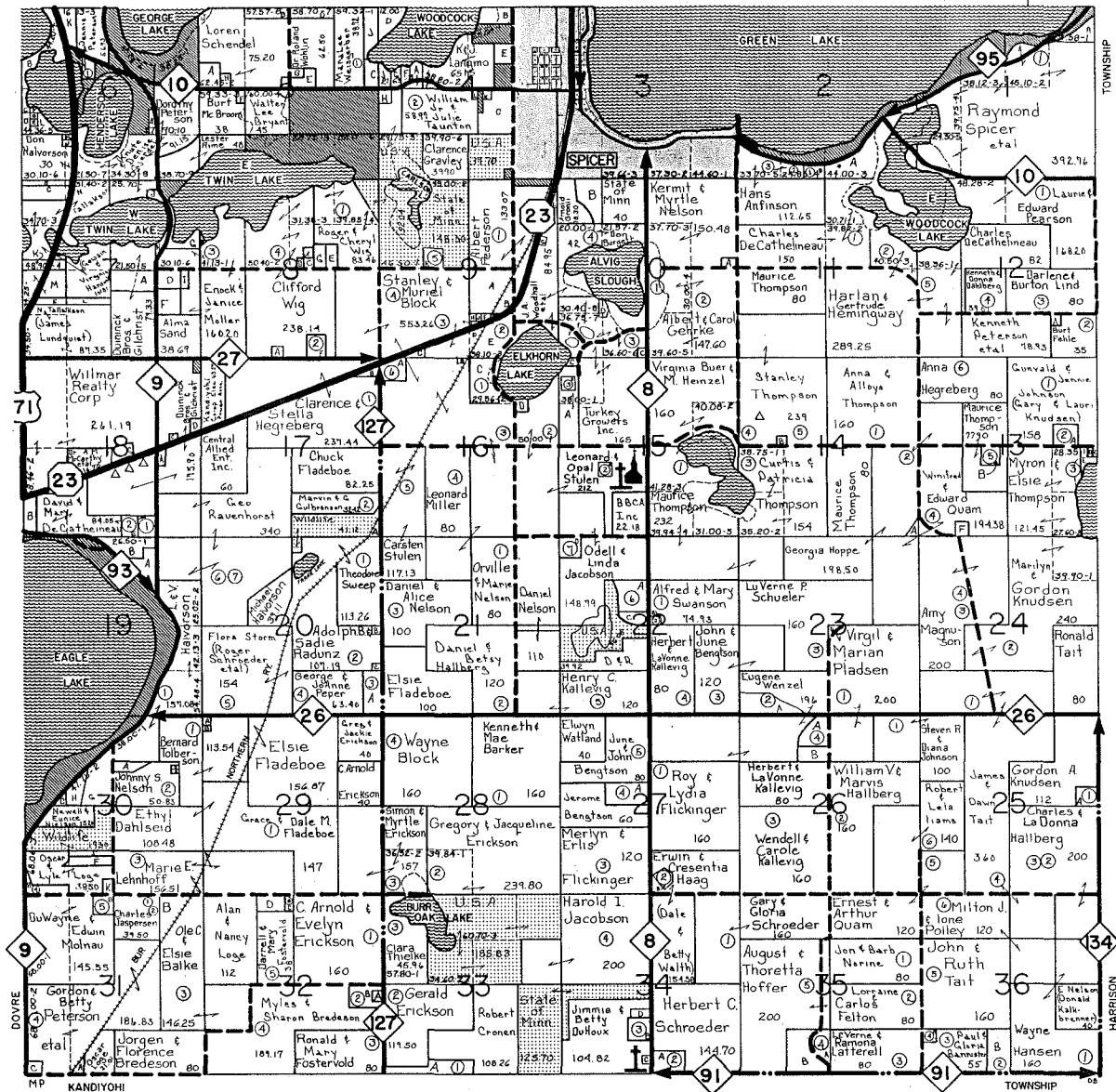

SEE SMALL TRACT OWNERS SECTION FOLLOWING TOWNSHIP MAPS

ADAMS	ALLEN	BURMAN	BUCKLEY
ANDERSON	ANDERSON	ANDERSON	ANDERSON
ANDERSON	ANDERSON	ANDERSON	ANDERSON
ANDERSON	ANDERSON	ANDERSON	ANDERSON
ANDERSON	ANDERSON	ANDERSON	ANDERSON
ANDERSON	ANDERSON	ANDERSON	ANDERSON
ANDERSON	ANDERSON	ANDERSON	ANDERSON
ANDERSON	ANDERSON	ANDERSON	ANDERSON
ANDERSON	ANDERSON	ANDERSON	ANDERSON
ANDERSON	ANDERSON	ANDERSON	ANDERSON