

PETITION FOR ANNEXATION BY ORDINANCE

RECEIVED BY
M.M.B. AUG 14-1989

IN THE MATTER OF THE PETITION OF
OWATONNA CANNING COMPANY
FOR ANNEXATION PURSUANT TO MINNESOTA STATUTES 414.033, SUBD. 5

TO: Council of the City of Owatonna, Minnesota.

Minnesota Municipal Board
165 Metro Square Building
St. Paul, Minnesota 55101

PETITIONERS STATE: The property owner or a majority of the property owners in number are required to commence a proceeding under M.S. 414.033, Subd. 5.

It is hereby requested by Owatonna Canning Company, the sole property owner to annex certain property described herein lying in the Town of Owatonna in the City of Owatonna, County of Steele, Minnesota.

The area proposed for annexation is described as follows:

Commencing at a point on the south line of the N 1/2 of the SW 1/4 of Section 8, Township 107N, Range 20W, that is 786.10' from the west line of the SW 1/4 of said Section 8; thence North 0°41'02" West 1483.98'; thence North 74°44'48" East 1266.51'; thence South 0°49'14" East 1791.46' to the South line of the N 1/2 of the SW 1/4 of Section 8, T107N, R20W; thence west along said South line of the N 1/2 of the SW 1/4 of Section 8, 1230.10' to the point of beginning.

1. There is one property owner in the area proposed for annexation.
2. Property owners have signed this petition
3. The population of the annexation area is 2.
4. Said property is unincorporated, abuts on the city's west boundary and is not included within any other municipality.
5. The area of land to be annexed is unplatted. Total acreage is 46.17.
6. The reason for the requested annexation is the property abuts city corporate limits on 3 1/2 sides and abuts developing industrial property.
7. All of the annexation area is or is about to become urban or suburban in character.
8. The area proposed for annexation is not included in any area that has already been designated for orderly annexation pursuant to M.S. 414.0325.

PETITIONERS REQUEST: That pursuant to M.S. 414.033, the property described herein be annexed to and included within the City of Owatonna.

Dated: aug 8, 1989

Charles A. Jager

The petition to the Minnesota Municipal Board should be accompanied by the following pursuant to Minnesota Municipal Board Law Chapter 414 and Rules of Procedure:

- A. A certification showing that a copy of the petition was filed within 10 days after service on the annexing city with the Town of Owatonna on August 11, 1989, the County of Steele on August 11, 1989, and the abutting municipality of Owatonna, on August 11, 1989.
- B. A filing fee of \$5 per acres with a minimum of \$100 and a maximum of \$600.
- C. Mapping requirements are described below:

(414.011) (DEFINITIONS) Subd. 9: "Corporate boundary map" means a map which accurately describes the boundaries of a municipality.

(414.011) (DEFINITIONS) Subd. 10: "Plat map" means that document recorded in the office of the county recorder in the county where the area is located.

(414.012) (MAPS) Subd. 1: (CORPORATE BOUNDARY MAP.) A municipality initiating any boundary adjustment authorized by this chapter shall file with the Municipal Board a corporate boundary map. Any proposed boundary adjustment shall be delineated on a copy of the corporate boundary map.

(414.012) (MAPS) Subd. 2: (PLAT MAPS.) Any party initiating a boundary adjustment, which includes platted land, shall file with the Municipal Board maps which are necessary to support and identify the land description. The maps shall include copies of plats.

Minnesota Municipal Board Rule 6000.0800 (c) A map showing the property proposed for consideration and its relationship to any surrounding municipality. All distance references should be given by length. Beginning points should be land survey monuments and the description must close the boundaries. References to roads or railroads should be to survey lines such as centerline or known right-of-way line. The intent to include or exclude highway, railroad, and street right-of-ways surrounding platted blocks or lots should be clearly stated.

A B C D E F G H I J K L M N O P Q

OWATONNA, MINNESOTA

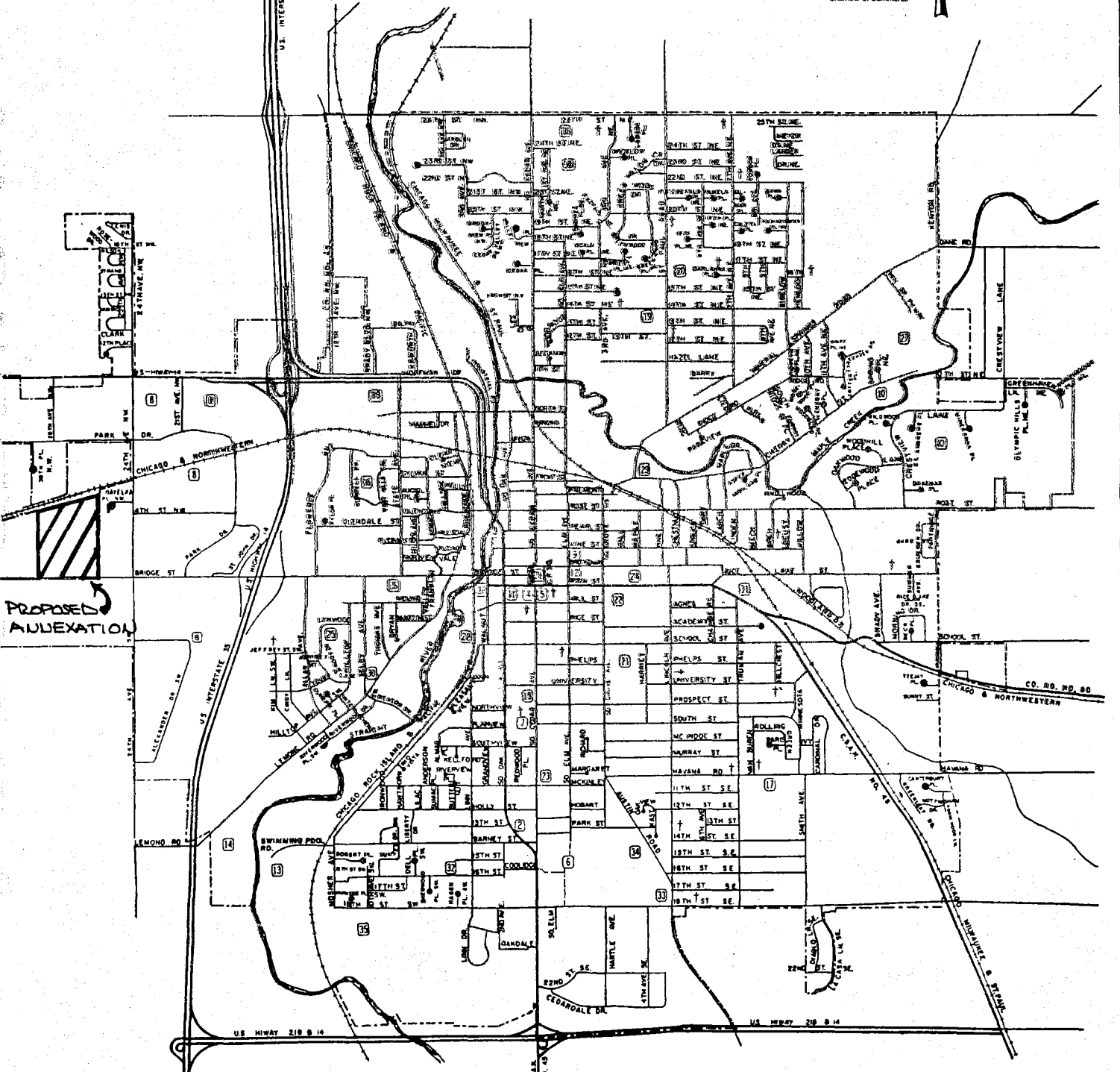
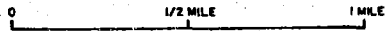
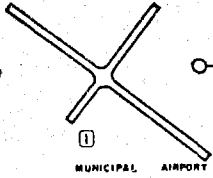

A B C D E F G H I J K L M N O P Q

PUBLIC BUILDINGS & LOCATIONS

Map #	Name	Code
1	Airport	C-3
2	Bus Depot	I-17
3	Chamber of Commerce	H-11
14	Country Club	D-16
5	Court House (Steele County)	I-12

Map #	Name	Code
16	Municipal Golf Course (Brooktree)	N-9
37	Municipal Utilities	K-12
11	Police & Sheriff Dept.	N-13
12	Post Office	I-13
13	Swimming Beach-Kohlmer Lake	E-16

REVISED BY COPYRIGHT, OWATONNA AREA CHAMBER OF COMMERCE, 1971

AUG 14 1977

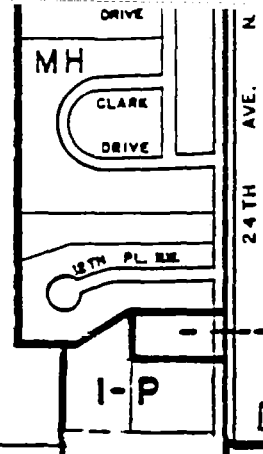

DRAWN BY: D.R.H., S.D.C. & P.A.

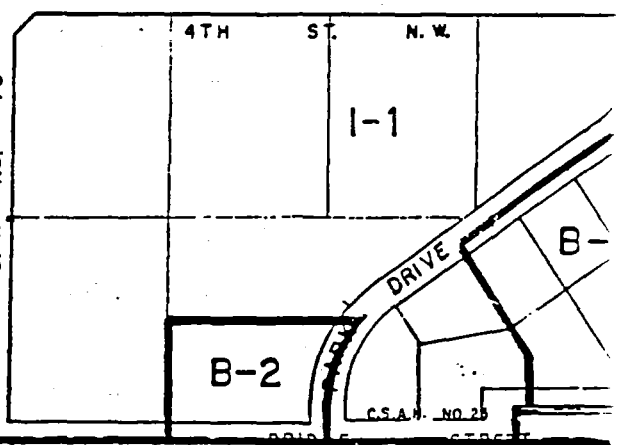
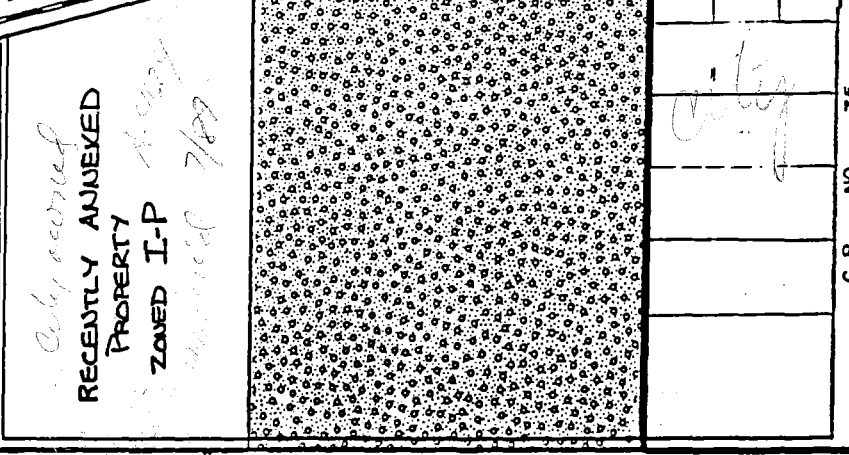
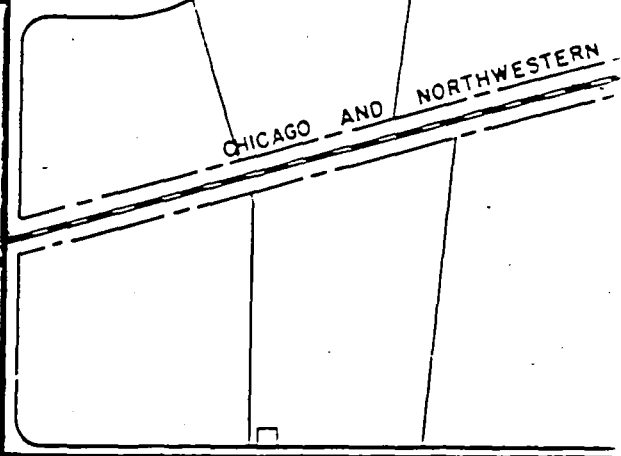
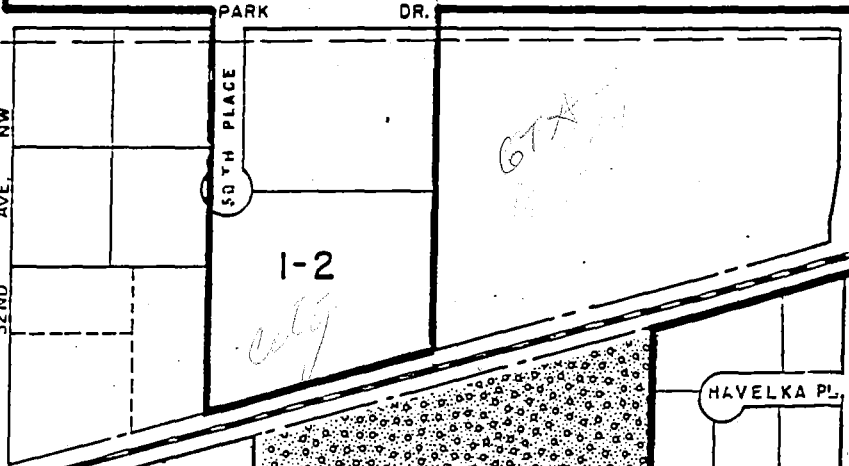
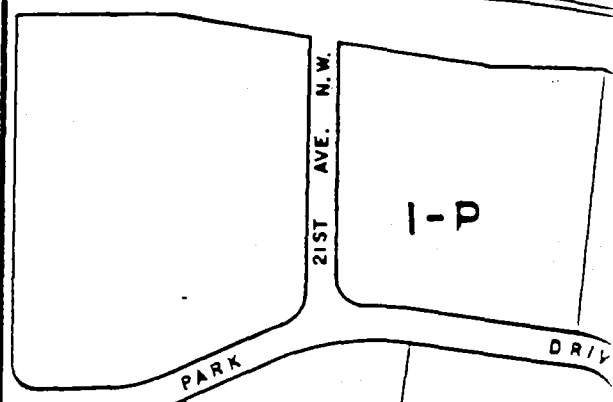
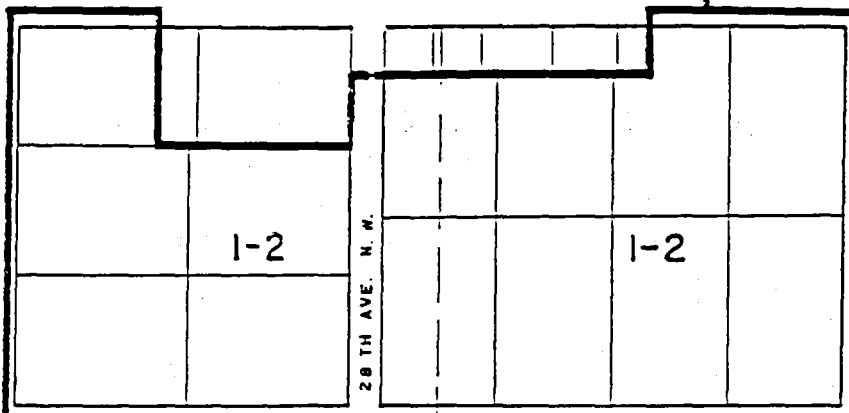

PROPOSED ANNEXATION
A-0 46.17 ACRES

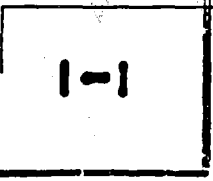

city