

ORDINANCE NO. 945

AN ORDINANCE EXTENDING THE CORPORATE LIMITS OF THE CITY OF WILLMAR, A MUNICIPAL CORPORATION OF THE STATE OF MINNESOTA, TO INCLUDE CERTAIN LANDS NOT EXCEEDING 200 ACRES.

WHEREAS, a Petition has been filed with the governing body of the City of Willmar, a municipal corporation in the State of Minnesota, by the owners having an interest therein, to have certain real estate hereinafter described included within the limits of the City of Willmar, Minnesota; and

WHEREAS, it is proposed to annex by virtue hereof to the said City of Willmar, said property, all of which said property is in Kandiyohi County, Minnesota; and

WHEREAS, pursuant to Minnesota law, said land may be annexed by ordinance; and

WHEREAS, the said real estate to be annexed is described as follows, to-wit:

That part of the SW $\frac{1}{4}$  of the SW $\frac{1}{4}$  of Section 13, Township 119, Range 35, lying Southeasterly of the centerline of Branch 3 of County Ditch No. 23A, except that part taken for right-of-way for CSAH No. 23.

NOW, THEREFORE, the City Council of the City of Willmar hereby determines, ordains and declares as follows:

Section 1. BEST INTEREST OF THE CITY OF WILLMAR AND AREA TO BE ANNEXED. That the annexation will be in the best interest of the City of Willmar, Minnesota, and of the territory affected.

Section 2. ABUTS ON CITY LIMITS. That the real estate above described abuts on the city limits, and is so conditioned as such property to be subject to city government.

Section 3. ANNEXATION. That the said real estate is hereby annexed to, and included within, the City of Willmar, Minnesota, as effectually as if it had originally been a part hereof.

Section 4. ZONING. The parcel above described shall be zoned R-3, Low Density Multiple Family Residential.

Section 5. ACREAGE. The parcel has a combined area of .25 acres.

Section 6. EFFECTIVE DATE. This Ordinance shall be filed and shall take effect and be in full force and effect from and after filing a certificate thereof with the Minnesota Municipal Commission, the County of Kandiyohi, Minnesota, and the Secretary of State of the State of Minnesota, and from and after its adoption and publication.

This Ordinance introduced by Councilman: Tinklenberg .  
This Ordinance introduced on: March 15, 1989 .  
This Ordinance published on: March 27, 1989 .  
This Ordinance given a hearing on: April 5, 1989 .  
This Ordinance adopted on: April 5, 1989 .  
This Ordinance published on: April 11, 1989 .

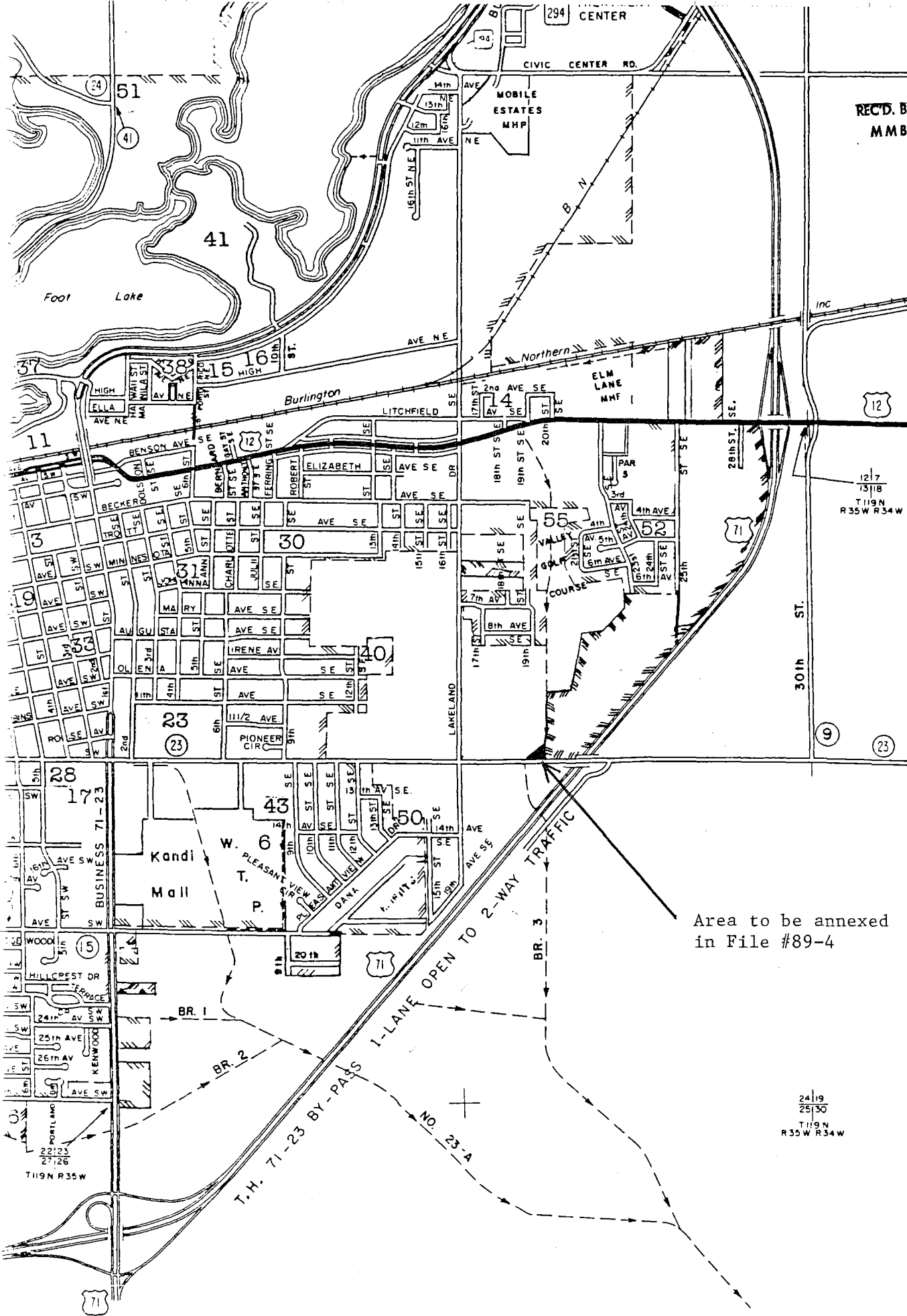

REC'D. BY APR 10 1989  
MMB

Area to be annexed  
in File #89-4

24/19  
25/30  
T119N  
R35W R34W