

APR 11 1989

md #945

PETITION FOR ANNEXATION

CITY OF WILLMAR  
County of Kandiyohi  
State of Minnesota

File No. 89-4  
Area No. \_\_\_\_\_

TO HONORABLE COUNCIL OF THE CITY OF WILLMAR, MINNESOTA

We, the undersigned, are the sole (all of the) (a majority of the) owners of the following described property lying in the County of Kandiyohi, State of Minnesota:

That part of the SW 1/4 of the SW 1/4 of Section 13, Township 119, Range 35, lying Southeastly of the centerline of Branch 3 of County Ditch No. 23 A, except that part taken for right of way for C.S.A.H. No. 23.

Said property is unincorporated, abuts upon the limits of the City of Willmar, and is not included within any other municipality. (Said property is platted and encompasses \_\_\_\_\_ acres) (Said property is unplatted and does not exceed 200 acres in area. The total acreage of such area is 1/4 acres.)

PETITIONERS RESPECTFULLY PETITION:

1. That pursuant to M.S. 414.033, said property be annexed to and incorporated within the City of Willmar.
2. That said property be zoned R-3.
3. That said property be served with City services/improvements/facilities/utilities, including sanitary and storm sewer, water, electricity and any other City utility required by the area and which is within the capability of the City to provide.

It is hereby certified and stated that said area is contiguous to the City of Willmar and is suitable and proper for annexation under the laws of the State of Minnesota and the ordinances of the City of Willmar; and

It is further certified and stated that we have read carefully the contents of the petition herein and understand the same and covenant and agree that by signing the same it is irrevocable as to us and is binding upon our heirs, representatives and assigns.

Dated: 2/28/89

By: The Korman Land Co.  
Daniel J. Korman

By: \_\_\_\_\_

A filing fee of \$100.00 must accompany this Petition for Annexation.

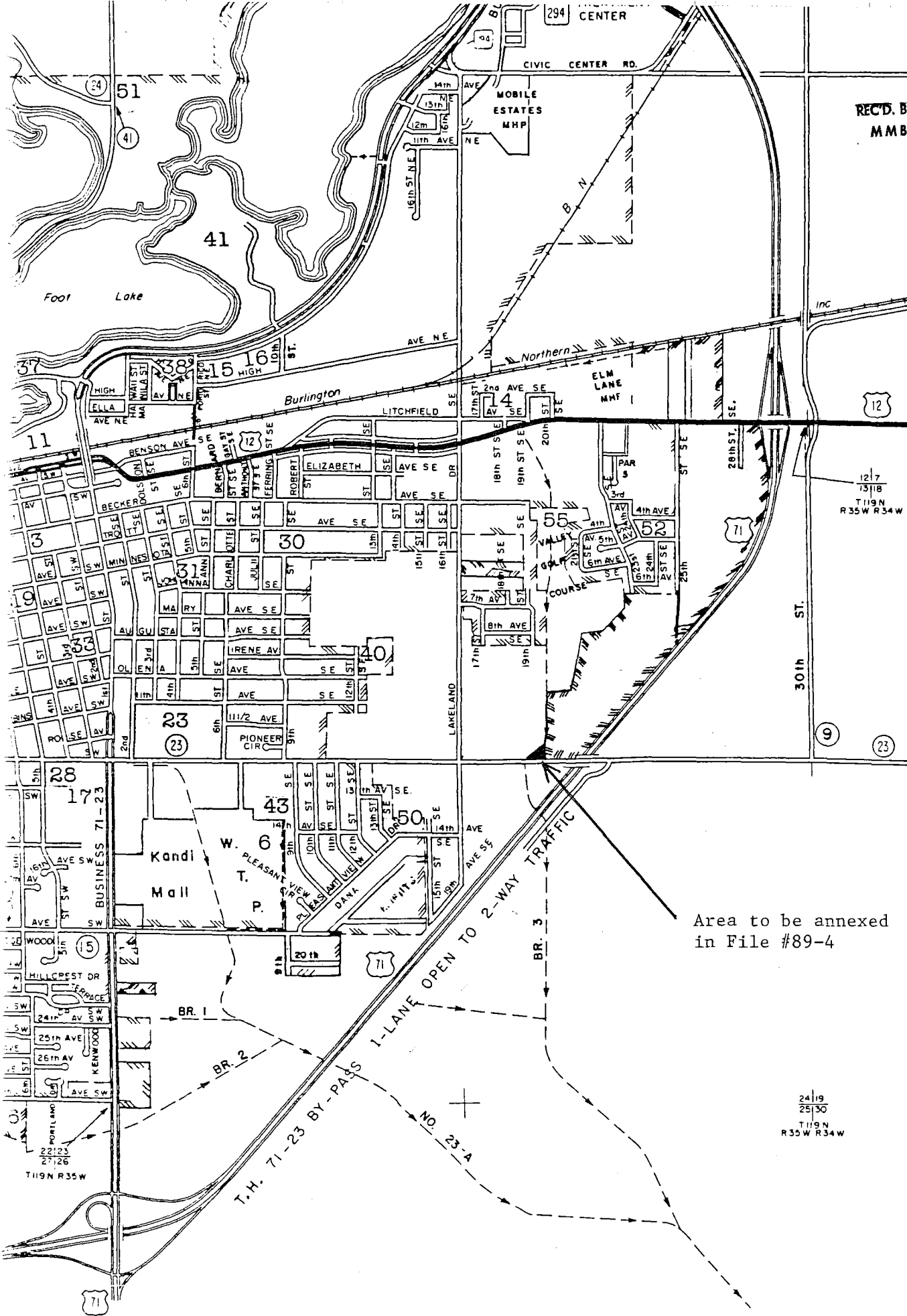

REC'D. BY APR 10 1989  
MMB

Area to be annexed  
in File #89-4

24/19  
25/30  
T.I. 19 N  
R 35 W R 34 W