

*ord. # 944*

PETITION FOR ANNEXATION

File No. 89-3  
Area No. \_\_\_\_\_

CITY OF WILLMAR  
County of Kandiyohi  
State of Minnesota

TO HONORABLE COUNCIL OF THE CITY OF WILLMAR, MINNESOTA

We, the undersigned, are (the sole) (all of the) (a majority of the) owners of the following described property lying in the County of Kandiyohi, State of Minnesota:

SE $\frac{1}{4}$  of SE $\frac{1}{4}$  of Section 21, Township 119, Range 35

Said property is unincorporated, abuts upon the limits of the City of Willmar, and is not included within any other municipality. (Said property is platted and encompasses \_\_\_\_\_ acres) (Said property is unplatted and does not exceed 200 acres in area. The total acreage of such area is 40 acres.)

PETITIONERS RESPECTFULLY PETITION:

1. That pursuant to M.S. 414.033, said property be annexed to and incorporated within the City of Willmar.
2. That said property be zoned R-1.
3. That said property be served with City services/improvements/facilities/utilities, including sanitary and storm sewer, water, electricity and any other City utility required by the area and which is within the capability of the City to provide.

It is hereby certified and stated that said area is contiguous to the City of Willmar and is suitable and proper for annexation under the laws of the State of Minnesota and the ordinances of the City of Willmar; and

It is further certified and stated that we have read carefully the contents of the petition herein and understand the same and covenant and agree that by signing the same it is irrevocable as to us and is binding upon our heirs, representatives and assigns.

Dated: 2-21-89

By: *Nettie M. Kelly*  
Nettie M. Kelly

By: *Jeffrey L. Danielson*  
Jeffrey L. Danielson  
*Susan P. Danielson*  
Susan P. Danielson

A filing fee of \$60<sup>00</sup> must accompany this Petition for Annexation.

*pd 4/2/89 BDP balance of \$40 pd. 4-10-89*

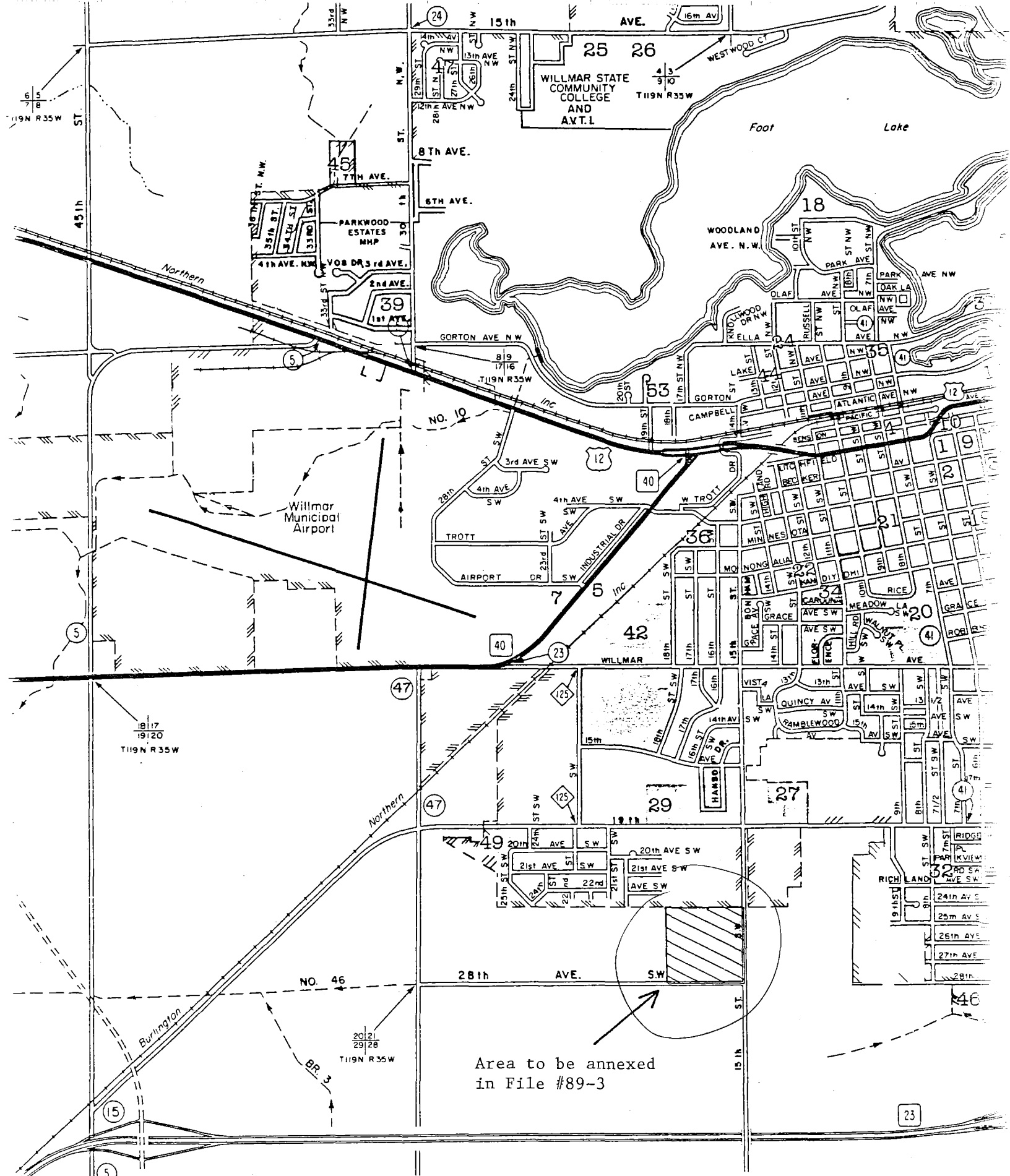

Area to be annexed  
in File #89-3

REC'D. BY APR 10 1989  
MMB