

ORDINANCE NO. 225

AN ORDINANCE ANNEXING KARVEL PROPERTY TO THE
CITY OF WAITE PARK

The City Council of Waite Park, Minnesota, ordains as follows:

1. That the City has been deeded and is the owner of property lying in Stearns County legally described as follows:

All that part of the Northwest Quarter of the Northwest Quarter (NW 1/4 of NW 1/4) of Section Seventeen (17), Township One Hundred Twenty-four (124) North, Range Twenty-eight (28) West, lying Easterly of the East Bank of Sauk River and North and West of the Center line of County Aid Road #138 and North of the following described line: Commencing at the point of intersection of the westerly right-of-way line of County Aid Road #138, and the Northerly right-of-way line of Old Trunk Highway #52 and assuming the bearing of said Northerly right-of-way line of Old Trunk Highway #52, to be, South 82 degrees 36 minutes East; thence North 12 degrees 46 minutes East along said Westerly right-of-way line of County Aid Road #138, a distance of 1190.15 feet to the point of beginning of the line herein described; thence North 82 degrees 36 minutes West, for a distance of 589.70 feet, more or less, to a point on the East Bank of the Sauk River and there terminating, in Stearns County, Minnesota.

Pursuant to Minn. Stat. 414.033, the City Council is empowered to annex the property without further notice in the event that the land is owned by the municipality.

The City of Waite Park, by power vested pursuant to Minnesota law, does hereby annex the property referred to in Paragraph 1 of this Ordinance.

The City Clerk is directed to file a copy of this Ordinance with the Secretary of State, the executive director of

the Minnesota Municipal Board, the State Auditor, and the Town Clerk for the Township of St. Cloud. This Ordinance shall become effective upon its passage, publication, and filing with the Minnesota Municipal Board.

Dated this 14th day of February, 1989.



Alcuin Ringsmuth, Mayor



Jeffrey Baird
City Clerk/Treasurer

I do hereby certify that this is a true and correct copy of Waite Park City Ordinance # 225 passed by the Waite Park City Council on February 14, 1989 and published on February 22, 1989.



Jeffrey J. Baird
City Clerk/Treasurer of the City of Waite Park

S E A L

From Roger
7-1488
mts

REC'D. BY
MMB MAR 10 1889

DR. KARVEL
PROPERTY DONATION

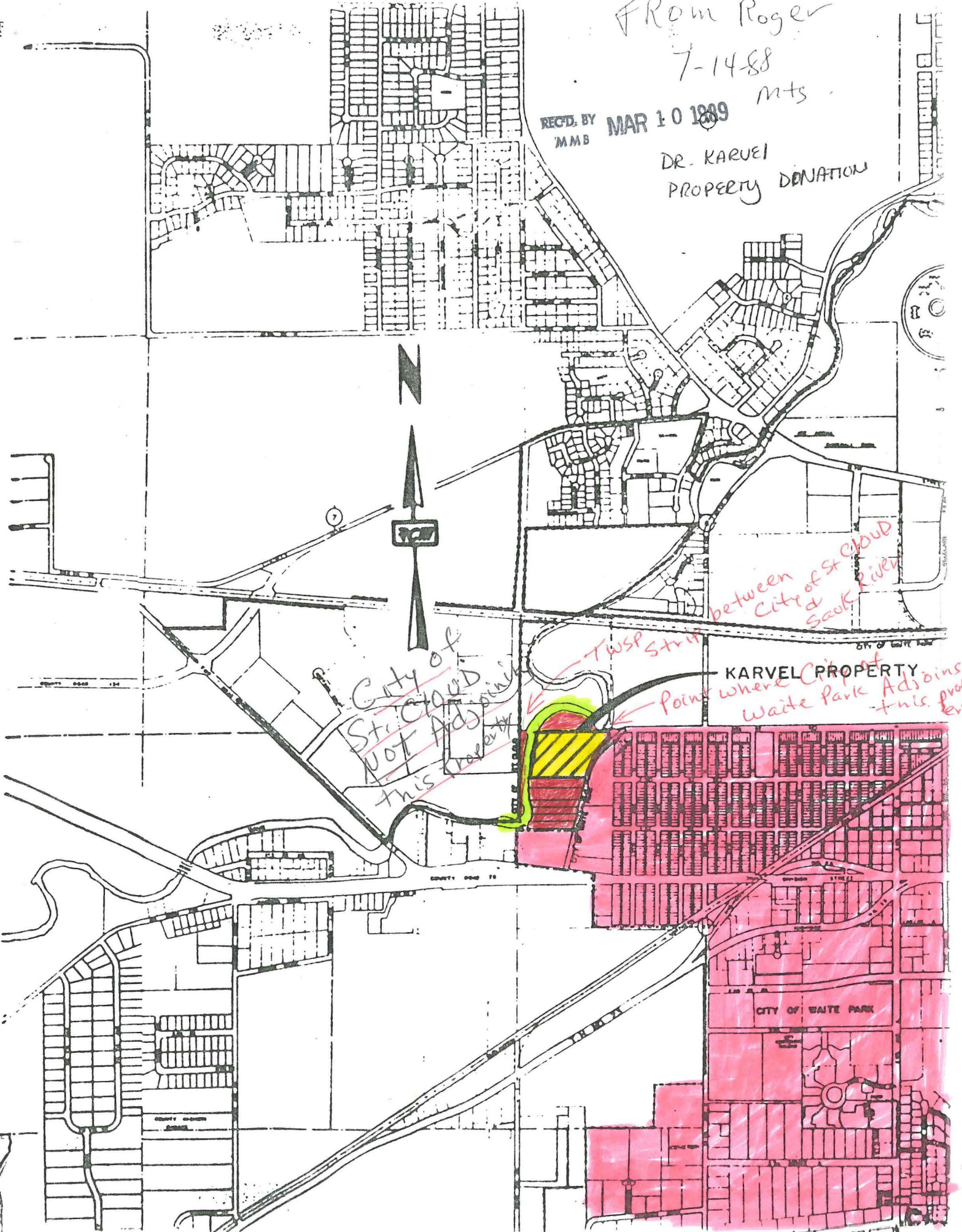

City of
St. Cloud
NOT Adjoining
this territory

between City of St. Cloud
& Saak River

TWP Street

KARVEL PROPERTY
Point where City of
Waite Park Adjoins
this property

CITY OF WAITE PARK