

ORDINANCE NO. 902.00

AN ORDINANCE EXTENDING THE CORPORATE LIMITS OF THE CITY OF WARROAD TO INCLUDE CERTAIN UNINCORPORATED PROPERTY OWNED BY AND ABUTTING UPON THE LIMITS OF THE CITY.

WHEREAS, the territory described below is not presently within the corporate limits of any incorporated city; and

WHEREAS, the territory abuts upon the corporate limits of the city at the Southern boundary thereof and is deemed to be urban or suburban in character; and

WHEREAS, this territory is owned in fee by the city;

The city council of Warroad ordains:

Section 1. Territory annexed. The corporate limits of the City of Warroad are hereby extended to include the unplatted property described as follows now owned by the city:

That part of the North East Quarter (NE $\frac{1}{4}$) of Section Thirty-two (32), Township One Hundred Sixty-three (163) North, Range Thirty-six (36) West of the Fifth Principal Meridian, Roseau County, Minnesota described as follows:

Commencing at the North East corner of the North East Quarter of said Section 32; thence on an assumed bearing of South 00 degrees 09 minutes 00 seconds East along the East line of said Section 32 a distance of 739.06 feet to the South line of Paul's Addition to the City of Warroad to the point of beginning; thence North 89 degrees 16 minutes 48 seconds West along said South line of Paul's Addition a distance of 1412.87 feet to the Easterly right-of-way

line of the Canadian National Railroad; thence along said Easterly right-of-way South 16 degrees 43 minutes 03 seconds East a distance of 773.72 feet to the point of curve of a tangential curve concave to the northeast, central angle 34 degrees 56 minutes 00 seconds, Radius 2814.93 feet; thence Southeasterly along said curve chord bearing South 30 degrees 40 minutes 07 seconds East, chord distance 1357.43 feet a distance of 1370.94 feet to the South line of said North East Quarter; thence South 89 degrees 44 minutes 47 seconds East along said South line a distance of 52.77 feet; thence North 00 degrees 09 minutes 00 seconds West a distance of 450.00 feet; thence South 89 degrees 44 minutes 47 seconds East a distance of 450.00 feet to the East line of said North East Quarter; thence North 00 degrees 09 minutes 00 seconds West along said East line a distance of 1443.07 feet to the point of beginning. Containing 41.68 acres more or less.

Section 2. Filing. The city clerk is directed to file certified copies of this ordinance with the Secretary of State, the County Auditor of the county of Roseau County, the Lake Township Clerk and the Minnesota Municipal Board.

Section 3. Effective date of annexation. This ordinance takes effect upon its passage and publication and the filing of certified copies as directed in Section 2.

Adopted by the City of Warroad, Minnesota

October 11, 1988.

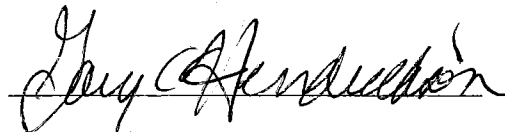

Gary C. Hendrickson, Mayor

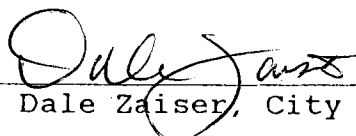
ATTEST:

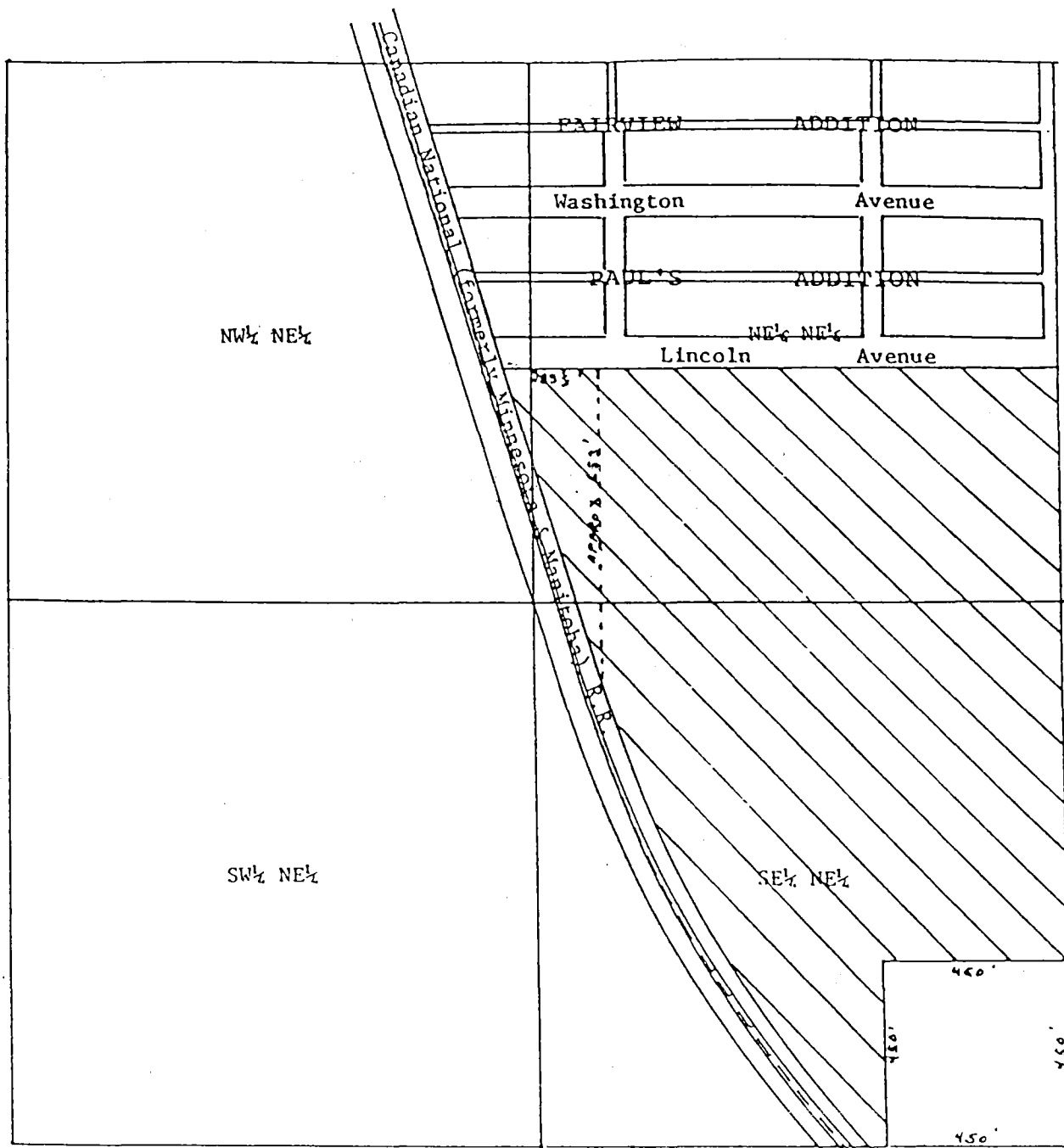
Dale Zaiser, City Clerk

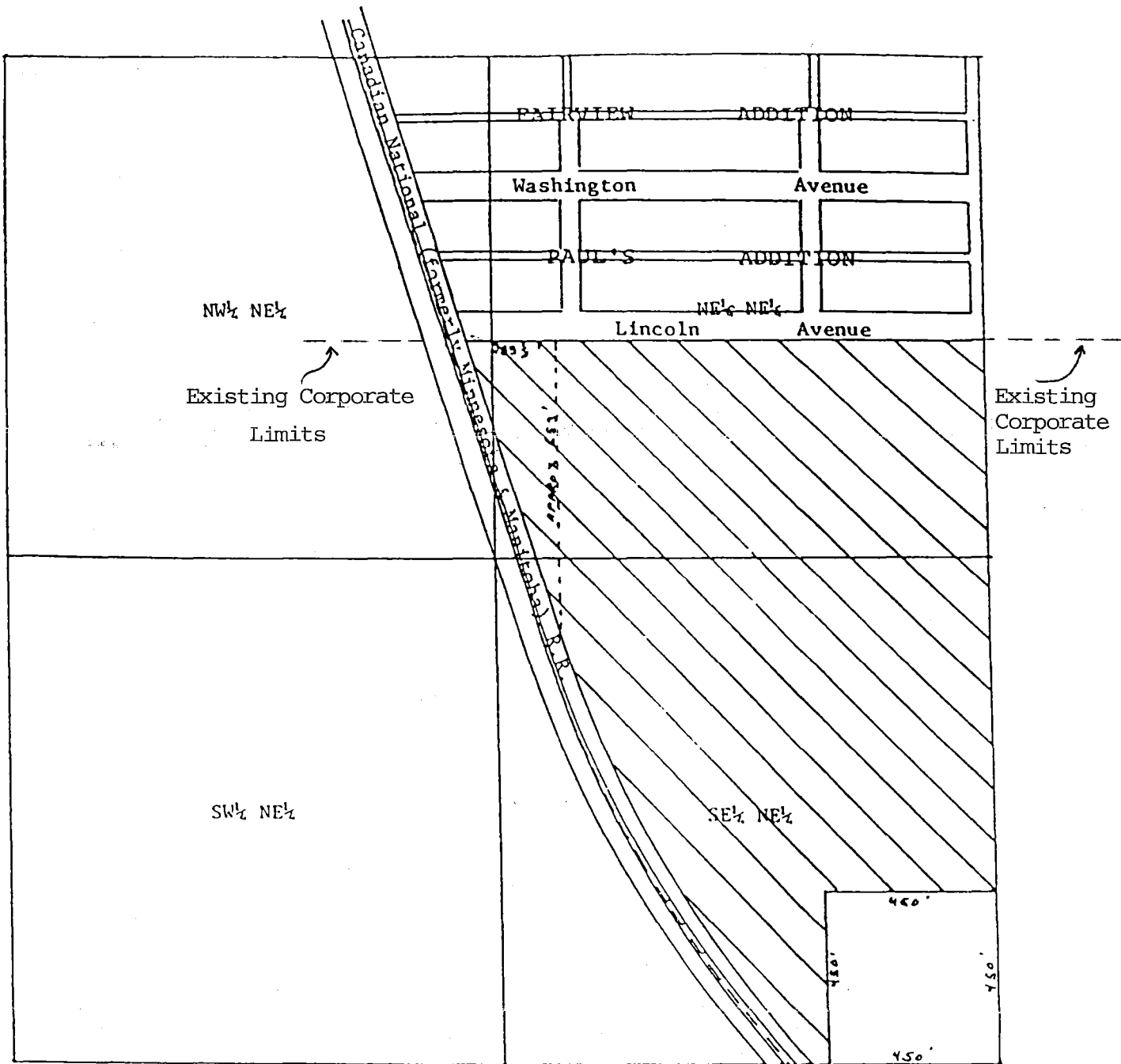

41.68 Acres



41.68 Acres

Property described
in Ordinance #903

A-4534

REC'D. BY
MMB NOV 30 1988

Existing
Corporate Limits

WARROAD, MINNESOTA

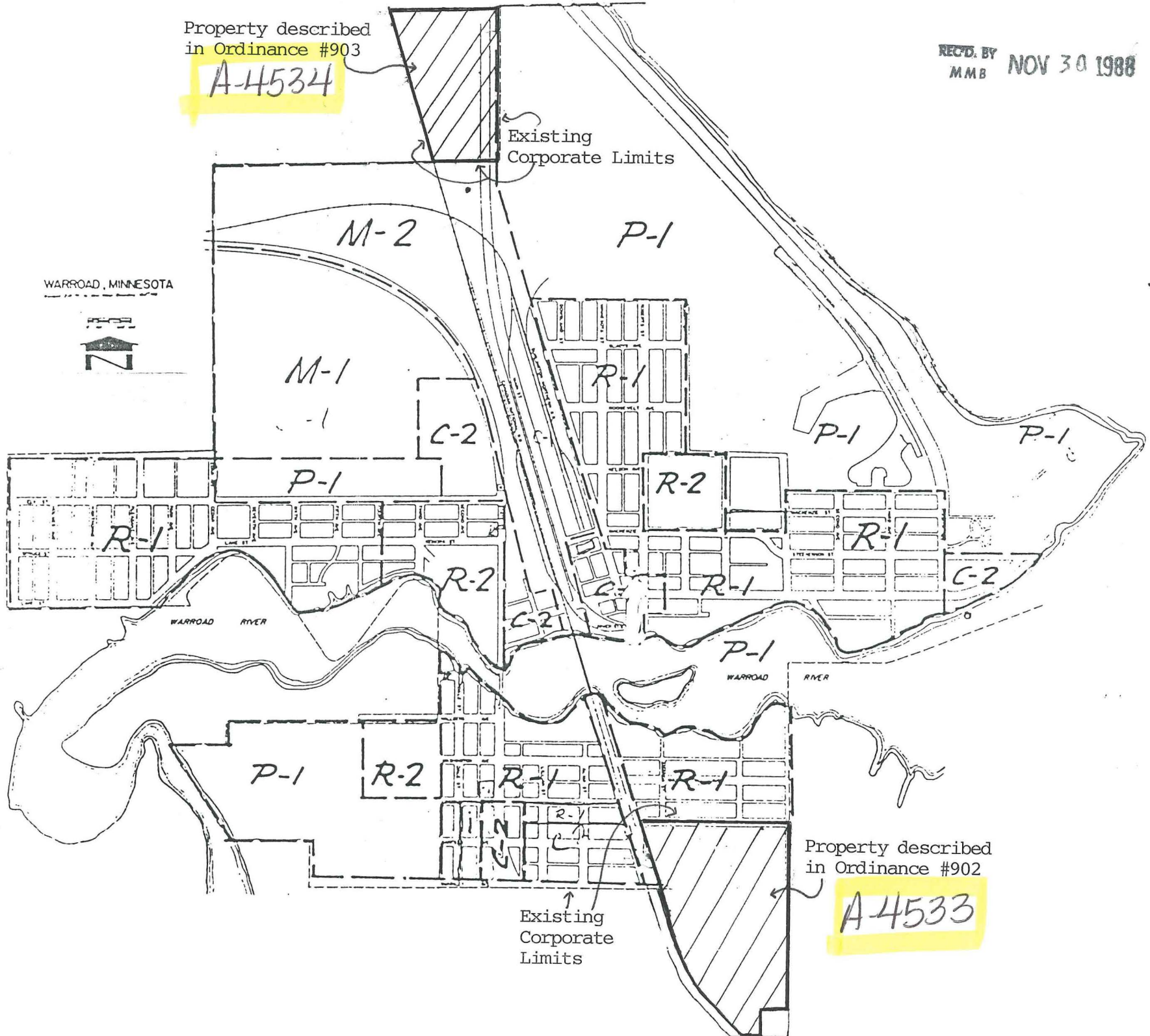

Property described
in Ordinance #902

A-4533

Existing
Corporate
Limits