

ORDINANCE NO. 679

AN ORDINANCE EXTENDING THE CORPORATE LIMITS
OF THE CITY OF STILLWATER INTO CERTAIN
UNINCORPORATED TERRITORY THAT IS OWNED
BY THE CITY OF STILLWATER

WHEREAS, certain territory described below is not presently included within the corporate limits of any incorporated city; and

WHEREAS, this territory is owned by the city and the land is deemed to be urban or suburban in character;

NOW THEREFORE, the City Council of the City of Stillwater ordains:

Section 1. Territory Annexed. The corporate limits of the City of Stillwater, Minnesota, are hereby extended to include the territory described as follows:

All that part of the East 1046.17 feet of the Southeast Quarter of Section 31, Township 30 North, Range 20 West, Washington County, Minnesota, contained within the following described parcel of land, to-wit:

All that part of the Southeast Quarter of Section 31, Township 30 North, Range 20 West, Washington County, Minnesota, described as follows to-wit: Beginning at the northwest corner of the South Half of said Southeast Quarter of Section 31, thence South 89 degrees 25 minutes 16 seconds East, assumed bearing, along the northerly line of said South Half of the Southeast Quarter a distance of 42.00 feet; thence South 65 degrees 12 minutes 11 seconds East 214.95 feet; thence easterly along a tangential curve, concave to the north, radius 1333.12 feet, central angle 17 degrees 03 minutes 51 seconds, 397.04 feet; thence South 82 degrees 16 minutes 02 seconds East along tangent 806.81 feet; thence South 82 degrees 56 minutes 16 seconds East 1068.50 feet to the centerline of Stillwater Boulevard North; thence North 34 degrees 51 minutes 17 seconds East along said centerline 306.74 feet, more or less, to its intersection with the easterly line of said Southeast Quarter; thence northerly along said easterly line to a point 130.90 feet southerly of the northeast corner of the northeast corner of said South Half of the Southeast Quarter; thence westerly to a point in the westerly line of the Northeast Quarter of said Southeast Quarter distant 33.00 feet northerly of the southwest corner thereof; thence westerly to a point in the westerly line of the Northwest Quarter

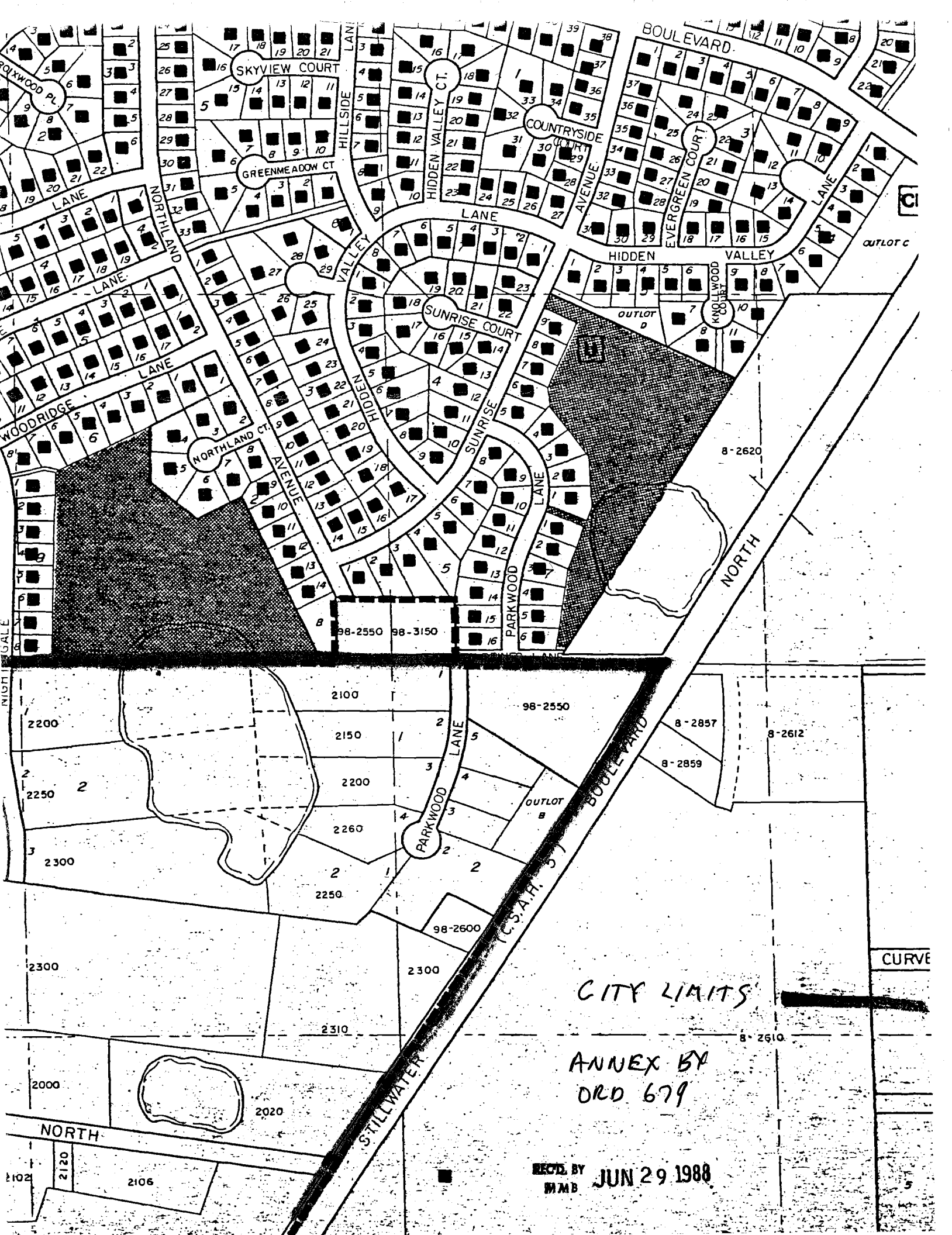

CITY LIMITS

ANNEX BY
ORD 679

REC'D BY
MMB

JUN 29 1988