

PETITION FOR ANNEXATION

REC'D. BY JUN 20 1988
MMB

CITY OF WILLMAR
County of Kandiyohi
State of Minnesota

File No. 88-2
Area No. _____

TO HONORABLE COUNCIL OF THE CITY OF WILLMAR, MINNESOTA

We, the undersigned, are (the sole) ~~(all of the)~~ ~~(a majority of the)~~ owners of the following described property lying in the County of Kandiyohi, State of Minnesota:

See attached

Said property is unincorporated, abuts upon the limits of the City of Willmar, and is not included within any other municipality. (Said property is platted and encompasses _____ acres) (Said property is unplatted and does not exceed 200 acres in area. The total acreage of such area is 3.26 acres.)

PETITIONERS RESPECTFULLY PETITION:

1. That pursuant to M.S. 414.033, said property be annexed to and incorporated within the City of Willmar.
2. That said property be zoned GB.
3. That said property be served with City services/improvements/facilities/utilities, including sanitary and storm sewer, water, electricity and any other City utility required by the area and which is within the capability of the City to provide.

It is hereby certified and stated that said area is contiguous to the City of Willmar and is suitable and proper for annexation under the laws of the State of Minnesota and the ordinances of the City of Willmar; and

It is further certified and stated that we have read carefully the contents of the petition herein and understand the same and covenant and agree that by signing the same it is irrevocable as to us and is binding upon our heirs, representatives and assigns.

Dated: 6/1/88

By: Marcus Construction Co., Inc
Barb Marcus

By: _____

A filing fee of \$100.00 must accompany this Petition for Annexation.

pd 6-1-88

JUN 20 1988

WHEREAS, the said real estate to be annexed is described as follows, to-wit:

The West 160 feet of the East 565 feet of the South 297 feet of the SE $\frac{1}{4}$ of the SE $\frac{1}{4}$ of Section 22, Township 119, Range 35; and all that part of the SE $\frac{1}{4}$ of the SE $\frac{1}{4}$ of said Section 22, described as follows: Beginning at the Southeast corner of said Section 22; thence North along the East line of said Section 22, a distance of 297 feet; thence West parallel with the South line of said Section 22, a distance of 405 feet; thence South and parallel with the East line of said Section 22, a distance of 297 feet to the South line of said Section 22; thence East along said South line, 405 feet, to the point of beginning, excepting the North 80 feet of the East 320 feet thereof;

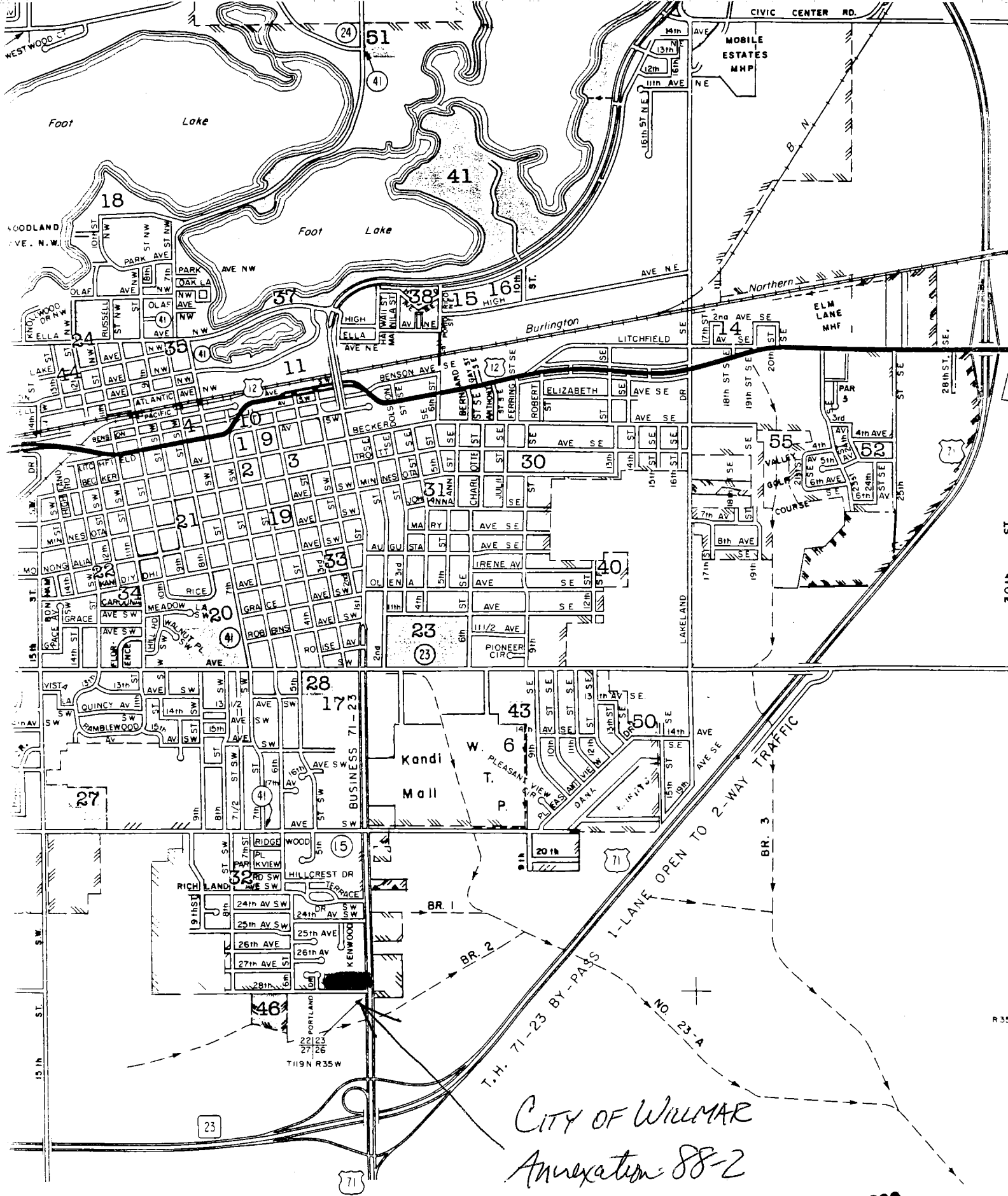

CITY OF WILLMAR
Annexation 88-2

REC'D. BY JUN 20 1988
MMS