

JUL 7 1986

ORDINANCE NO. 561

AN ORDINANCE ANNEXING CERTAIN LANDS (SCHAUMKESSEL PROPERTY)
TO THE CITY OF WASECA, MINNESOTA AND ESTABLISHING THE
ZONING THEREOF

WHEREAS, at the request of the landowner, certain lands are petitioned for annexation into the City of Waseca, and

WHEREAS, the land hereinafter described is unplatted land situated in Woodville Township, Waseca County, Minnesota, and is contiguous to the incorporated limits of the City of Waseca, and

WHEREAS Woodville Township and Waseca County have waived any claim or appeal against said annexation petition, and

WHEREAS, said lands are urban or suburban in character or about to become urban or suburban in character, and

WHEREAS, a portion of the land hereinafter described will be part of the City's Rural Service District, and

WHEREAS, the Waseca City Council has determined that the annexation of said land to the City of Waseca will be in the best interest of the City of Waseca.

NOW, THEREFORE, THE CITY OF WASECA DOES ORDAIN:

Sec. 1. That there is hereby annexed to and included within the City of Waseca, Minnesota, the following described land in the County of Waseca, State of Minnesota, as contained in Exhibit "A".

Sec. 2. That the annexed land shall be zoned within the meaning of the zoning ordinances and codes of the City of Waseca as R-2 Urban Residential.

Sec. 3. That a certified copy of this ordinance shall be filed with the Minnesota Municipal Commission, the Secretary of the State of Minnesota, the Waseca County Auditor, the Waseca County Register of Deeds and the Clerk of the Woodville Township Board.

Sec. 4. That this ordinance shall be effective on November 5, 1986 and upon legal publication, the filing of certified copies as directed in Sec. 3., and approval of the Minnesota Municipal Commission.

Passed and adopted by the City Council of Waseca, Minnesota, this 1st day of July, 1986.

ATTEST: Robert J. Allen
CITY CLERK

Ernest J. Hall
MAYOR

First Reading	<u>June 4, 1986</u>
Second Reading	<u>July 1, 1986</u>
Published	<u>July 10, 1986</u>
Effective	<u>November 5, 1986</u>

EXHIBIT "A"

Commencing at the Southwest corner of Government Lot 3 in Section Seventeen (17), Township One Hundred Seven (107) North, Range Twenty-two (22) West; thence North $00^{\circ} 36' 00''$ East 827.00 feet on the West line of said Government Lot 3, on an assumed bearing; thence Easterly 660.00 feet; thence South $00^{\circ} 36' 00''$ West 853 feet, more or less, parallel with the West line of said Government Lot 3, to the point of intersection with an Easterly extension of the South line of Eleventh Avenue Southeast as shown on the plat of South View Addition, as the same is platted and recorded in the Office of the County Recorder of Waseca County, Minnesota; thence North $90^{\circ} 00' 00''$ West 502.00 feet on the Easterly extension of the South line of said Eleventh Avenue Southeast; thence South $00^{\circ} 36' 00''$ West 608.07 feet parallel with the West line of Government Lot 4 in Section Seventeen (17), Township One Hundred Seven (107) North, Range Twenty-two (22) West; thence North $89^{\circ} 57' 00''$ West 158.00 feet to a point on the West line of Government Lot 4 in said Section Seventeen (17); thence North $00^{\circ} 36' 00''$ East 640.93 feet on said West line of said Government Lot 4 to the point of beginning, being part of Government Lot 3 and 4 in Section Seventeen (17), Township One Hundred Seven (107) North, Range Twenty-two (22) West, and containing 15.18 acres, more or less.

EXCEPTING THEREFROM: Starting at the South Quarter Corner of Section Seventeen (17), Township One Hundred Seven (107) North, Range Twenty-two (22) West; thence North 1873.81 feet on the north-south centerline of said Section; thence East 33.0 feet at a deflection angle of $89^{\circ} 24'$ right to a point on the East right-of-way line of Eighth Street S.E., which point is hereinafter called the point of beginning; thence East 182.0 feet on an easterly extension of the last described line; thence South 80.0 feet at a deflection angle of $90^{\circ} 36'$ right; thence West 182.0 feet at a deflection angle of $89^{\circ} 24'$ right, to the East right-of-way line of said street; thence North 80.0 feet on said right-of-way line to the point of beginning; being part of the Northwest Quarter of the Southeast Quarter ($NW\frac{1}{4}$ of $SE\frac{1}{4}$), Section Seventeen (17), Township One Hundred Seven (107) North, Range Twenty-two (22) West, and containing 0.33 acres.

AND EXCEPTING THEREFROM: Starting at the South Quarter Corner of Section Seventeen (17), Township One Hundred Seven (107) North, Range Twenty-two (22) West; thence North 1979.81 feet on the North-South centerline of said section; thence East 33.0 feet at a deflection angle of $89^{\circ} 24'$ right to a point on the East right-of-way line of Eighth Street S.E., which point is hereinafter called the point of beginning; thence East 150.0 feet on an Easterly extension of the last described line; thence South 106.0 feet at a deflection angle of $90^{\circ} 36'$ right; thence West 150.0 feet at a deflection angle of $89^{\circ} 24'$ right, to the East right-of-way line of said street; thence North 106.0 feet on said right-of-way line to the point of beginning, being part of the Northwest Quarter of the Southeast Quarter ($NW\frac{1}{4}$ of $SE\frac{1}{4}$) of Section Seventeen (17), Township One Hundred Seven (107) North, Range Twenty-two (22) West and containing 0.37 acres.

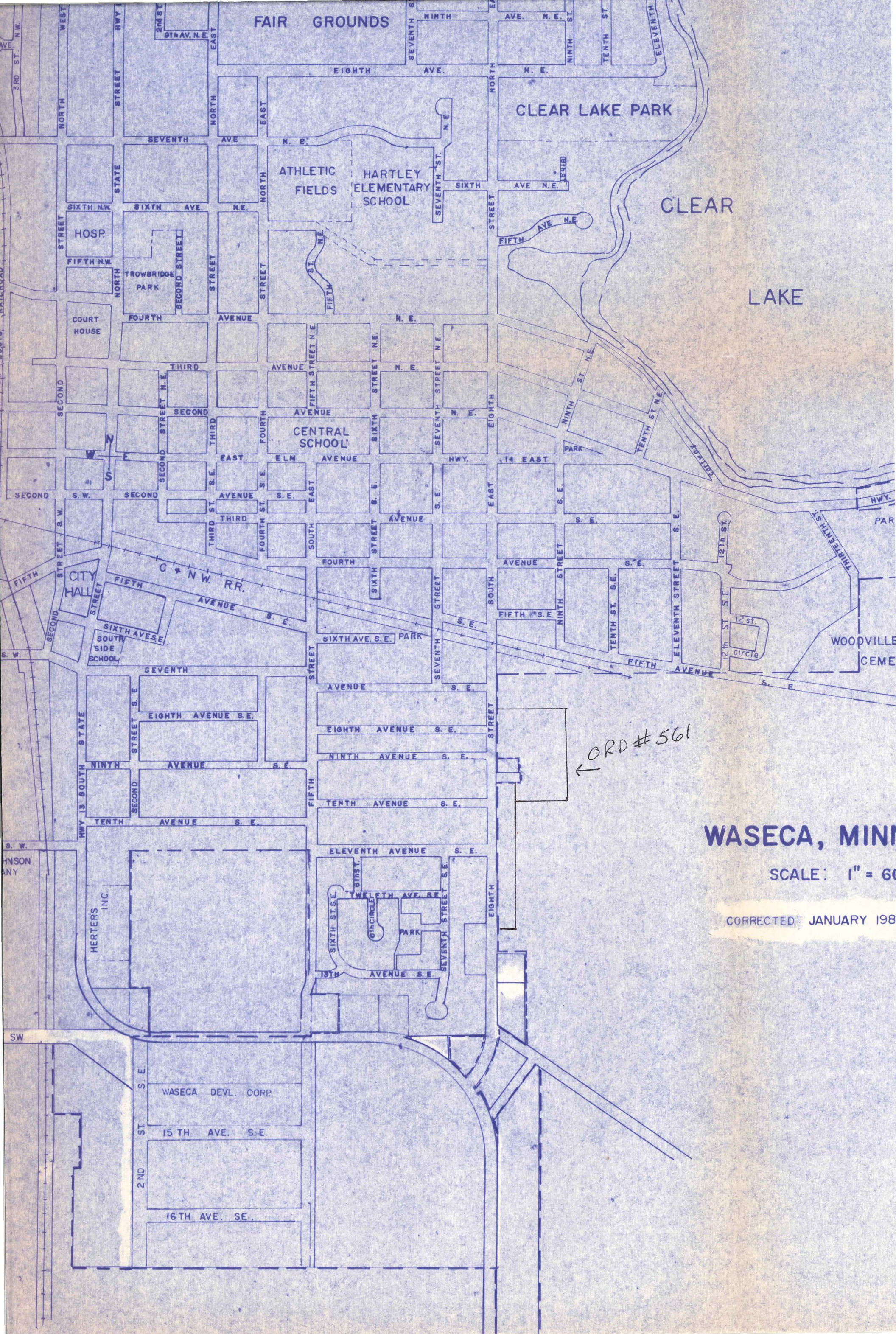

FAIR GROUNDS

CLEAR LAKE PARK

CLEAR

LAKE

ATHLETIC
FIELDS

HARTLEY
ELEMENTARY
SCHOOL

CENTRAL
SCHOOL

HOSP.

TROWBRIDGE
PARK

COURT
HOUSE

CITY
HALL

SOUTH
SIDE
SCHOOL

WOODVILLE
CEMETERY

WASECA DEVL. CORP.

15 TH AVE. S.E.

16 TH AVE. SE.

ORD #561

WASECA, MINN

SCALE: 1" = 60'

CORRECTED JANUARY 198

RECD. BY
RMB JUL 7 1986

