

JUL 7 1986

P E T I T I O N   F O R   A N N E X A T I O N

TO THE CITY COUNCIL OF THE CITY OF WASECA, MINNESOTA

We, the undersigned, being the owners of the territory described below, hereby request the City Council to annex this territory to the City of Waseca and to extend the City boundaries to include the same, and for that purpose respectfully state:

1. The territory to be annexed consists of unplatted lands. All of these lands lie entirely within the County of Waseca, Minnesota, and a description of such lands as contained in Exhibit "A".
2. The territory described above abutts upon the City limits of the City of Waseca and none of this described premises is presently included within the corporate limits of any incorporated city.
3. All of this territory is requested to be included in the City of Waseca Rural Service District.
4. And the owner of said premises is Lucille Schaumkessel.

Dated this 30th day of May, 1986.

Lucille Schaumkessel  
Lucille Schaumkessel

STATE OF MINNESOTA )  
                                  ) ss:  
COUNTY OF WASECA    )

The foregoing instrument was acknowledged before me this 30th day of May, 1986, by Lucille Schaumkessel.

Einer C. Iversen  
Notary Public

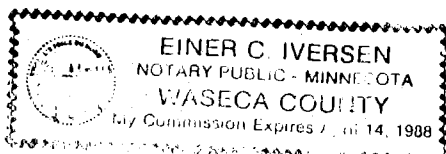

*no Exhibit "A" attached*

## EXHIBIT "A"

Commencing at the Southwest corner of Government Lot 3 in Section Seventeen (17), Township One Hundred Seven (107) North, Range Twenty-two (22) West; thence North  $00^{\circ} 36' 00''$  East 827.00 feet on the West line of said Government Lot 3, on an assumed bearing; thence Easterly 660.00 feet; thence South  $00^{\circ} 36' 00''$  West 853 feet, more or less, parallel with the West line of said Government Lot 3, to the point of intersection with an Easterly extension of the South line of Eleventh Avenue Southeast as shown on the plat of South View Addition, as the same is platted and recorded in the Office of the County Recorder of Waseca County, Minnesota; thence North  $90^{\circ} 00' 00''$  West 502.00 feet on the Easterly extension of the South line of said Eleventh Avenue Southeast; thence South  $00^{\circ} 36' 00''$  West 608.07 feet parallel with the West line of Government Lot 4 in Section Seventeen (17), Township One Hundred Seven (107) North, Range Twenty-two (22) West; thence North  $89^{\circ} 57' 00''$  West 158.00 feet to a point on the West line of Government Lot 4 in said Section Seventeen (17); thence North  $00^{\circ} 36' 00''$  East 640.93 feet on said West line of said Government Lot 4 to the point of beginning, being part of Government Lot 3 and 4 in Section Seventeen (17), Township One Hundred Seven (107) North, Range Twenty-two (22) West, and containing 15.18 acres, more or less.

EXCEPTING THEREFROM: Starting at the South Quarter Corner of Section Seventeen (17), Township One Hundred Seven (107) North, Range Twenty-two (22) West; thence North 1873.81 feet on the north-south centerline of said Section; thence East 33.0 feet at a deflection angle of  $89^{\circ} 24'$  right to a point on the East right-of-way line of Eighth Street S.E., which point is hereinafter called the point of beginning; thence East 182.0 feet on an easterly extension of the last described line; thence South 80.0 feet at a deflection angle of  $90^{\circ} 36'$  right; thence West 182.0 feet at a deflection angle of  $89^{\circ} 24'$  right, to the East right-of-way line of said street; thence North 80.0 feet on said right-of-way line to the point of beginning; being part of the Northwest Quarter of the Southeast Quarter ( $NW\frac{1}{4}$  of  $SE\frac{1}{4}$ ), Section Seventeen (17), Township One Hundred Seven (107) North, Range Twenty-two (22) West, and containing 0.33 acres.

AND EXCEPTING THEREFROM: Starting at the South Quarter Corner of Section Seventeen (17), Township One Hundred Seven (107) North, Range Twenty-two (22) West; thence North 1979.81 feet on the North-South centerline of said section; thence East 33.0 feet at a deflection angle of  $89^{\circ} 24'$  right to a point on the East right-of-way line of Eighth Street S.E., which point is hereinafter called the point of beginning; thence East 150.0 feet on an Easterly extension of the last described line; thence South 106.0 feet at a deflection angle of  $90^{\circ} 36'$  right; thence West 150.0 feet at a deflection angle of  $89^{\circ} 24'$  right, to the East right-of-way line of said street; thence North 106.0 feet on said right-of-way line to the point of beginning, being part of the Northwest Quarter of the Southeast Quarter ( $NW\frac{1}{4}$  of  $SE\frac{1}{4}$ ) of Section Seventeen (17), Township One Hundred Seven (107) North, Range Twenty-two (22) West and containing 0.37 acres.



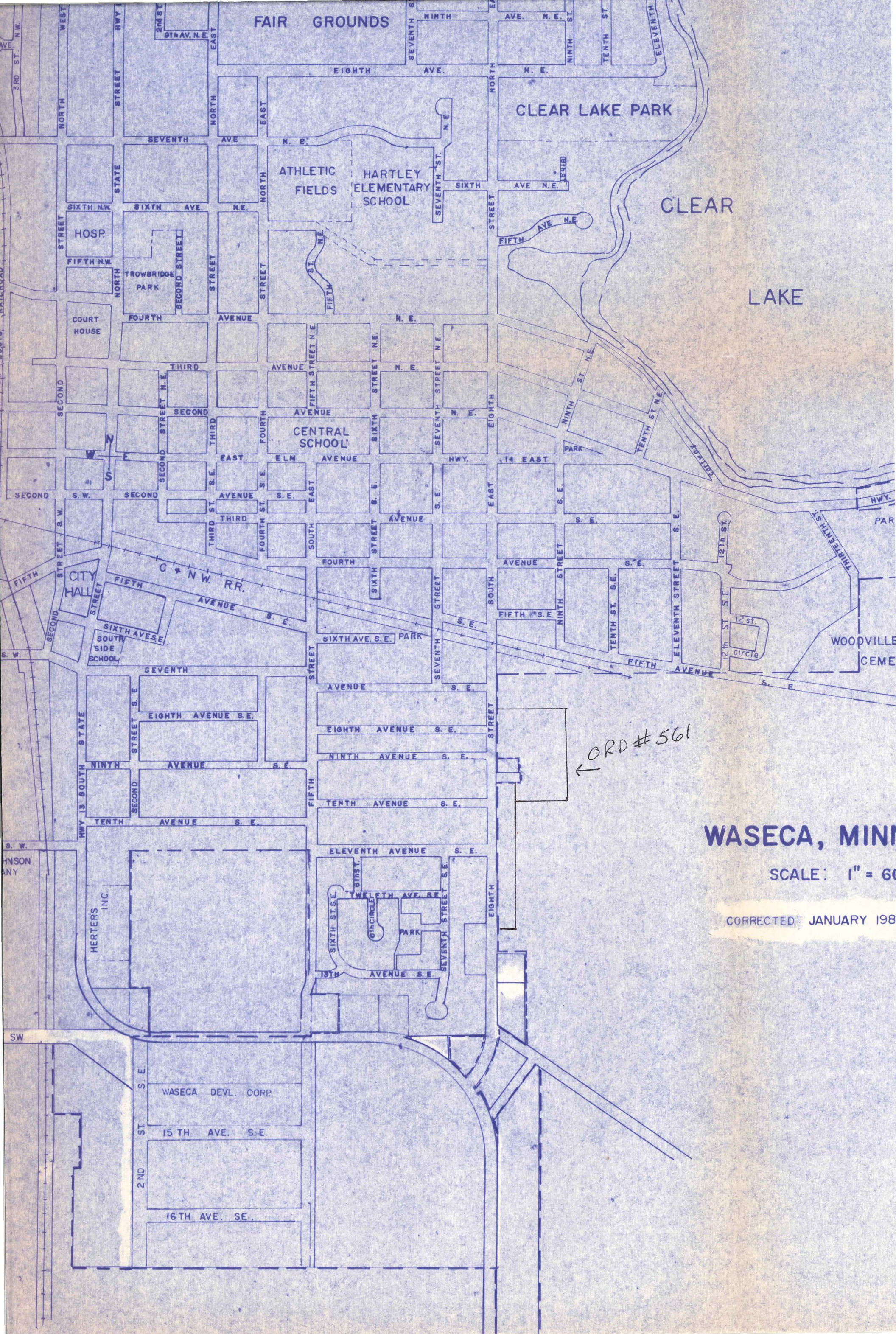

FAIR GROUNDS

CLEAR LAKE PARK

CLEAR

LAKE

ATHLETIC  
FIELDS

HARTLEY  
ELEMENTARY  
SCHOOL

CENTRAL  
SCHOOL

HOSP.

TROWBRIDGE  
PARK

COURT  
HOUSE

CITY  
HALL

SOUTH  
SIDE  
SCHOOL

WOODVILLE  
CEMETERY

WASECA DEVL. CORP.

15 TH AVE. S.E.

16 TH AVE. SE.

ORD #561

WASECA, MINN

SCALE: 1" = 60'

CORRECTED JANUARY 198



RECD. BY  
RMB JUL 7 1986

